

105x148.5mm

# NOORCO

## LAMP ACCESSORIES

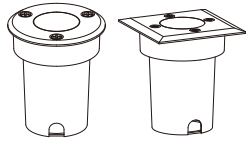

### Warning

- Please read the product instructions carefully before installation. Keep this installation instruction manual for future reference.
- Installation of stationary products and connection of cables shall comply with local national electrical codes.
- For safety reasons, the product must be grounded to prevent damage from electrical leakage.
- All installation procedures must be performed by qualified electrician personnel.
- If the shell or internal structure of the product is damaged, please cut off the power and replace it by qualified electricians.

### Product Installation and Wiring Diagram

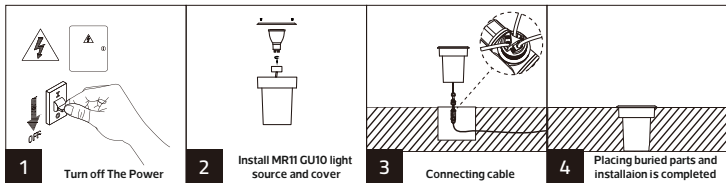

### Product Specifications and Dimensions

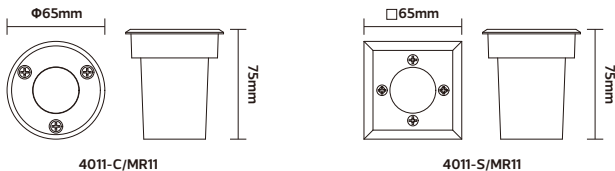

ta:50°C



IP65&IP67

Customer Service Center.8004300030

Made in China  
صنع في الصين

