

BURIED LIGHT HOUSING

NR-BLS0301-1

IP65



Model No	Cap Type	Lamp Type	Dimensions in mm		Hole Size (mm)	
A	B					kg
NR-BLS0301-1	GU10*1(Max.6W)	MR16	Φ110	140	Φ100	0.43

Dimensions in mm

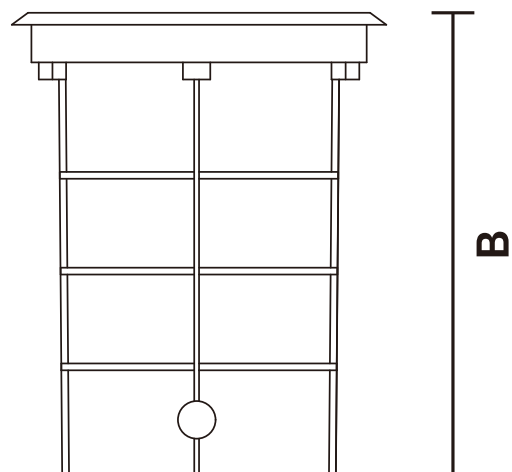
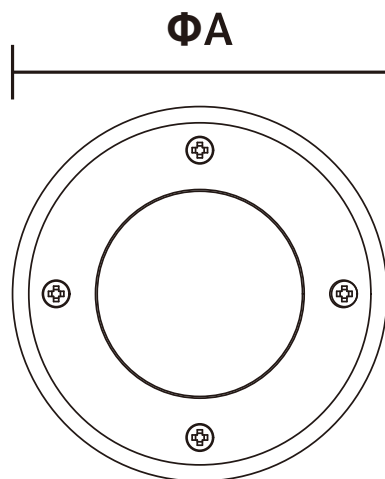

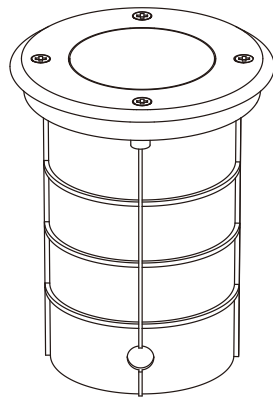

Description:
BURIED LIGHT HOUSING

Main material:
Stainless steel+aluminum material

Specification

- 1.Fashionable simplicity: Classic modernist design, simple and generous lamp body, suitable for various decoration styles.
- 2.Texture material: Adopt high-quality materials, the surface is processed by special technology, which has texture and is easy to clean.
- 3.Multiple lights: Unique design concept, multiple light effects to choose from, both beautiful and practical.
- 4.Easy installation: The lamp holder adopts a user-friendly installation design, which is convenient, quick, time-saving and labor-saving.

Applications

. Park . Square . Tourist attraction . Corridor

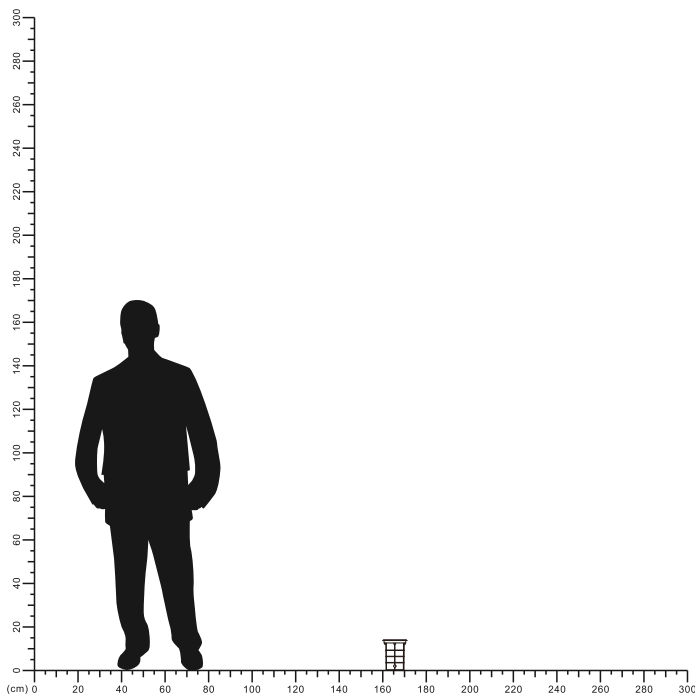

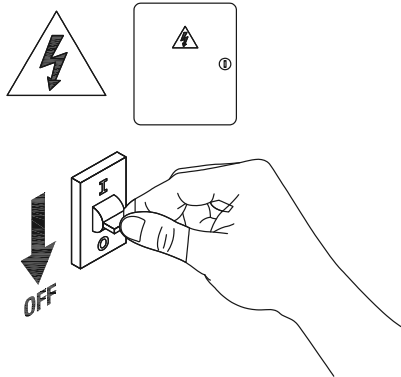

1

Turn off The Power

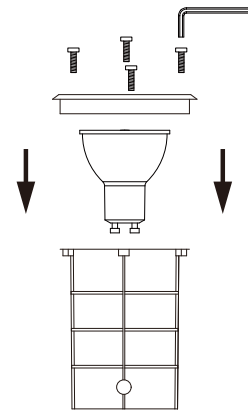

2

Install GU10 lamp cup

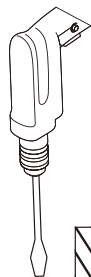

3

Opening holes on the ground

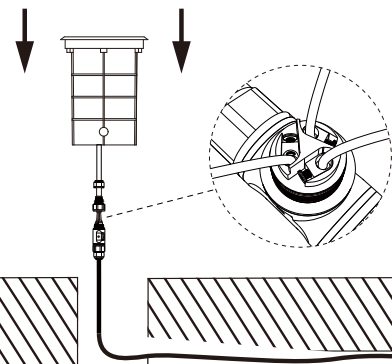

4

Connect the cable

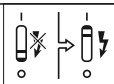

5

Installation completed

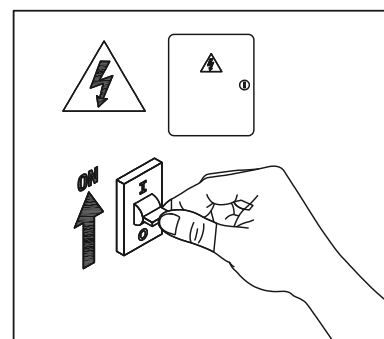

6

Turn on the power

