

Lamp Accessories

A095

IP54



Item Code	Cap Type	Dimensions in mm			kg
		A	B	C	
A095	E27*1(Max Size: Φ90mm)	190	163	380	1.46

Dimensions in mm

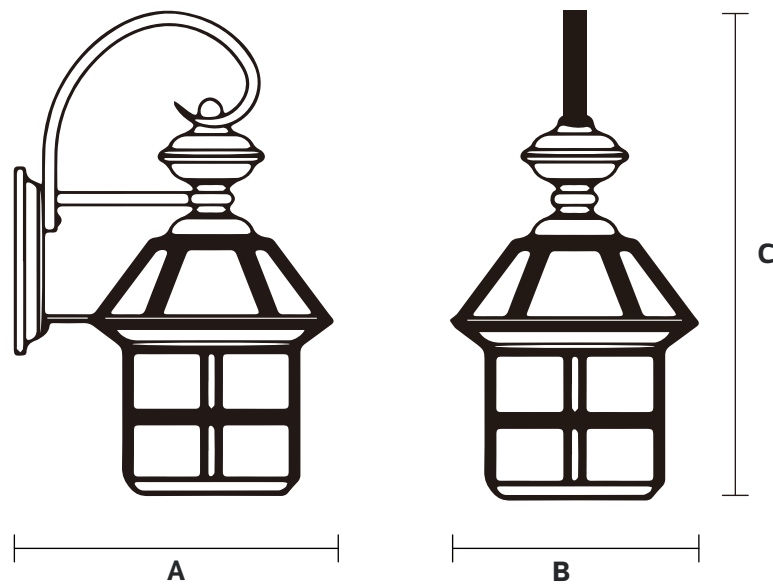

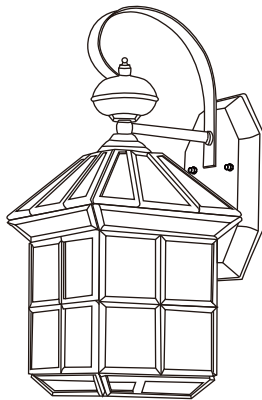

Description:
Lamp Accessories

Main material:
Copper+Transparent glass

Specification
Durable lamp body, integrated die-casting forming, with a hard texture but wear resistance.
High transparency glass, soft and not dazzling light.

IP 54

Applications
. Villas
. Parks
. Communities

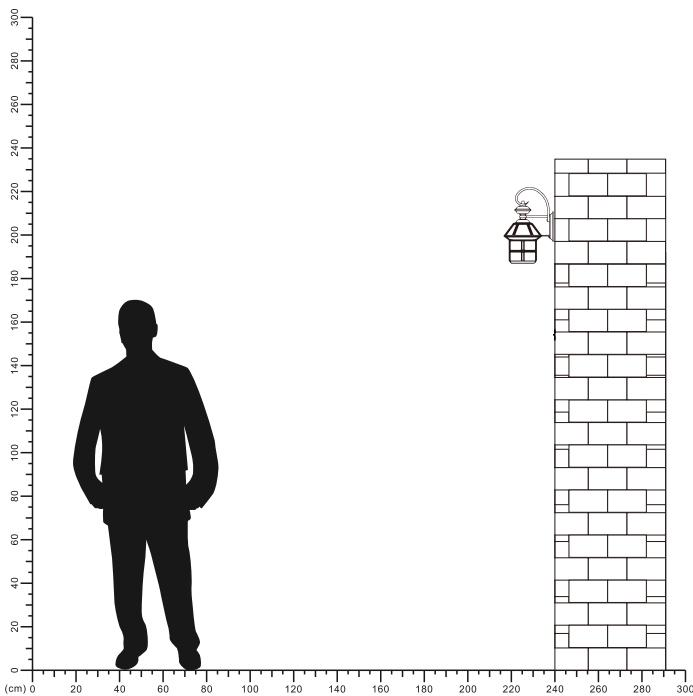

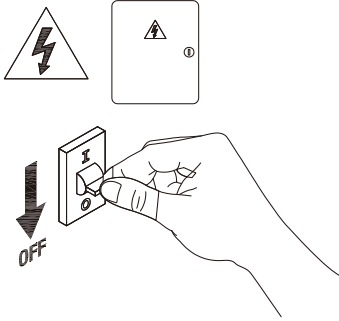

1

Turn off the power

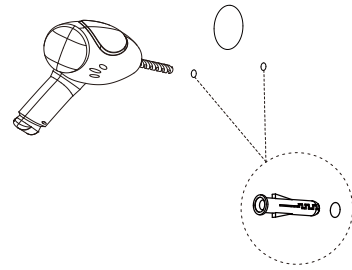

2

Drill holes in the wall insert expansion screws

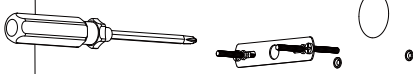

3

To install the hanging board

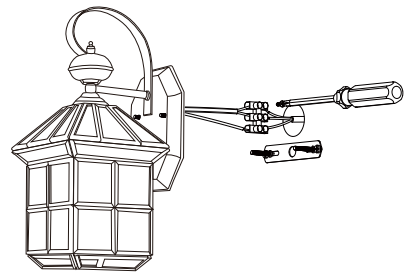

4

Connecting the power cord

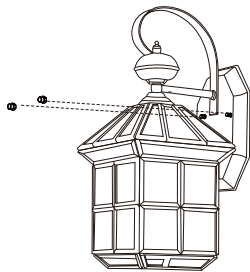

5

Tighten the screw cap



6

Tighten the bulb

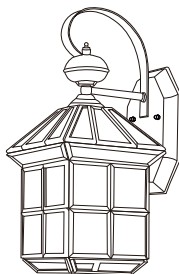

7

Installation completed

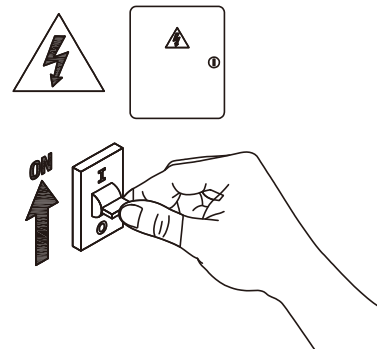

8

Turn on power

