

LED Ceiling Lamp

CL-011-01 Series

IP20

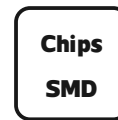
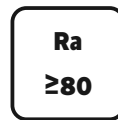

Item Code	P (W)	CCT (K)	Dimensions in mm		 kg
			A	B	
CL-011-01-1500	24W	3000K	1500	800	1.6

Dimensions in mm

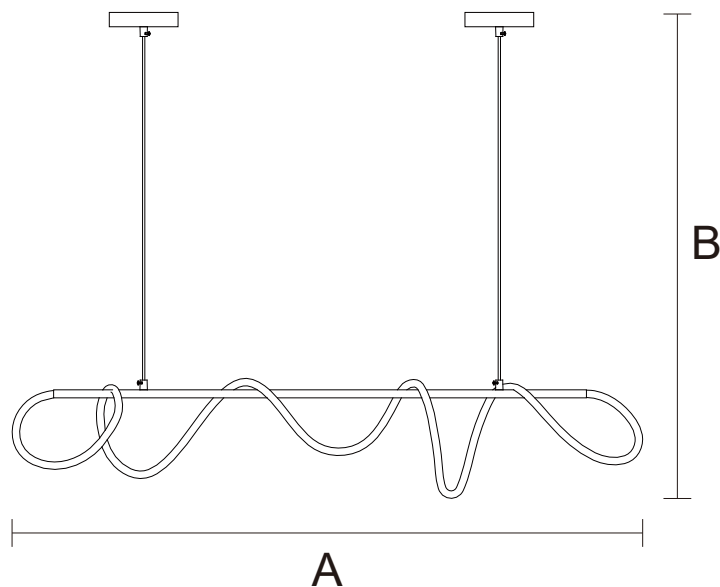

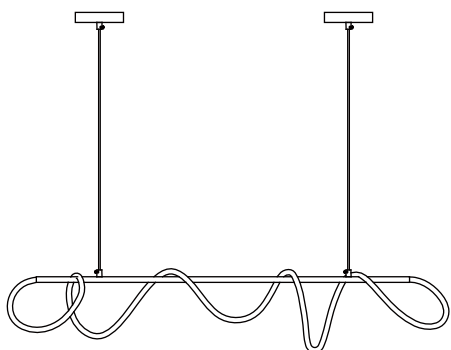

Description:
LED Ceiling Lamp

Main material:
Iron+PC

Specification

Special tree branch shape appearance, simple but full of personality and creative, randomly match the scene.
IP20

Applications

- . Hotel
- . Drawing room
- . Corridor

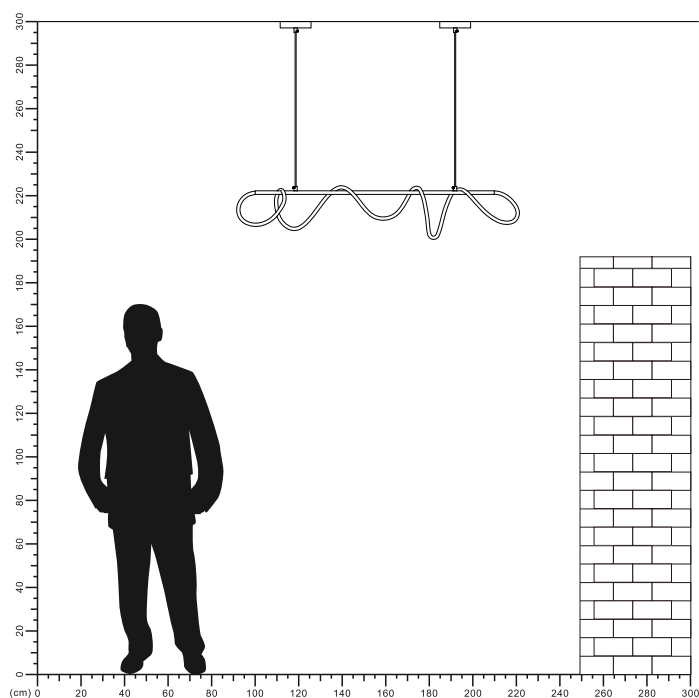

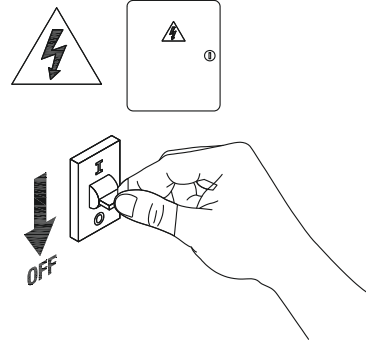
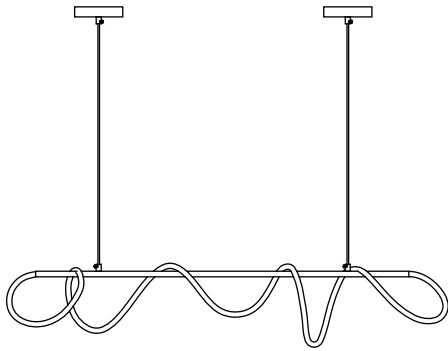

1

Turn off The Power

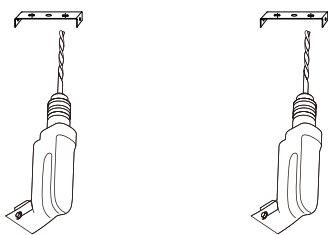

2

Drill 4 holes on your ceiling

3

Install base plate

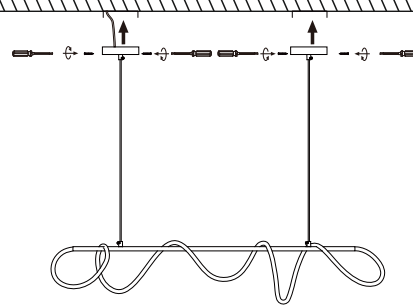
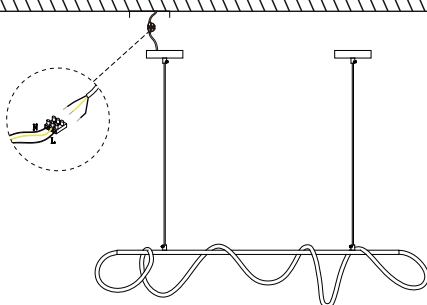

4

connect the cable

5

Install the ceiling lamp on the base plate

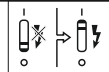
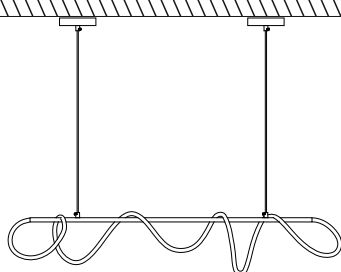

6

Installation completed

7

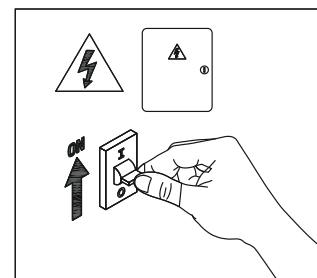

Turn on the power

