

LED Ceiling Lamp

CL-1100

IP20



Item Code	Cap Type	Dimensions in mm			
		A	B	C	
CL-1100	G9*2(Max Size: Φ22mm)	1100	Φ100	1490	1.1

Dimensions in mm

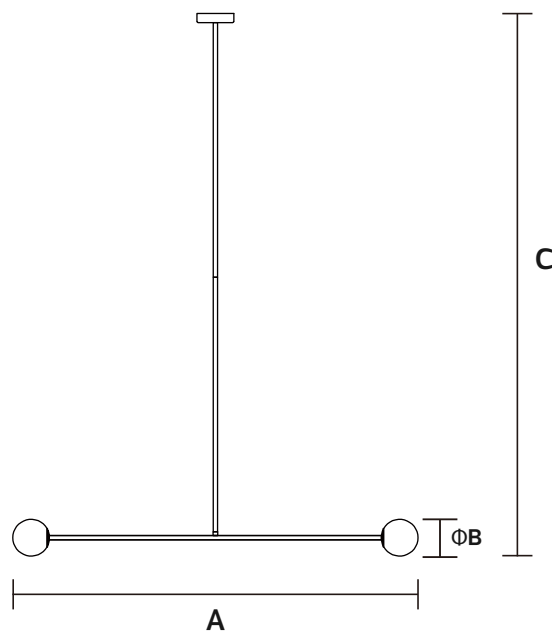

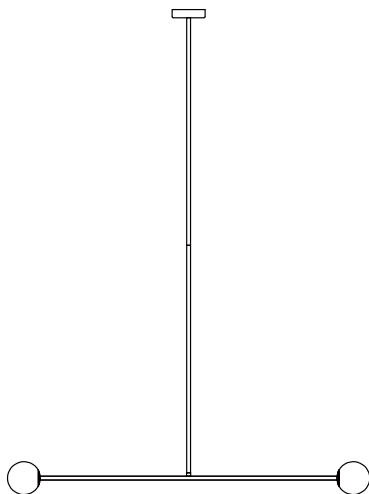
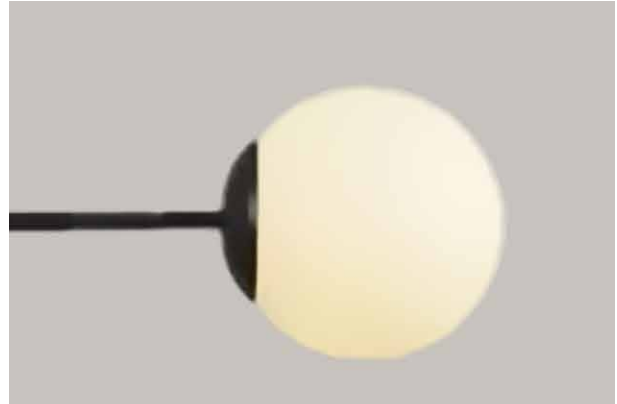

Description:
LED Ceiling Lamp

Main material:
Iron + acrylic

Specification
Special tree branch shape appearance, simple but full of personality and creative, randomly match the scene.
IP20

Applications
. Hotel
. Drawing room
. Corridor

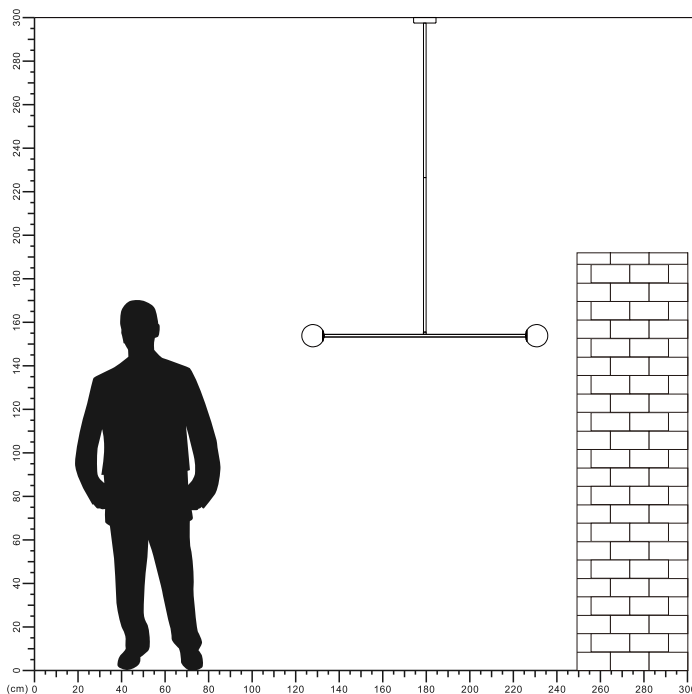

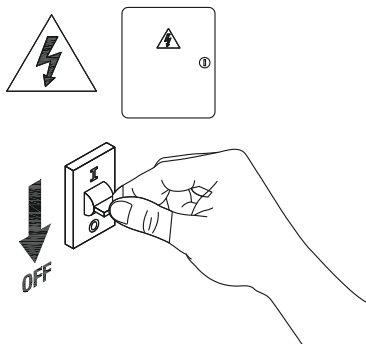

1

Turn off The Power

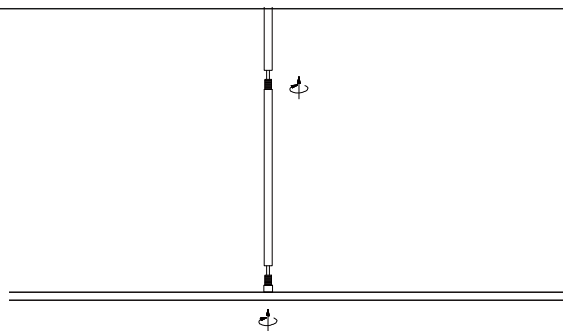

2

Lock the connector

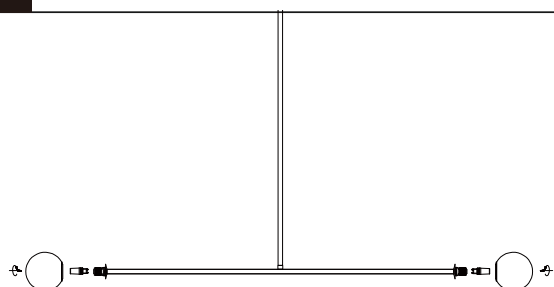

3

Install G9 bulb

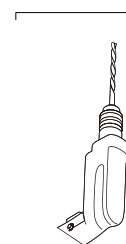

4

Drill 2 holes on your ceiling

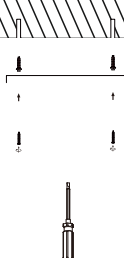

5

Install base plate

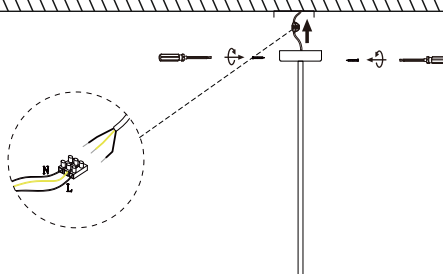

6

Connect the cable and Mounting lamp body

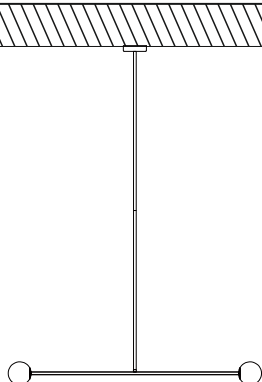

7

Installation completed

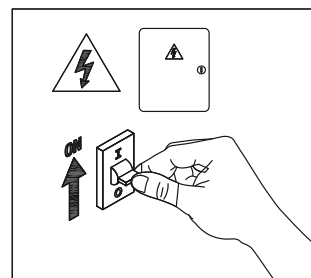

8

Turn on the power

