

Lamp Accessories

CL-1124 Series

IP20



Item Code	Cap Type	Dimensions in mm		
		A	B	
CL-1124-A	E27*1(Max Size Φ60 mm)	Φ200	1500	0.9
CL-1124-B	E27*1(Max Size Φ60 mm)	Φ250	1500	1.2
CL-1124-C	E27*1(Max Size Φ60 mm)	Φ300	1500	1.5

Dimensions in mm

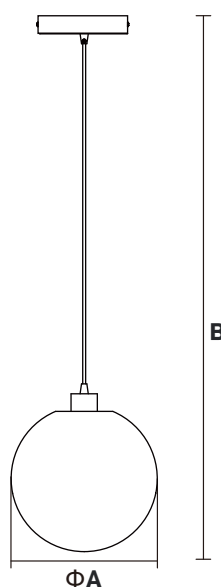

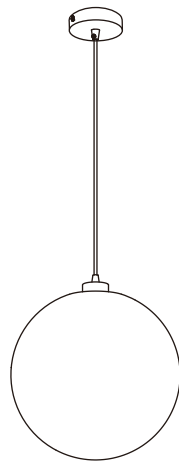
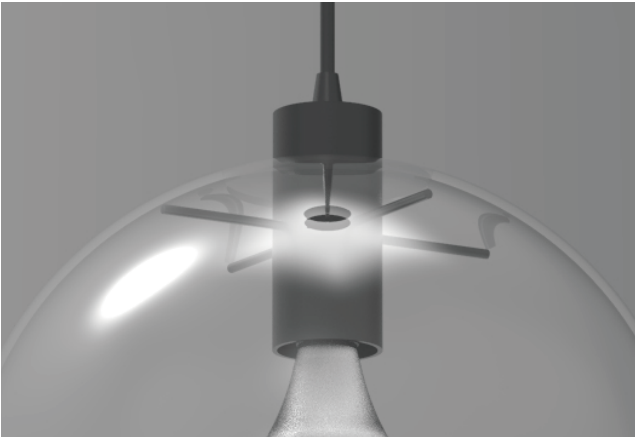

Description:

Lamp Accessories

Main material:

Iron+glass

Specification

Iron spray painted ceiling tray with strong load bearing capacity, black spray painting process, anti corrosion and rust prevention. Clear glass lampshade, hand blown, beautiful and elegant, with soft and non dazzling lighting.

Lock wire accessories, can arbitrarily adjust the height of the lamp line, simple to use, convenient.

E27 screw socket lamp head, high temperature and heat resistance, light source can be freely replaced.

IP 20

Applications

- Dining room
- Coffee shop
- Living room

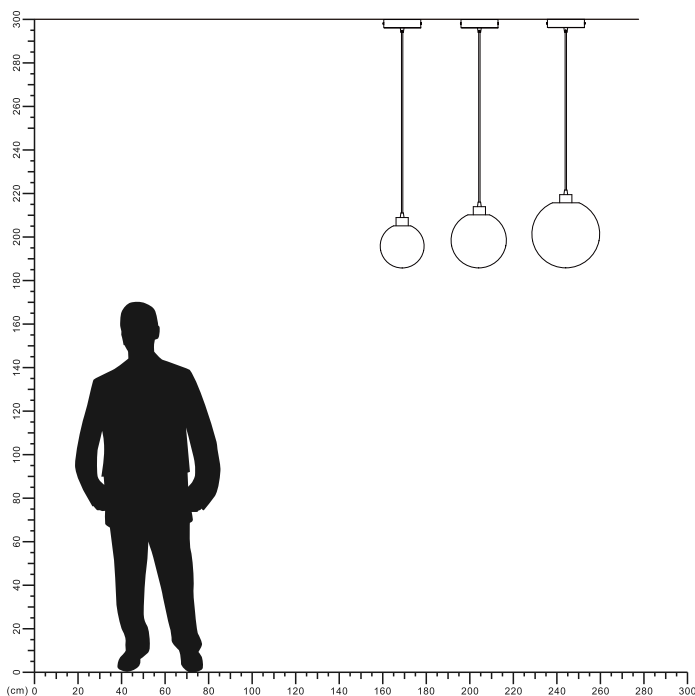

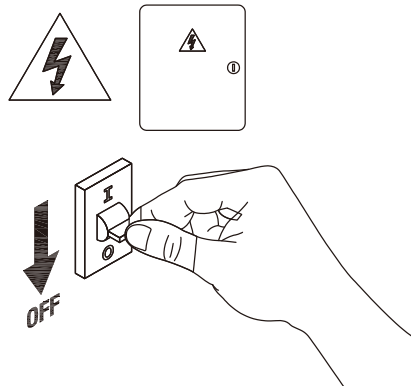
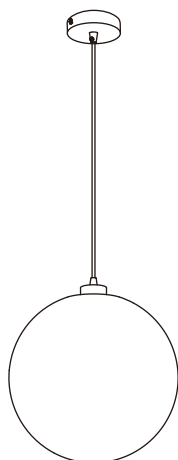

1

Turn off the power

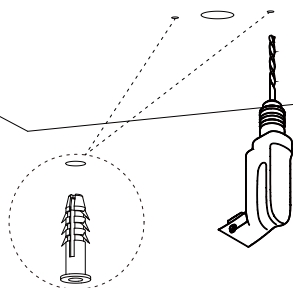

2

Drill holes in the ceiling to insert expansion screws

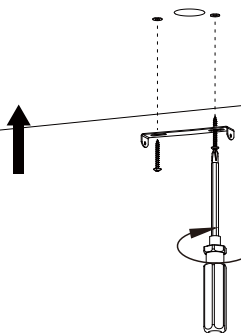

3

To install the hanging board

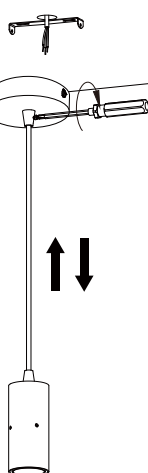

4

Adjust the length of the three cables according to usage and tighten the screws

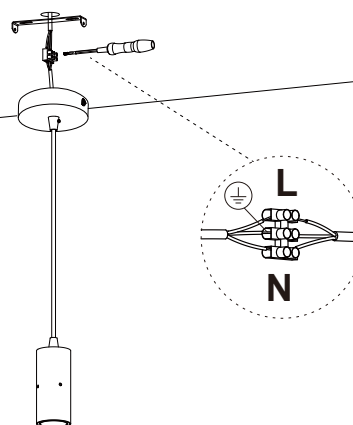

5

Connecting the power cord

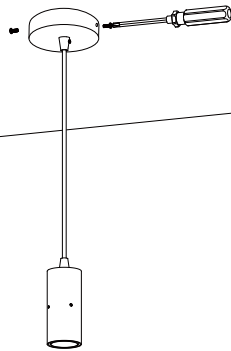

6

Tighten the screws the suction top disc

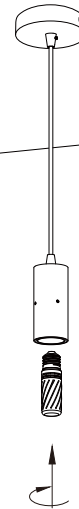

7

Tighten the three E27 bulbs

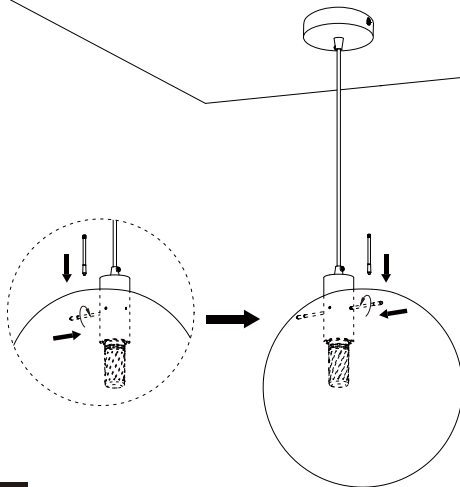

8

Place the lampshade and insert it into the support tube on one side before inserting it into the support tube on the other side

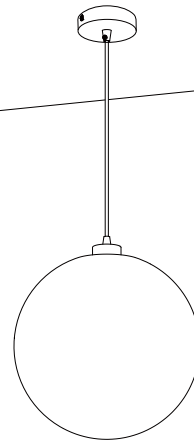

9

Installati on completed

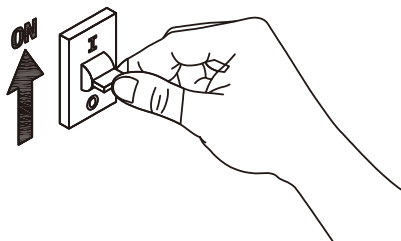

10

Turn on the power

