

Lawn Lamp Housing

NR-OLLS0652-1

IP65



Model No	Cap Type	Lamp Type	Color	Dimensions in mm		
				A	B	
NR-OLLS0652-1	GU10*1	MR16	Black	Φ55	505	0.53

Dimensions in mm

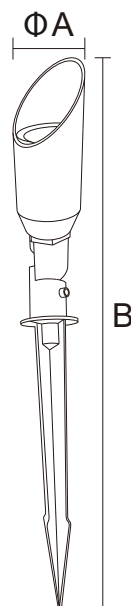

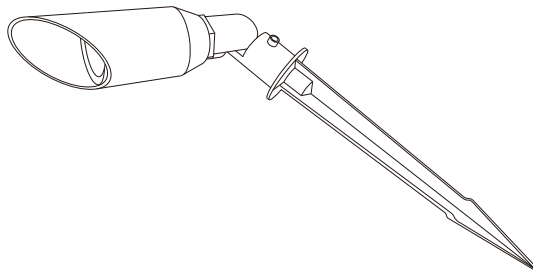

Description:
Lawn Lamp Housing

Main material:
Aluminum+Glass

Specification

1. Fashionable simplicity: Classic modernist design, simple and generous lamp body, suitable for various decoration styles.
2. Texture material: Adopt high-quality materials, the surface is processed by special technology, which has texture and is easy to clean.
3. Multiple lights: Unique design concept, multiple light effects to choose from, both beautiful and practical.
4. Easy installation: The lamp holder adopts a user-friendly installation design, which is convenient, quick, time-saving and labor-saving.

Applications

. Park . Square . Tourist attraction . Corridor

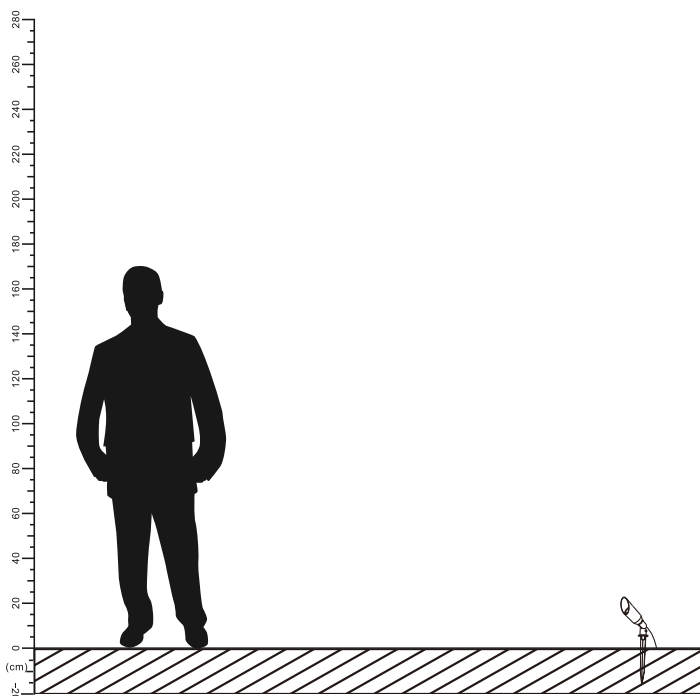

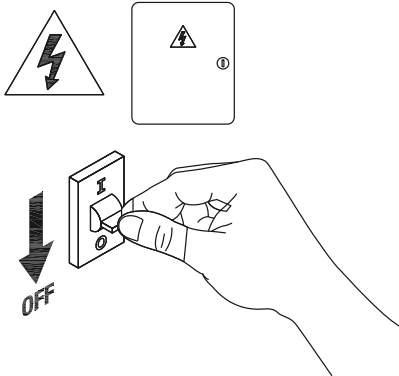

1

Turn off The Power



2

Install MR16 GU10 light source and cover

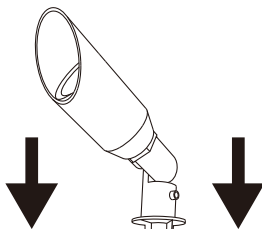

3

Insert the lamp body into the ground

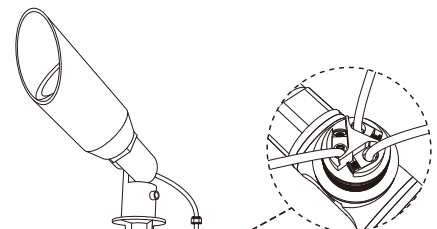

4

Connect the cable

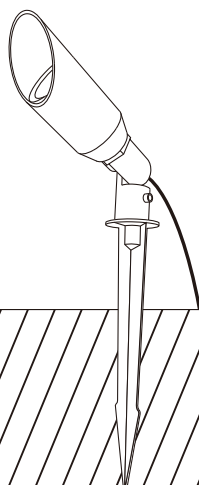

5

Installation completed

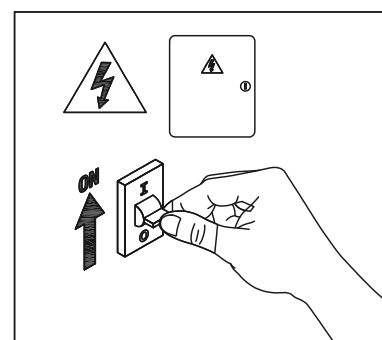

6

Turn on the power

