

Lamp Accessories

H8016-E27

IP65



Item Code	Socket	Color	Dimensions in mm			kg
			A	B	C	
H8016-E27	E27*1	Black	152	120	230	1

Dimensions in mm

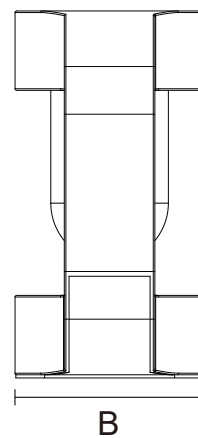
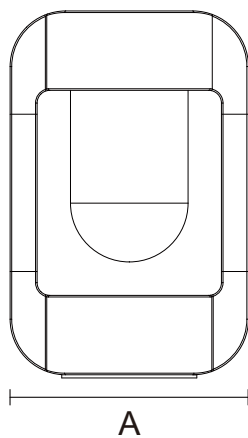

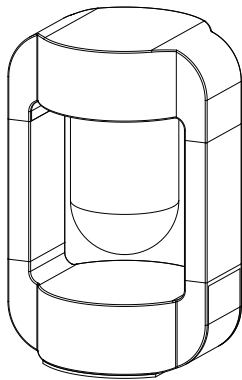

Description:
Lamp Accessories

Main material:
Aluminum+PC Plastic

- Specification**
- 1.Fashionable simplicity: Classic modernist design, simple and generous lamp body, suitable for various decoration styles.
 - 2.Texture material: Adopt high-quality materials, the surface is processed by special technology, which has texture and is easy to clean.
 - 3.Easy installation: The lamp holder adopts a user-friendly installation design, which is convenient, quick, time-saving and labor-saving.

Applications
. Park . Square . Tourist attraction . Corridor

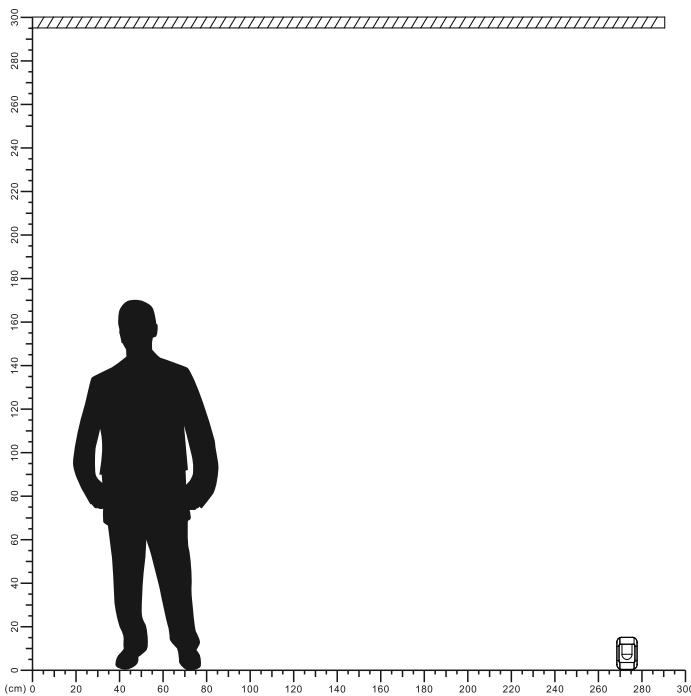

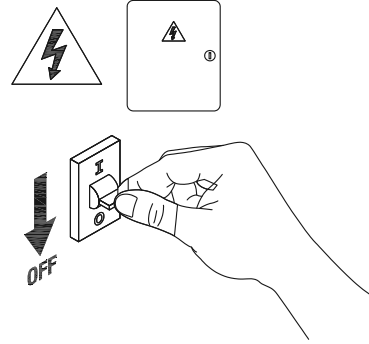
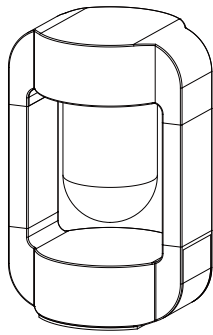

1

Turn off The Power

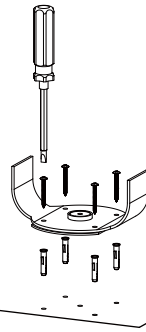
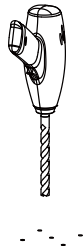

2

Drill 5 holes on the ground

3

Fix the base

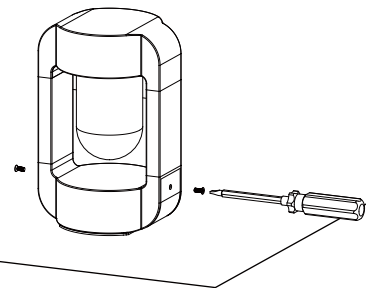
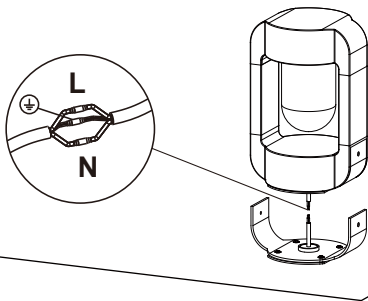

4

Connect the cable

5

Fix the lamp body

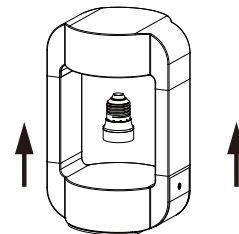
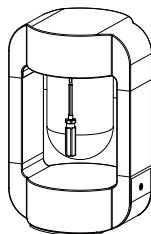

6

Take off the PC cover

7

Install the E27 LED lamp

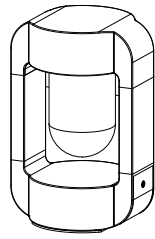

8

Installation completed

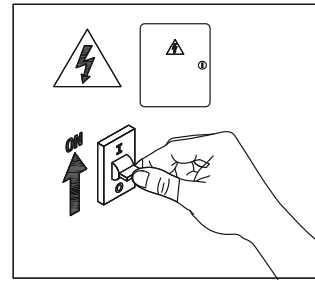

9

Turn on the power

