

## HV-SL101-6 W Series

### LED Gu10 Lamp Cup



<b>Indoor</b> 	<b>SocKet</b> <b>GU10</b>	<b>AC</b> 100-240V	<b>50/60</b> Hz	<b>PF</b> ≥0.5	<b>CCT</b> 6500K 4000K 3000K	<b>Ra</b> ≥80	<b>IP20</b>	<b>Beam Angel</b> 60°	<b>Chips</b> <b>SMD</b>	
-------------------	------------------------------	-----------------------	--------------------	-------------------	---------------------------------------	------------------	-------------	--------------------------	----------------------------	--

Item Code	P (W)	CCT(K)	Beam angle	Output (lm)	lm/w	Dimensions in mm A B		kg
HV SL101-6-WW	6	3000	60°	550	91	50	58	0.03
HV SL101-6-DW	6	4000	60°	550	91	50	58	0.03
HV SL101-6-W	6	6500	60°	550	91	50	58	0.03

### Dimensions in mm

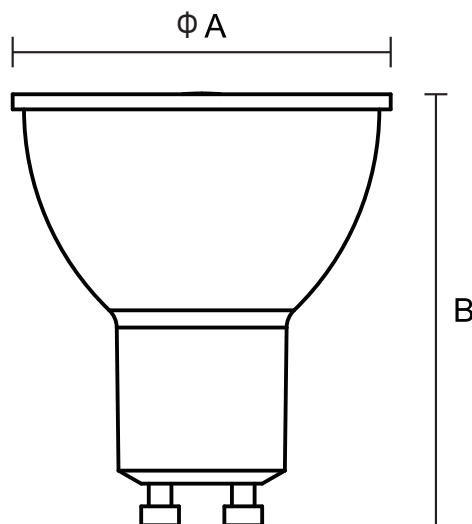



High quality plastic coated aluminum material



High quality flame retardant material



**Description:**  
LED GU10 LAMP CUP

**Main material:**  
Engineering plastics+Aluminum

**Specification**  
Energy saving, up to 85% energy saving comparing to standard halogen and incandescent lamps  
High quality light, high color rendering, less heat, no UV or IR radiation  
Build-in LED Driver  
IP20

**Applications**  
.Shopping mall  
.Hotels  
.Exhibition hall  
.Art hall  
.Museums

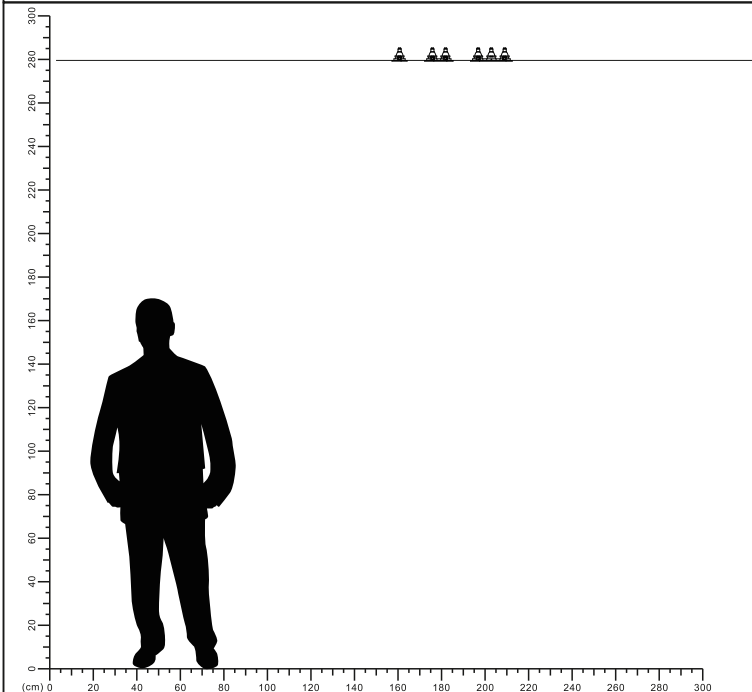

# LUMINOUS INTENSITY DISTRIBUTION DIAGRAM

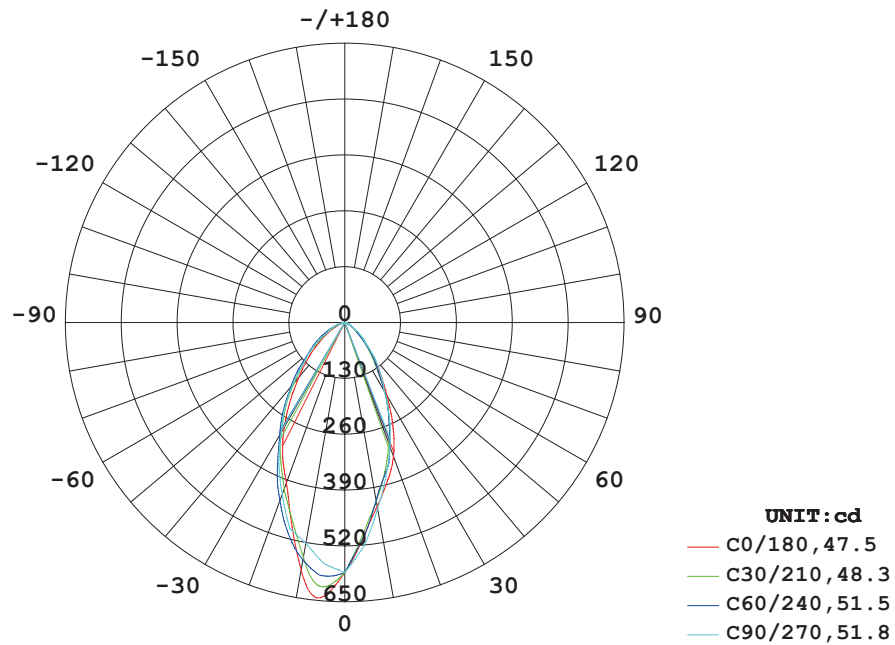

**AVERAGE BEAM ANGLE (50%) : 49.8 DEG**

## Illuminance at a Distance

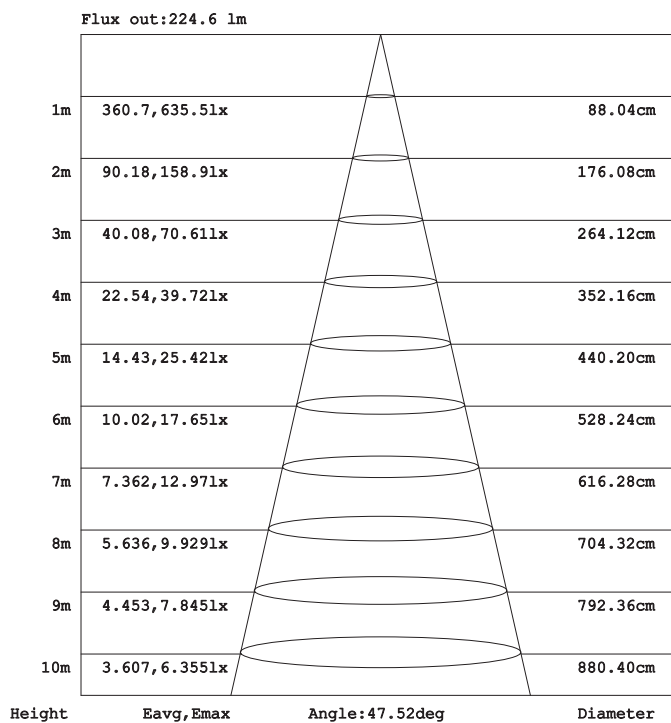

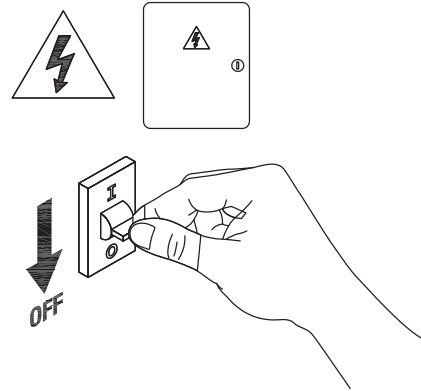
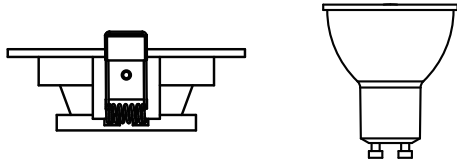

**1**

**Turn off The Power**

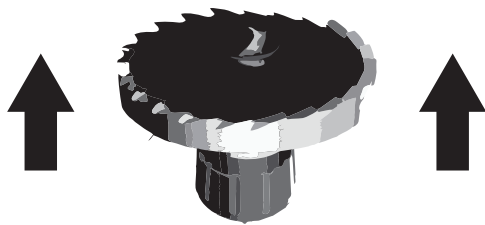

**2**

**Cut a hole on your ceiling**

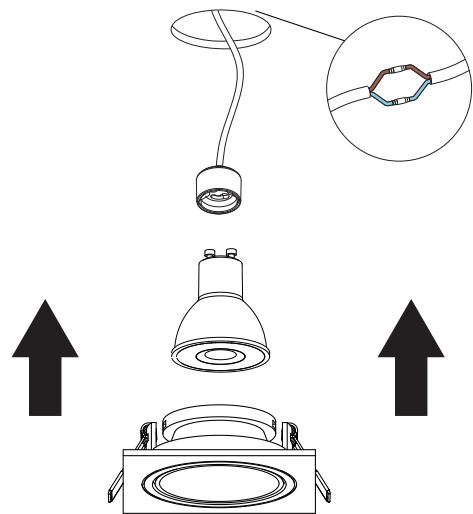

**3**

**Install lamps and wiring**

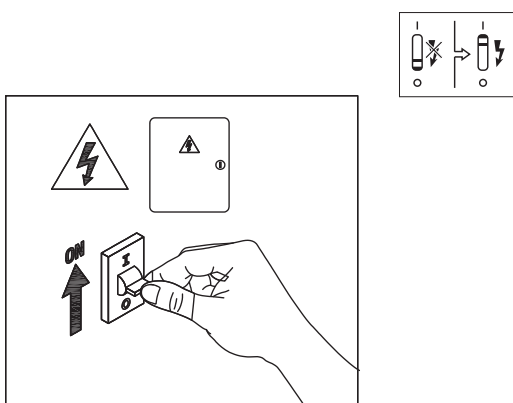

**4**

**Turn on the power**

