

LED Wall Lamp

LH-3039 Series

IP20

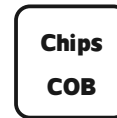
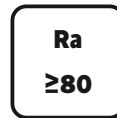

Item Code	P (W)	CCT(K)	Color	kg
LH-3039-Black	3	3000	Black	2.35
LH-3039-Gold	3	3000	Gold	2.35

Dimensions in mm

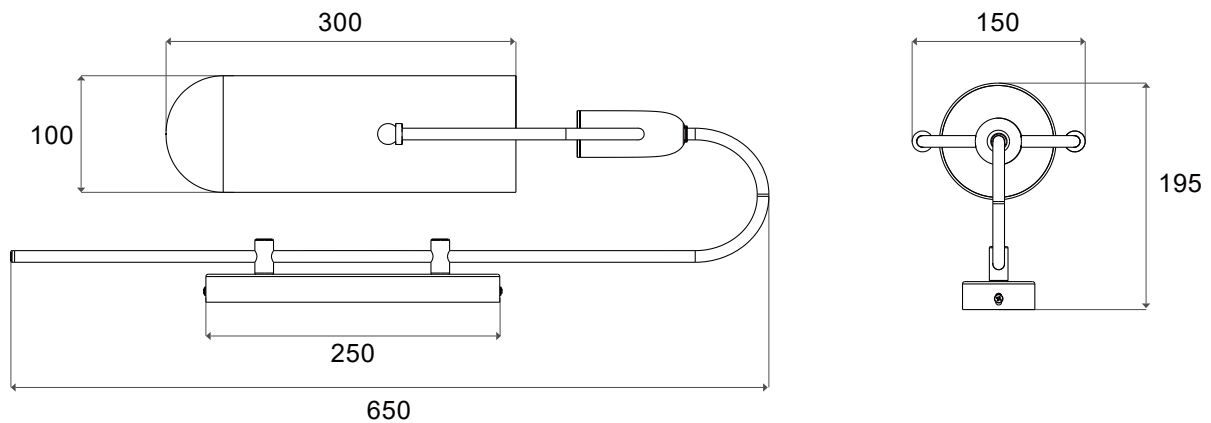

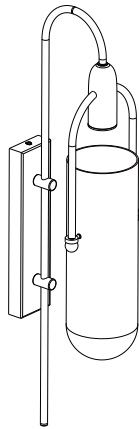

Description:
LED Wall Lamp

Main material:
Iron+ Glass

Specification

Spray painting can enhance the surface hardness and wear resistance of the lamp body, provide resistance against oxidation and corrosion, and make the surface smoother.
IP 20

Applications

- . Villas
- . Room
- .Communities

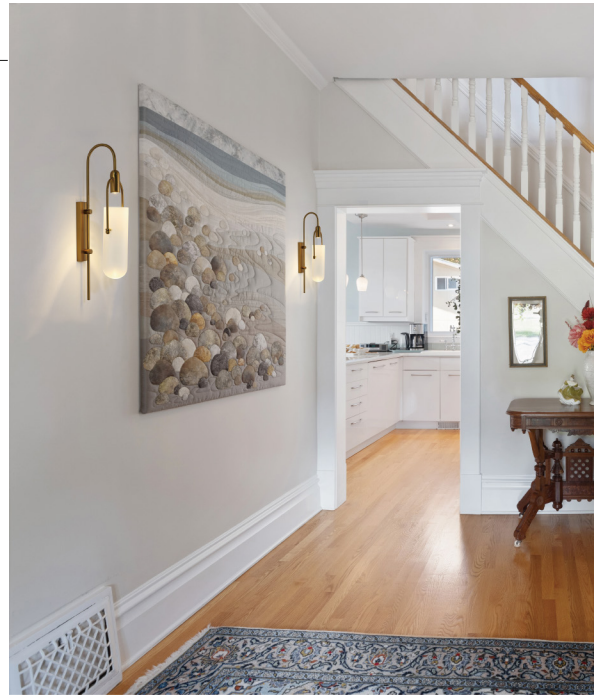
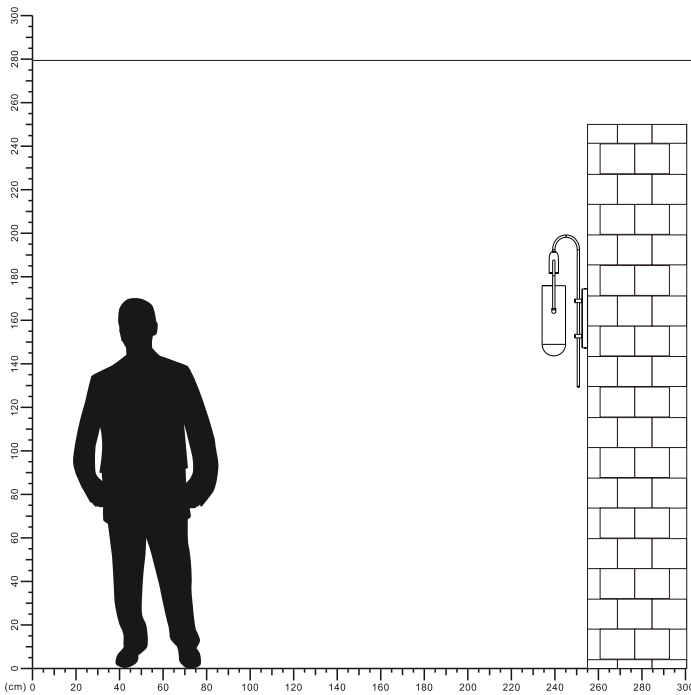

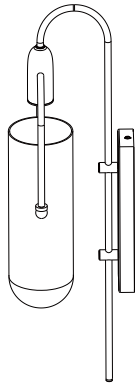

1

Turn off the power

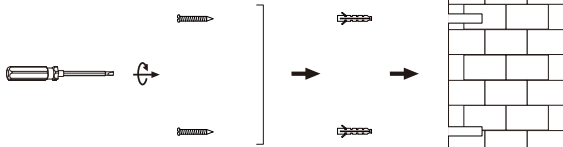
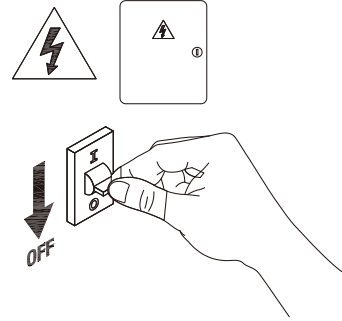

2

Drill two screw holes on the wall and install the base plate

3

Installing a buckle in the glass lampshade

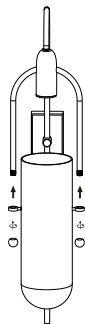
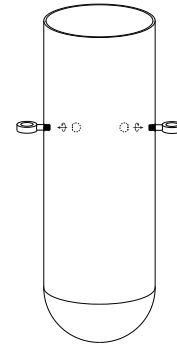

4

Installing the glass lampshade onto the lamp body

5

Connect cable

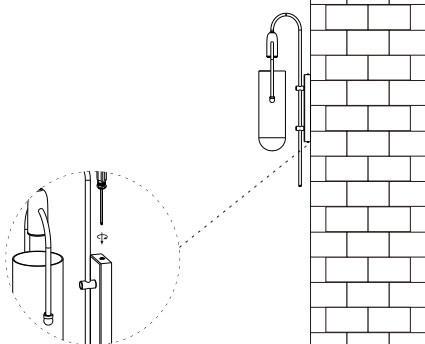
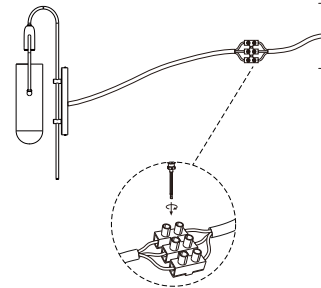

6

Fix the lamp body on the bottom plate, and the installation is complete

7

Turn on power

