

LED Ceiling Lamp

MD20002 Series

IP20

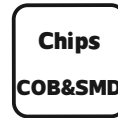
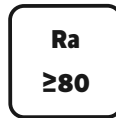

Item Code	P (W)	CCT (K)	Dimensions in mm		
			A	B	
MD20002-60	72W	3000	Φ600	1200	2.7
MD20002-80	96W	3000	Φ800	1500	3.1

Dimensions in mm

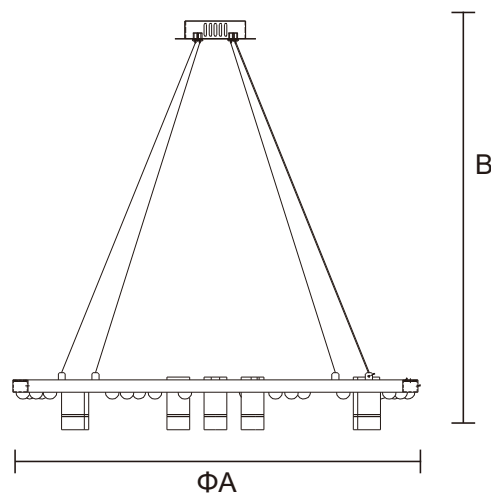

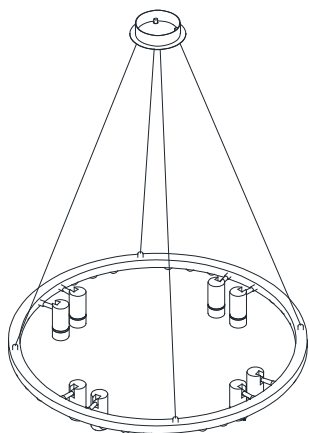

Description:
LED Ceiling Lamp

Main material:
Aluminum+Iron+Acrylic

Specification

Special tree branch shape appearance, simple but full of personality and creative, randomly match the scene.
IP20

Applications

- . Hotel
- . Drawing room
- . Corridor

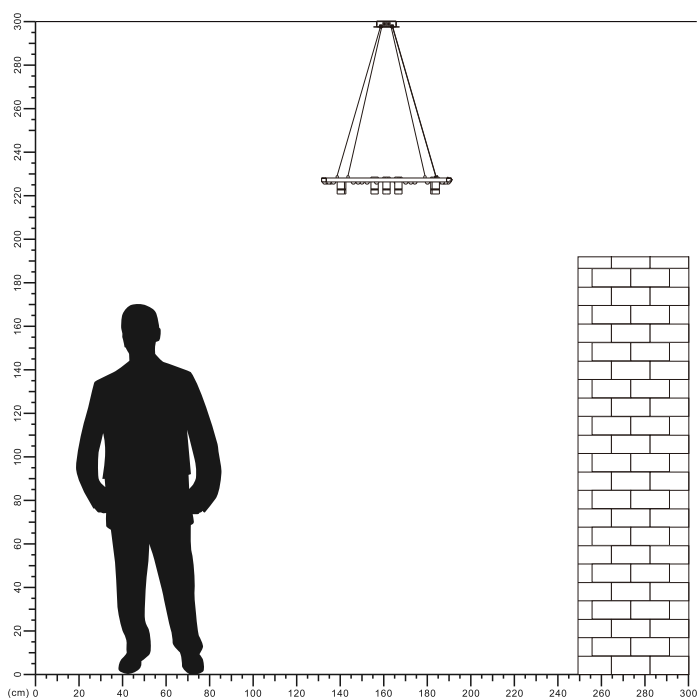

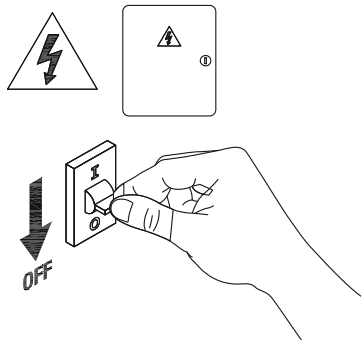
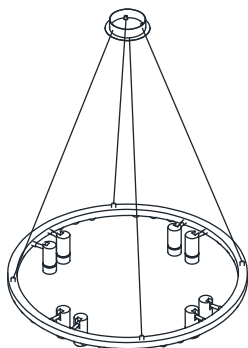

1

Turn off The Power

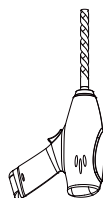

2

Drill 2 holes on your ceiling

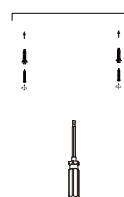

3

Install base plate

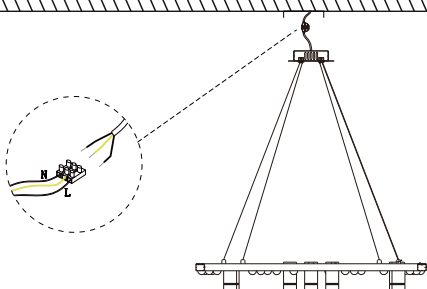

4

connect the cable

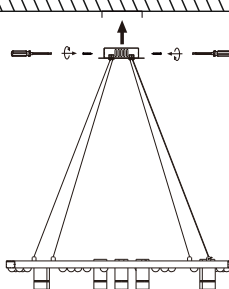

5

Install the ceiling lamp on the base plate

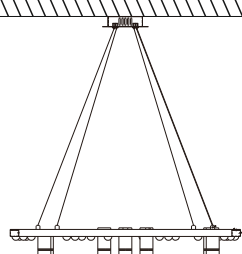

6

Installation completed

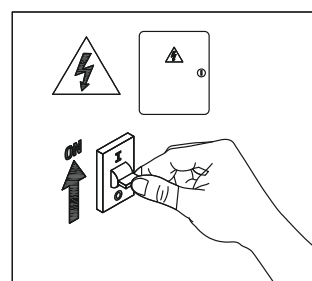

7

Turn on the power

