

## Ceiling Lamp

ME-ICLS0004-12

IP20

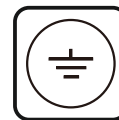

Model No	Cap Type	Color	kg
ME-ICLS0004-12	G9*12 (Max Size Ø30mm)	Titanium Gold+Chrome	19.1

## Dimensions in mm

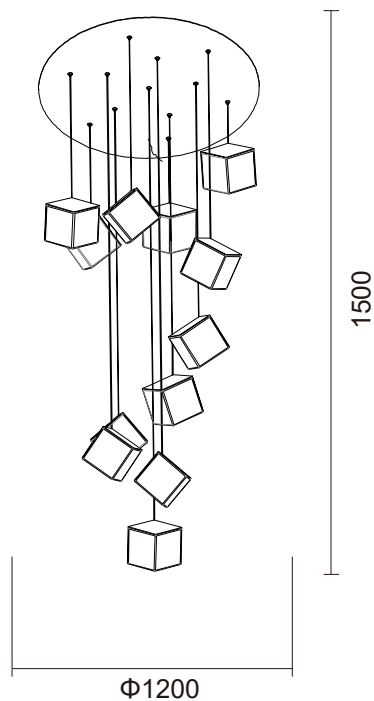

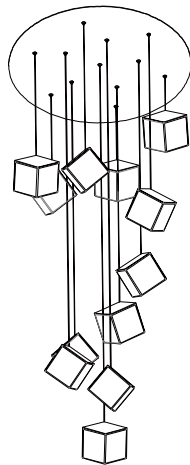

## Description:

Ceiling Lamp

## Main material:

Glass + stainless steel + aluminum

## Specification

Protection from corrosion: Iron surfaces are prone to rust and corrosion when exposed to moisture and other environmental factors. Spray painting provides a protective layer that helps prevent corrosion and prolongs the lifespan of the material.  
IP 20

## Applications

- . Hotel
- . Drawing room
- . Corridor

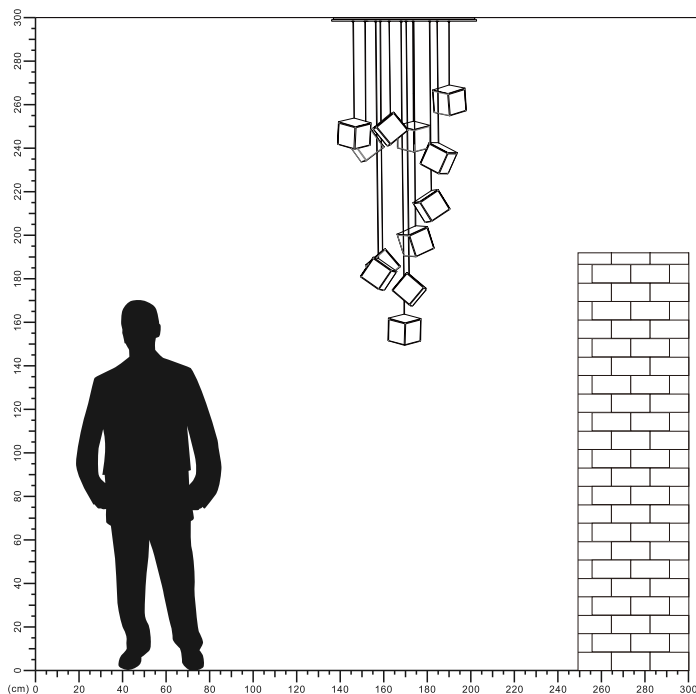

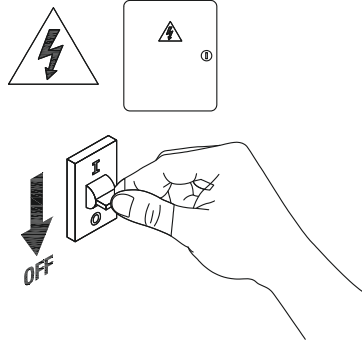
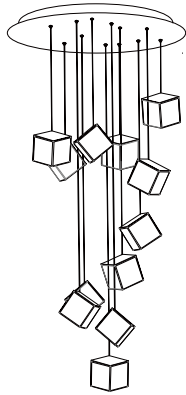

**1**

**Turn off The Power**

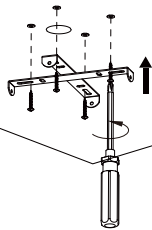

**2**

**Fixed hanging plate**

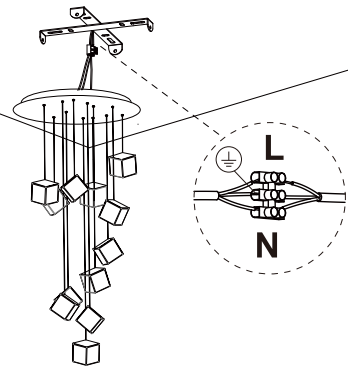

**3**

**Connect the cable**

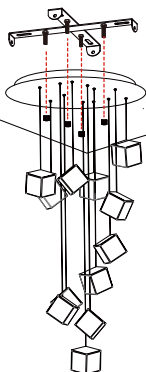

**4**

**Fixed hanging plate**

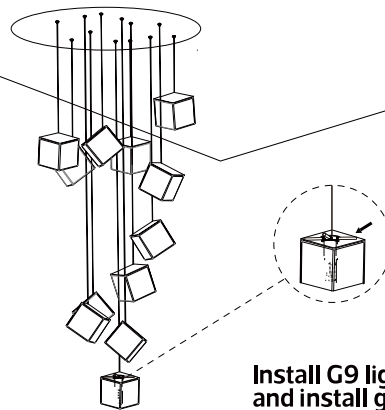

**5**

**Install G9 light source  
and install glass cover**

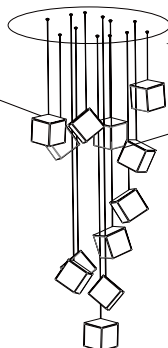

**6**

**Installation completed**

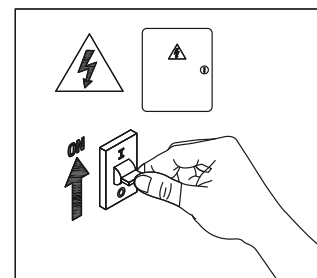

**7**

**Turn on the power**

