

Ceiling Lamp

ME-ICLS003-8

IP20



Model No	Cap Type	Color	kg
ME-ICLS003-8	G9*10 (Max Size $\Phi 40\text{mm}$)	Chrome	14.3

Dimensions in mm

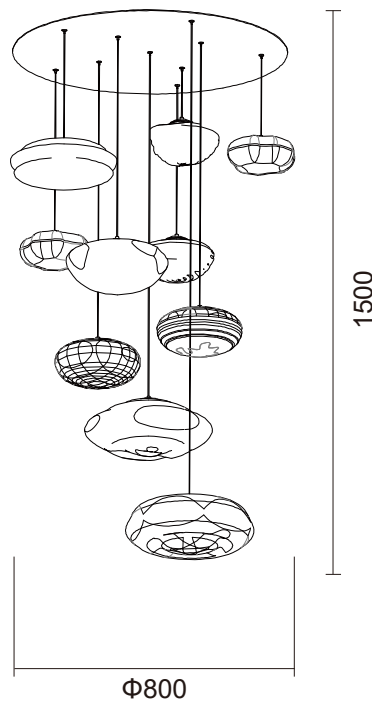

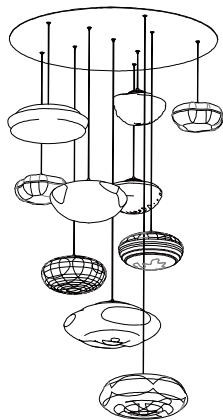

Description:

Ceiling Lamp

Main material:

Stainless steel + Glass+Aluminum

Specification

Protection from corrosion: Iron surfaces are prone to rust and corrosion when exposed to moisture and other environmental factors. Spray painting provides a protective layer that helps prevent corrosion and prolongs the lifespan of the material. IP 20

Applications

- . Hotel
- . Drawing room
- . Corridor

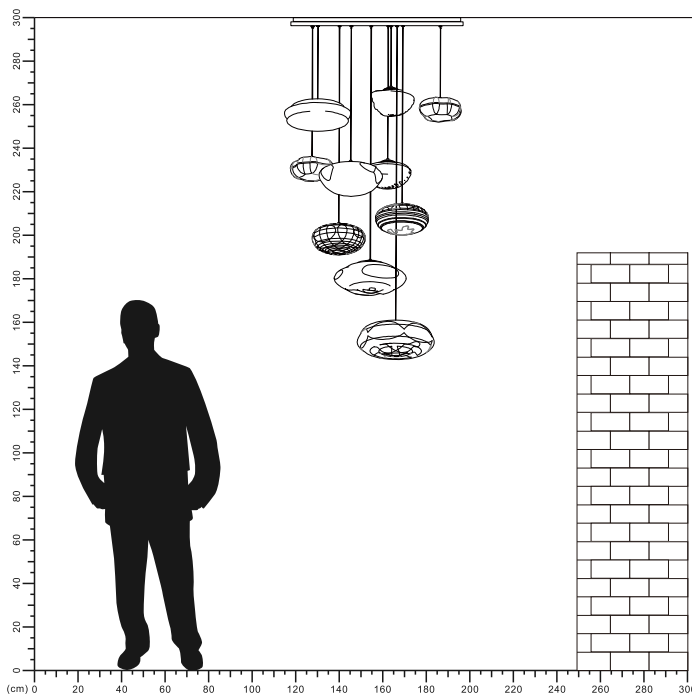

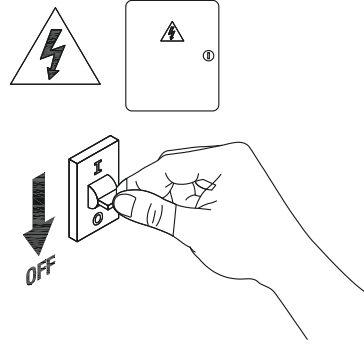
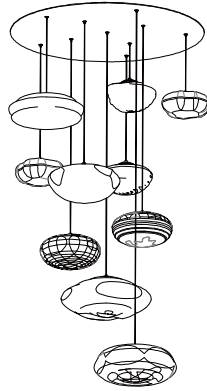

1

Turn off The Power

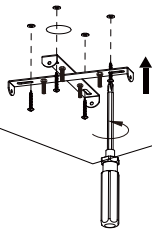

2

Fixed hanging plate

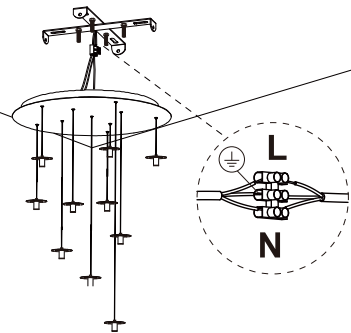

3

Connect the cable

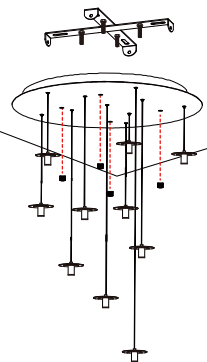

4

Fixed hanging plate

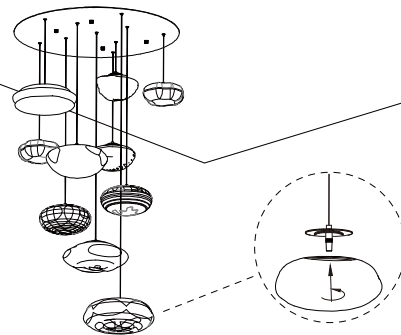

5

Install G9 light source and install glass cover

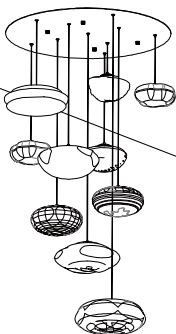

6

Installation completed

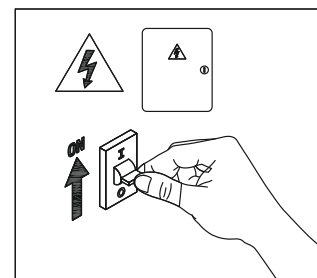

7

Turn on the power

