

Wall Lamp

ME-IWLS1802-2

IP20



Model No	Cap Type	Color	Dimensions in mm			
			A	B	C	
ME-IWLS1802-2	E14*3	Gold	220	115	350	1.8

Dimensions in mm

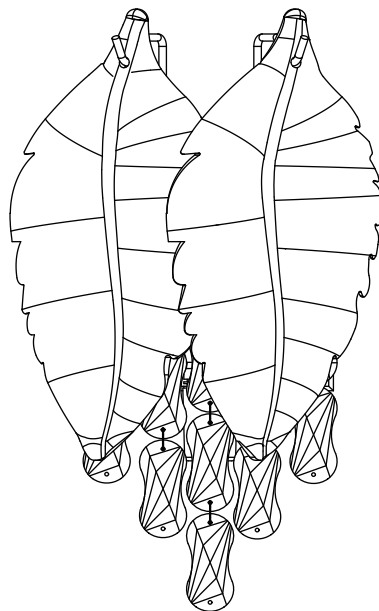

A

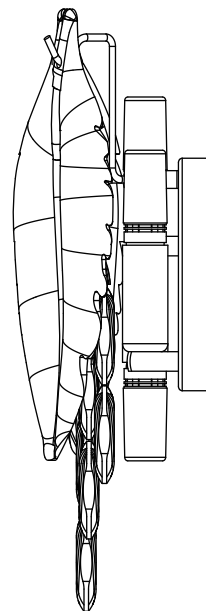

B

C

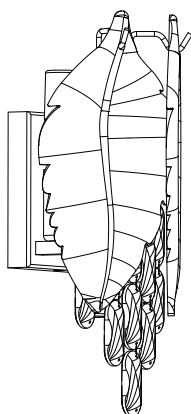

Description:

Wall Lamp

Main material:

Iron+glass+crystal

Specification

High quality iron lamp body, electroplating process, long-lasting durability, and strong load-bearing capacity. Handmade glass lampshade, clearly layered, made of high temperature fusion, pure and free of impurities. Selected high-quality crystal, clear and translucent, high refractive index, bright light effect, soft and not dazzling. IP 20

Applications

- . Living room
- . dining room
- . bedroom

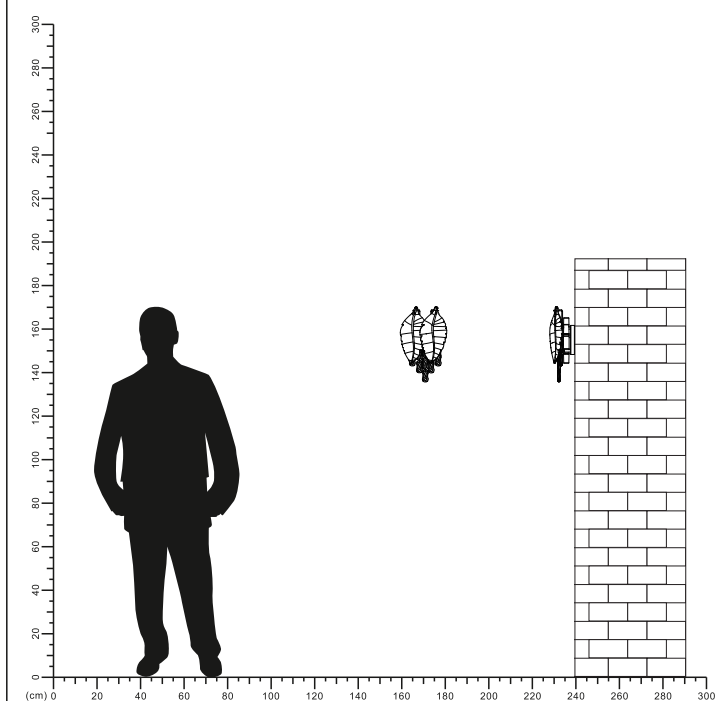

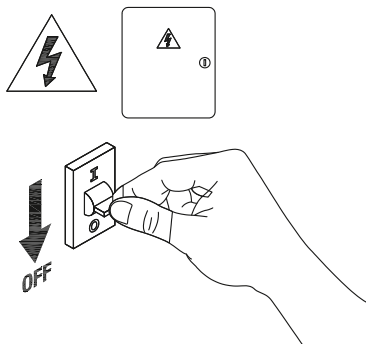

1

Turn off The Power

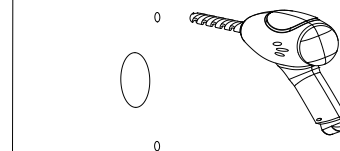

2

Drill two holes in the wall

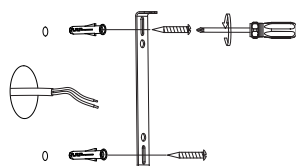

3

Fix the hanging plate

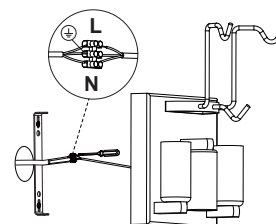

4

Connecting the power cord

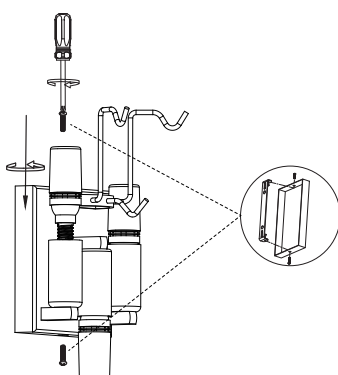

5

Fix the lamp body and Install E14 bulb

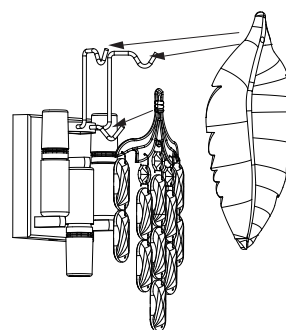

6

Install crystals

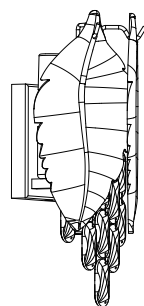

7

Installation completed

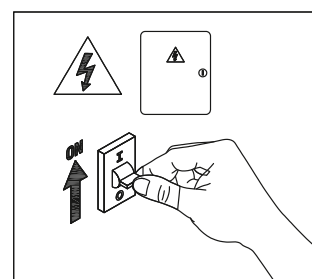

8

Turn on the power

