

LED Wall Lamp

ME2028B ME2029B
IP20

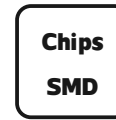
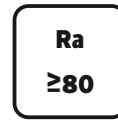

Item Code	P (W)	CCT (K)	Output (lm)	lm/w	Dimensions in mm			kg
					A	B	C	
ME2028B	7	3000	385	55	110	143	260	2
ME2029B	10	3000	550	55	110	143	460	3.45

Dimensions in mm

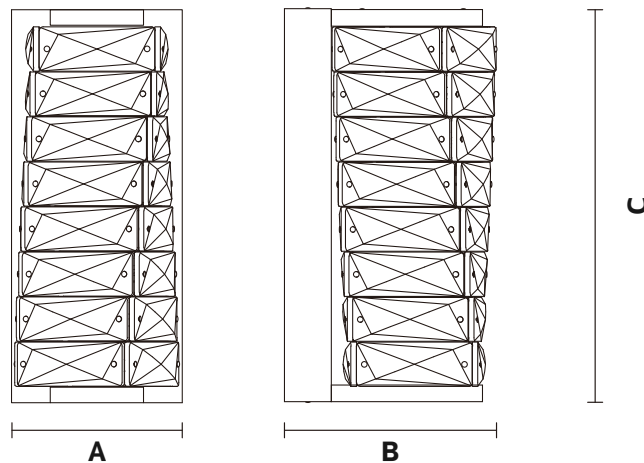

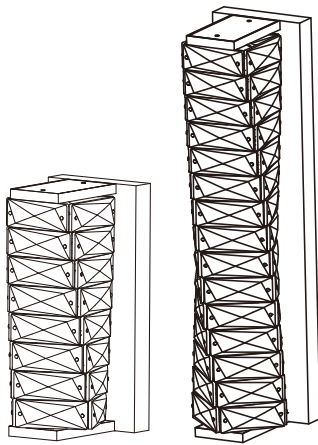
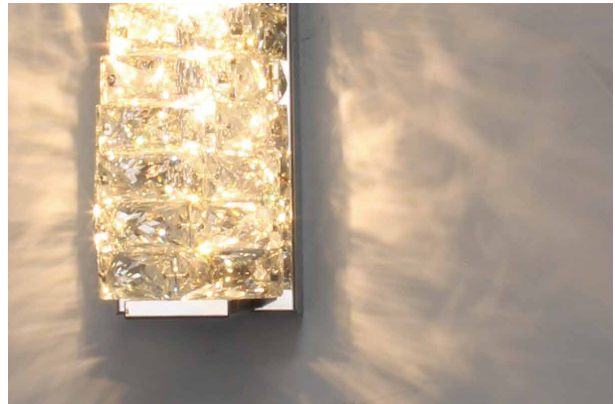

Description:
LED Wall Lamp

Main material:
Aluminum+Acrylic

Specification
Energy saving, up to 85% energy saving comparing to standard halogen and incandescent lamps High quality light, high color rendering, less heat, no UV or IR radiation LED driver is included IP20

Applications
. Hotel
. Drawing room
. Dar

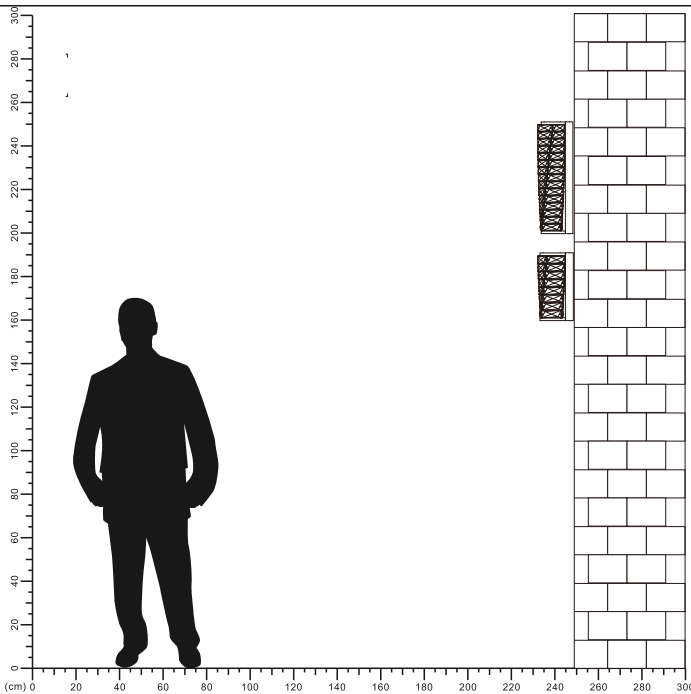

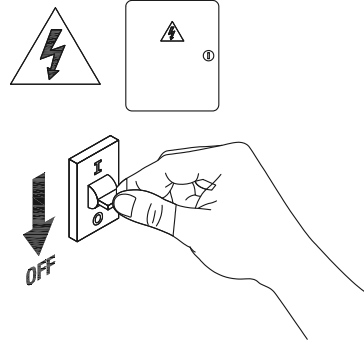
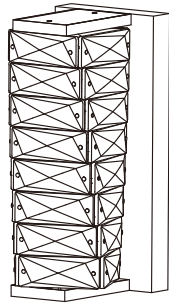

1

Turn off The Power

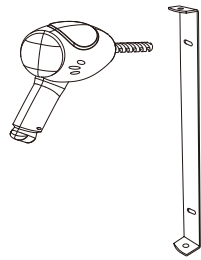

2

Drill 2 holes on the wall

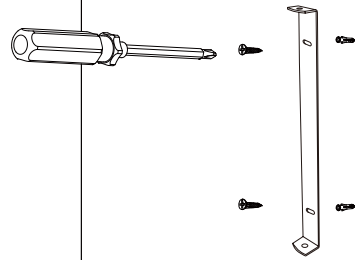

3

Install base plate

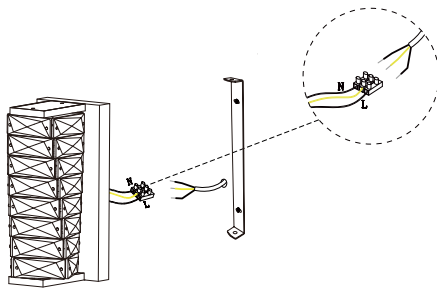

4

connect the cable



5

Fix the lamp to the wall

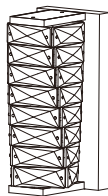

6

Installation completed

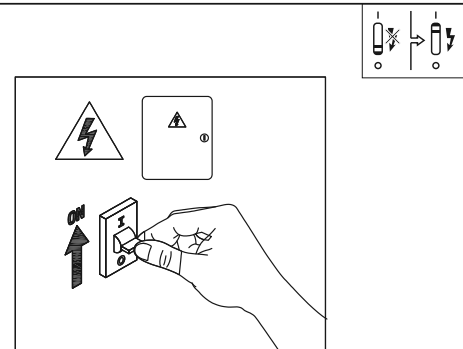

7

Turn on the power

