

LED Wall Lamp

ME2039A

IP20

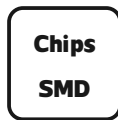
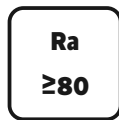

Item Code	P (W)	CCT(K)	Output (lm)	lm/w	Dimensions in mm			kg
					A	B	C	
ME2039A	12	3000	576	48	1200	220	51	0.68

Dimensions in mm

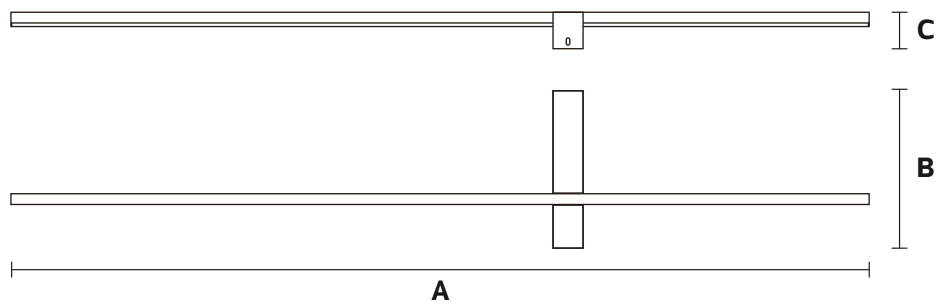



Description:
LED Wall Lamp

Main material:
Iron+Silicone

Specification
Energy saving, up to 85% energy saving comparing to standard halogen and incandescent lamps High quality light, high color rendering, less heat, no UV or IR radiation LED driver is included IP20

Applications
. Hotel
. Drawing room
. Dar

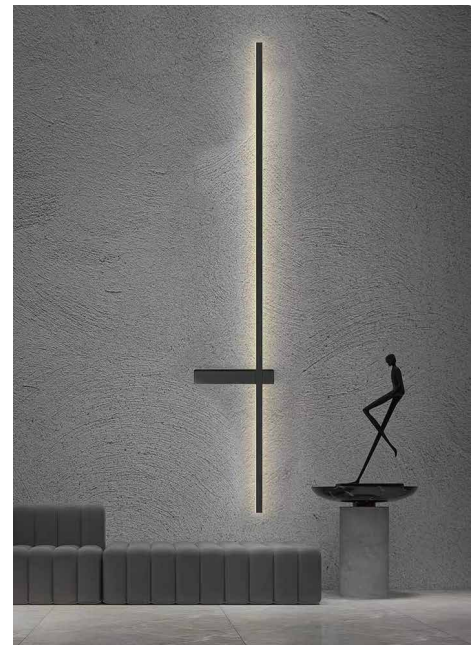
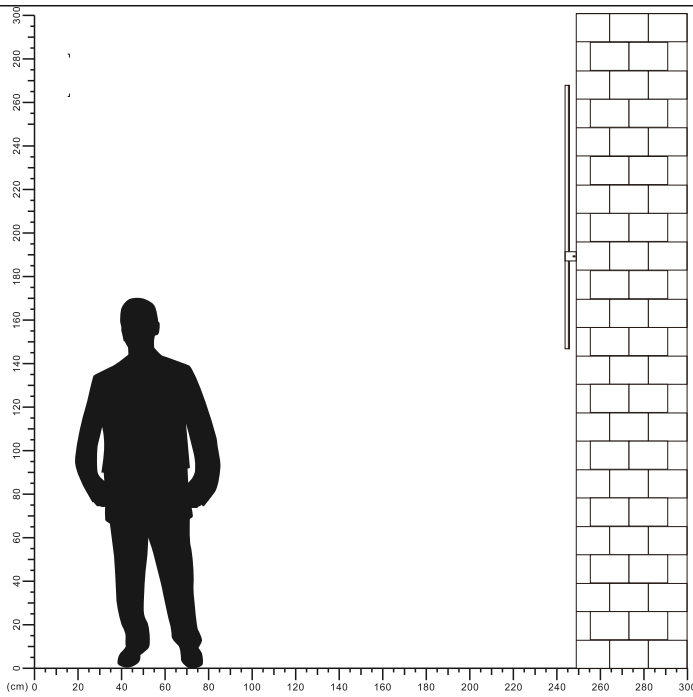

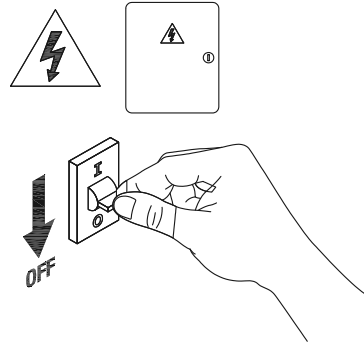

1

Turn off The Power

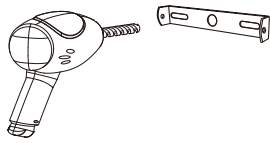

2

Drill 2 holes on the wall

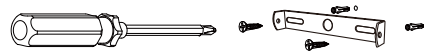

3

Install base plate

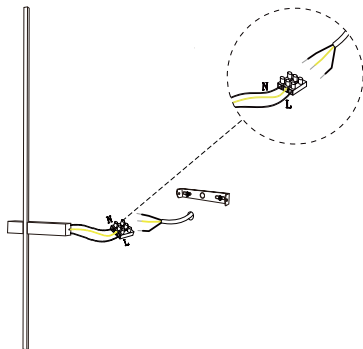

4

connect the cable

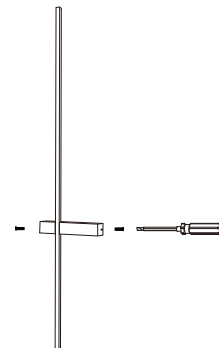

5

Fix the lamp to the wall



6

Installation completed

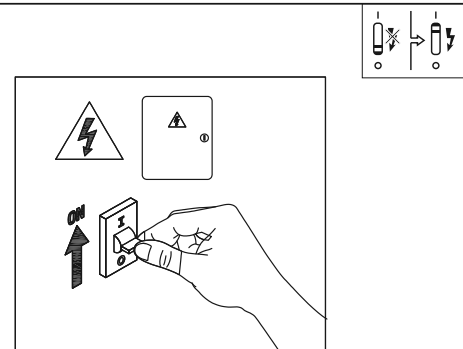

7

Turn on the power

