

LED Ceiling Lamp

ME2058B

IP20

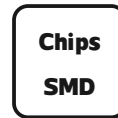
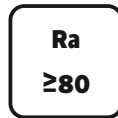

Item Code	P (W)	CCT (K)	Dimensions in mm		kg
			A	B	
ME2058B	40W	3000	Φ600	1000	2.7

Dimensions in mm

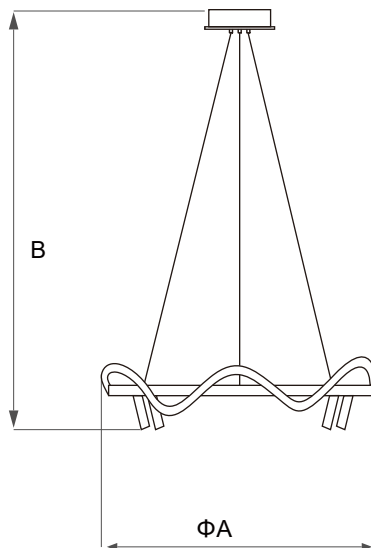

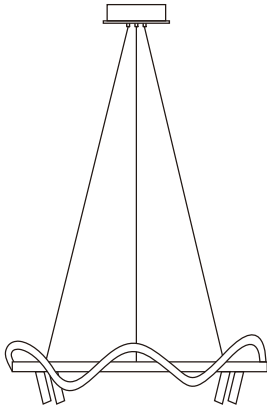

Description:
LED Ceiling Lamp

Main material:
Acrylic+Aluminum

Specification

Special tree branch shape appearance, simple but full of personality and creative, randomly match the scene.
IP20

Applications

- . Hotel
- . Drawing room
- . Corridor

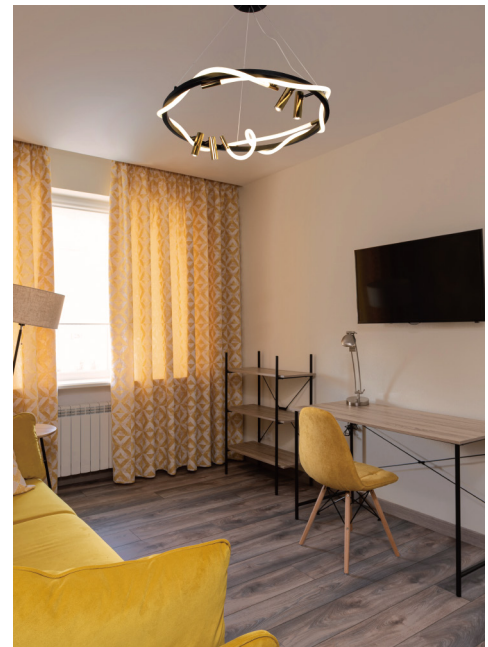
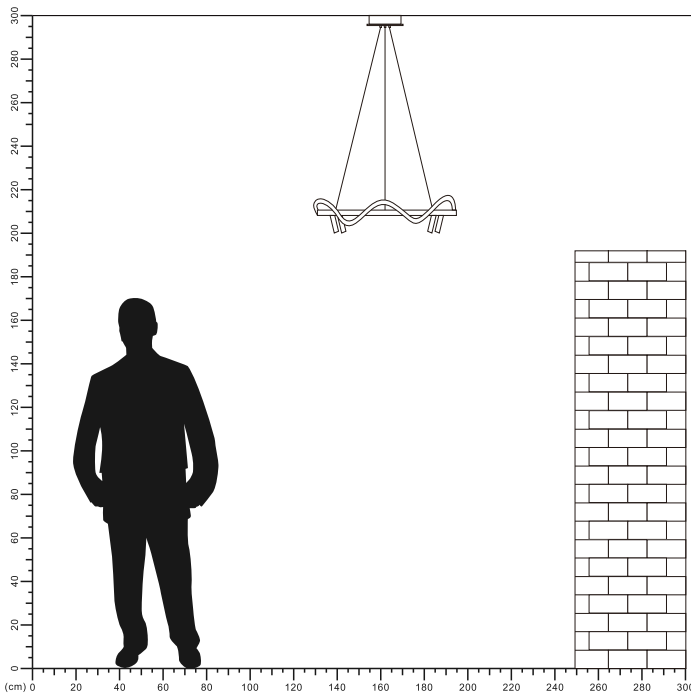

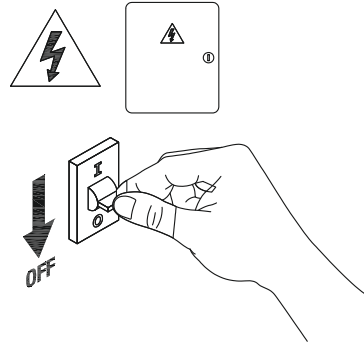
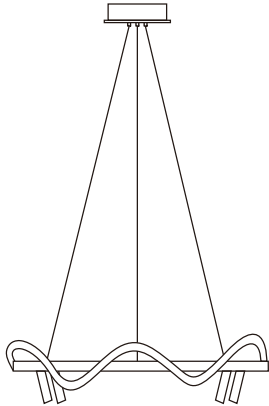

1

Turn off The Power

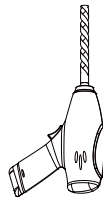

2

Drill 2 holes on your ceiling

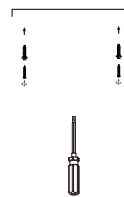

3

Install base plate

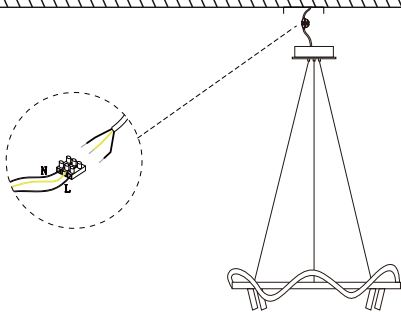

4

connect the cable

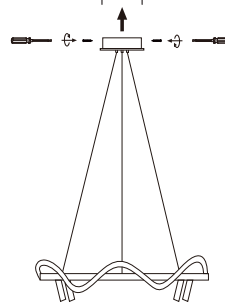

5

Install the ceiling lamp on the base plate

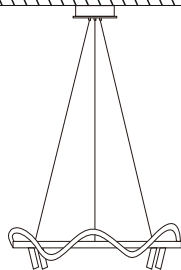

6

Installation completed

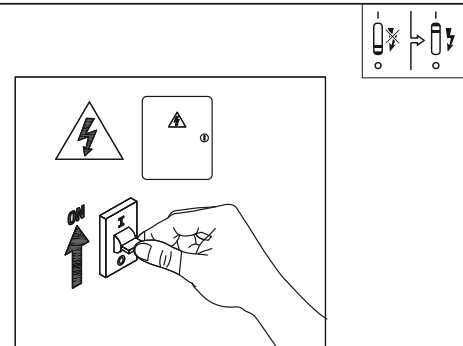

7

Turn on the power

