

LED Wall Lamp

ME2067B

IP20

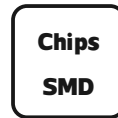
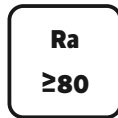

Item Code	P (W)	CCT(K)	Color	Dimensions in mm			kg
				A	B	C	
ME2067B	7	3000	Gold	215	70	370	1.52

Dimensions in mm

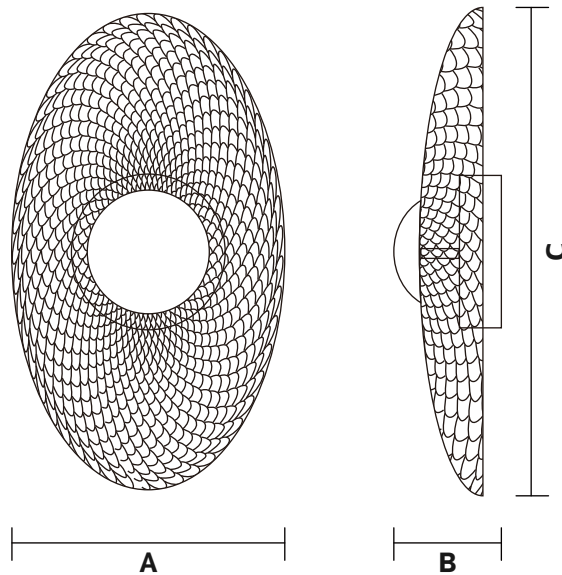

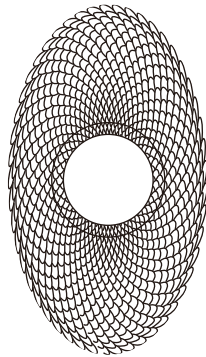

Description:
LED Wall Lamp

Main material:
Glass

Specification
Energy saving, up to 85% energy saving comparing to standard halogen and incandescent lamps High quality light, high color rendering, less heat, no UV or IR radiation LED driver is included IP20

Applications
. Hotel
. Drawing room
. Dar

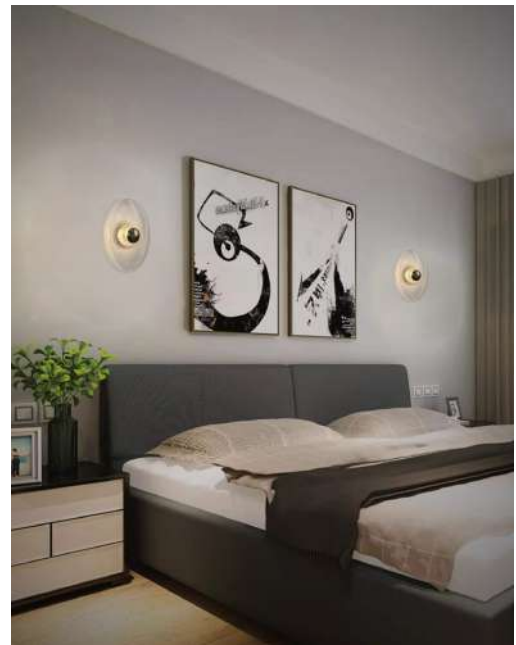
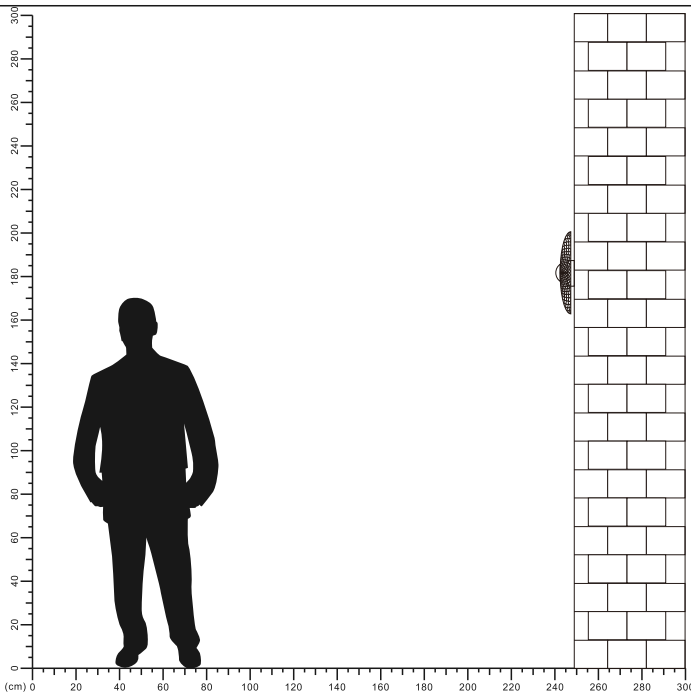

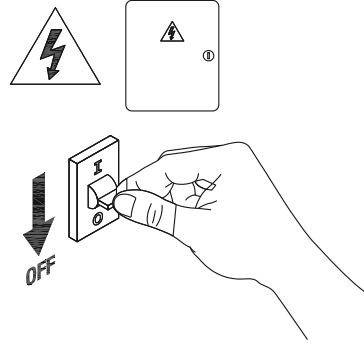
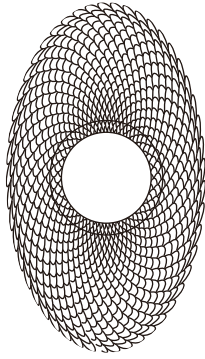

1

Turn off The Power

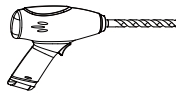

2

Drill 2 holes on your ceiling

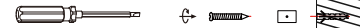

3

Install base plate

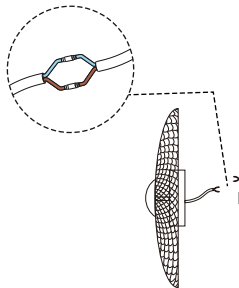

4

connect the cable

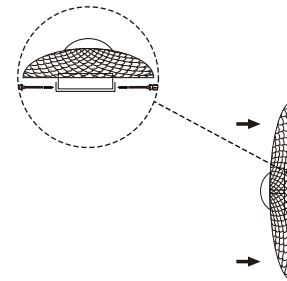

5

Install the ceiling lamp on the base plate



6

Installation completed

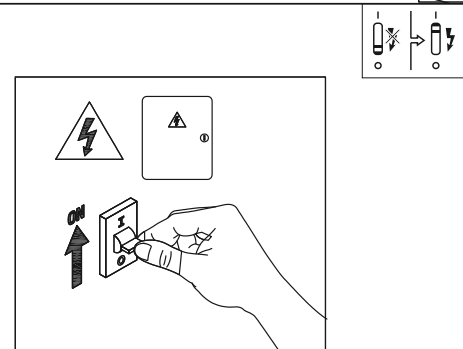

7

Turn on the power

