

LED Ceiling Lamp

ME-ICL0005-55 ME-ICL0108-60

IP20

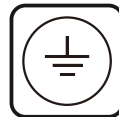
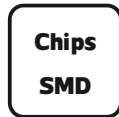
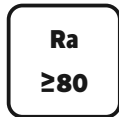
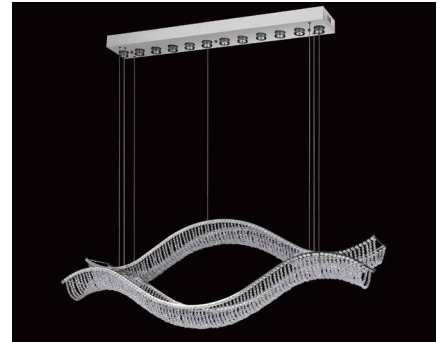

Model No	P (W)	Output (lm)	lm/w	CCT(K)	Color	Cap Type	Lamp Type	Dimensions in mm			kg
								A	B	C	
ME-ICL0005-55	55	3025	55	3000	Chrome	GU10*12 Max.6W/Cap	MR16	1500	400	1500	15
ME-ICL0108-60	60	3300	55	3000	Chrome	GU10*16 Max.6W/Cap	MR16	2000	400	2000	19.5

Dimensions in mm

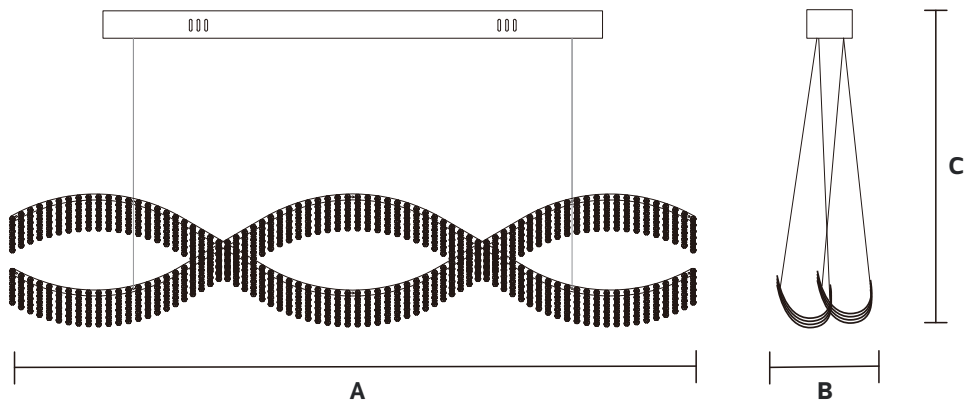

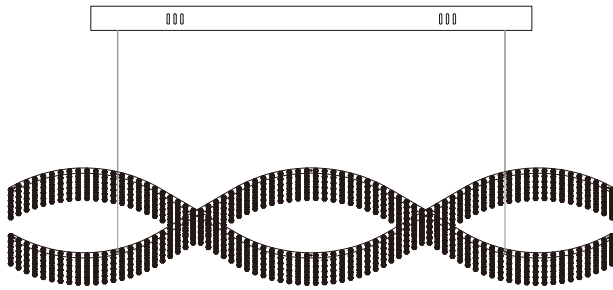

Description:
LED Ceiling Lamp

Main material:
Stainless steel + iron + crystal

Specification
Special tree branch shape appearance, simple but full of personality and creative, randomly match the scene.
IP 20

Applications
. living room
. dining room
. bedroom

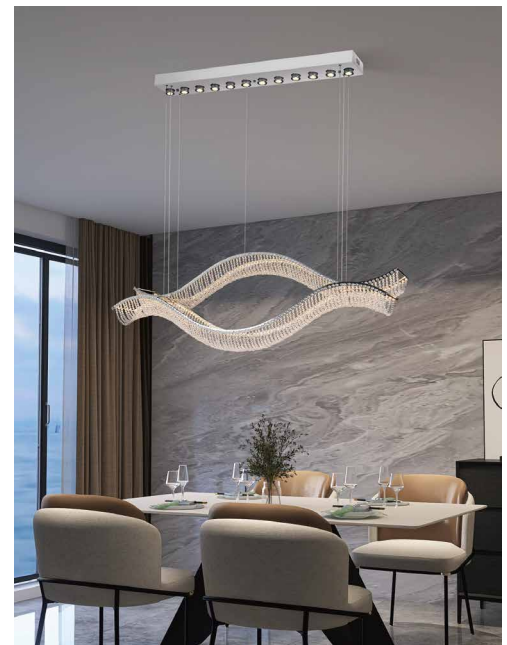
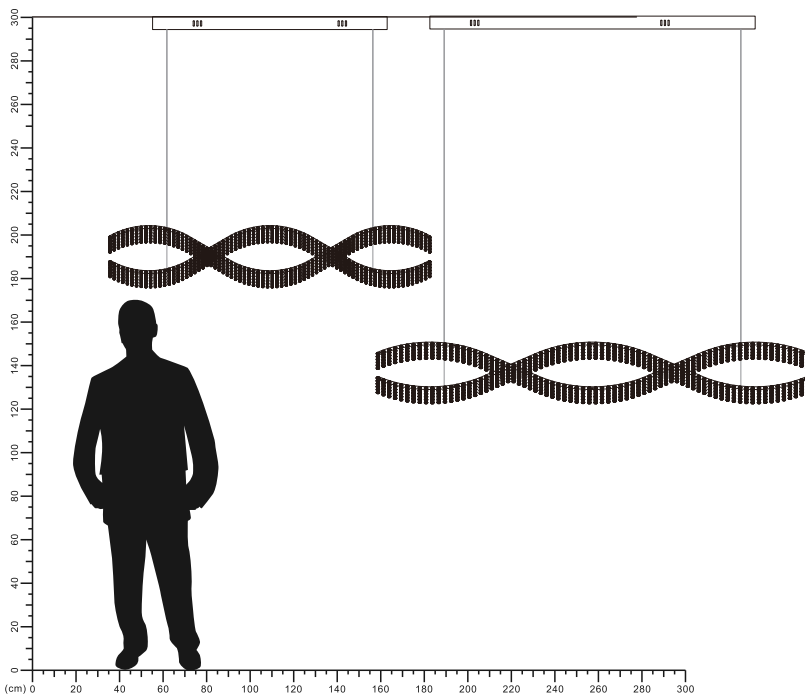

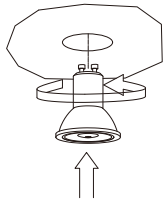

Chassis mounted GU10 light source

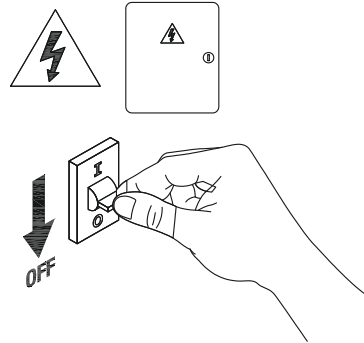

1

Turn off The Power

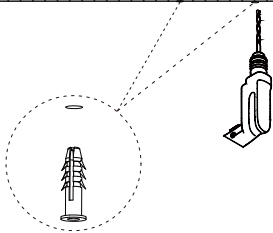

2

Drill holes in the wall insert expansion screws

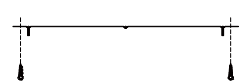

3

Fixing ceiling screw

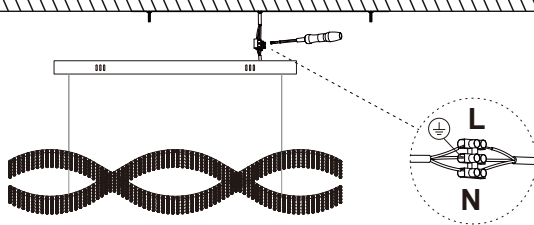

4

connect the cable

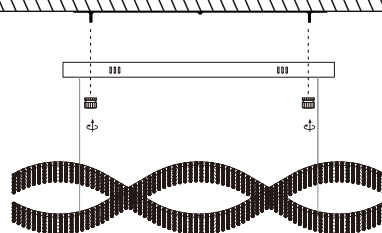

5

Fixing screw

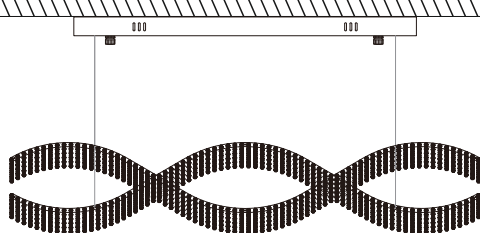

6

After installation, the length of the wire can be adjusted according to the floor height

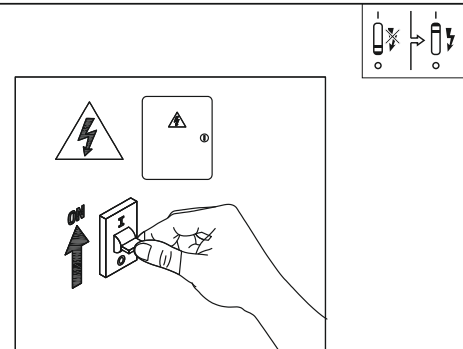

7

Turn on the power

