

## Ceiling Lamp

ME-ICL1502-1  
ME-ICL1503-1  
IP20



Model No	Cap Type	Color	Size(mm)	kg
ME-ICL1502-1	E14*8	Chrome	500*500*Max1650	10
ME-ICL1503-1	E14*16	Chrome	500*500*Max1650	15

### Dimensions in mm

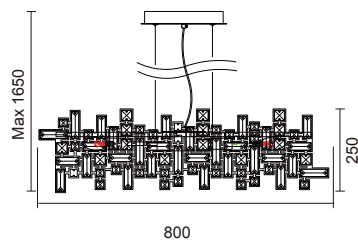
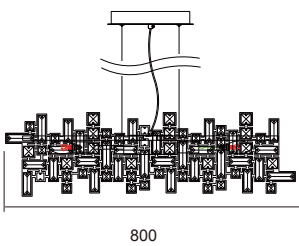

ME-ICL1503-1

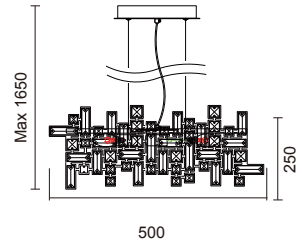
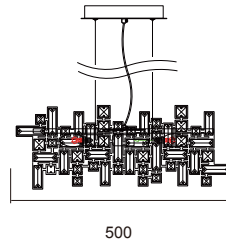

ME-ICL1502-1

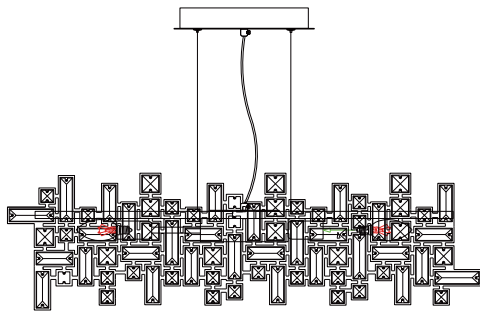

**Description:**

Ceiling Lamp

**Main material:**

Stainless steel + Glass

**Specification**

Protection from corrosion: Iron surfaces are prone to rust and corrosion when exposed to moisture and other environmental factors. Spray painting provides a protective layer that helps prevent corrosion and prolongs the lifespan of the material. IP 20

**Applications**

- . Hotel
- . Drawing room
- . Corridor

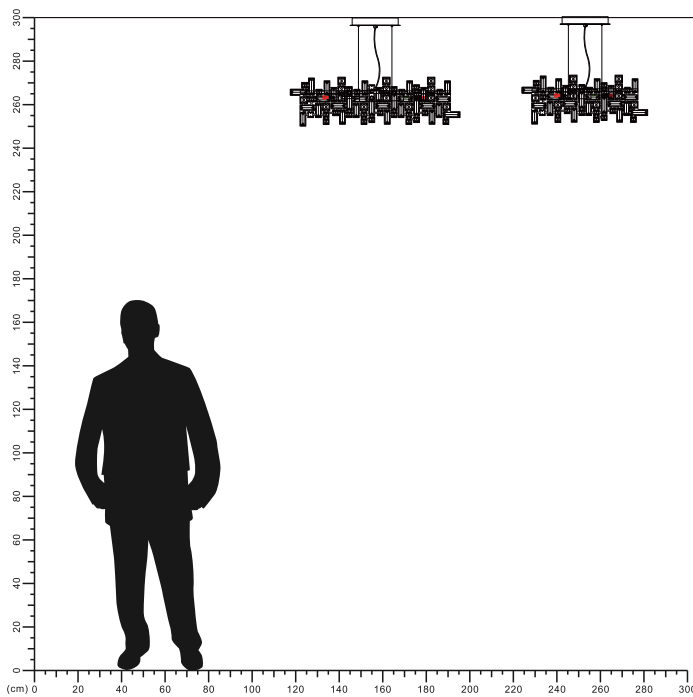

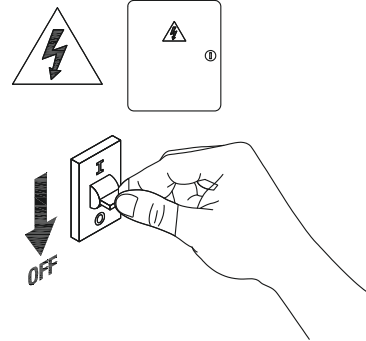
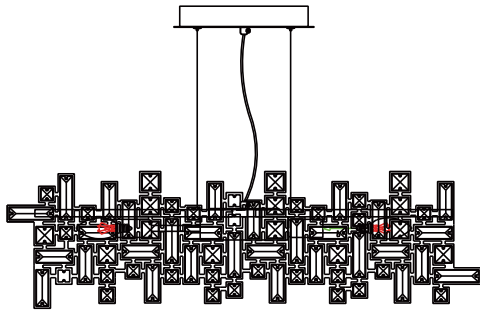

**1**

**Turn off The Power**

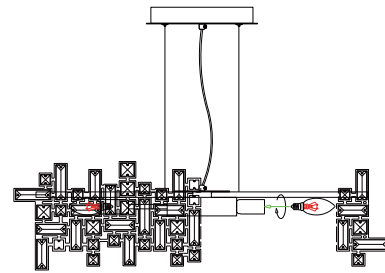
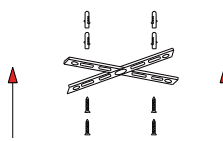

**2**

**Drill 2 holes on your ceiling and  
Fixing ceiling screw**

**3**

**Install E14 bulbs**

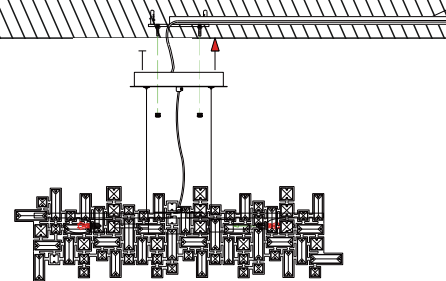
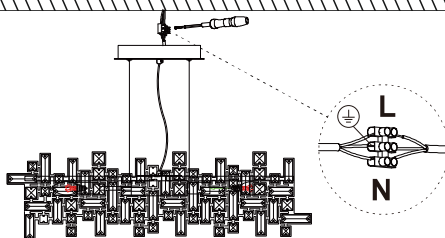

**4**

**Connect the cable**

**5**

**Fixing the screw**

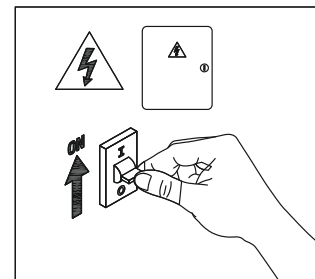
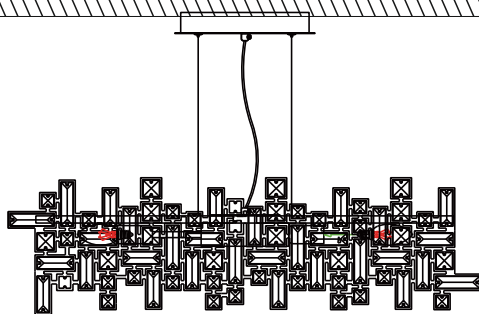

**6**

**Installation completed**

**7**

**Turn on the power**

