

SMART CLOCK DIFFUSER



- Wi-Fi Control
- App Control
- Voice Control
- Mist Adjustable
- Scheduling Program
- Set Timer
- Running Time
- Auto Shut-Off
- Capacity
- Touch Screen
- Temperature Display
- Scope of Application

Item Code	Input	Output	Power	
MS-AD102-W-BR	AC 100-240V	DC 24V/0.5A	12W	0.46

Dimensions in mm

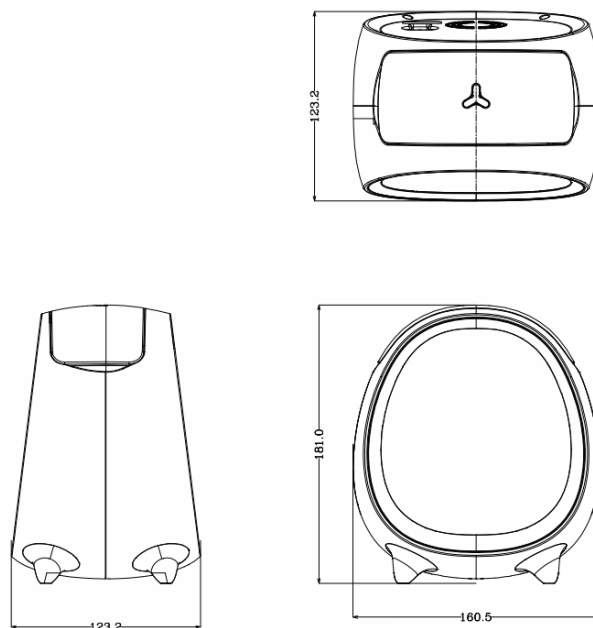

Function

Step 1

This aroma diffuser uses ultrasonic waves to instantly vaporize water and essential oil in the tank, to produce a cool, moist fragrant mist.

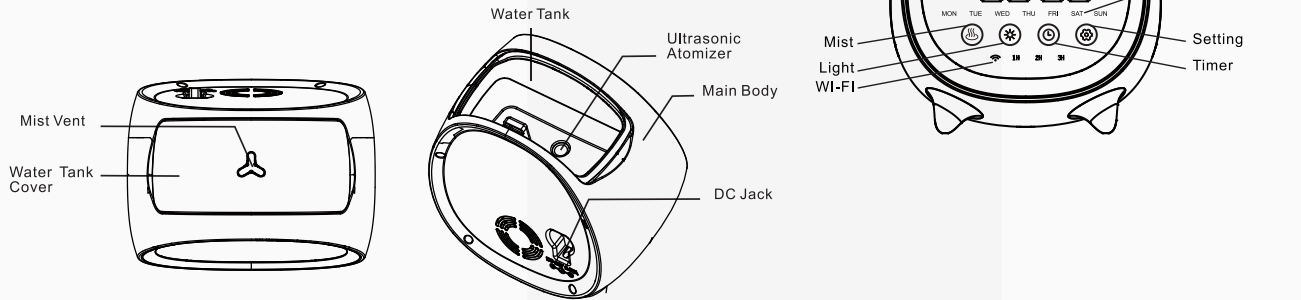

Function indication of diffuser button:

- Mist: Turns the mist function of the unit on, in three levels: High/Low/Off.
- Light: Turns the light function of the unit on, in two levels: On/Off.
- Timer: The amount of time to run the unit for, set to "On" by default: 1 H/2H/3H/On (Continuous).
- Setting: Tap more than 3 seconds, change from normal mode to AP mode.

Function Description:

- 1 Weather display: Display local real-time weather.
- 2 Temperature display: Display local real-time temperature, the unit (Cels and Hua Celsius) can be based on local standards.
- 3 Time and week display: Synchronize with local network time.

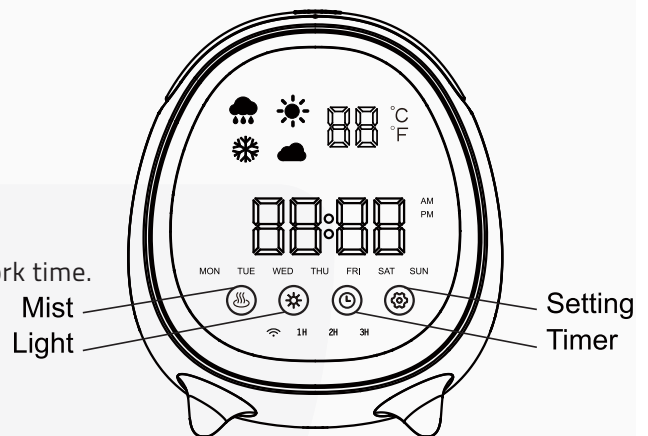

On screen display, only when Wi-Fi is connected, the corresponding functions will be displayed, and synchronized with the settings on APP.

How to use the Diffuser:

①

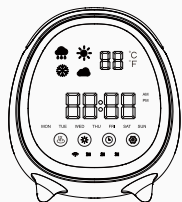

Place diffuser in stable location, open the cover and take out the adapter.

②

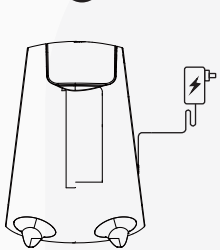

Powered on.

③

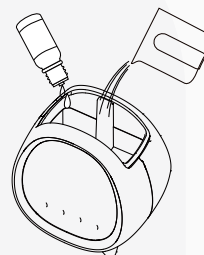

Add water and essential oil and recover the lid.

④

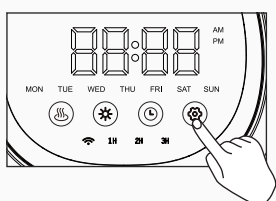

Touch physical buttons to control the functions.

⑤



Download "Meshkatech" APP to control.

⑥

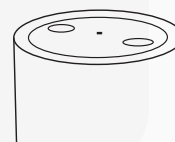

Also can use the Google home and Amazon Alexa to control.

Step 2

APP's user manual

- Download and install APP: Search "Meshkatech" in application market to download and install the APP.
- Register: register an account with your E-mail or sign in with verification code by SMS.
- Enter the APP, tap "+" in the upper right of the page to enter network connection page, choose the "Aroma Diffuser" in "Small Home Appliances".
- There are two network connection methods (normal mode and AP mode), If normal mode is default, users could tap the upper right corner to switch the connection method to AP mode. For normal mode: please make sure the device's indicator light rapidly flashes(2 times per second), tap to go on to the next step. If not, please tap the setting button in diffuser for more than 3 seconds to change to rapidly flashes.
- For the AP mode: please make sure the device's indicator light slowly flashes(1 time every 3 seconds), tap to go on to the next step. if not, tap the setting button in diffuser setting button more than 3 seconds to change to slowly flashing.
- Enter WI-FI password: Select the WI-FI under which device is working, enter password and tap "CONFIRM" to enter network connection process.
- Control device: after successfully configuring the devices, the smart device will be shown on the home page, tap to enter its control page. the diffuser will show the Weather, temperature, time, week.

Quick Guide of Using Amazon Echo to Control Smart Devices

- Search "Amazon Alexa" in App Store or Google Play to install the app.
 - Make sure your Echo device is energized. Open the Alexa app by tapping the app icon on your mobile device. Type in your Amazon account and password, then tap "SIGN IN".
 - Tap the hamburger menu on the top left corner, select "Settings", then tap "SET UP A NEW DEVICE".
 - Select your Echo model, choose a proper language, then tap "CONNECT TO WI-FI".
 - Long press the dot button on the top of your Echo device until the orange light shows up, then tap "CONTINUE". When your phone is connected to Echo, tap "CONTINUE".
 - Select a Wi-Fi to let Echo have the access to the Internet. Type in the Wi-Fi password, then tap "CONNECT". Echo may take several minutes to connect the network.
 - Tap "CONTINUE" when Echo is connected to the network. After an introduction video, tap "CONTINUE" to finish the setup.
 - Tap "Skills" in the hamburger menu, then search "Meshkatech". Select "Meshkatech" and tap "ENABLE" to enable the Skill.
 - You will be redirected to the account link page. Type in your Meshkatech account and password, don't forget to select the country/region where your account belongs to. Then tap "Link Now" to link your Meshkatech account. The country/region, the account, and the password must match with the exact contented.
 - Echo needs to discover your smart devices before it controls them. You can say "Alexa, discover devices" to Echo. Echo will discover devices which have already been added in the Meshkatech app. You can also tap "DISCOVER" to discover the smart devices. Discovered devices will be shown in the list. Now you can control your smart devices through Echo.
- Note: The use of "Google Home" to control smart device operation guidelines is similar to Amazon Alexa operation, which can be set according to boot settings.

Step 3

Cleaning & Storage

Periodic maintenance is necessary to maintain the safety of this machine. Follow the care instructions below. You should clean and maintain the unit after each 5 to 6 time uses, or every 2 to 3 days, as a guideline.

- 1 Cut off the power and then remove the tank cover, always place the unit on a stable, flat surface and ensure that it is not tilted.
- 2 Drain the remaining water in the water tank.
- 3 Wipe using a cloth dripped in mild detergent dissolved in warm water and wrung well. Use a cotton ball to care for the ultrasonic plate on the bottom of the water tank. Use a cloth or cotton ball to care for the unit cover. Caution: Don't directly touch or apply a strong force to the ultrasonic plate on the bottom center of the water tank.
- 4 After you have cleaned the water tank, add tap water it and operate the timer for 30 minutes. Drain, wipe dry and then dry thoroughly.
- 5 To remove essential oil or dirt adhered to the outside of the unit cover or water tank, wipe with a cloth that has been dipped in mild detergent dissolved in warm water and wrung well.
- 6 If dirt accumulates near the nozzle, remove the unit cover and tank cover and wash with mild kitchen detergent. Hold the tank cover and shake to remove the water inside, naturally dry before next use.
- 7 Make sure that no hair or dust is on the air intake filter on the bottom. Use your hand or a cotton swab to remove any hair or dust. Caution: The filter cover cannot be removed.

Caution: Always use mild detergent to clean. Chlorine, acid and enzyme-type detergents remaining inside pose the danger of emitting noxious gases. If mist emission is interrupted during use, use a cotton swab to clean the vent of the ultrasonic plate nozzle and the air intake.

Step 4

Safety Information

Please read and follow these instructions, be aware of all warnings, and keep this document for future reference.

- Set up your product in accordance with product manual and place your product in a stable location or it will fall and cause product damage or bodily harm.
- Prohibition: Do not place on an uneven surface, a high location such as a shelf, or an unstable location. Water spilled when the unit is knocked over them may result in damage to the unit and injury.
- Do not use your product near water, including dripping or splashing (e.g. Indoor fountain), or near object filled with liquids, such as flower vase or fish tanks.
- Do not use your product near heat sources (e.g. radiators, heat registers, stoves, open flame, such as lighted candles, or other heat producing devices, such as audio amplifiers or TVs).
- Do not insert or remove the AC adapter with wet hands. Doing so may cause electric shock or injury.
- Do not immerse the unit or AC adapter in water or get it wet. Doing so may cause electric shock or injury.
- Do not use AC adapter near heat resources, do not damage, bend, pull or twist the power cord of the AC adapter excessively. Doing so may damage the power cord and may cause fire or electric shock.
- Do not use the power cord of the AC adapter or plug when it is damaged or when receptacle of the outlet is loose. Doing so may cause electric shock, short circuit or spark a flame.
- If an abnormality such as an unusual smell or sound occurs in the unit or AC adapter, or the unit becomes unusually hot, or mist abnormally stops, immediately remove the AC adapter from the outlet and refrain from usage. If not, it may cause fire or electric shock.
- Do not block ventilation openings or put objects into product vents, ports or slots. Doing so may create an electric shock or fire hazard. Maintain a minimum distance of at least 15cm (6 inches) around your product for sufficient ventilation. Covering ventilation openings with items such as tablecloths or curtain may impede ventilation and cause a fire.
- Do not block the mist nozzle or the air intake on the bottom. Doing so may prevent proper operation which may result in damage, faulty operation, overheating or malfunction.
- All servicing and repair must be operated by qualified service personnel. Servicing is required when your product does not operate normally, the power cord/plug has been damaged, the product has been exposed to water, rain, liquid or moisture, the product has been dropped, or an object has been inserted into a product port or vent.
- Please do not disassemble and make any modifications to the product, this may lead to electric shock, fire or electric leakage.

Step 5

Precautions

- Draining direction — Follow the instructions in the User's Manual for proper cleaning method and draining direction.
- If drained in an incorrect direction, water may enter the unit electrical area inside and cause fire, electric shock or a short circuit.
- The temperature of the unit may be high during use and after it stops.

Troubleshooting

Please refer to the below in the event of the product operating abnormally.

Symptom	Possible Cause	Solution
Will not switch on or switch off early	<ul style="list-style-type: none">-Is there enough water in the tank?-Are the power cables connected properly?	<ul style="list-style-type: none">- Add water to the tank-Disconnect, check cables and reconnect and try again.
No mist or abnormal mist	<ul style="list-style-type: none">-Not enough water?-Too much water?-Dirt on the ultrasonic plate?-Inner shell and outer shell are not installed properly?-Dirt on the air suction port on the underside of the base?	<ul style="list-style-type: none">-Add suitable amount of water in the tank.-Water must never be filled over 200ML (MAX) line.-Please refer to maintenance instructions, remove or re-install correctly, so vapors mist can be released freely.-Clean the air suction port .-Restricted airflow will affect mist.
Water leakage from product	<ul style="list-style-type: none">-Inner shell and outer shell are not installed properly?-Has the unit been tipped over?-Low temperature or high humidity?	<ul style="list-style-type: none">-Remove and reinstall correctly, so vapors can be released freely.-Follow accidental leakage instructions.-Under these conditions, the mist may condense quickly into water droplets.