

### 32A/45A D/P Switch

#### T-series

#### Technical specification

##### Electrical

Voltage rating:  
250V a.c.50Hz-60Hz

Current:  
32A/45A resistive

Switch:  
3mm contact gap  
Double pole operation -  
except socket switch on CCUs

Terminal capacity,45A Switches and CCUs;  
4X4mm<sup>2</sup>  
3X6mm<sup>2</sup>  
1X6mm<sup>2</sup>

Terminal capacity,32A Switch;  
3X2.5mm<sup>2</sup>  
2X4mm<sup>2</sup>  
1X6mm<sup>2</sup>

##### Physical

Ambient operating temperature:  
-5°C to +50°C  
(not to exceed an average of more than 25°C in  
any 24 hour period)

IP rating:  
IP2XD

Max.installation altitude:  
2000 metres

### Model:T1016



45A D/P switch

#### Dimensions(mm)

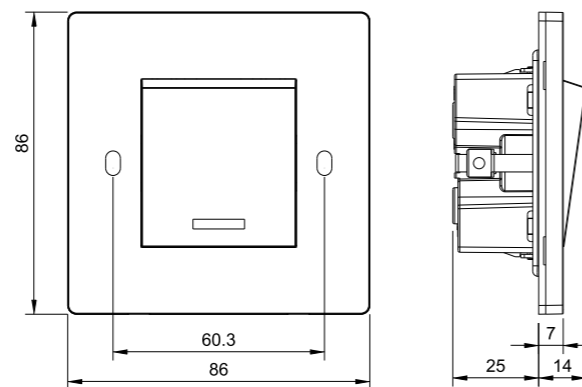

#### Wiring Instructions

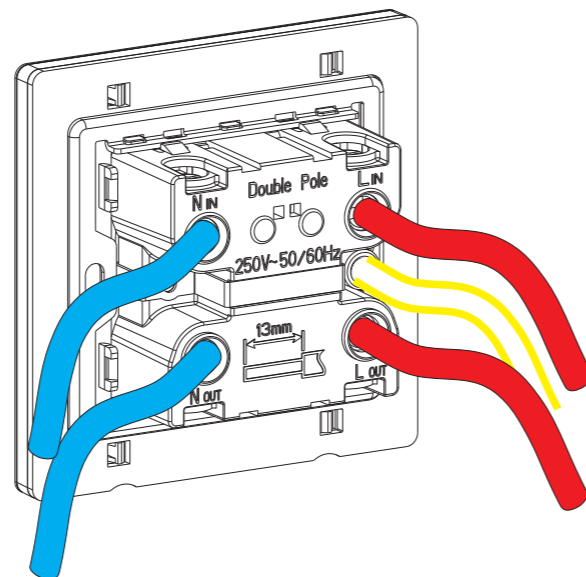

#### Neon indicators

Neon indicators can be included in the rockers of the switched connection units. In the case of unswitched units, they can be located centrally and uppermost on the face plate. Neon indicators are integrally wired into the product and do not require separate connection when installing. The design gives 170 visibility in the horizontal and vertical planes.

#### Fuse carriers

These are captive and are opened by a fast acting, screwdriver operated worm drive for ease of replacement.

#### Flex outlets

Bottom outlet types are supplied with blanking plug allowing use where the bottom outlet is not required. Spare blanking plugs are available. The products are equipped with very strong, push-fit nylon cord grips making installation safe, quick and easy.

NO	Name	Material	Specifications	Technical characteristics
1	Surface frame	PC	SABIC GE plastics	Can use in ocean weather and high temperature up to 130 celsius degree.PC and PA material V0 inflaming retarding .Strong hygroscopicity, excellent strength and durability
2	Middle frame	PC	SABIC GE plastics	
3	Rocker	PC	SABIC GE plastics	Difficult to make electrical spark ,our products can use in the moist weather.
4	Base	PA	PA+15% GF V0	
5	Cover	PA	PA+15% GF V0	Difficult to make electrical spark ,our products can use in the moist weather.
6	Stir	PA	PA+15% GF V0	
7	Indicator cover	PC	SABIC GE plastics	Big copper connector 5.5 gram, moisture resistance and stand wear and tear . Difficult to make electrical spark ,our products can use in the moist weather.
8	Copper cylinder	Brass	59 Copper particles	
9	Copper Rocker	Brass	Phosphor Copper	High hardness , wear-resisting.
10	Silver alloy contact	Silver	Silver&Copper composite	
11	Sliding contact	Brass	Phosphor Copper	6*11mm screw ,make the cable very fastness,surface gold-plating,prevent oxidation,improve the electrical conductivity
12	Screw	Iron	Carbon Steel	
13	Earth wire	Iron	Carbon Steel	1.0mm thickness
14	Spring	Iron	Spring steels	
15	PCB			

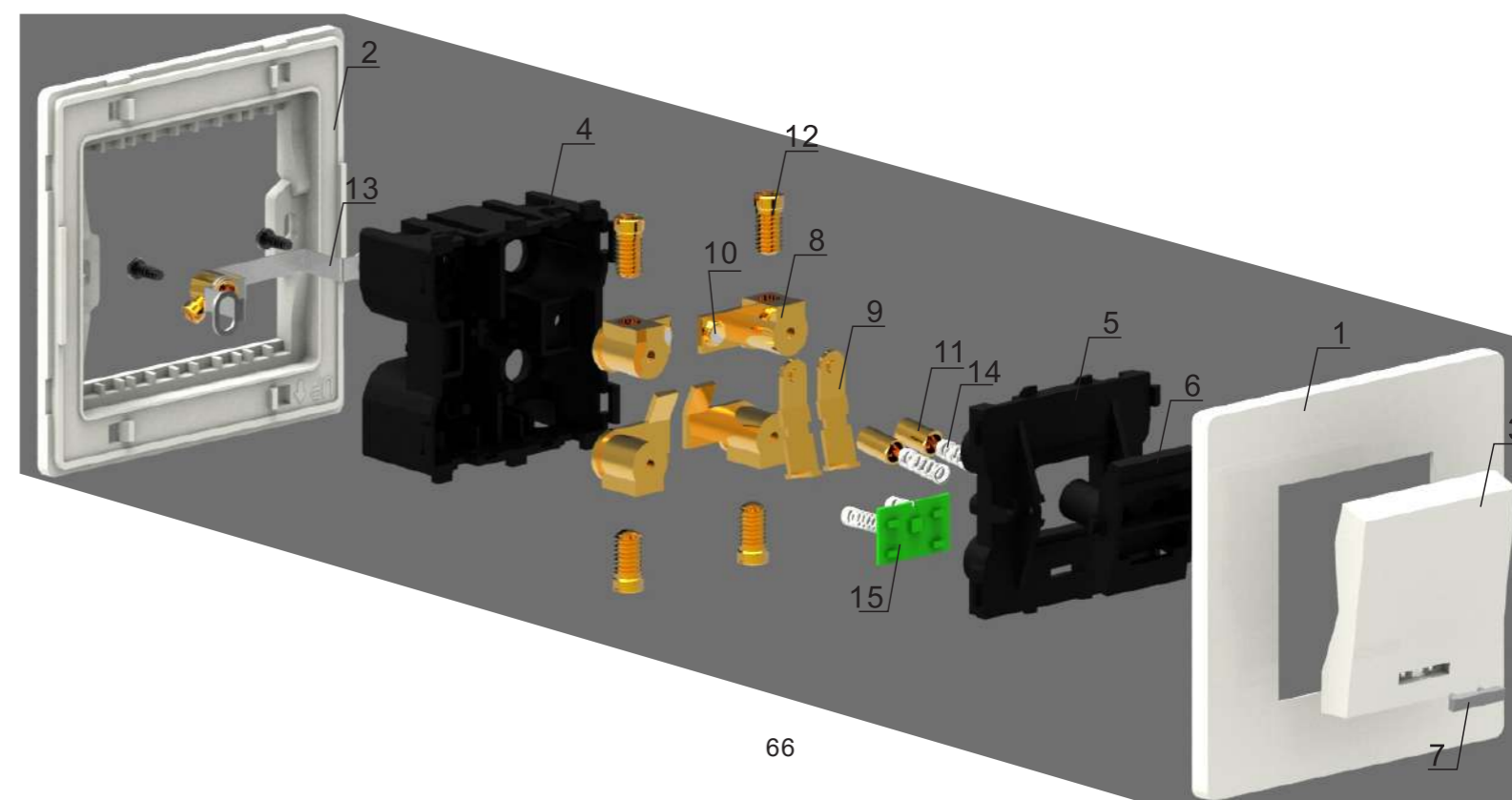

#### Features

- Positive switch action
- Positive double pole switch
- Toggle action switches
- Metal front plates available
- Replaceable neon indicators
- Wide product choice

#### Description

A range of switches and cooker control units harmonising with the Logic Plus style, suitable for the switching of all domestic, commercial and industrial appliances where higher current ratings are required, i. e. cookers, heaters, commercial refrigeration units etc. Metal units are particularly suitable for refurbishment projects.