

LED LINE LIGHT

NR-AL101-40-W-PC
IP20

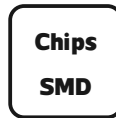
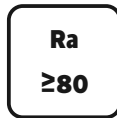
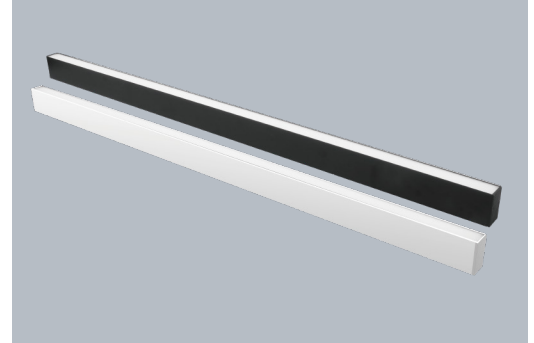

Item Code	P (W)	CCT (K)	Beam angle	Output (lm)	lm/w	Color	Dimensions in mm			kg
							A	B	C	
NR-AL101-40-W-PC	40	3000	120°	4510	112.7	Black/White	1204	33	60	1.15
NR-AL101-40-W-PC	40	4000	120°	4510	112.7	Black/White	1204	33	60	1.15
NR-AL101-40-W-PC	40	6500	120°	4510	112.7	Black/White	1204	33	60	1.15

Dimensions in mm

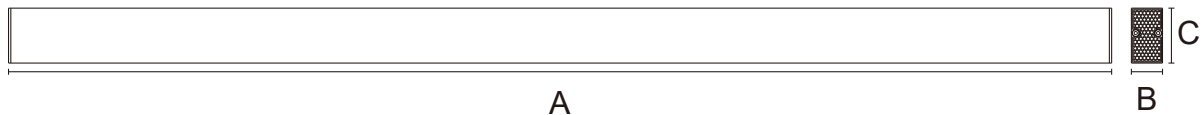

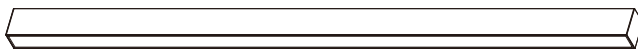
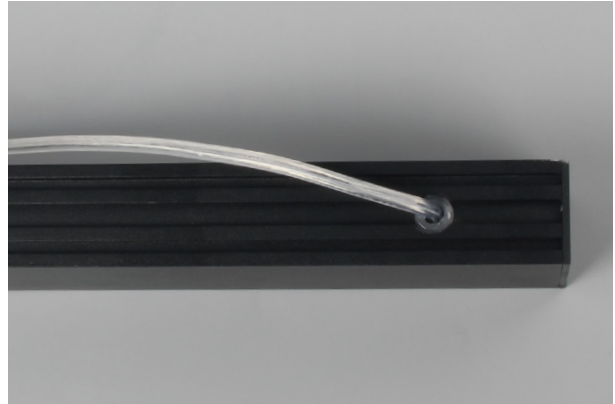

Description:
LED LINE LIGHT

Main material:
Aluminium+Engineering plastics

Specification
Energy saving, up to 85% energy saving comparing to standard halogen and incandescent lamps
High quality light, high color rendering, less heat, no UV or IR radiation
LED driver is included
IP20

Applications
• Shopping mall
• Office buildings
• Exhibition hall

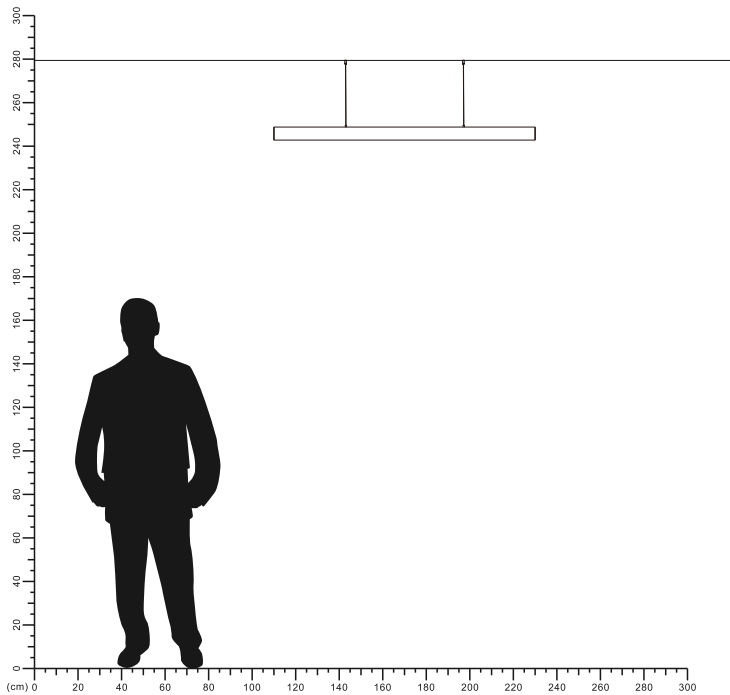

LUMINOUS INTENSITY DISTRIBUTION DIAGRAM

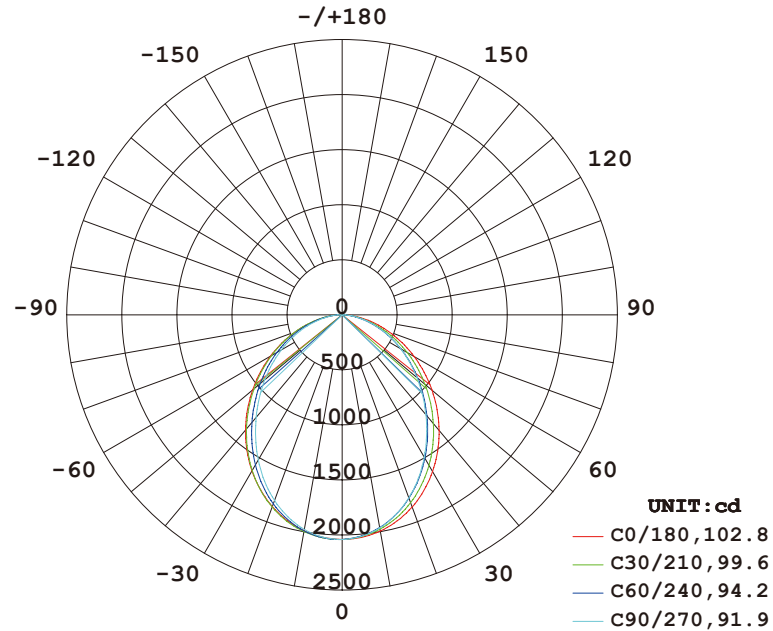

AVERAGE BEAM ANGLE (50%) : 97.1 DEG

Illuminance at a Distance

Flux out: 2943 lm

1m	873.5, 2064lx	203.34cm
2m	218.4, 516.1lx	406.68cm
3m	97.05, 229.4lx	610.02cm
4m	54.59, 129.0lx	813.37cm
5m	34.94, 82.58lx	1016.71cm
6m	24.26, 57.34lx	1220.05cm
7m	17.83, 42.13lx	1423.39cm
8m	13.65, 32.26lx	1626.73cm
9m	10.78, 25.49lx	1830.07cm
10m	8.735, 20.64lx	2033.41cm

Height Eavg, Emax Angle: 90.95deg Diameter

Note: The Curves indicate the illuminated area and the average illumination when the luminaire is at different distance.

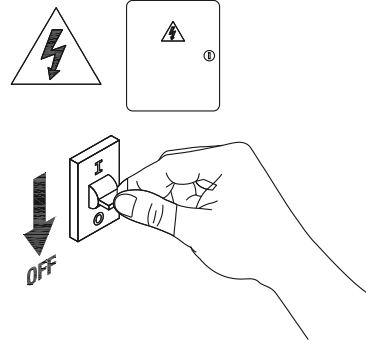
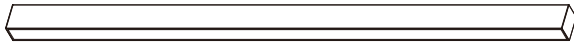

1

Turn off The Power



2

Drill 2 holes on your ceiling



3

Fix screw

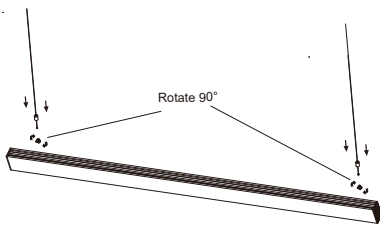

4

Fixing the lamp body

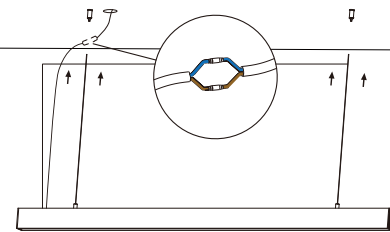

5

Connect the cable

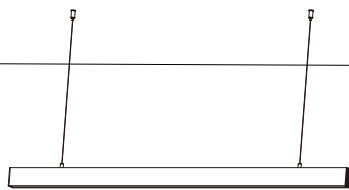

6

Installation completed

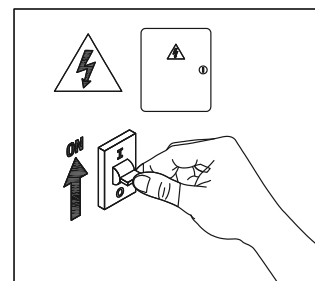

7

Turn on the power

