

GU10 Frame

NR-BG109 Series

IP20



Item Code	Match Lamp	Color	Dimensions in mm			Hole Size (mm)	kg
			A	B	C		
NR-BG109-1-WH	GU10/MR16	White	90	90	45	80x80	0.092
NR-BG109-1-BK	GU10/MR16	Black	90	90	45	80x80	0.092
NR-BG109-2-WH	GU10/MR16	White	172	90	45	165x80	0.195
NR-BG109-2-BK	GU10/MR16	Black	172	90	45	165x80	0.195

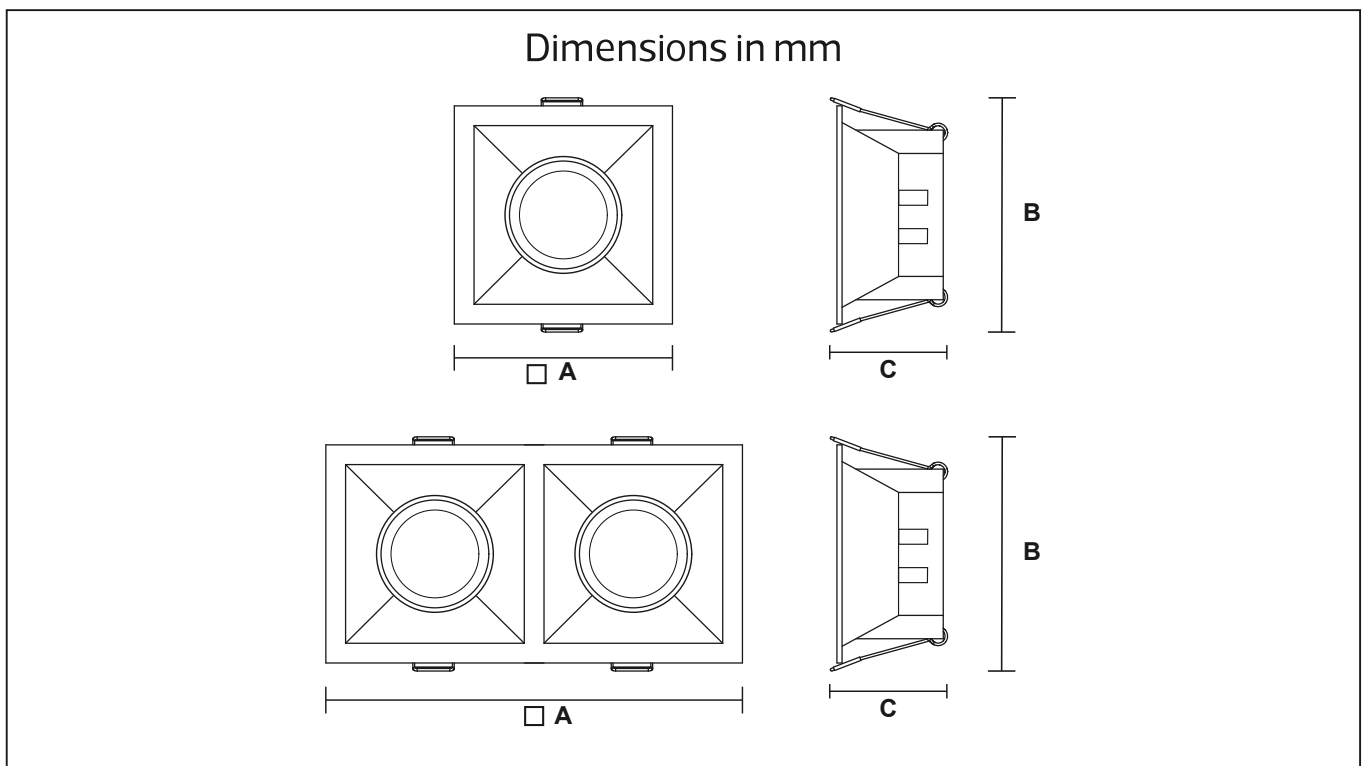



Strong spring fixation



Diversified selection of anti-glare cups



Description:

Recessed GU10 Frame

Main material:

Engineering plastic high quality reflector for soft and comfortable light.

Applications

- . Shopping mall
- . Office buildings
- . Exhibition hall

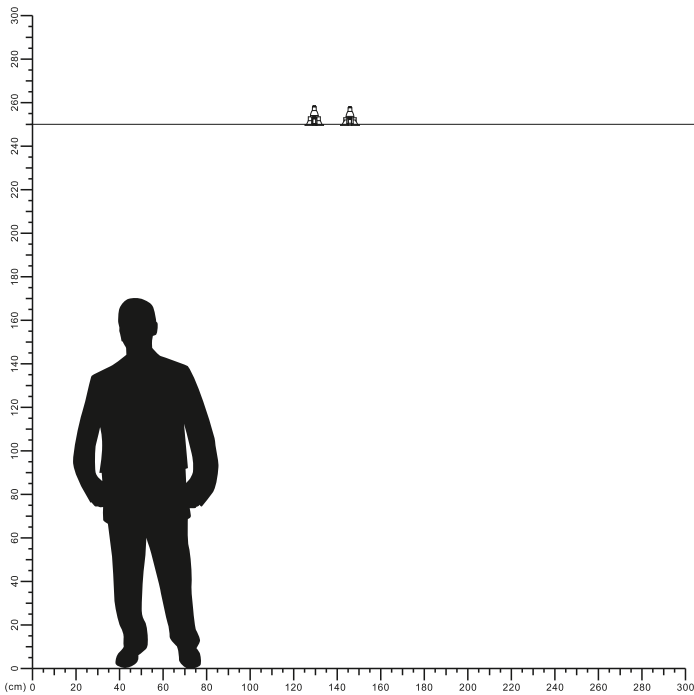

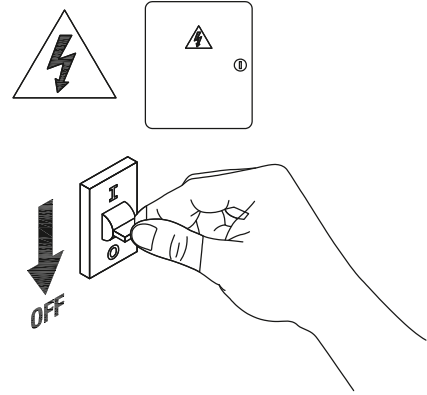
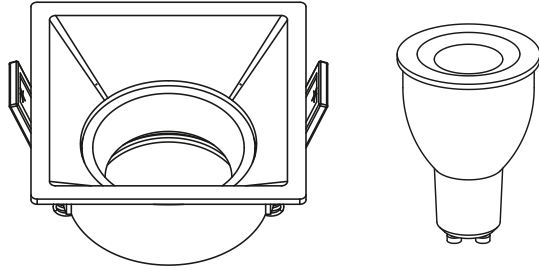

1

Turn off The Power

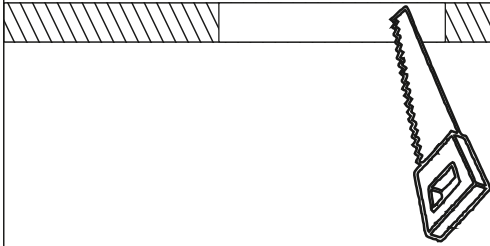

2

Cut a hole on your ceiling

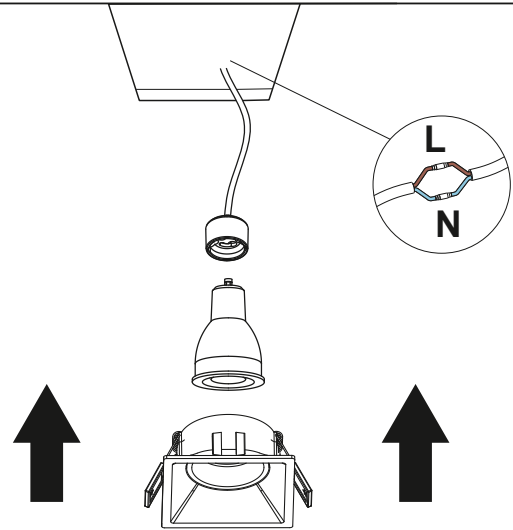

3

Cut a hole on your ceiling

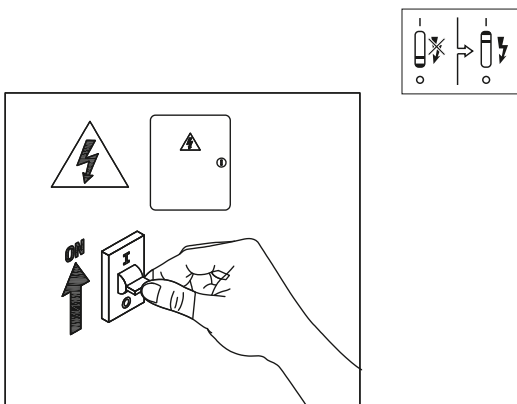

4

Turn on the power

