

## LED Emergency Exit Sign

NR-EXS101 Series  
IP20

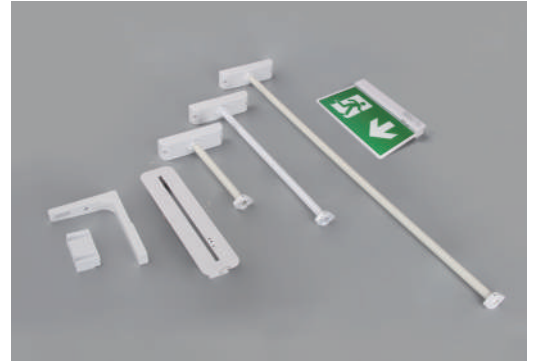

Indoor	AC 220-240V	50/60 Hz	PF ≥0.5	CCT 6500K	Ra ≥80	IP20	Beam Angel 360°	Charging Time ≤24h	Chips SMD	
--------	----------------	-------------	------------	--------------	-----------	------	-----------------------	--------------------------	--------------	--

Item Code	P(W)	Total Lumen	Emergency Duration	Dimensions in mm			 kg
				A	B	C	
NR-EXS101-4.5W-3H	4.5	40	≥3h	316	229	41.5	0.57

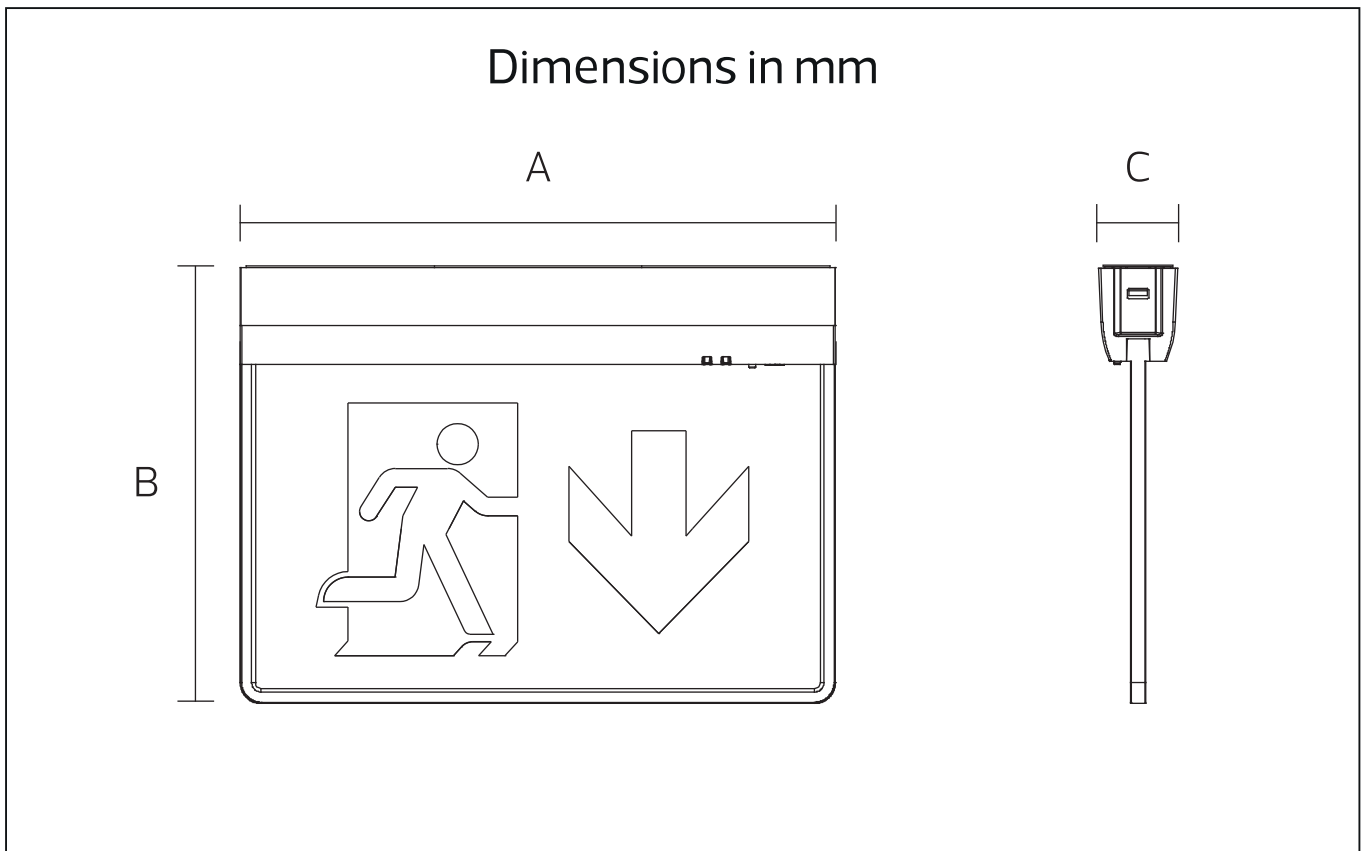

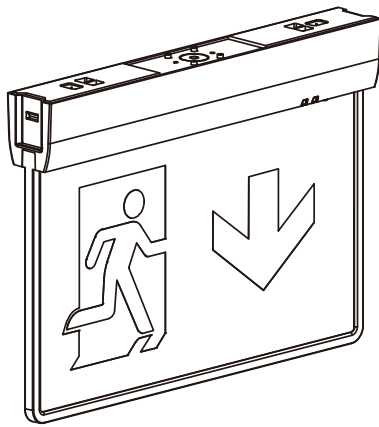

**Description:**  
LED Emergency Exit Sign

**Main material:**  
Engineering plastics+glass

**Specification**  
 Energy saving, up to 85% energy saving comparing to standard halogen and incandescent lamps  
 High quality light, high color rendering, less heat, no UV or IR radiation  
 Build-in LED Driver  
 IP20

**Applications**  
 .Shopping mall  
 .Hotels  
 .Exhibition hall  
 .Art hall  
 .Museums

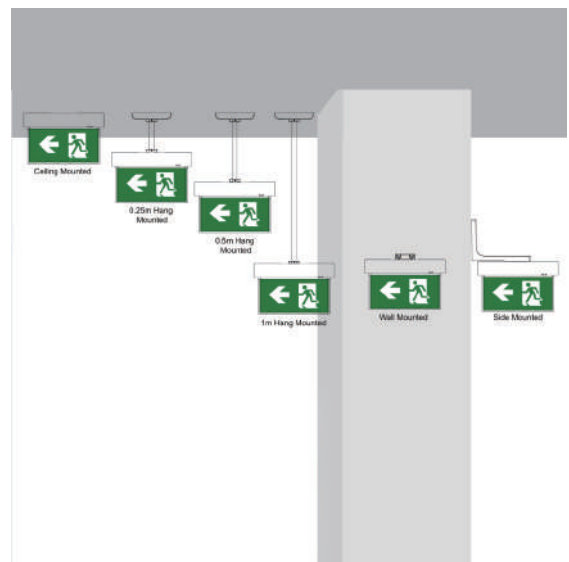
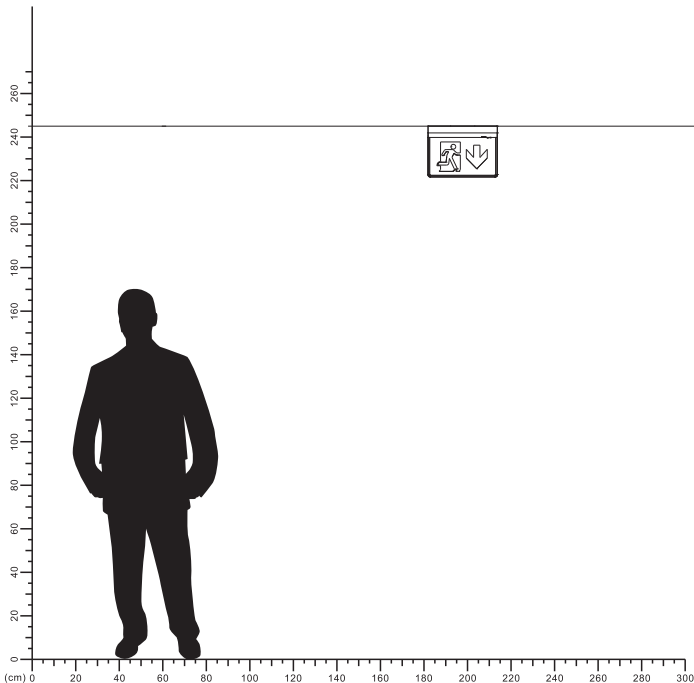

# LUMINOUS INTENSITY DISTRIBUTION DIAGRAM

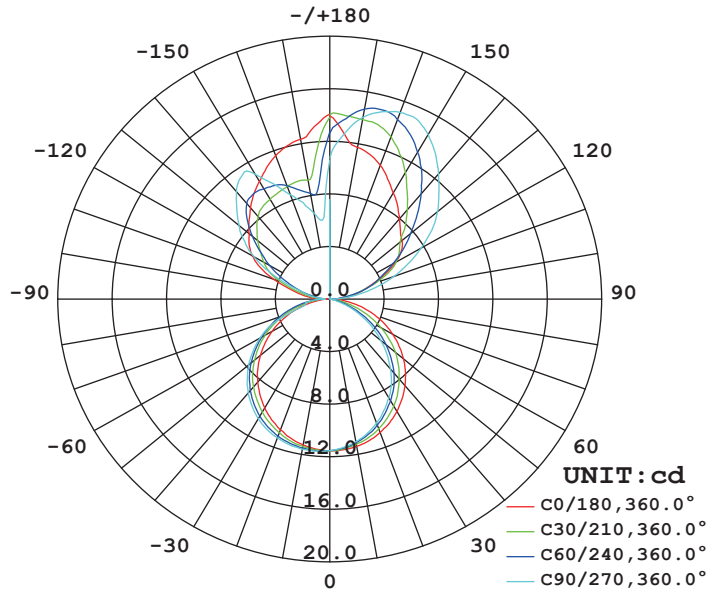

**AVERAGE BEAM ANGLE (50%) : 360.0 DEG**

## Illuminance at a Distance

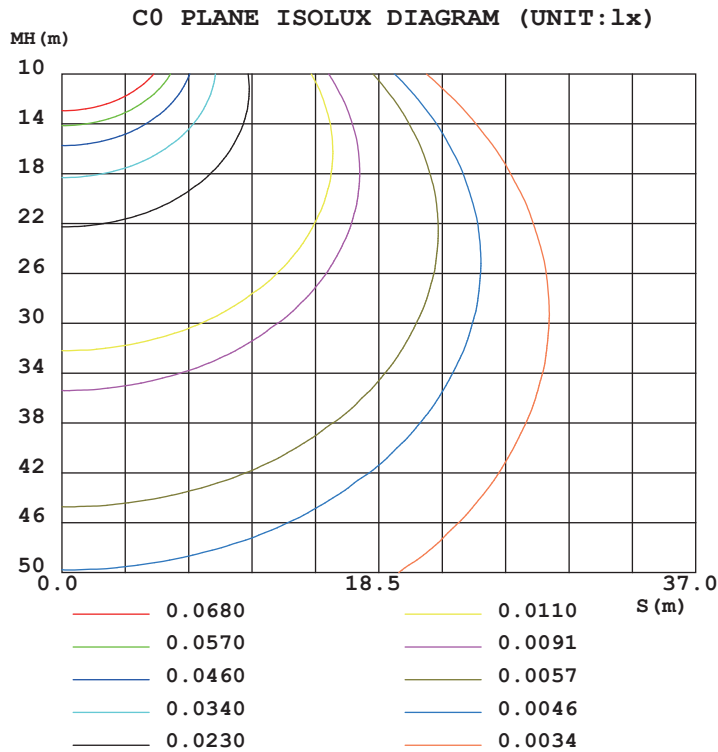

## Accessories

Picture	Item Code	Size	 kg
	Hange- 1M-ACS-WH	1030*180*55	0.27
	Hange- 0.5M-ACS-WH	535*180*55	0.13
	Hange- 0.25M-ACS-WH	283*180*55	0.12
	NR-EXS101-FRAME	375*85*40	0.13
	Side-ACS-WH	225*35*155	0.05
	Wall-ACS-WH	100*50*25	0.04

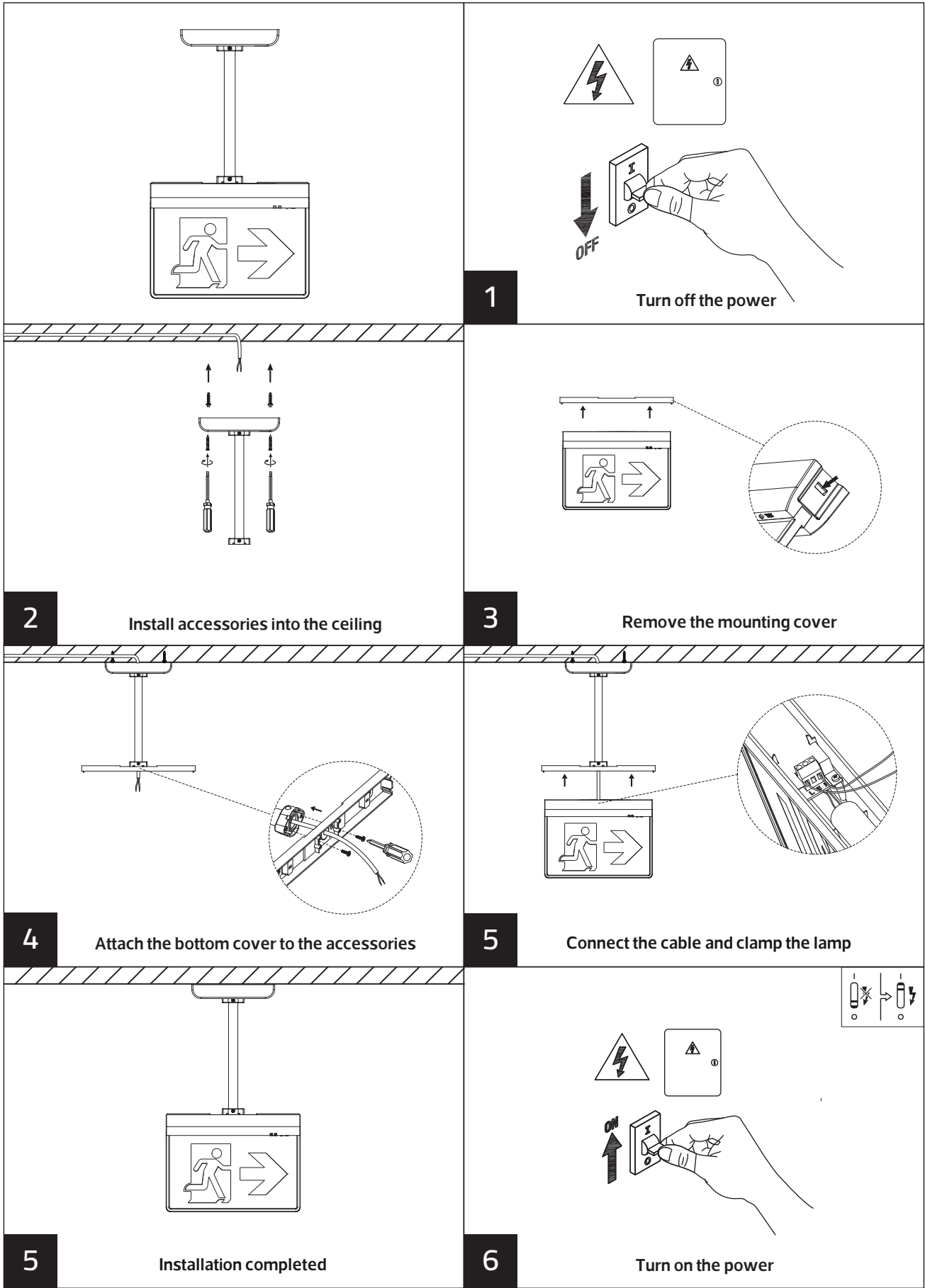

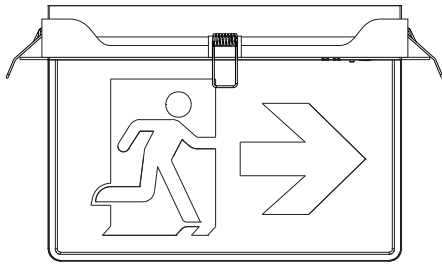

1

Turn off the power

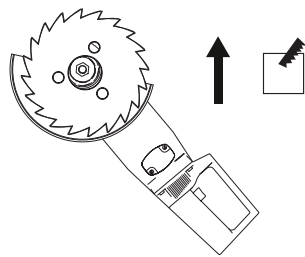
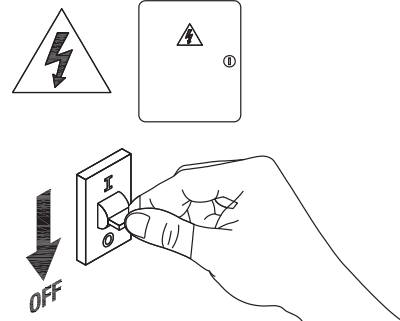

2

Cut a hole in the ceiling

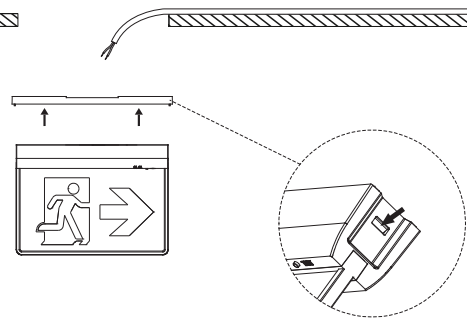

3

Remove the mounting cover

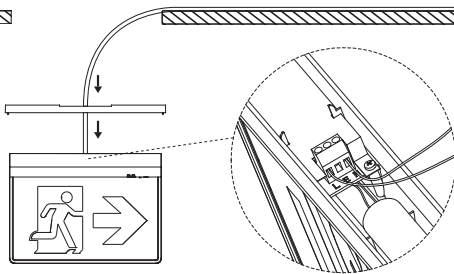

4

Connect the cable and clamp the lamp

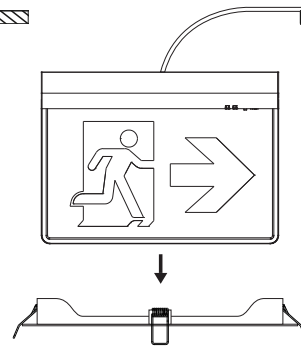

5

Put the lamp in the attachment

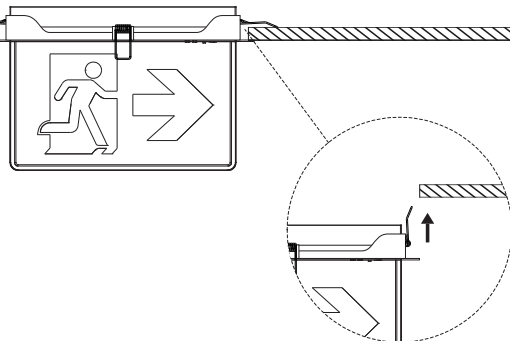

5

Stuck in ceiling and installed

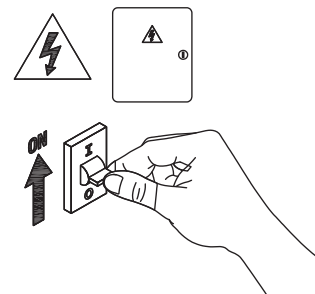

6

Turn on the power

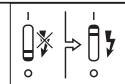

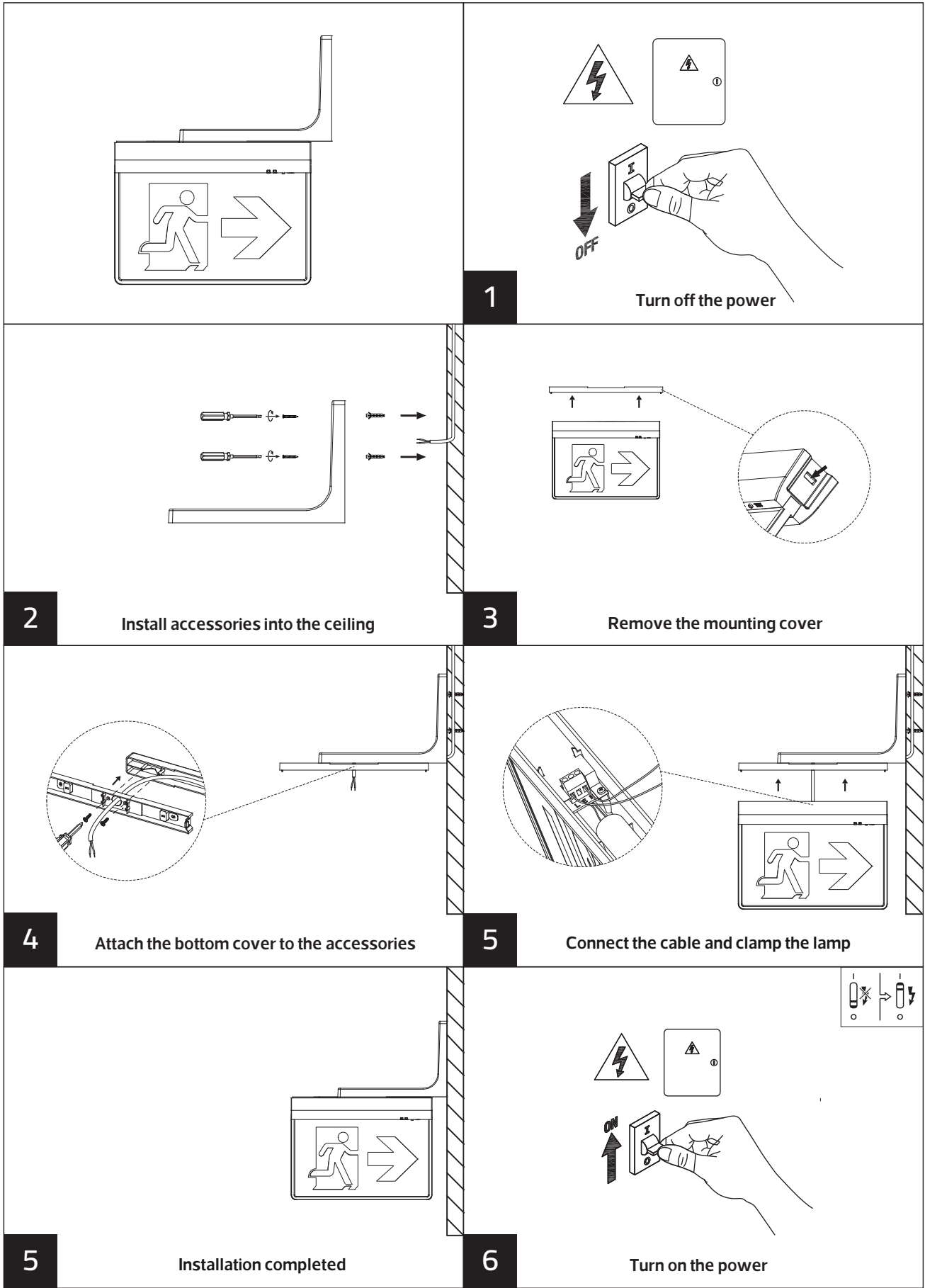

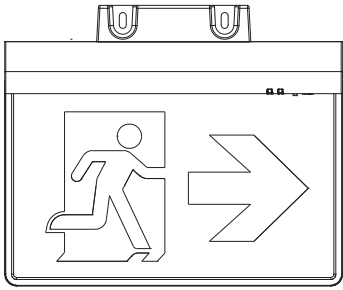

1

Turn off the power

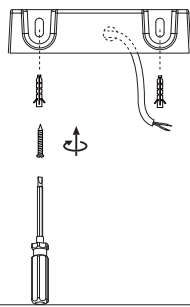
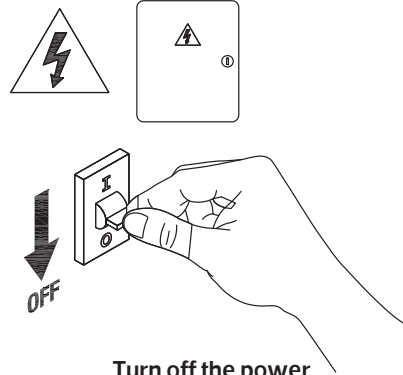

2

Install accessories into the ceiling

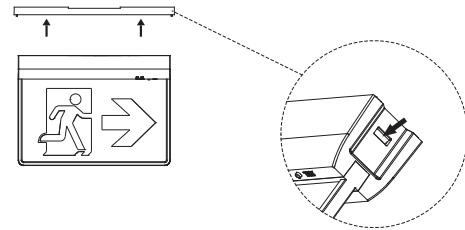

3

Remove the mounting cover

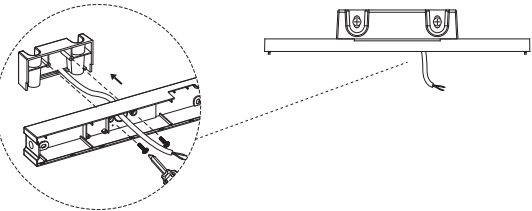

4

Attach the bottom cover to the accessories

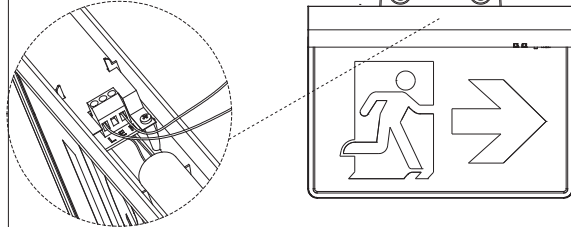

5

Connect the cable and clamp the lamp

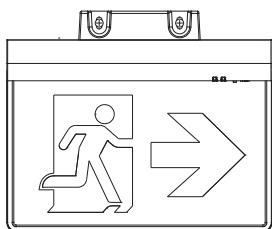

5

Installation completed

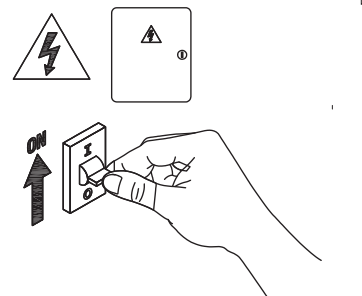

6

Turn on the power

