

NOORCO

LED FLOOD LIGHT

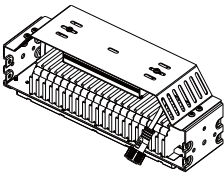

Product benefits & features:

- 1.High Brightness Illumination:** Floodlights utilize high-brightness LED chips to provide intense illumination. High brightness lighting can be used for both indoor and outdoor lighting requirements, including landscape lighting, architectural facade lighting, etc.
- 2. Waterproof and Dustproof:** Designed to be waterproof and dustproof, making them safe and reliable for outdoor environments.
- 3. Long Lifespan:** The LED chips used in floodlights have a long lifespan, typically lasting tens of thousands of hours. This means that floodlights have a longer lifespan and lower maintenance costs.
- 4. Energy-efficient and Environmentally Friendly:** Compared to traditional lighting fixtures, floodlights typically have higher energy efficiency, providing the same or even better lighting effects with lower energy consumption. Additionally, LED chips do not contain harmful substances such as mercury, making them more environmentally friendly.
- 5. Adjustable Lighting Angle:** The lighting angle of floodlights can be adjusted to change the direction and range of illumination. This allows floodlights to provide precise lighting according to specific needs and adapt to different lighting requirements.

Areas of application:

Building lighting, landscape lighting, stadiums, advertising sign lighting, street lighting.

Caution:

- 1.Selecting the Right Position:** Before installing floodlights, carefully choose the appropriate position. Consider lighting requirements and installation purposes to determine the optimal installation location. Ensure that the installation location is stable, flat, and suitable for fixture installation. If the installation location is high or requires the use of a ladder, be sure to use a sturdy and appropriate ladder and follow relevant safety operating procedures. Maintain balance and stability during the installation process to avoid falls or injuries.
- 2.Using Suitable Cables and Accessories:** Choose appropriate cables and accessories to connect the fixtures and power supply. Ensure reliable cable quality and equip with suitable connectors, insulating sleeves, and grounding devices, etc., to ensure proper grounding of floodlights for additional safety and electrical protection.
- 3. Waterproof and Dustproof Measures:** If the floodlights will be installed outdoors or in wet environments, ensure to select fixtures with waterproof and dustproof features and properly carry out waterproofing treatments. Use waterproof connectors, sealing compounds, and waterproof covers, etc., to ensure the long-term reliability and safety of the fixtures.
- 4. Testing and Debugging:** After completing the installation, perform necessary testing and debugging to ensure that the floodlights work properly and meet the expected lighting effects. Check the power connections and other aspects to ensure everything is in order.

Product Installation and Wiring Diagram

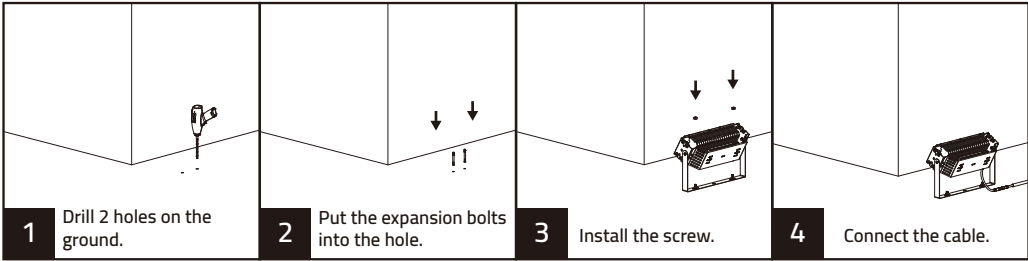

Product Specifications and Dimensions

Model No:	NR-FLO251-50-65K-BK-90D
Input:	AC220-240V 50/60Hz
Power:	50W
Lumen Output:	5000lm
CCT:	6500K
Beam angle:	90°
IP rated:	IP65
Ra:	≥80

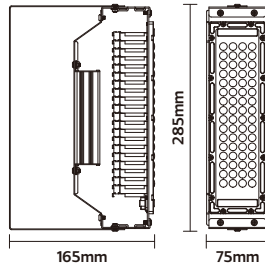

Customer Service Center: 8004300030
8004300030 مركز خدمة العملاء

www.meshKati.sa
Made in China
صنع في الصين

