

Lamp Frame

NR-FR104 Series

IP20



Item Code	Match Lamp	Color	Dimensions in mm		Hole Size (mm)	kg
			A	B		
NR-FR104-70	GU10	Black/White	φ92	76	φ73	0.05
NR-FR104-SQ-70	GU10	Black/White	□92	76	φ73	0.06
NR-FR104-140	AR111	Black/White	φ180	64	φ140	0.13
NR-FR104-SQ-140	AR111	Black/White	□180	64	φ140	0.14
NR-FR104-200	AR111	Black/White	φ225	64	φ200	0.18
NR-FR104-SQ-200	AR111	Black/White	□225	64	φ200	0.23

Dimensions in mm

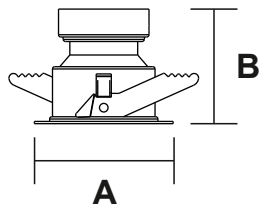

NR-FR104-70

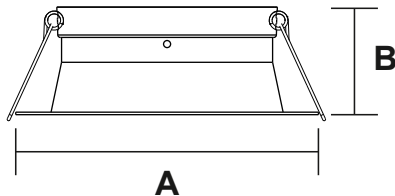

NR-FR104-140

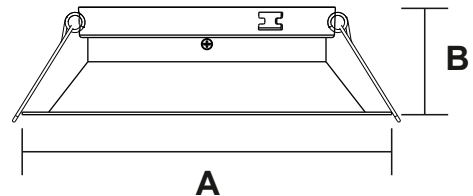

NR-FR104-200

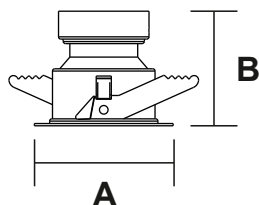

NR-FR104-SQ-70

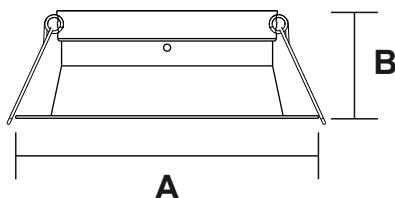

NR-FR104-SQ-140

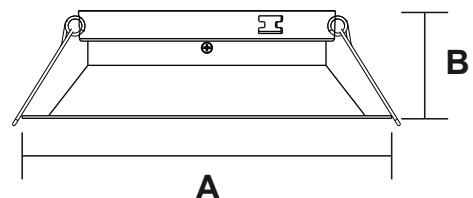

NR-FR104-SQ-200

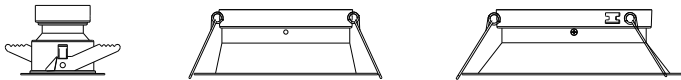
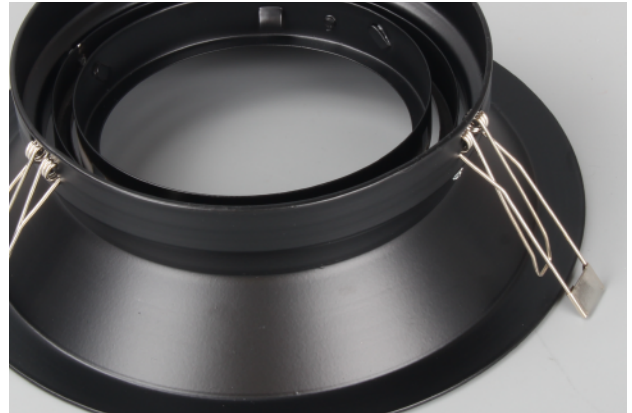
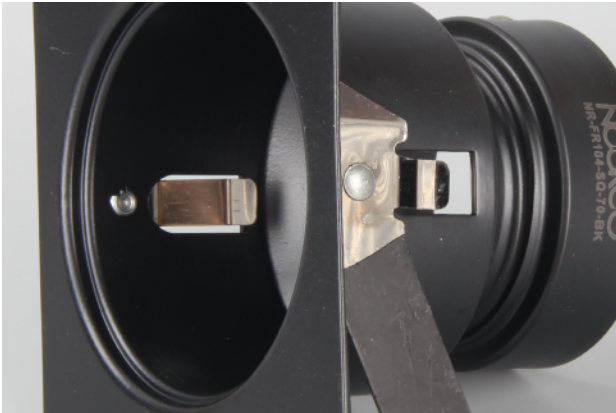

Description:
NR-FR104 Series

Main material:
Die-cast aluminum

- Applications**
- . Shopping mall
 - . Office buildings
 - . Exhibition hall

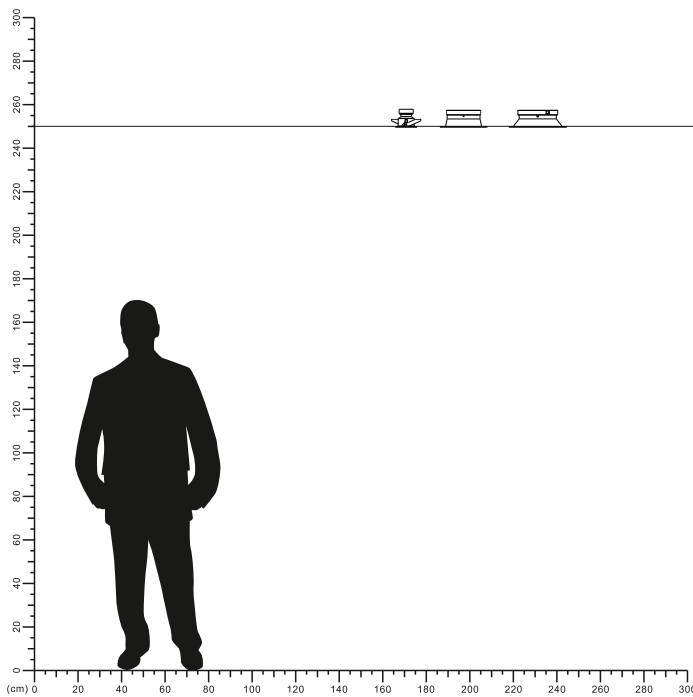

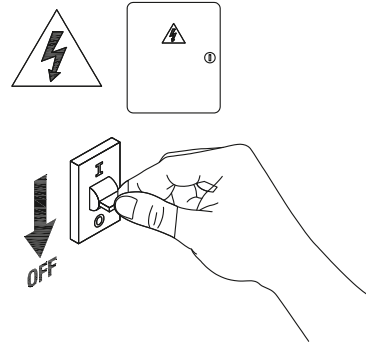
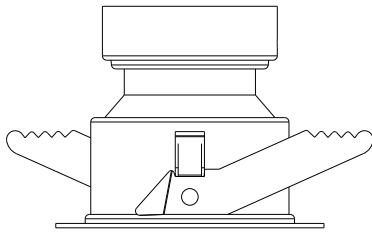

1

Turn off The Power

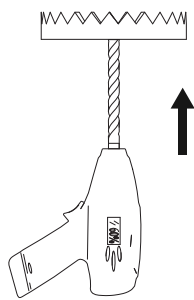

2

Cut a hole in the ceiling

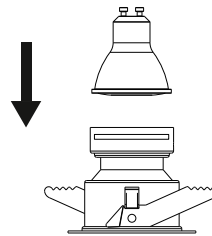

3

Snap the LED cup into the outer ring

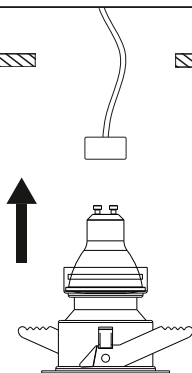

4

Snap the LED cup into the Lamp cup base

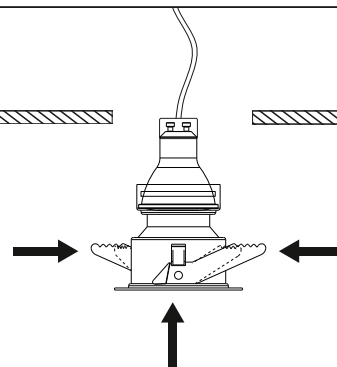

5

Press the two clips down and place them in the ceiling

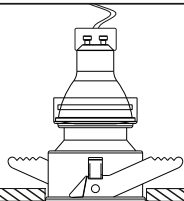

6

installaion is complete

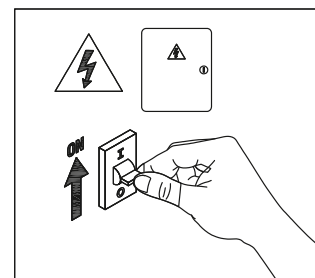
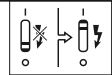

7

Turn on the power

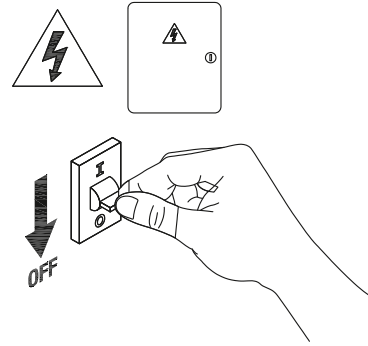
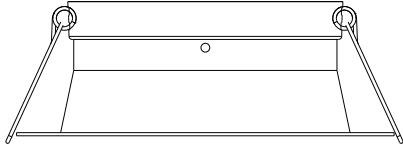

1 Turn off The Power

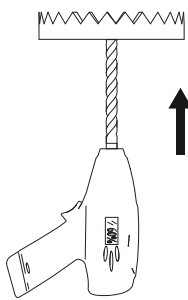

2 Cut a hole in the ceiling

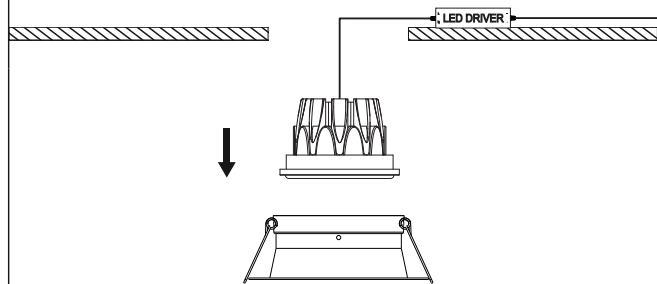

3 Snap the LED cup into the outer ring

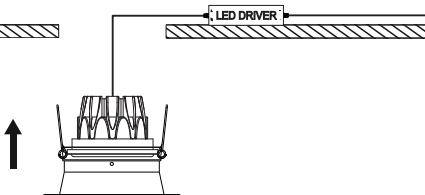

4 Buckle automatically fall down place them in the ceiling

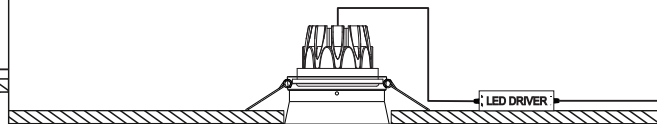

5 installaion is complete

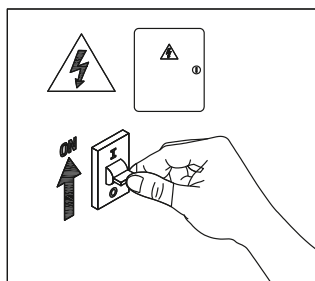

6 Turn on the power

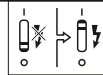

7

