

## Lamp Frame

NR-FR105-MR16A Series  
IP20



Item Code	Match Lamp	Color	Dimensions in mm			Hole Size (mm)	kg
			A	B	C		
NR-FR105-MR16A-1	GU10	White/Black	98	98	150	100*100	0.45
NR-FR105-MR16A-2	GU10	White/Black	196	98	150	200*100	0.75

### Dimensions in mm

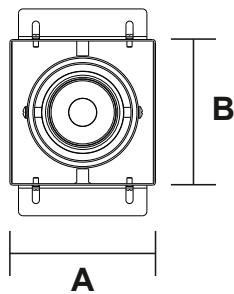

NR-FR105-MR16A-1

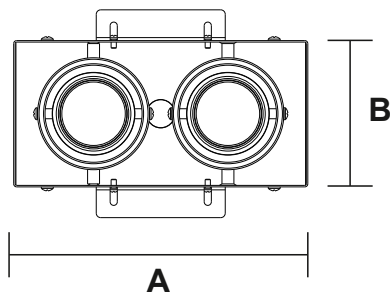
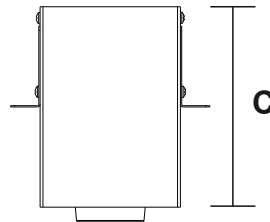

NR-FR105-MR16A-2

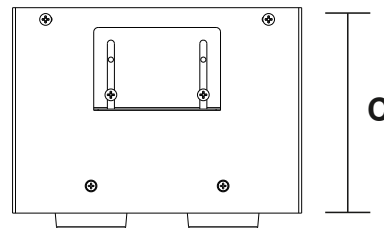

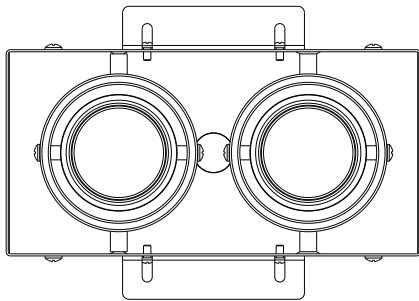

**Description:**  
NR-FR105-MR16A Series

**Main material:**  
Iron

- Applications**
- . Shoping mall
  - . Office buildings
  - . Exhibition hall

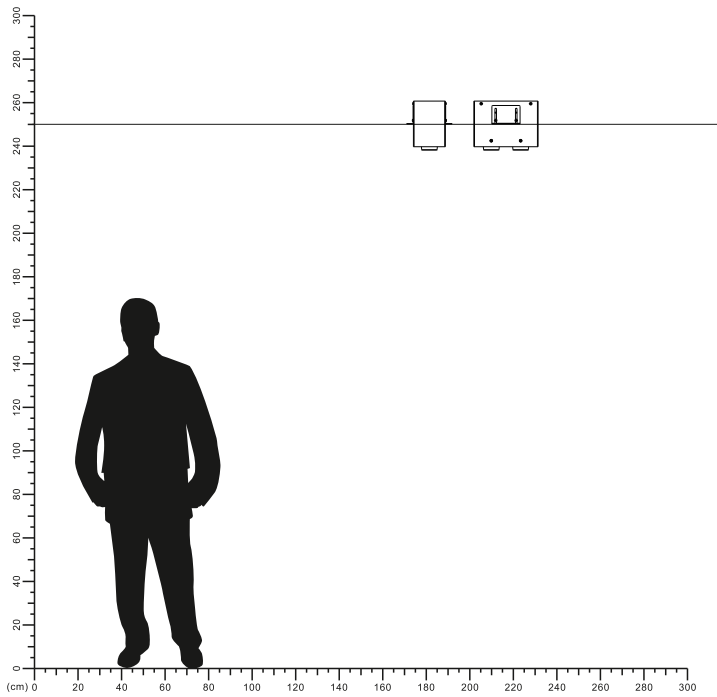

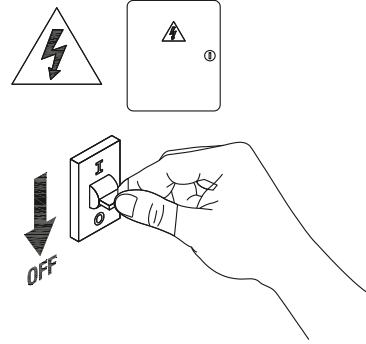
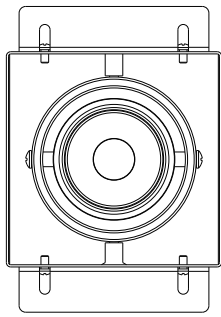

**1**

Turn off The Power

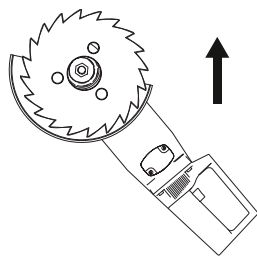

**2**

Cut a hole in the ceiling

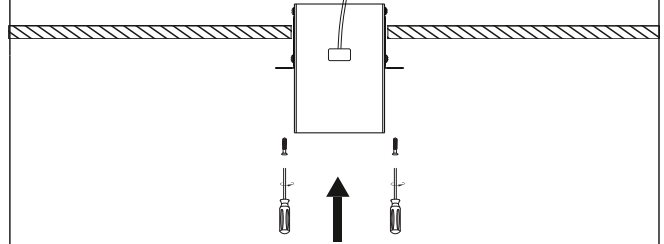

**3**

Attach the screws to the ceiling

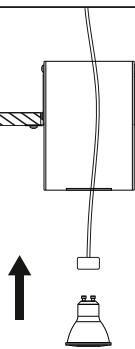

**4**

Snap the LED cup into the Lamp cup base

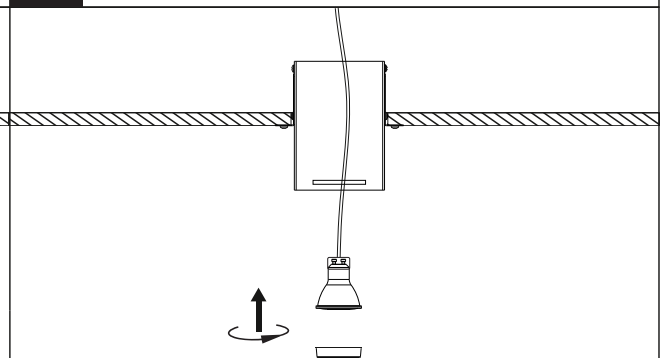

**5**

place them in the Lamp Frame

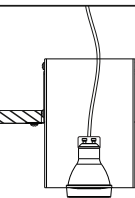

**6**

installaion is complete

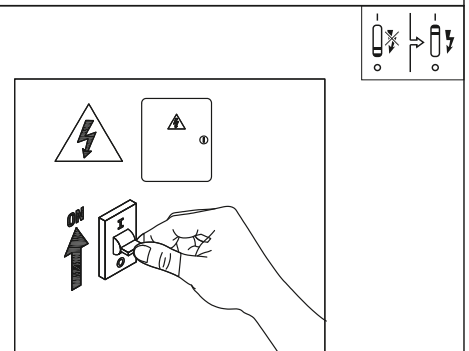

**7**

Turn on the power

