

Lamp Frame

NR-FR110

IP20



Item Code	Match Lamp	Color	Dimensions in mm		Hole Size (mm)	kg
			A	B		
NR-FR110	GU10	Black/White	φ85	43	φ70	0.1

Dimensions in mm

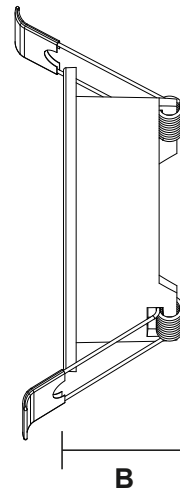
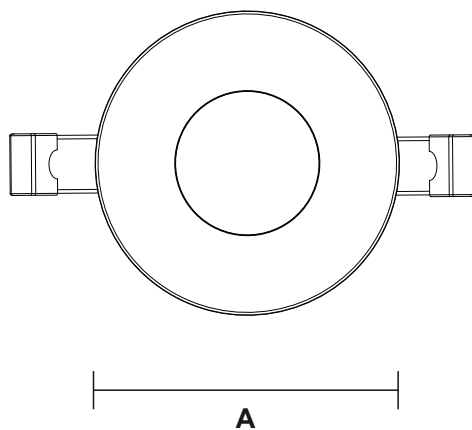

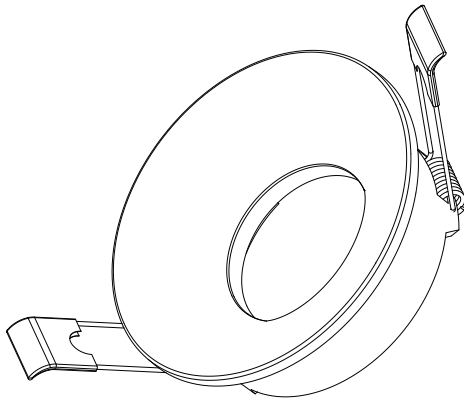

Description:

NR-FR110

Main material:

Die-cast aluminum

Applications

- . Shoping mall
- . Office buildings
- . Exhibition hall

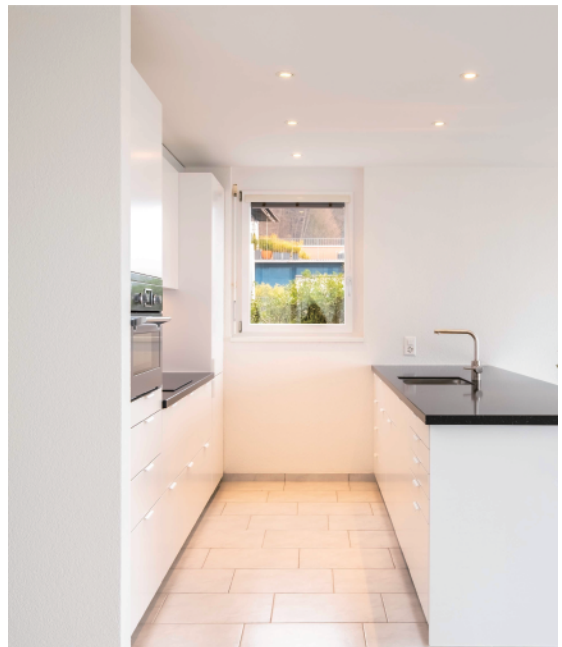
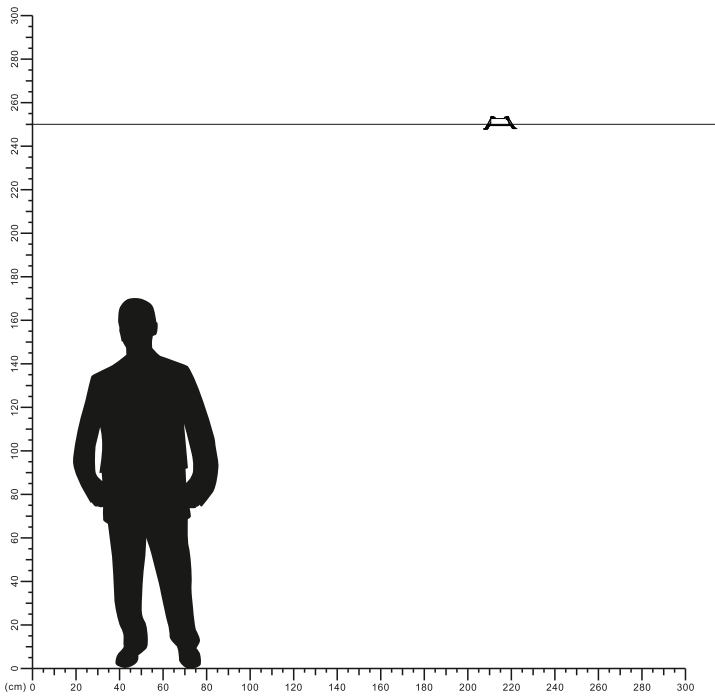

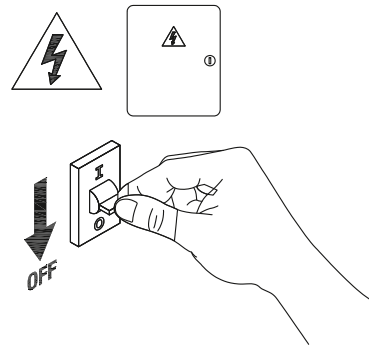
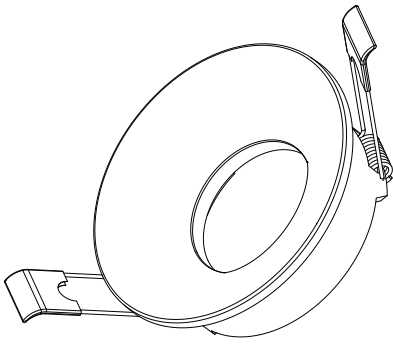

1

Turn off The Power

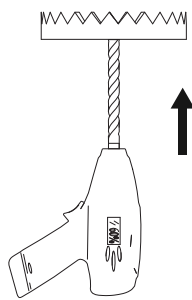

2

Cut a hole in the ceiling

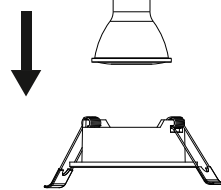

3

Snap the LED cup into the outer ring

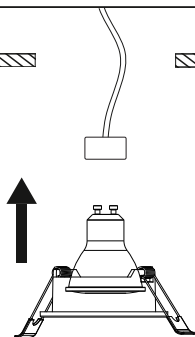

4

Snap the LED cup into the Lamp cup base

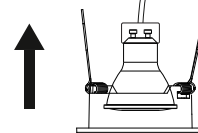

5

Buckle automatically fall down

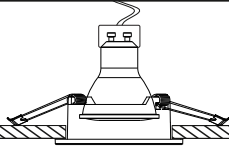

6

installaion is complete

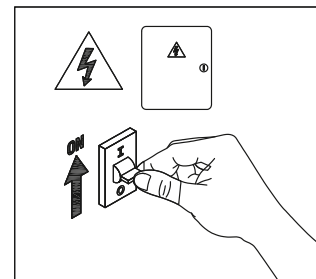
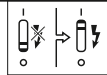

7

Turn on the power

