

# NOORCO GX53 LED LAMP

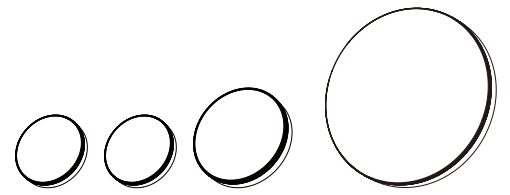

## Product benefits & features:

Very low energy consumption, Extremely long life, No UV and near-IR radiation in the light beam.

Shock proof and vibration-proof, Efficient generation of light, Not dimmable, Life time: up to 20,000h, Mercury-free lamps.

## Areas of application:

As a light source. Exhibitions, Department stores, House Luminaries & Directional light sources, Museums Hospitality Shops.

## Caution:

Risk of electric shock, Only for indoor use and never install where water may drop on the lamp. When the lamp is in fault, please turn off the power and don't use it and dispose it in safety way.

## Warning:

Please read the product instructions carefully before installation. Keep this installation instruction manual for future reference.

Installation of stationary products and connection of cables shall comply with local national electrical codes.

All installation procedures must be performed by qualified electrician personnel.

If the shell or internal structure of the product is damaged, please cut off the power and replace it by qualified electricians.

## Product Installation and Wiring Diagram

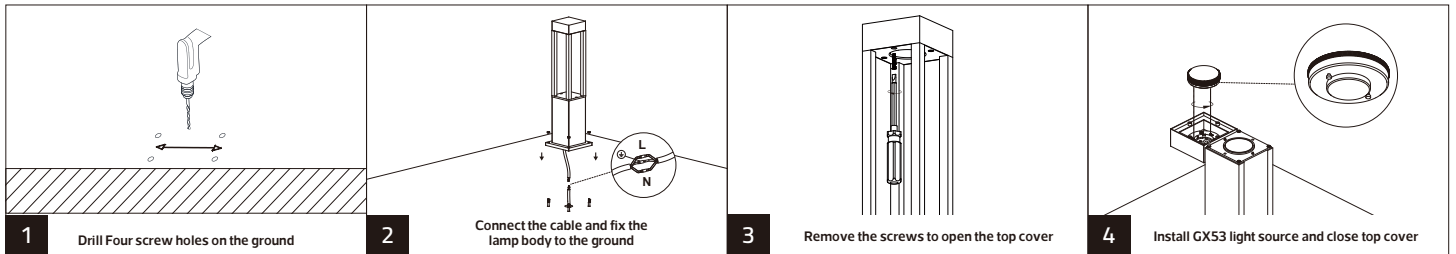

## Product Specifications and Dimensions

Item Code:	NR-GX53-3W	NR-GX53-7W	NR-GX53-10W	NR-GX53-18W
Input:	AC220-240V 50/60Hz	AC220-240V 50/60Hz	AC220-240V 50/60Hz	AC220-240V 50/60Hz
Power:	3W	7W	10W	18W
Lumen Output:	252lm	616lm	960lm	1818lm
CCT:	3000K/4000K/6500	3000K/4000K/6500	3000K/4000K/6500	3000K/4000K/6500
Beam angle:	120°	120°	120°	120°
IP rated:	IP20	IP20	IP20	IP20
Ra:	≥80	≥85	≥85	≥85
LxH(mm):	Φ73x22	Φ73x30	Φ100x28	Φ180x28
Socket:	GX53	GX53	GX53	GX53

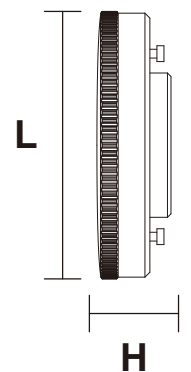

ta:40°C

Customer Service Center.8004300030

Made in China

صنع في الصين

