

LED Neon Strip Light

NR-NE48-1312 Series
IP65

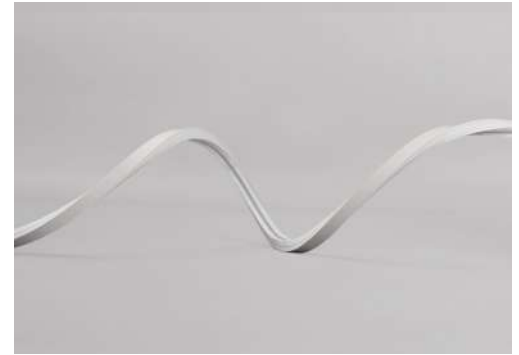

Item Code	Input Voltage	Watt	Ra	Lm/M	Cutting	LED QTY	LED Type	Beam Angle	IP	CCT
NR-NE48-1312-5W	DC48V	5W/M	≥97	250lm/m	100mm	120Pcs	SMD	120°	IP65	3000K/4000K
NR-NE48-1312-9W	DC48V	9W/M	≥97	450lm/m	100mm	120Pcs	SMD	120°	IP65	3000K/4000K

Dimensions in mm

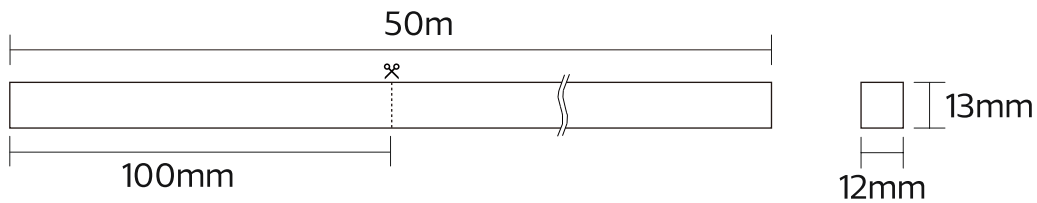



Description:

LED Neon Strip Light

Main material:

Silica gel

Specification:



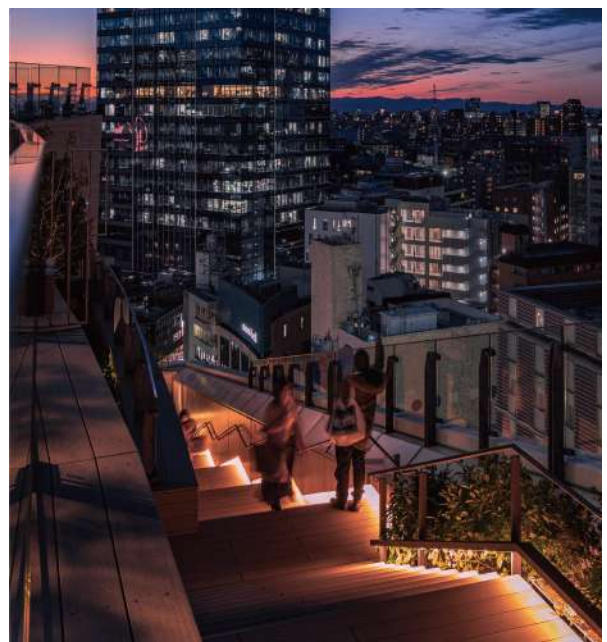
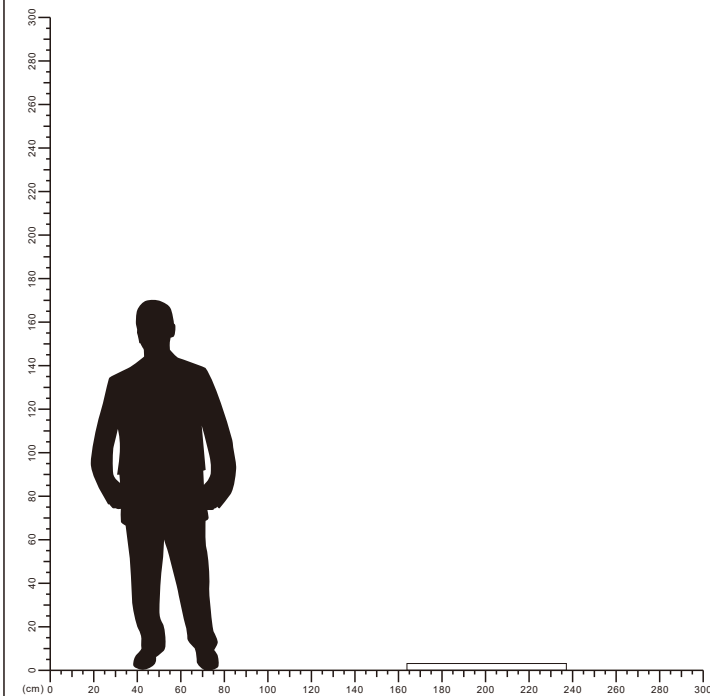

Energy saving, up to 85% energy saving comparing to standard halogen and in candescent lamps Long life, up to 20,000 hours High quality light, High color rendering, less heat.

Applications

- .Signboard
- .The ceiling
- .Building external wall



Accessories

Picture	Item Code	Size
	NR-NE48-1312-CONNECT	12*12
	NR-NE48-1312-CLIPS-MOV	14*14
	NR-NE48-1312-CLIPS	12*12
	NR-NE48-1312-CAP	12*12

POLAR AND CONE DIAGRAM

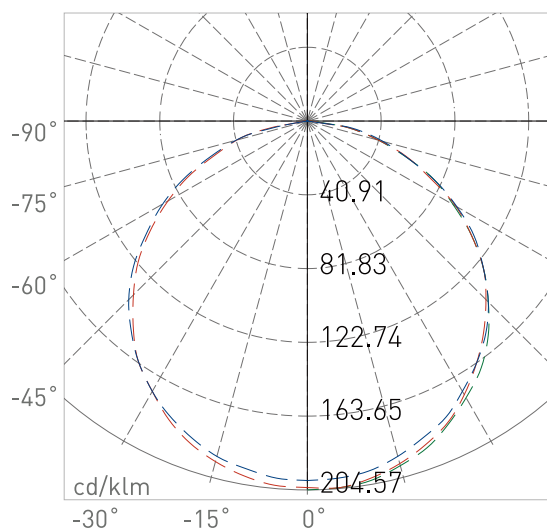

PHOTOMETRIC OF 1M STRIP

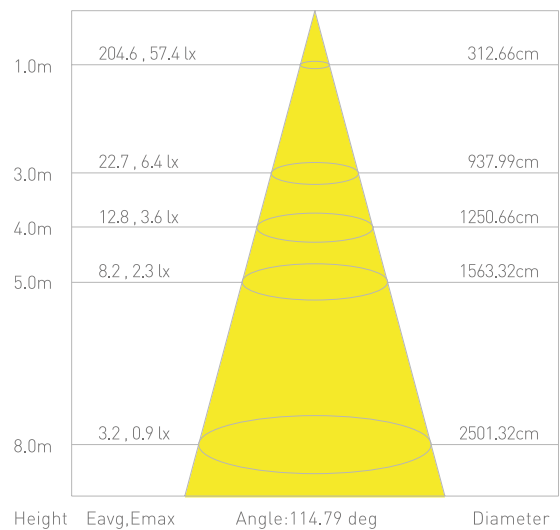

LED Strip Power Supply

Item Code	Input Voltage(AC)	Input Current(A)	Output Voltage(DC)	Output Current(A)	IP	Watt
NRP-PS102-FliKer-48V-150W-IP65	100-240V	1.5A	48V	3.2A	65	150
NRP-PS102-FliKer-48V-300W-IP65	180-240V	1.67A	48V	6.25A	65	300
NRP-PS102-FliKer-48V-400W-IP65	180-240V	2.2A	48V	8.33A	65	400



NOTE:the power supply should not exceed 80% of the rated power for long periods of time!



NRP-PS102-FliKer-48V-150W-IP65



NRP-PS102-FliKer-48V-300W-IP65



NRP-PS102-FliKer-48V-400W-IP65

Minimum bending radius and luminous surface.

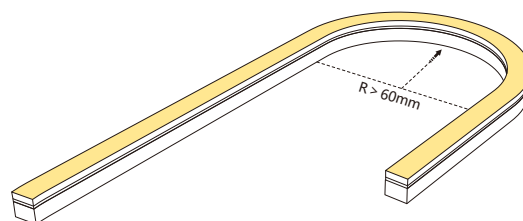

 Luminous surface

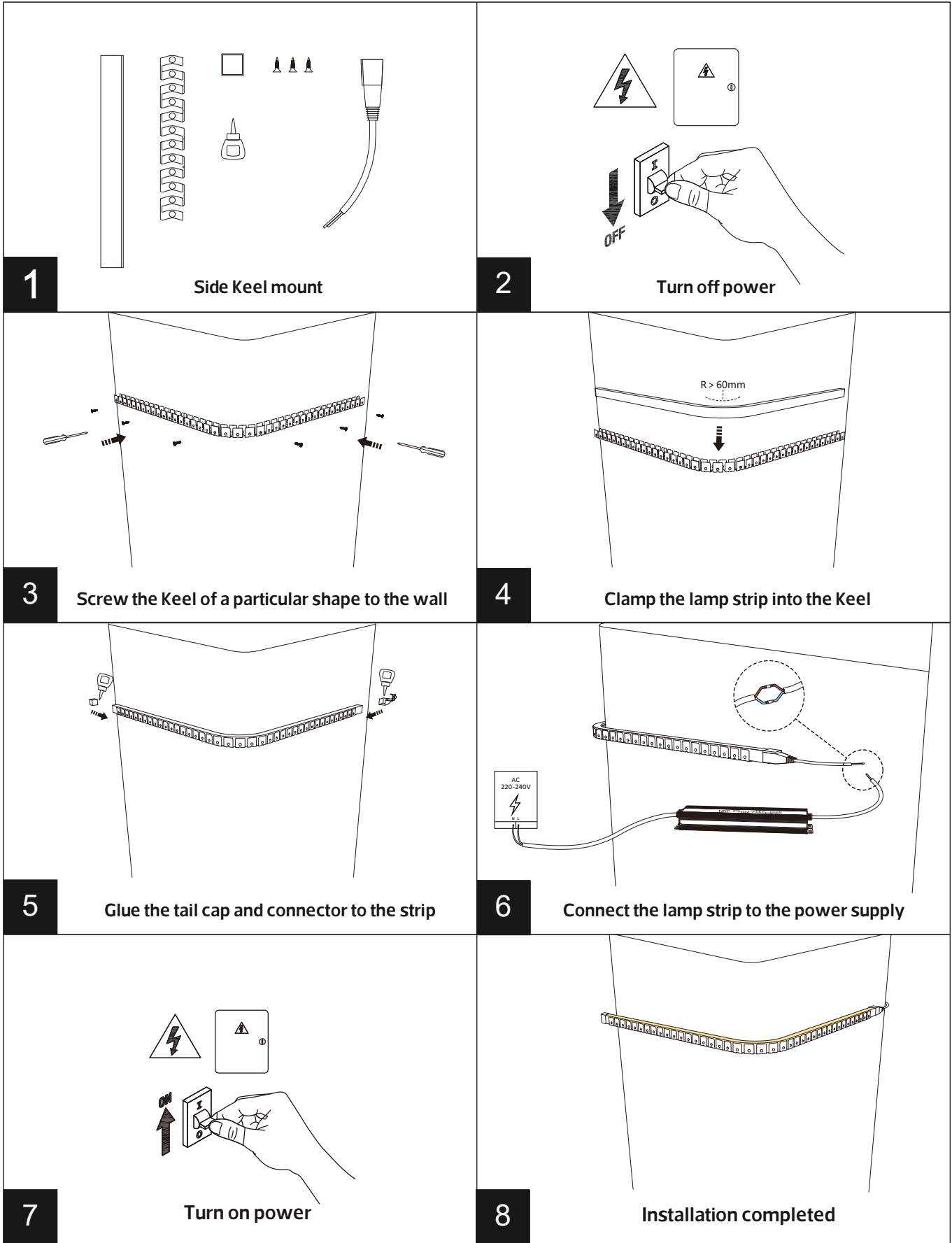

1

Side Keel mount

2

Turn off power

3

Screw the Keel of a particular shape to the wall

4

Clamp the lamp strip into the Keel

5

Glue the tail cap and connector to the strip

6

Connect the lamp strip to the power supply

7

Turn on power

8

Installation completed

