

Outdoor Lawn Light Accessories

NR-OLLS0404-1-BK
IP65



Model No	Cap Type	Lamp Type	Dimensions in mm		
			A	B	
NR-OLLS0404-1-BK	GU10*1	MR11	900	Φ40	0.77
CP7036-1	/	/	210	Φ40	0.09
CP7036-2	/	/	10	Φ70	0.04

Dimensions in mm

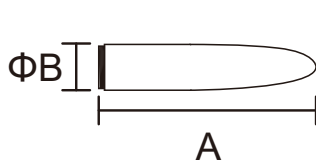

CP7036-1



CP7036-2

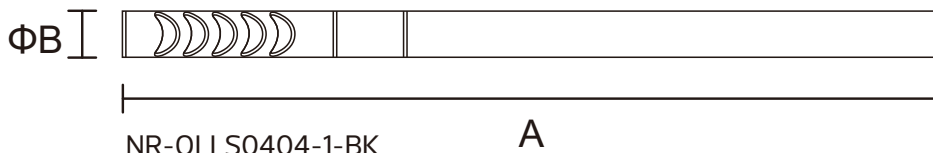

NR-OLLS0404-1-BK

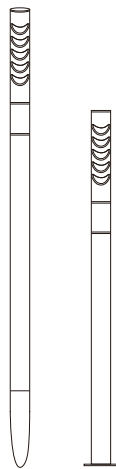

Description: LAMP ACCESSORIES

Main material:
Aluminum+Acrylic

Specification

- 1.Fashionable simplicity: Classic modernist design, simple and generous lamp body, suitable for various decoration styles.
- 2.Texture material: Adopt high-quality materials, the surface is processed by special technology, which has texture and is easy to clean.
- 3.Multiple lights: Unique design concept, multiple light effects to choose from, both beautiful and practical.
- 4.Easy installation: The lamp holder adopts a user-friendly installation design, which is convenient, quick, time-saving and labor-saving.

Applications

. Park . Square . Tourist attraction . Corridor

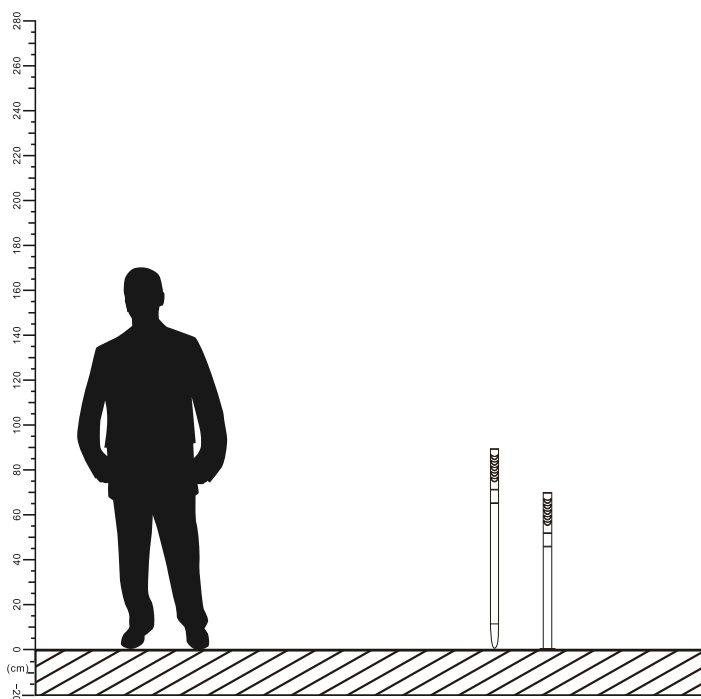

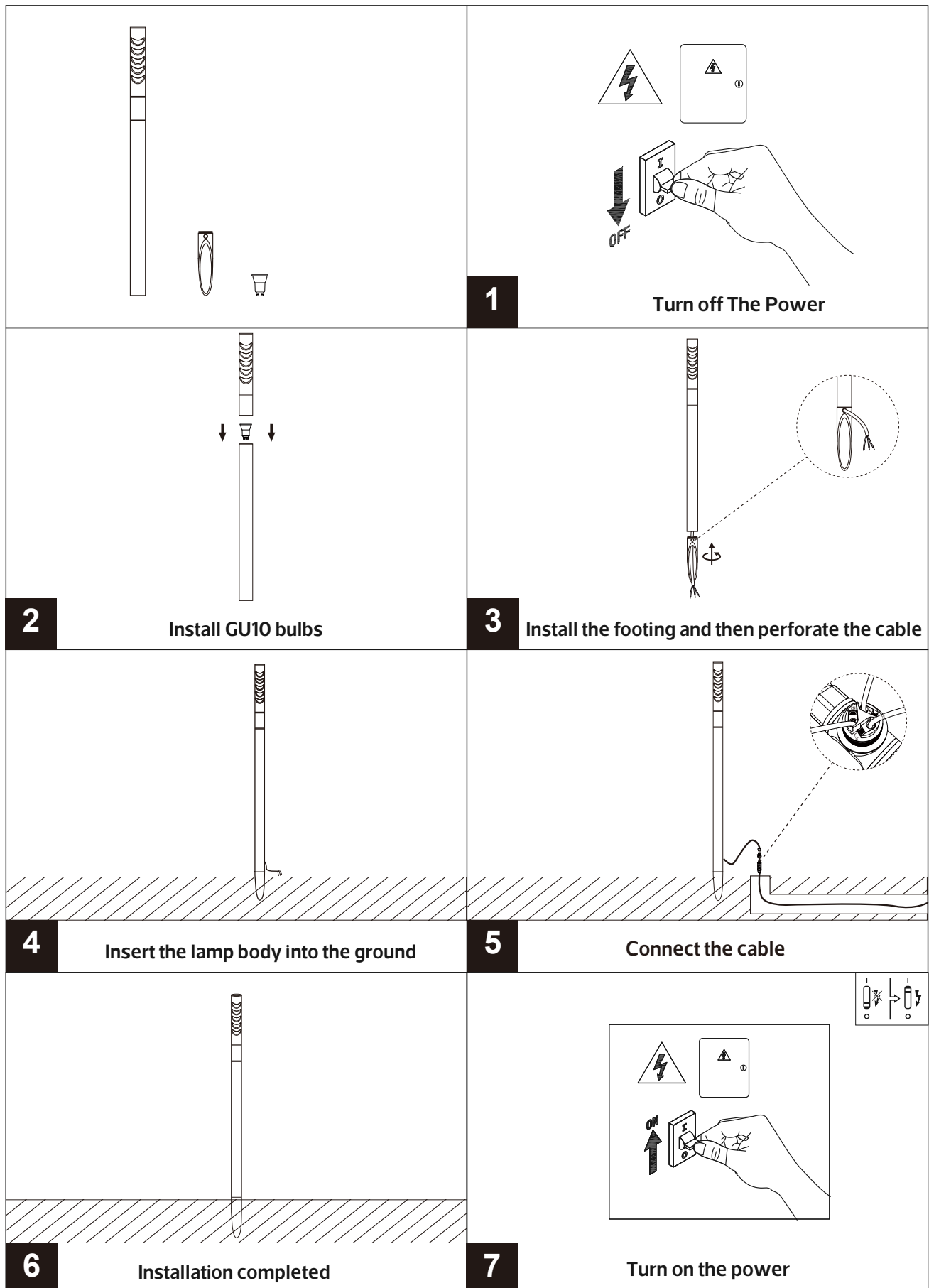

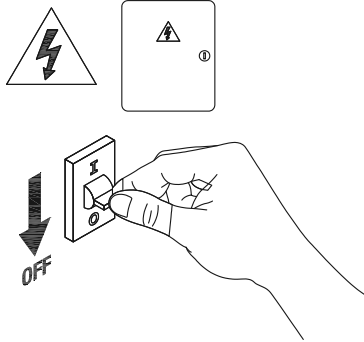

1

Turn off The Power

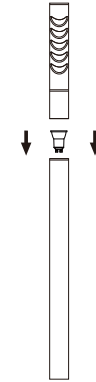

2

Install GU10 bulbs

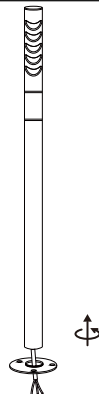

3

Install the base

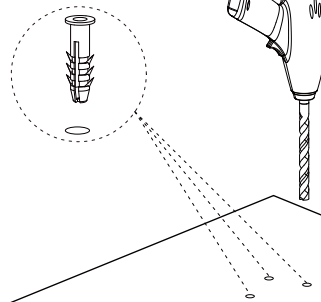

4

Drill 3 holes into the ground to insert the expansion screw

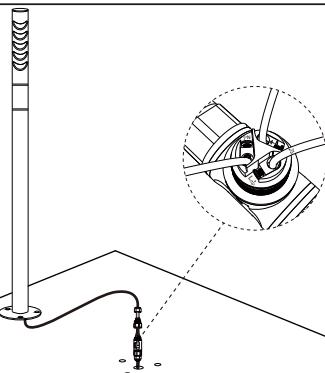

5

Connect the cable



6

Fixed lamp body



7

Installation completed

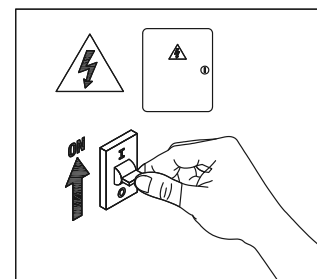

8

Turn on the power

