

## Flood Light Accessories

NR-OLLS0652-1-BK  
IP65



Model No	Cap Type	Lamp Type	Color	Dimensions in mm		
				A	B	
NR-OLLS0652-1-BK	GU10*1	MR16	Black	Φ63	148	0.33

### Dimensions in mm

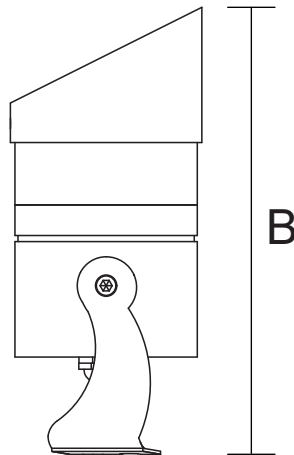
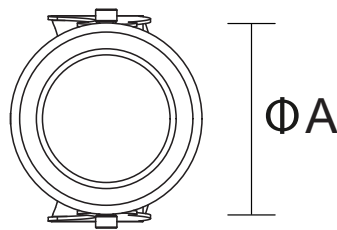

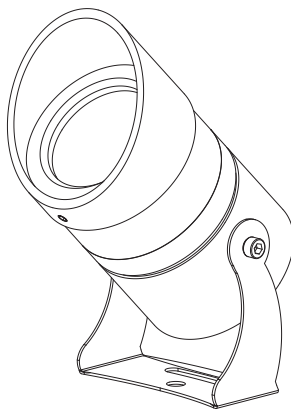

**Description:**  
Flood Light Accessories

**Main material:**  
Aluminum+Glass

**Specification**  
Die-cast aluminum lamp body corrosion rust prevention, durable.  
High transmittance glass lampshade, soft light and not dazzling.

**Applications**

- . Park
- . Square
- . Tourist attraction
- . Corridor

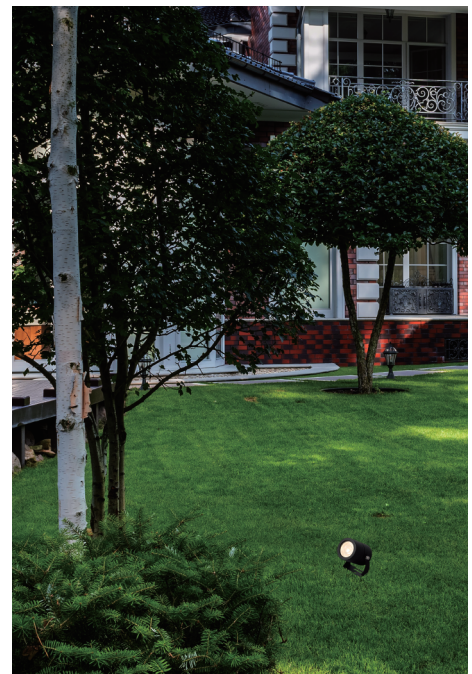
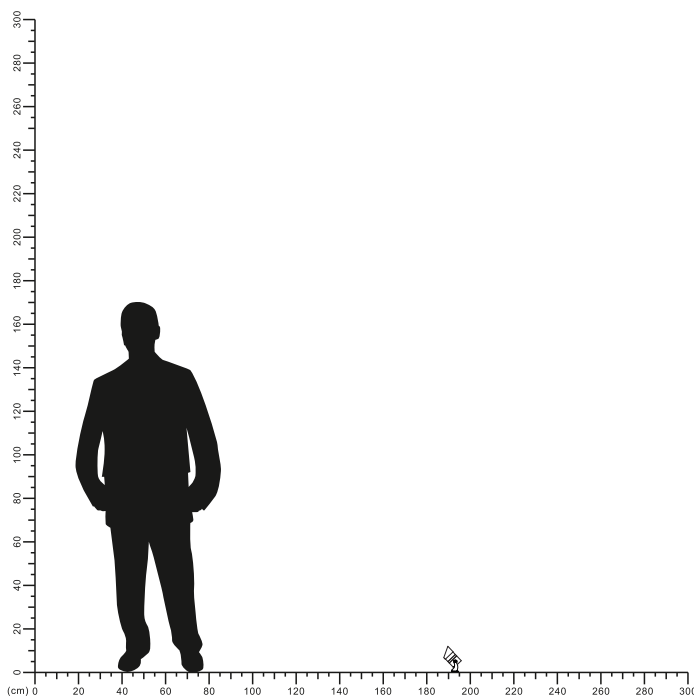

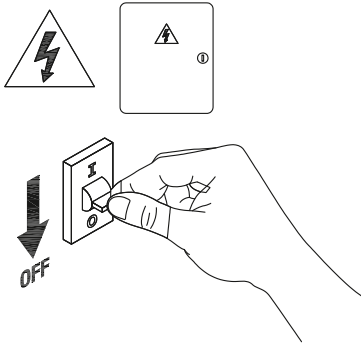

**1**

Turn off The Power

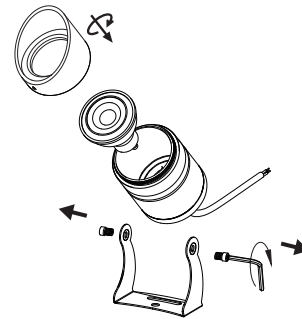

**2**

Install GU10 light source, tighten the cover  
Install anti-glare cup, take off the lamp holder

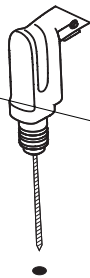

**3**

Drill 1 hole on the ground

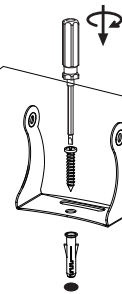

**4**

Insert the expansion screw, fix the light stand

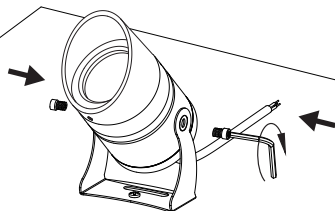

**5**

Tighten the screws and fix the lamp body

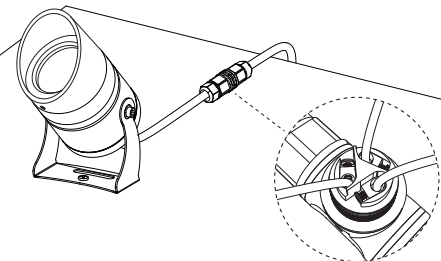

**6**

Wiring with waterproof terminals

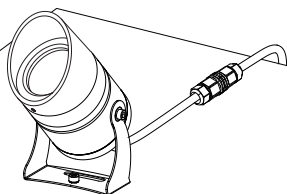

**7**

Installation completed

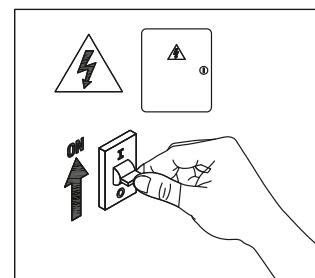

**8**

Turn on the power

