

LED Outdoor Wall Lamp

NR-OWL0401-10-30K-BK-120D
IP65

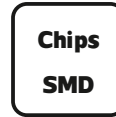
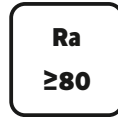
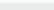

Model No	P (W)	PF	Beam Angel	Output (lm)	lm/w	Dimensions in mm			
						A	B	C	
NR-OWL0401-10-30K-BK-120D	10	≥0.7	120°	650	65	161	44	150	0.76

Dimensions in mm

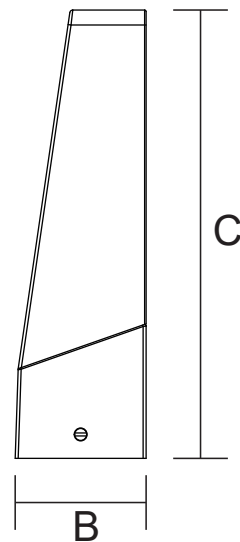
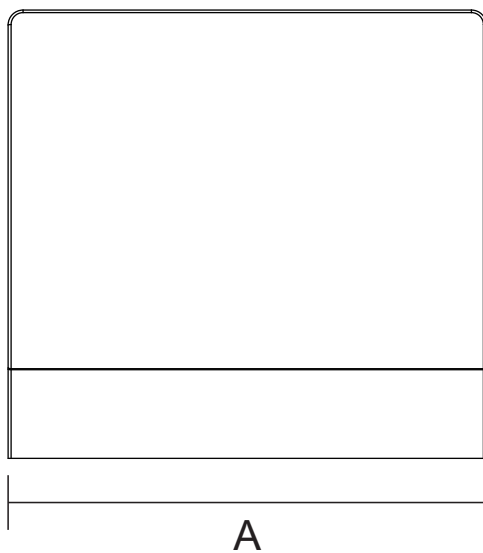

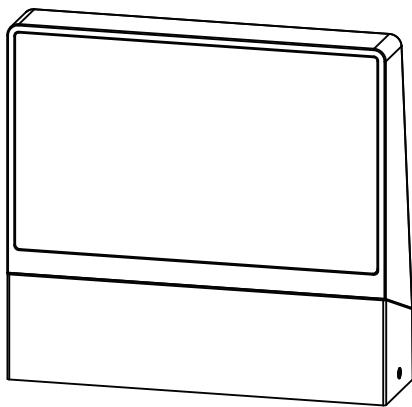
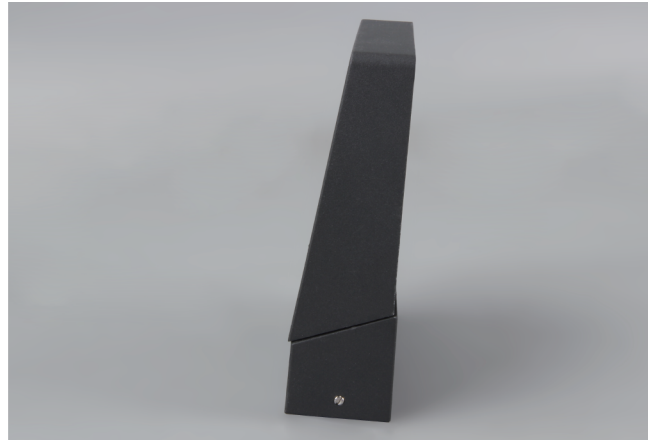

Description:
LED Outdoor Wall Lamp

Main material:
Aluminum+Pc

Specification
Aluminum lamp body integrated die-casting molding, spraying process, fine work, waterproof and dustproof. High light transmission PC material lamp shade, bright and not dazzling, anti-aging, long service life. IP65

Applications

- . Park
- . Square
- . Tourist attraction
- . Corridor

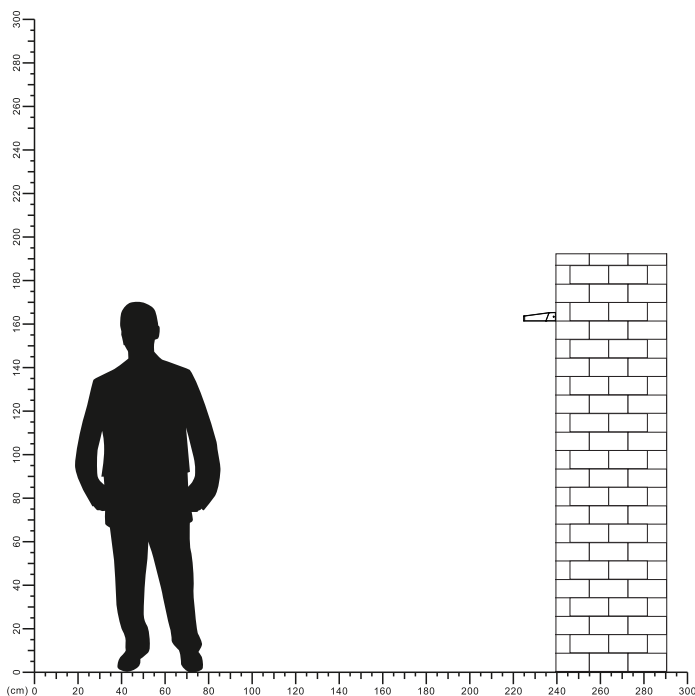

LUMINOUS INTENSITY DISTRIBUTION DIAGRAM

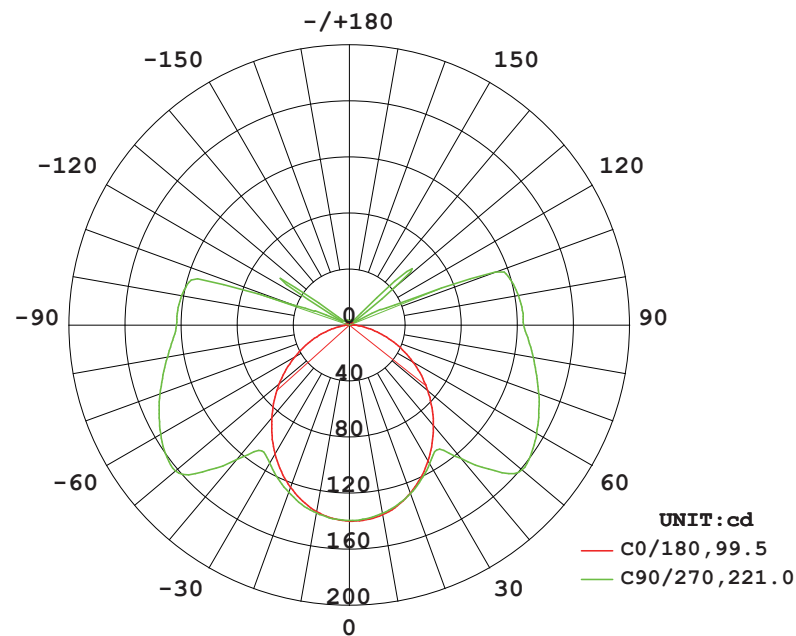

AVERAGE BEAM ANGLE (50%) : 160.2 DEG

Illuminance at a Distance

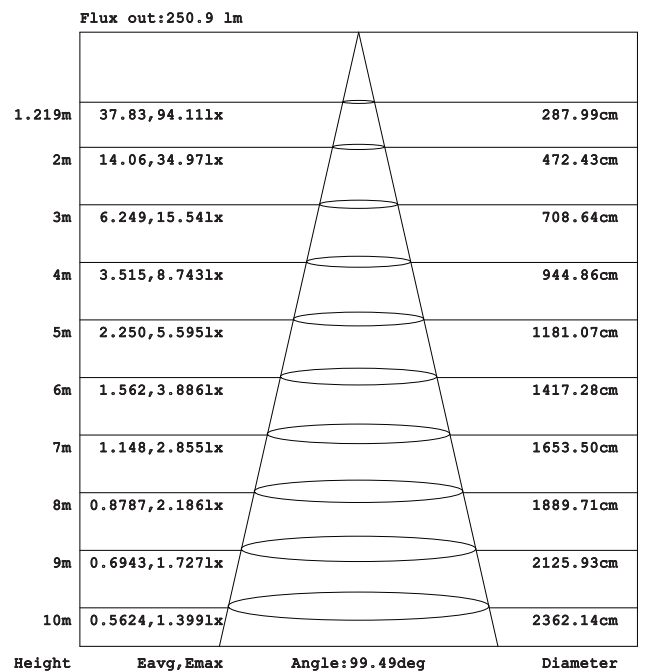

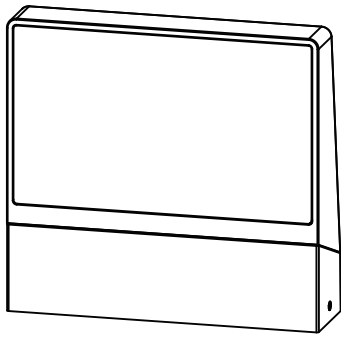

1

Turn off the power

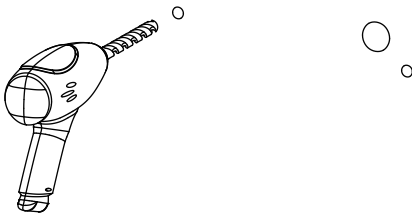
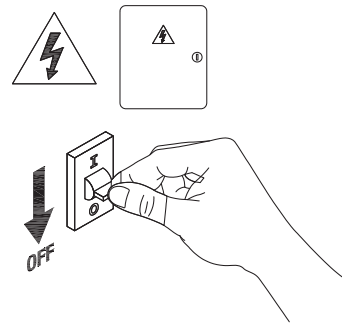

2

According to the holes in the baseplate position drill two screw holes on the wall

3

Insert the expansion screws install the base plate

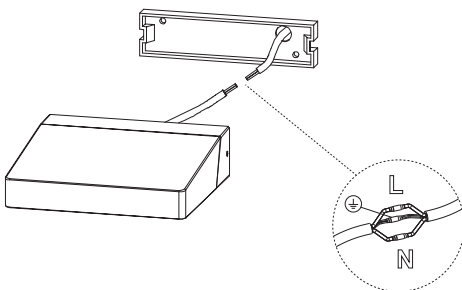
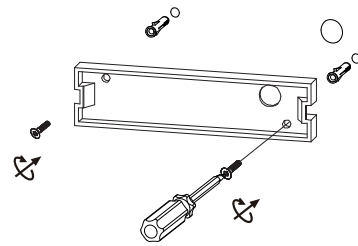

4

Terminals connect power cables and wrap terminals with waterproof tape

5

Tighten the screws to fix the lamp body

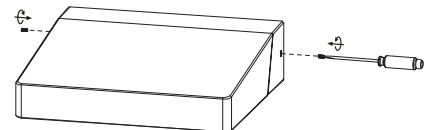

6

Installation completed

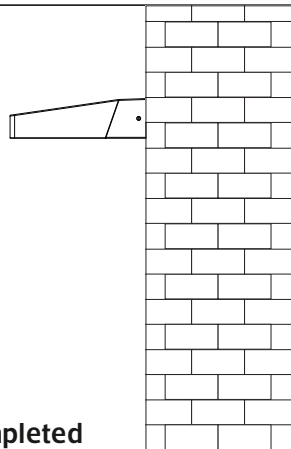

7

Turn on power

