

LED SURFACE PANEL LIGHT

NR-PL101S Series
IP20

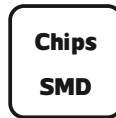
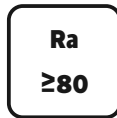

Item Code	P (W)	CCT (K)	Beam angle	Output (lm)	lm/w	Dimensions in mm		kg
						A	B	
NR-PL101S-18	18	3000/6500	120°	1440	80	Φ225	35	0.83
NR-PL101S-24	24	3000/4000/6500	120°	1920	80	Φ300	38	1.167

Dimensions in mm

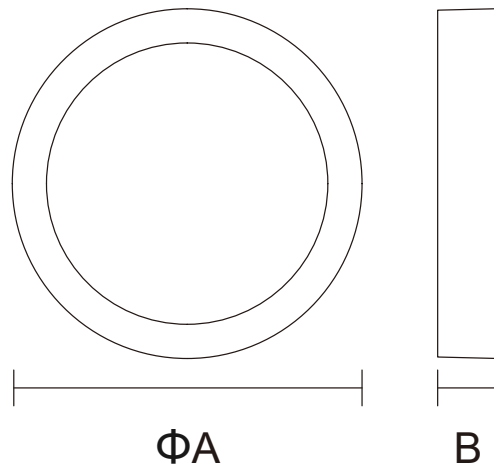

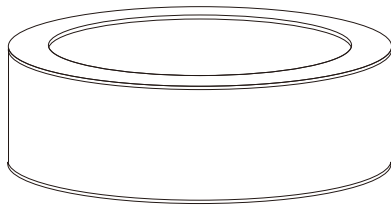
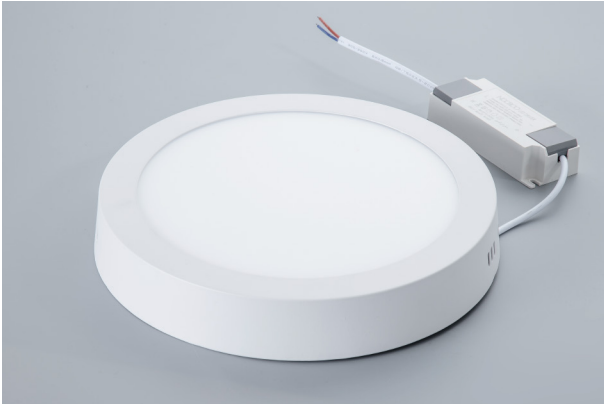

Description:
LED SURFACE PANEL LIGHT

Main material:
Aluminium+Engineering plastics

Specification
Energy saving, up to 85% energy saving comparing to standard halogen and incandescent lamps
High quality light, high color rendering, less heat, no UV or IR radiation
LED driver is included
IP20

Applications
. Shopping mall
. Office buildings
. Exhibition hall

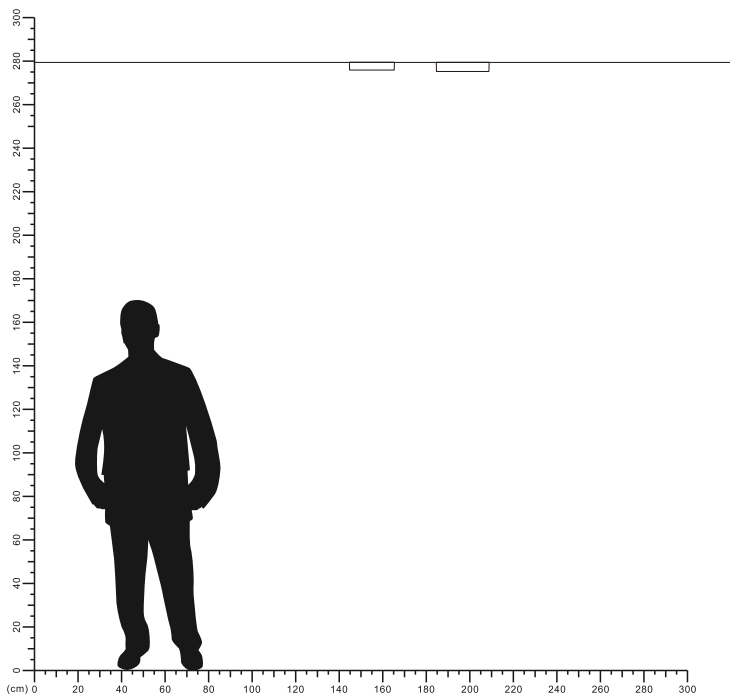

LUMINOUS INTENSITY DISTRIBUTION DIAGRAM

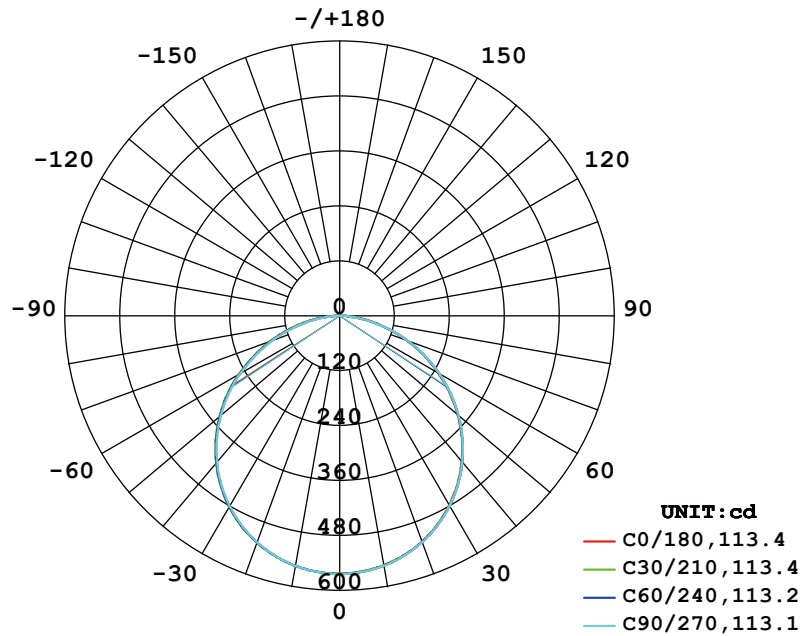

AVERAGE BEAM ANGLE (50%) : 113.3 DEG

Illuminance at a Distance

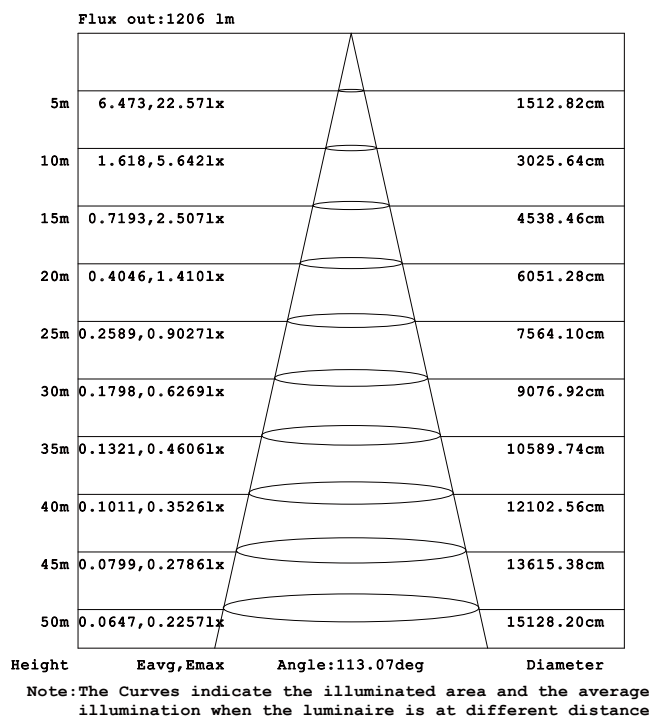

LUMINOUS INTENSITY DISTRIBUTION DIAGRAM

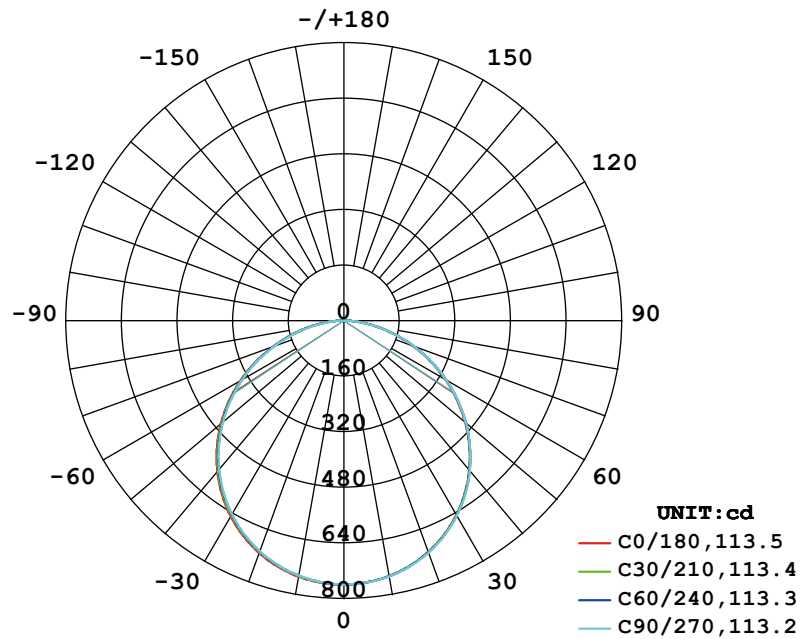

AVERAGE BEAM ANGLE (50%) : 113.4 DEG

Illuminance at a Distance

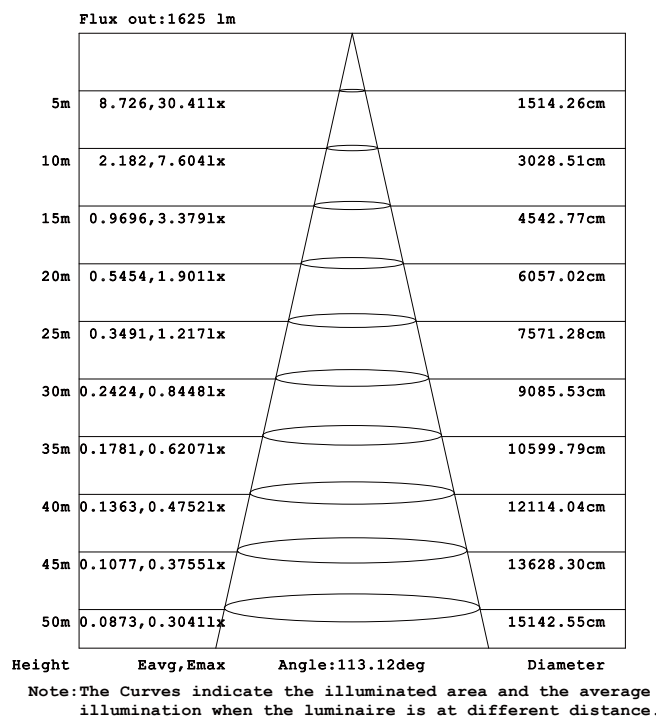

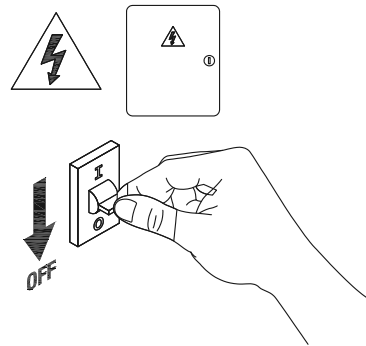
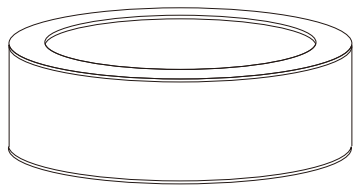

1

Turn off The Power

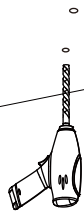

2

Drill 2 holes on your ceiling

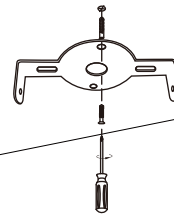

3

Fixing the base

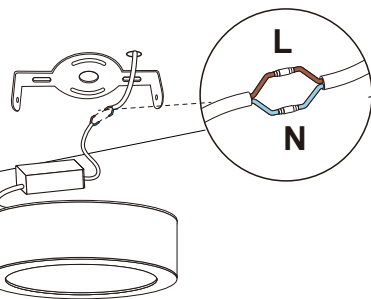

4

connect the cable

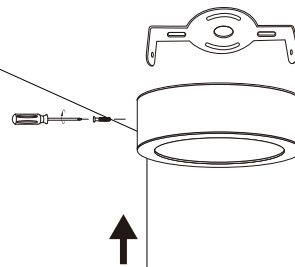

5

Fixing the lamp body



6

Installation completed

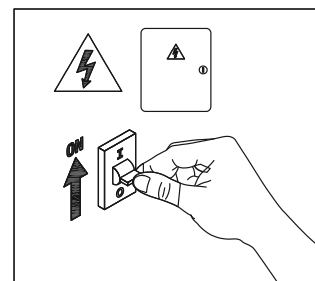

7

Turn on the power

