

LED SURFACE PANEL LIGHT

NR-PL103S Series
IP20

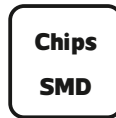
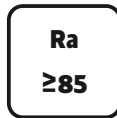

Item Code	P (W)	CCT (K)	Beam angle	Output (lm)	lm/w	Dimensions in mm		kg
						A	B	
NR-PL103S-24	24	3000/4000/6500	120°	1920	80	Φ380	60	0.63
NR-PL103S-36	36	3000/4000/6500	120°	2880	80	Φ480	60	0.73
NR-PL103S-SQ-24	24	3000/4000/6500	120°	1920	80	□330	60	0.48
NR-PL103S-SQ-36	36	3000/4000/6500	120°	2880	80	□430	60	0.81

Dimensions in mm

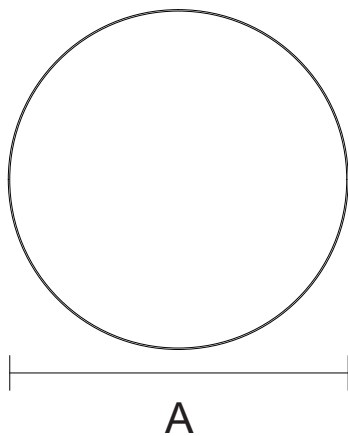

NR-PL103S

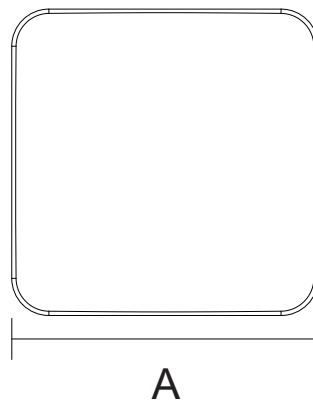
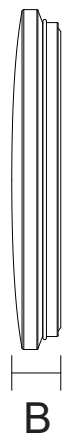

NR-PL103S-SQ



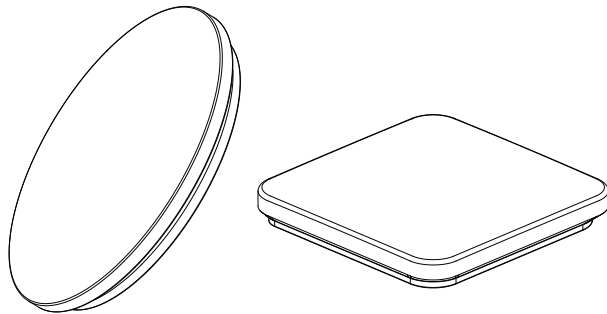

Description:
LED SURFACE PANEL LIGHT

Main material:
Iron+Engineering plastics

Specification
Energy saving, up to 85% energy saving comparing to standard halogen and incandescent lamps
High quality light, high color rendering, less heat, no UV or IR radiation
LED driver is included
IP20

Applications
. Shopping mall
. Office buildings
. Exhibition hall

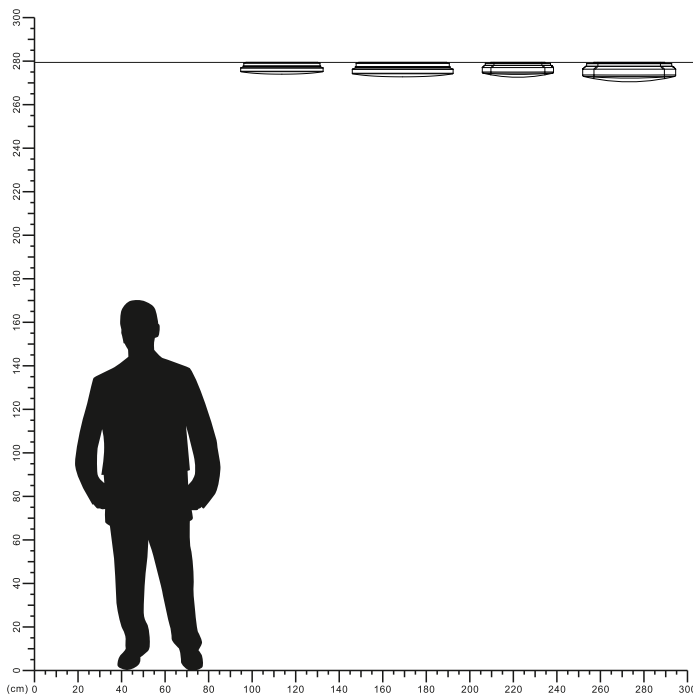

LUMINOUS INTENSITY DISTRIBUTION DIAGRAM

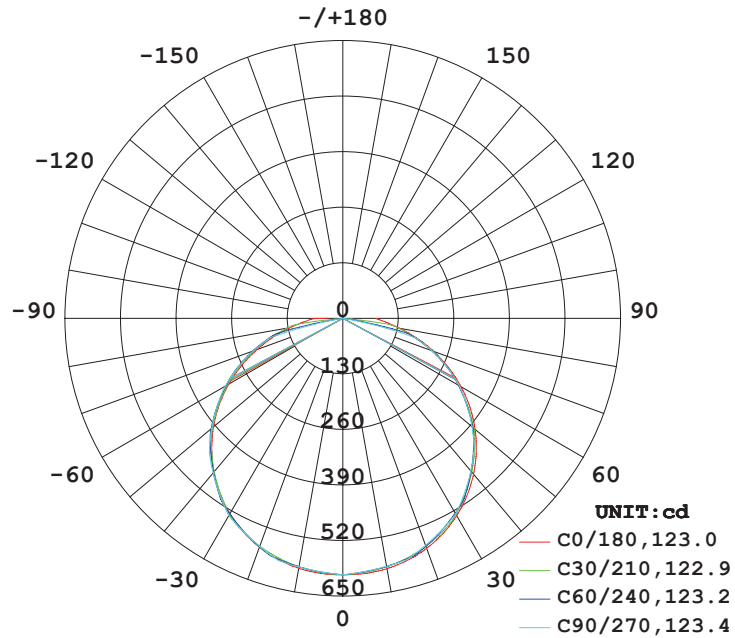

AVERAGE BEAM ANGLE (50%) : 123.1 DEG

Illuminance at a Distance

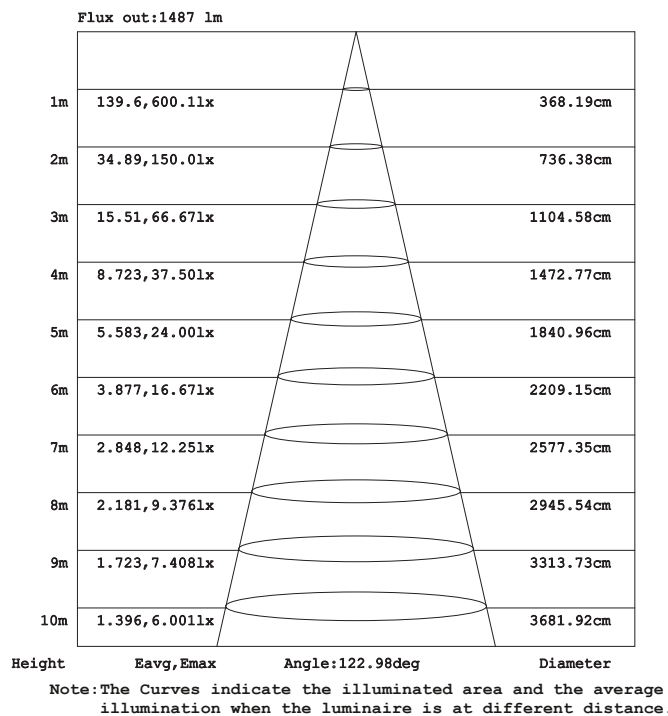

LUMINOUS INTENSITY DISTRIBUTION DIAGRAM

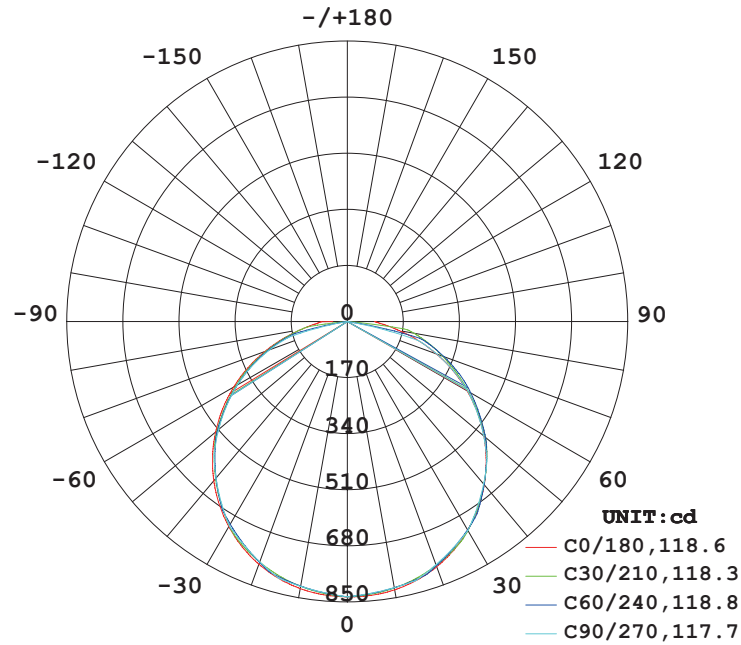

AVERAGE BEAM ANGLE (50%) : 118.3 DEG

Illuminance at a Distance

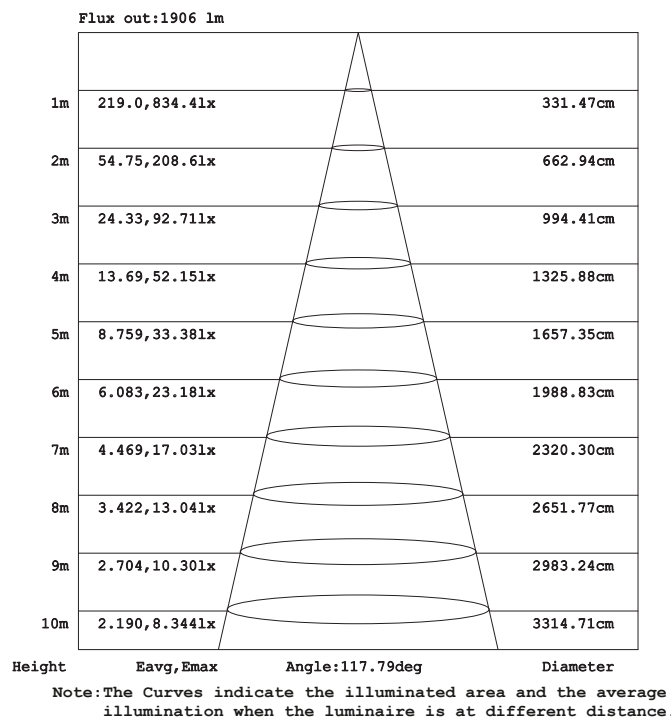

LUMINOUS INTENSITY DISTRIBUTION DIAGRAM

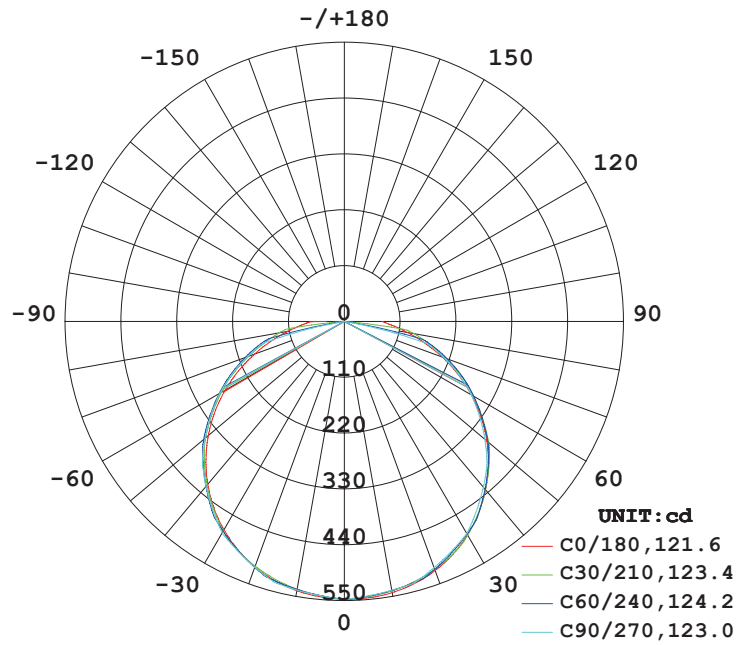

AVERAGE BEAM ANGLE (50%) : 123.0 DEG

Illuminance at a Distance

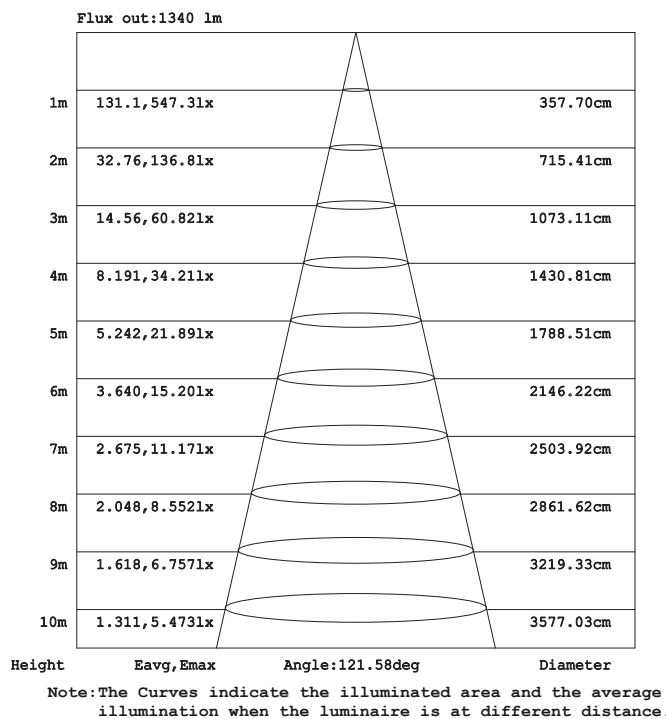

Model: NR-PL103S-SQ-24

LUMINOUS INTENSITY DISTRIBUTION DIAGRAM

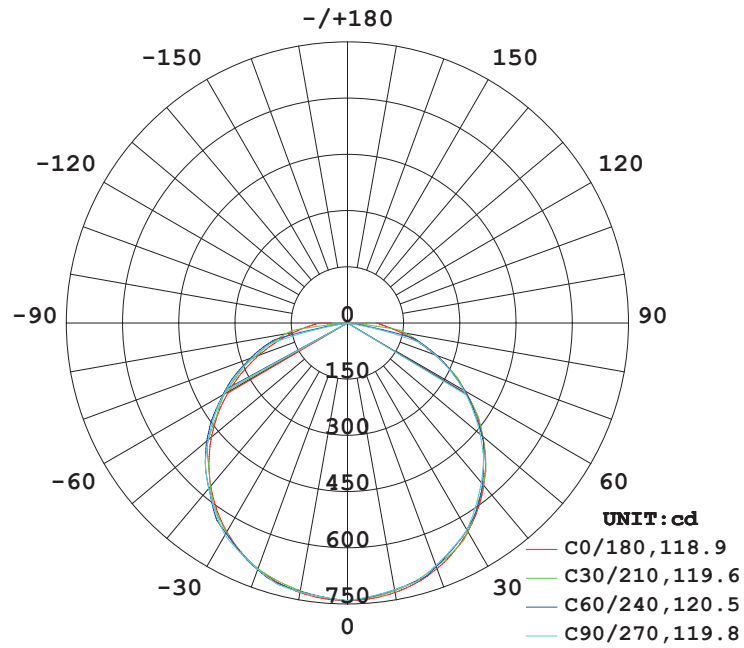

AVERAGE BEAM ANGLE (50%) : 119.7 DEG

Illuminance at a Distance

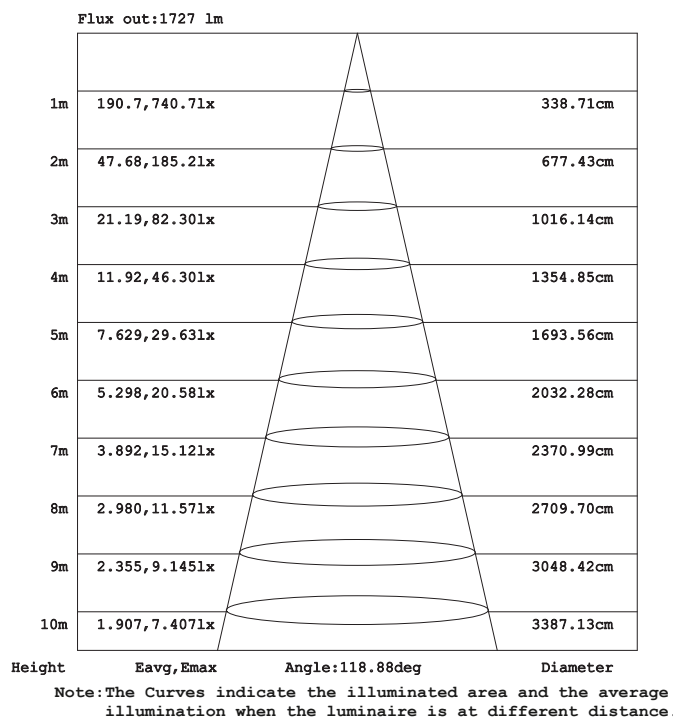

Model: NR-PL103S-SQ-36

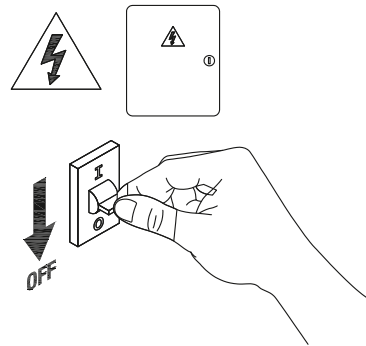
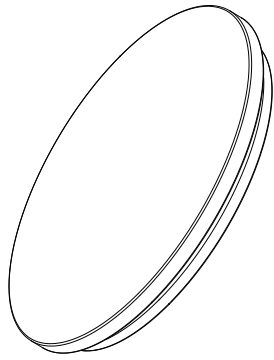

1

Turn off The Power

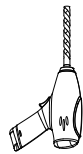

2

Drill 4 holes on your ceiling

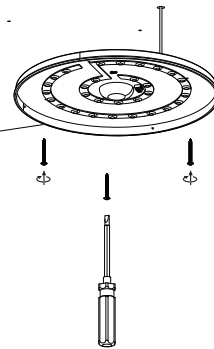

3

Fixing the base

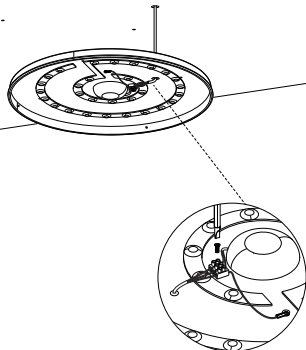

4

connect the cable

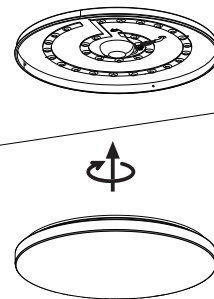

5

Put the PC cover into the base



6

Installation completed

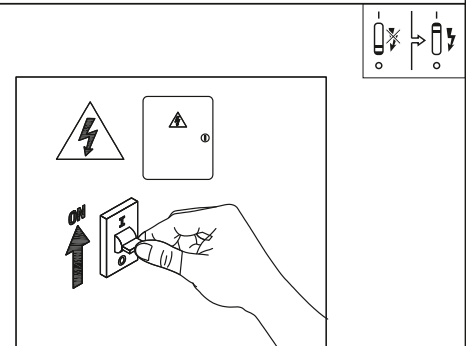

7

Turn on the power

