

MAGNETIC ADAPTER

NR-S20-S35-USB

IP20

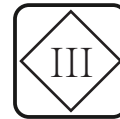
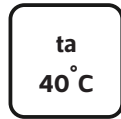

Item Code	Color	Input	2*USB Output	Type-C Output	Watt	Dimensions in mm			kg
						A	B	C	
NR-S20-S35-USB-BK	Black	DC48V	5V ⋮ 3A	5V ⋮ 3A 9V ⋮ 2.22A 12V ⋮ 1.67A	20W	150	23	42	0.09
NR-S20-S35-USB-WH	White	DC48V	5V ⋮ 3A	5V ⋮ 3A 9V ⋮ 2.22A 12V ⋮ 1.67A	20W	150	23	42	0.09

Dimensions in mm

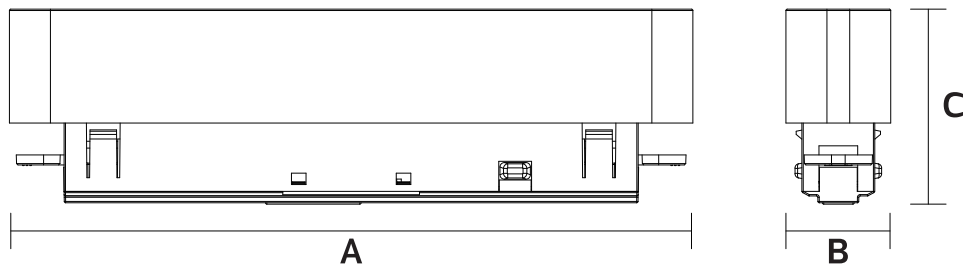

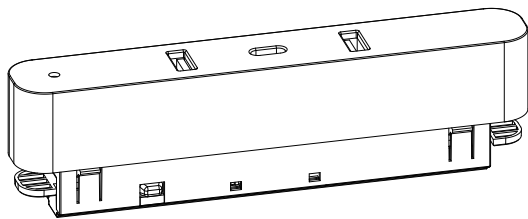
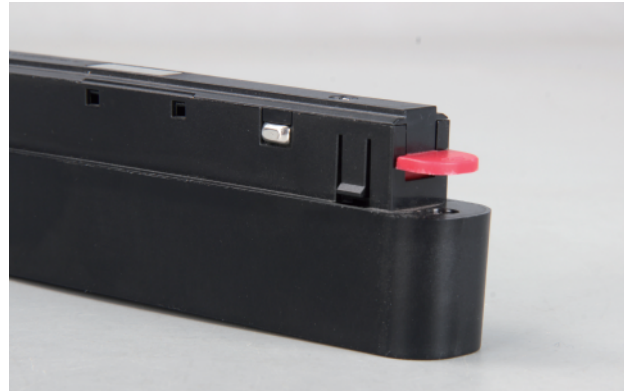

Description:
MAGNETIC ADAPTER

Main material:
PC+PA

Specification:
Free movement, flexible power extraction,
high temperature flame retardant
IP20

Applications
.Office
.Meeting room
.Sitting room

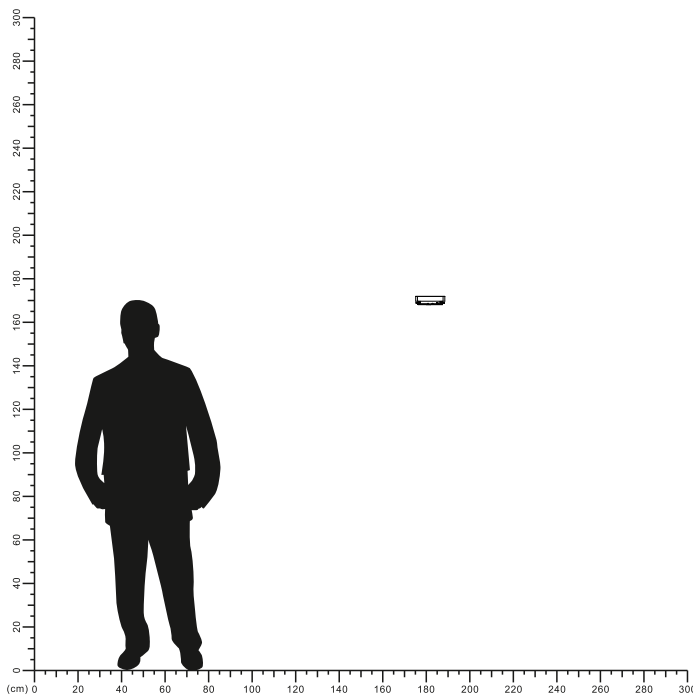

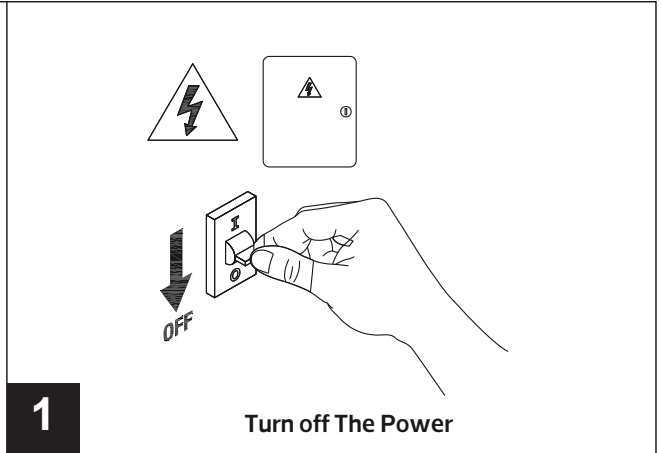
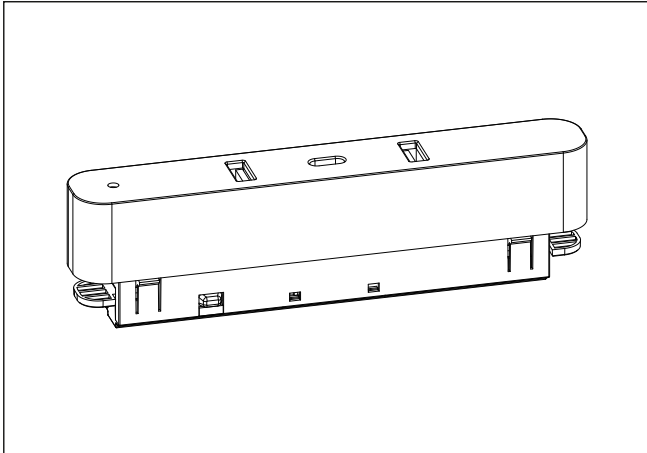

1

Turn off The Power

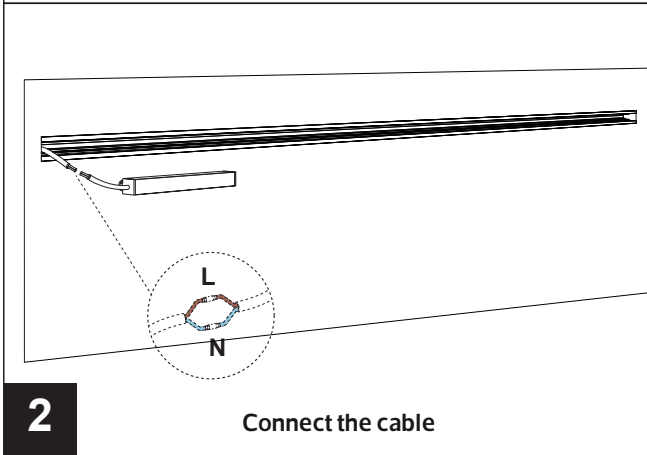

2

Connect the cable

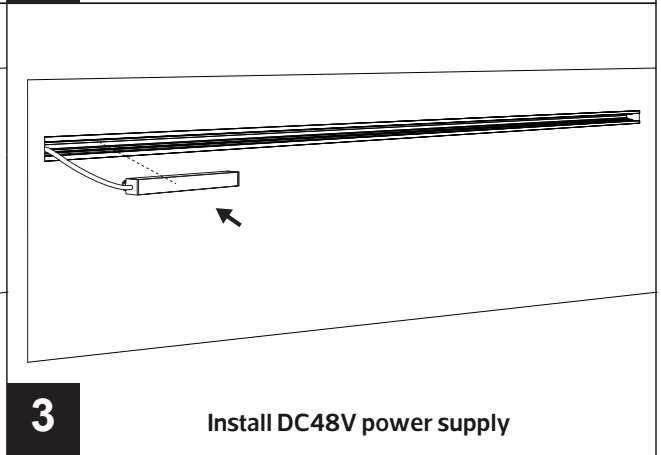

3

Install DC48V power supply

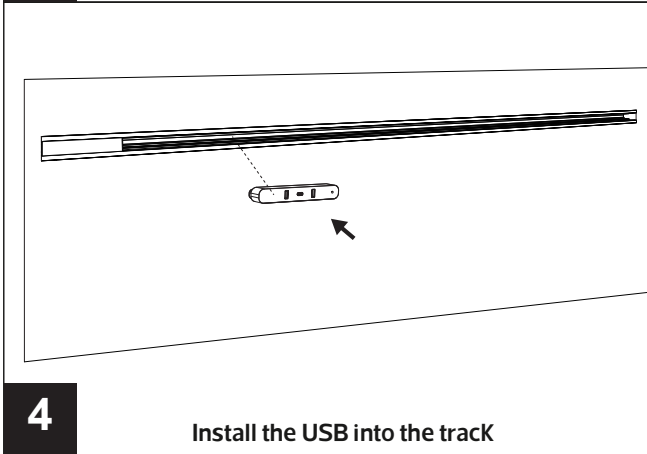

4

Install the USB into the track

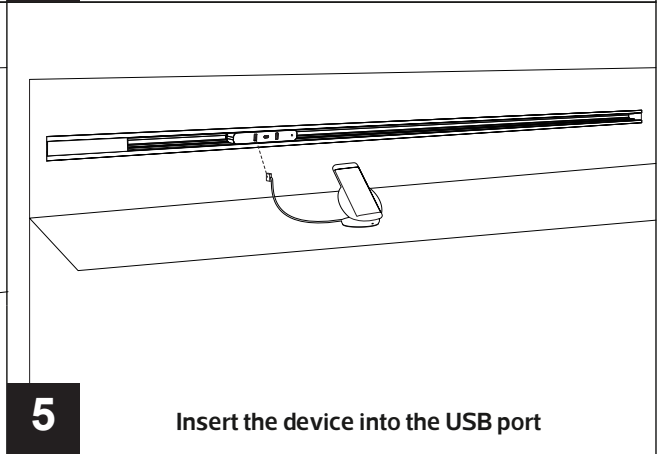

5

Insert the device into the USB port

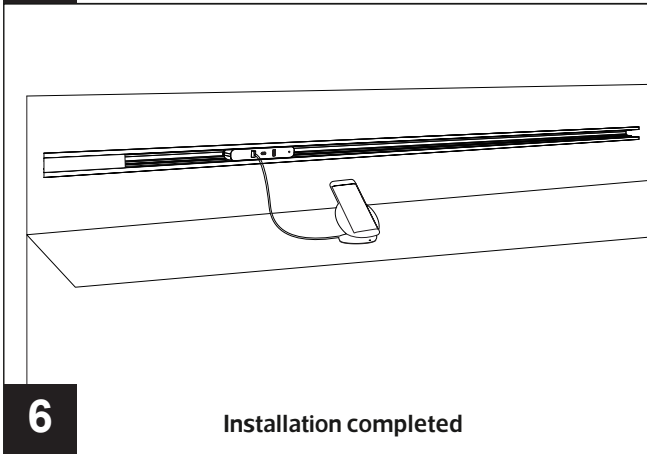

6

Installation completed

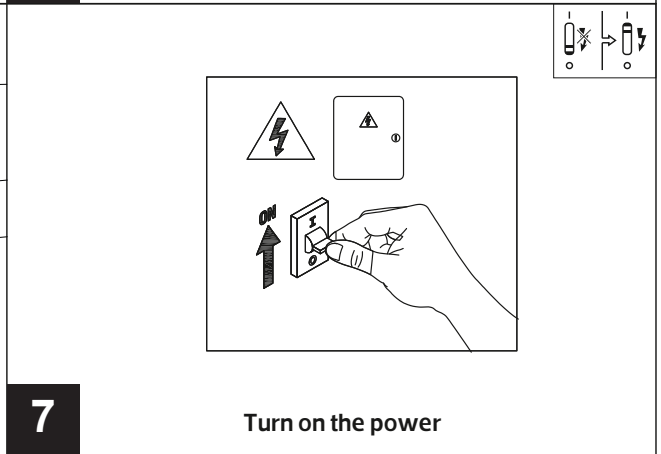

7

Turn on the power

