

LED OUTDOOR LAWN LAMP

NR-SP101-3

IP65

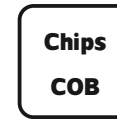
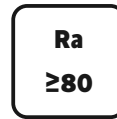

| Item Code | P (W) | CCT (K) | Beam angle | Output (lm) | lm/w | Dimensions in mm | | | kg |
|------------|-------|---------|------------|-------------|------|------------------|----|-----|------|
| | | | | | | A | B | C | |
| NR-SP101-3 | 3 | 3000 | 36° | 210 | 70 | 57 | 43 | 111 | 0.22 |

Dimensions in mm

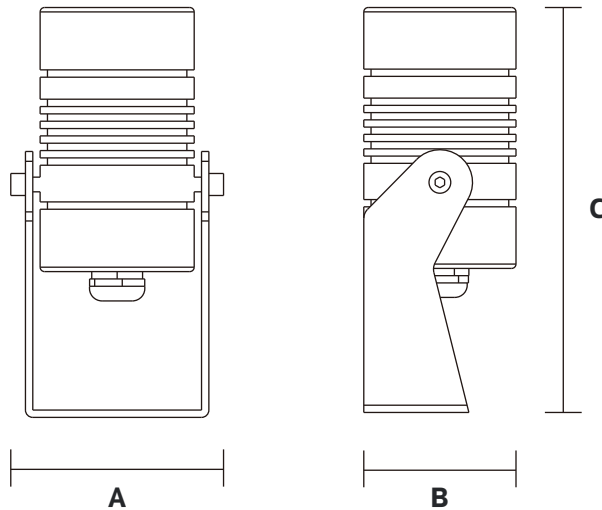

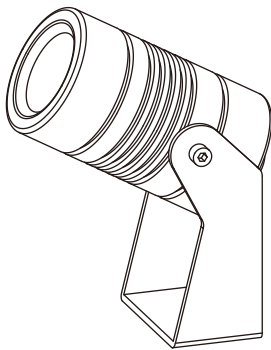

Description:
LED OUTDOOR LAWN LAMP

Main material:
Aluminum+Engineering plastics

Specification
Energy saving, up to 85% energy saving comparing to standard halogen and incandescent lamps
High quality light, high color rendering, less heat, no UV or IR radiation
Build-in LED Driver
IP65

Applications

- . Park
- . Square
- . Tourist attraction
- . Corridor

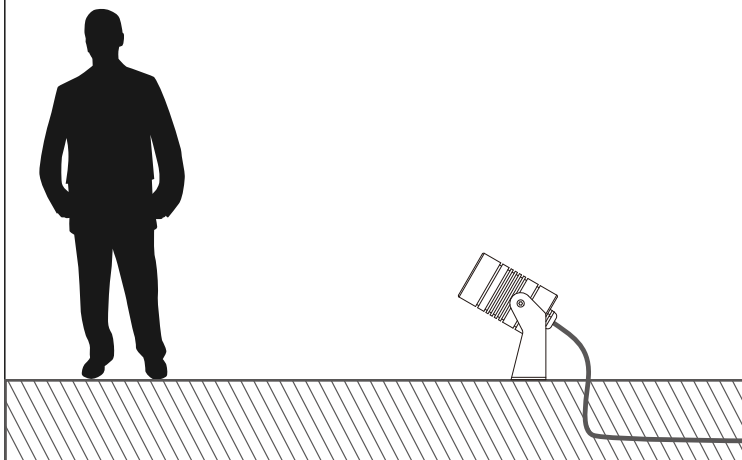

LUMINOUS INTENSITY DISTRIBUTION DIAGRAM

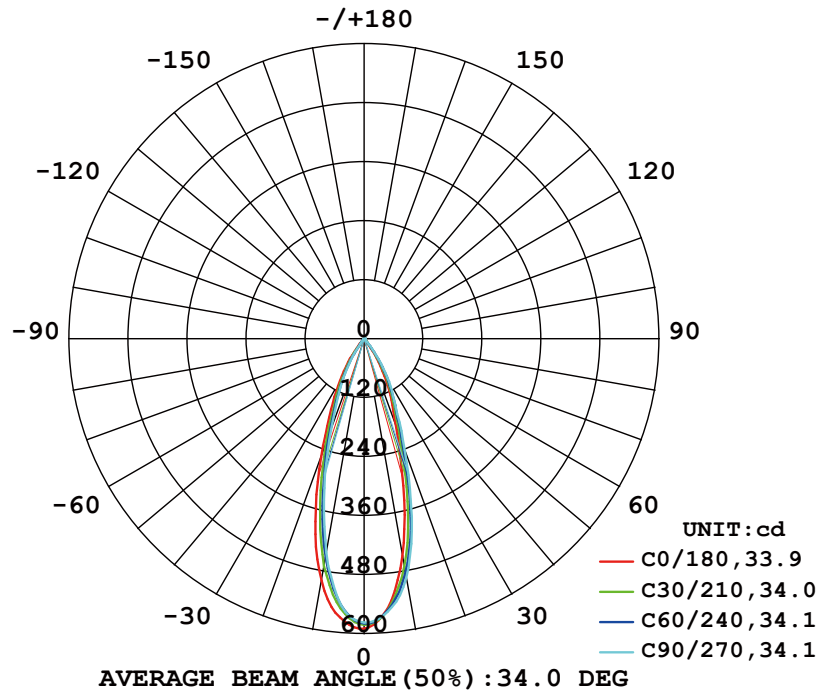

Illuminance at a Distance

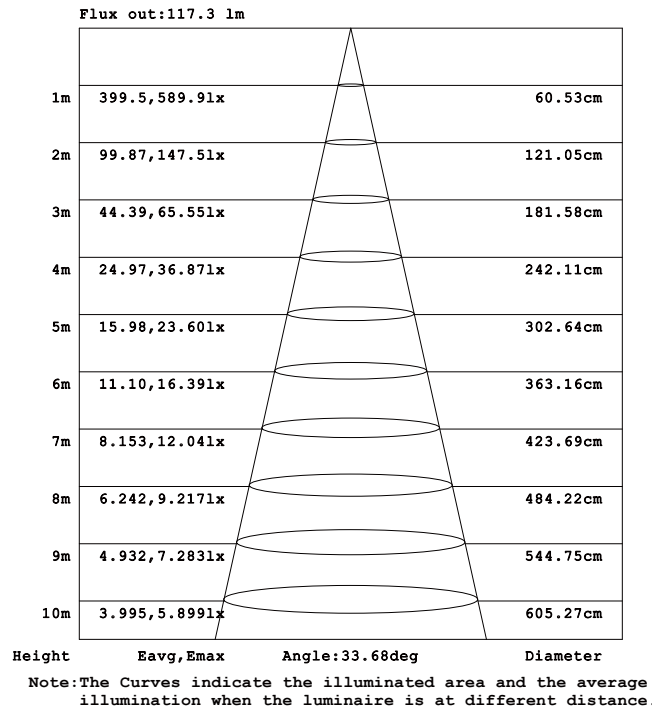

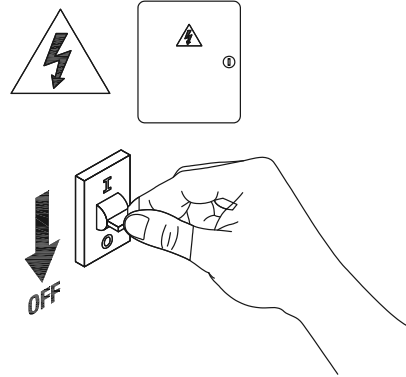
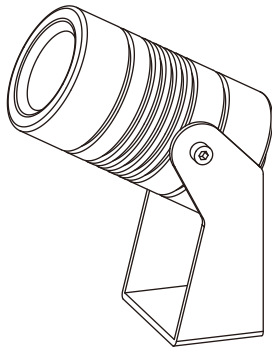

1

Turn off The Power

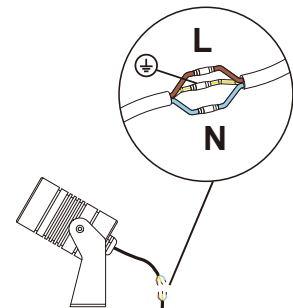

2

Drill two hole on your ground

3

Connect the cable

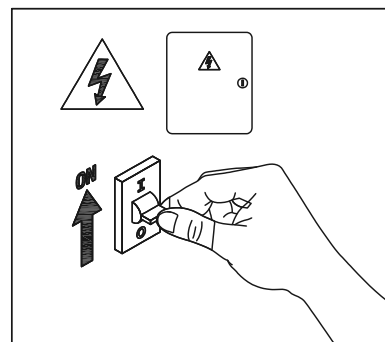
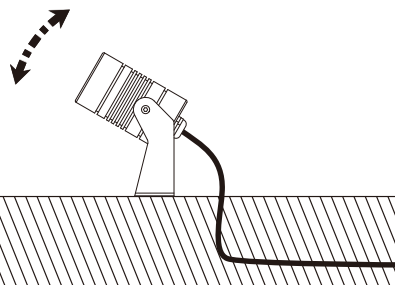

4

Ajustable the angle

5

Turn on the power

