

T5 LED Line Light

NR-T5 Series
IP20

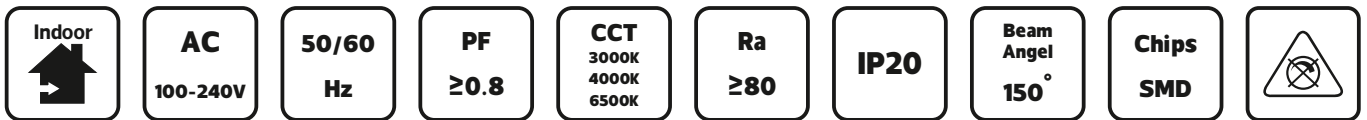
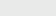

Item Code	P(W)	Color	CCT(K)	Total Lumen	Beam Angle	Dimensions in mm			
						A	B	C	
NR-T5-30-4	4	White	3000/4000/6500	312	150°	300	21	35	0.05
NR-T5-60-7	7	White	3000/4000/6500	665	150°	600	21	35	0.1
NR-T5-90-12	12	White	3000/4000/6500	1280	150°	900	21	35	0.15
NR-T5-120-18	18	White	3000/4000/6500	1887	150°	1200	21	35	0.2

Dimensions in mm

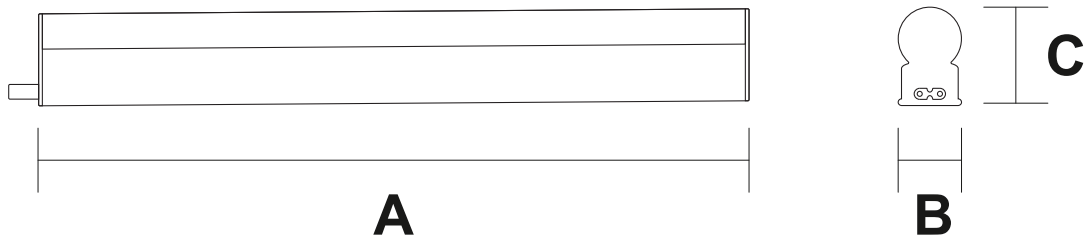



Description:
T5 LED Line Light

Main material:
PC, anti-corrosion, anti-rust, no fading, fashion modeling

Specification:
Energy saving, upto 85% energy saving comparing to standard halogen and incandescent lamps Long life, upto 50,000 hours
High quality light, high color rendering, less heat, no UV or IR radiation

Applications
Shoping mall
Office buildings
Exhibition hall

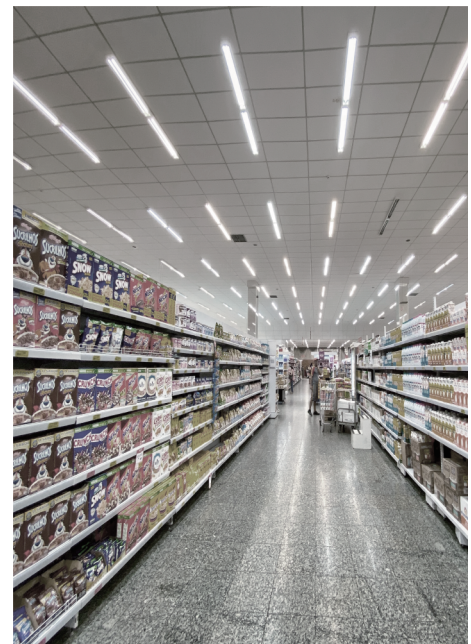
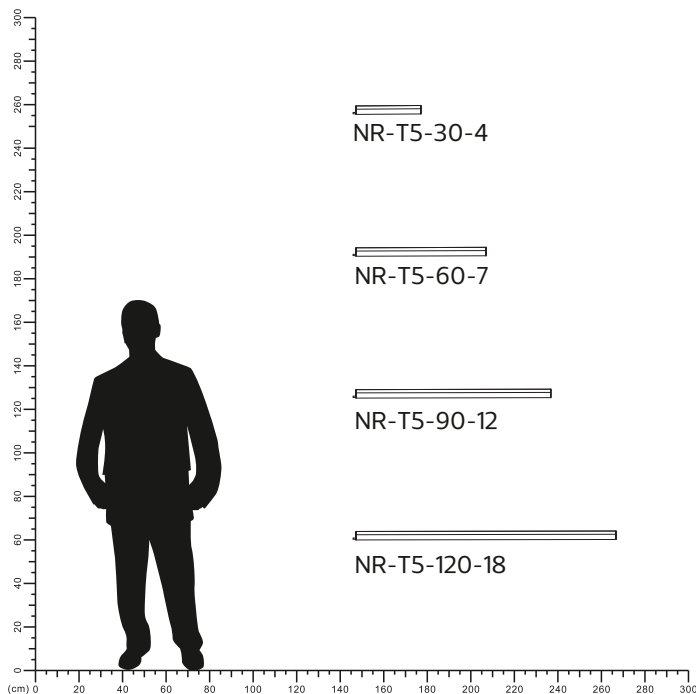

LUMINOUS INTENSITY DISTRIBUTION DIAGRAM

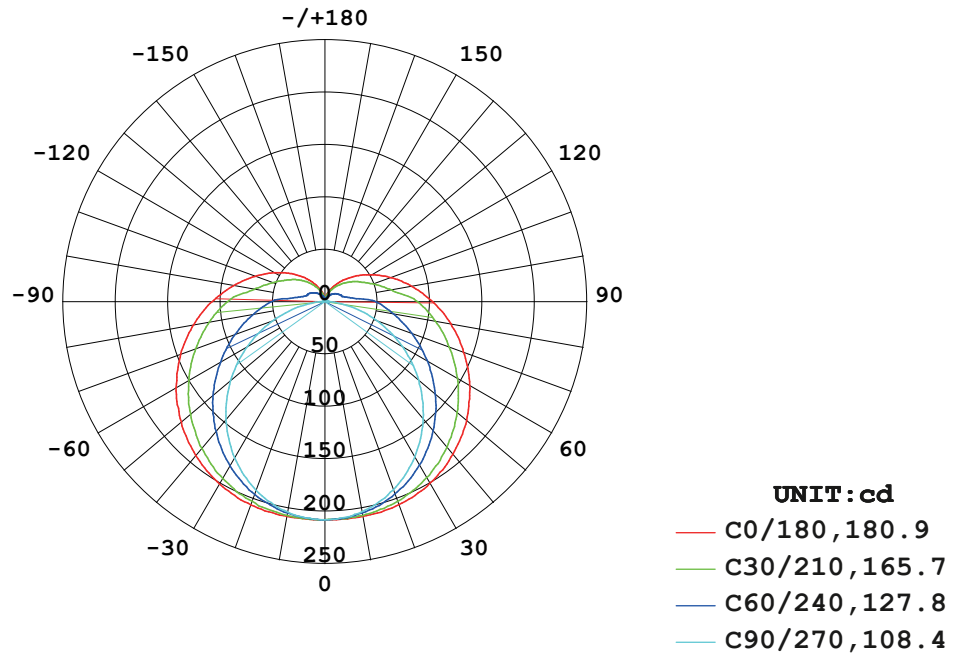

AVERAGE BEAM ANGLE (50%) : 145.7 DEG

Illuminance at a Distance

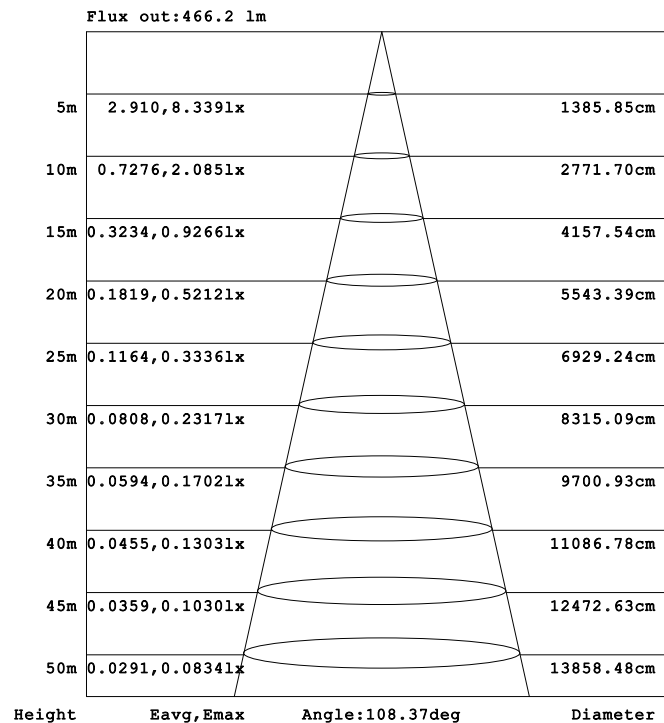

LUMINOUS INTENSITY DISTRIBUTION DIAGRAM

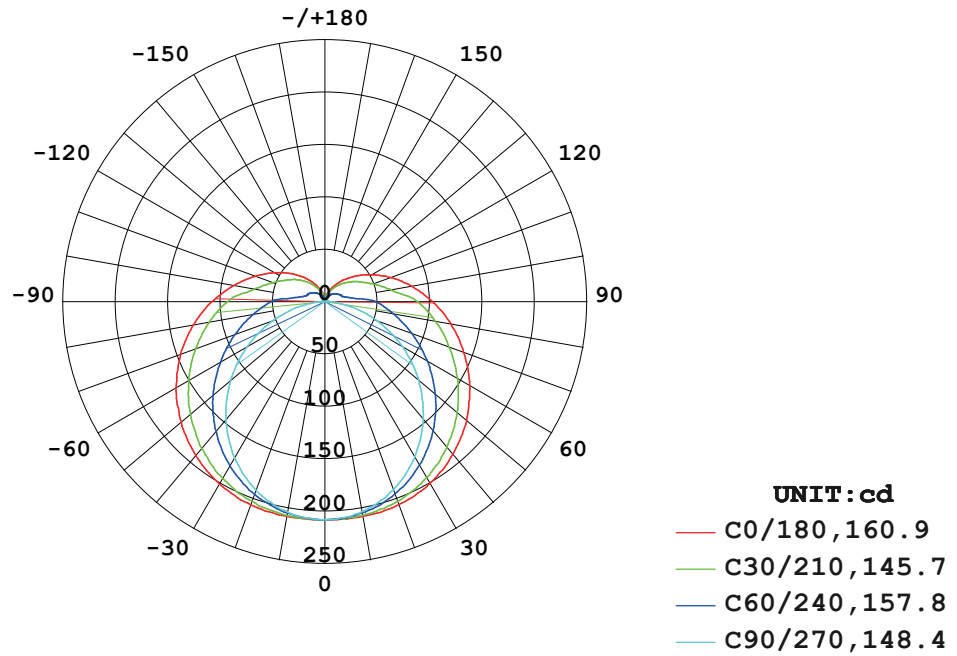

AVERAGE BEAM ANGLE (50%) : 140.3 DEG

Illuminance at a Distance

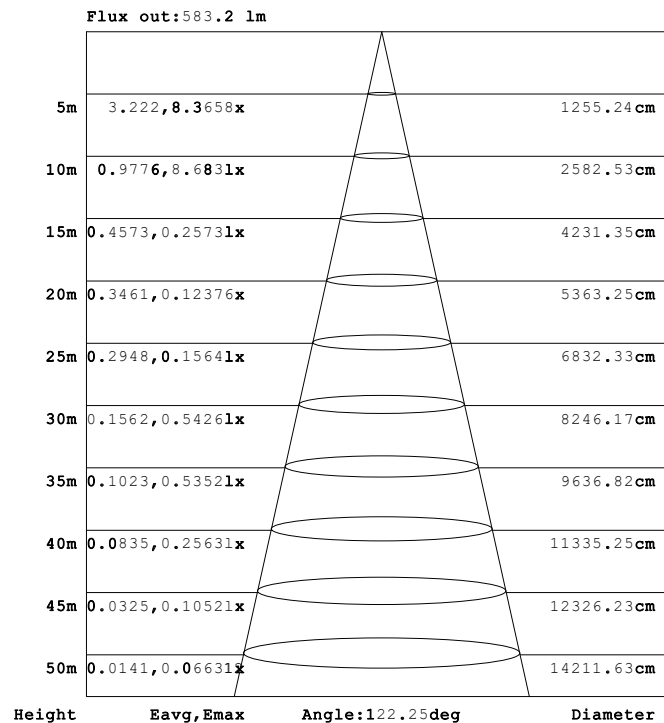

LUMINOUS INTENSITY DISTRIBUTION DIAGRAM

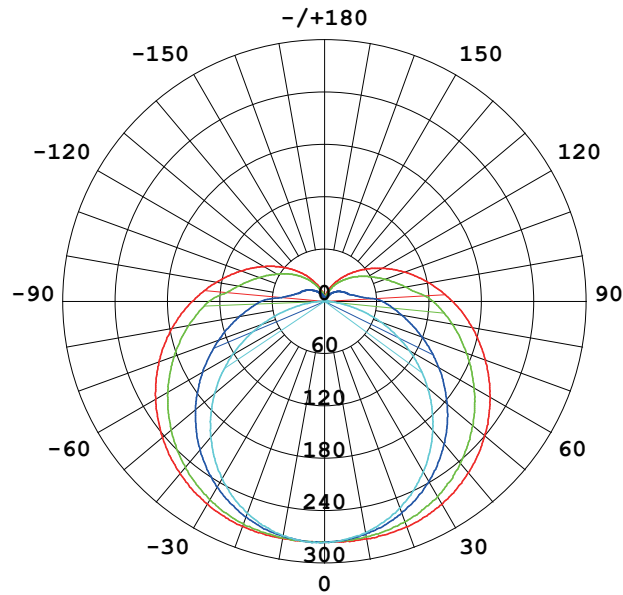

AVERAGE BEAM ANGLE (50%) : 150.4 DEG

Illuminance at a Distance

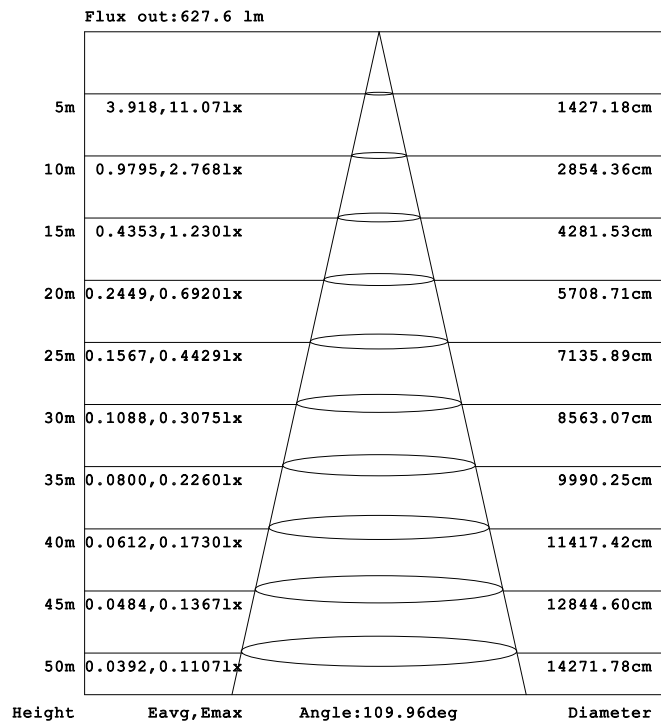

LUMINOUS INTENSITY DISTRIBUTION DIAGRAM

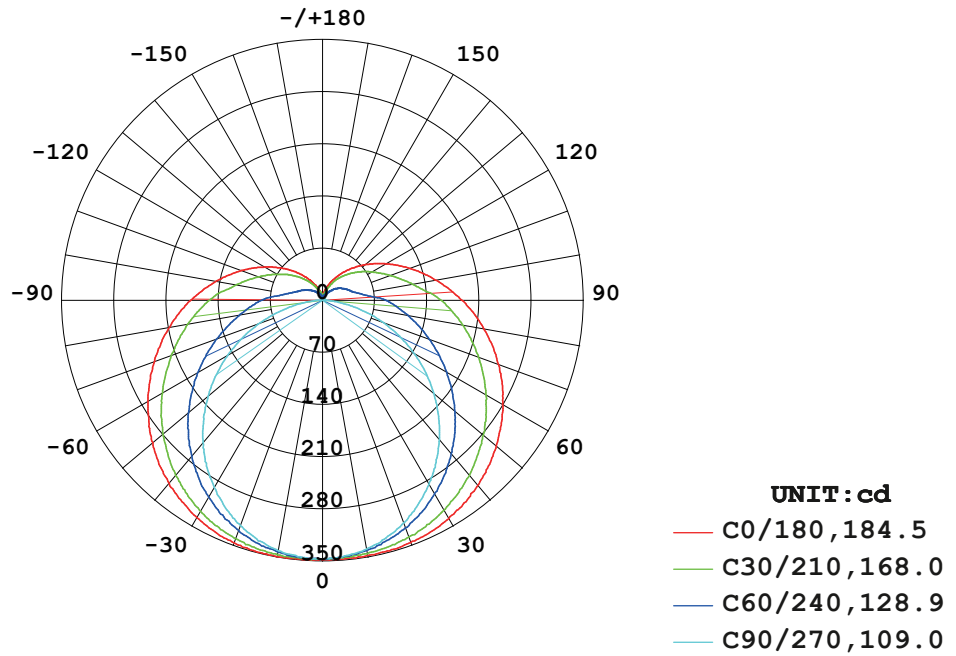

AVERAGE BEAM ANGLE (50%) : 147.6 DEG

Illuminance at a Distance

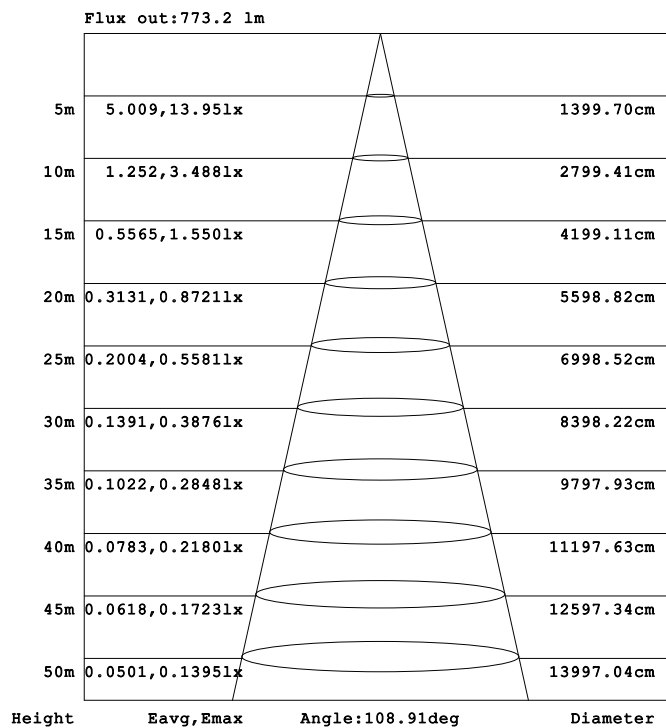

Warm Tips:
Not more than five series



1

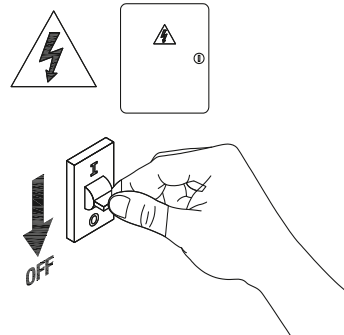

2

Turn off The Power

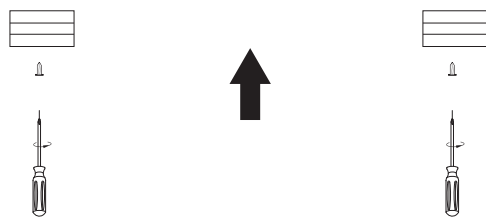

3

Install two clasps on the surface

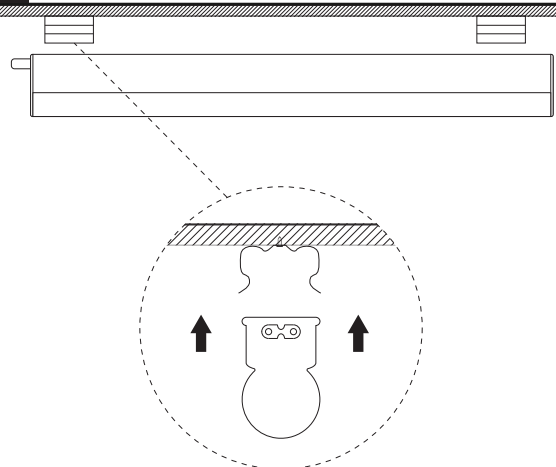

4

Clamp the T5 LED line light to the two clasps

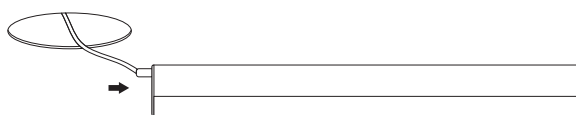

5

Connect the cable

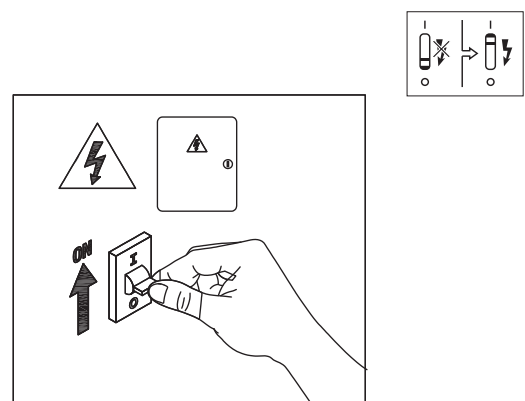

6

Turn on the power

