

LED Magnetic Track System

NR-TL3660-6

IP20



| | | | | | | | | | |
|------------|-----------|--------------|-----------|----------------------------|-------------------|------|----------------------|--------------|--|
| Indoor | DC 48V | CCT 3000K | Ra ≥90 | Average 30,000 Hours | ON OFF ≥15,000 | IP20 | Beam Angle 24° | Chips COB | |
|------------|-----------|--------------|-----------|----------------------------|-------------------|------|----------------------|--------------|--|

| Item Code | P(W) | Using Track | Total Lumen | Beam Angle | Dimensions in mm | | | kg |
|-------------|------|---------------|-------------|------------|------------------|-----|-----|------|
| A | B | C | | | | | | |
| NR-TL3660-6 | 6 | NR-S20/NR-S35 | 426 | 24° | 150 | Φ35 | 152 | 0.12 |

Dimensions in mm

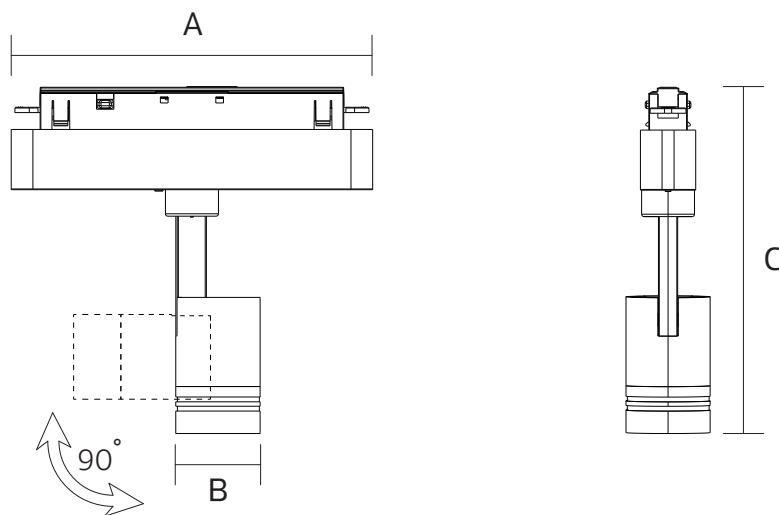

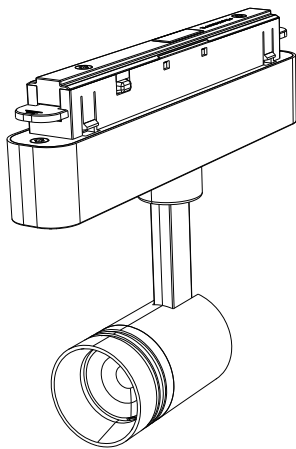

Description:
LED Magnetic Track System

Main material:
Aluminum shell, Silica gel

Specification:
Energy saving, up to 85% energy saving comparing to standard halogen and incandescent lamps
High quality light, high color rendering, less heat, no UV or IR radiation
Build-in LED Driver

Applications
.Office
.Meeting room
.Sitting room

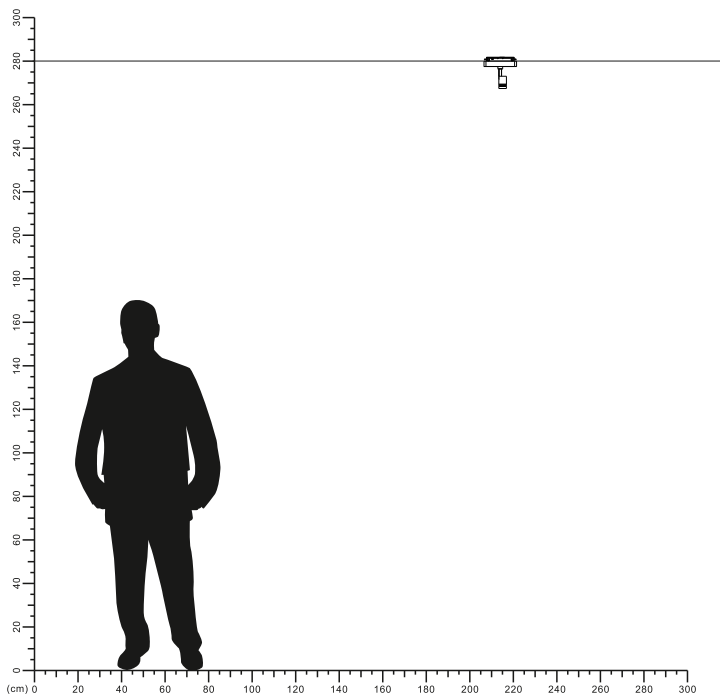

LUMINOUS INTENSITY DISTRIBUTION DIAGRAM

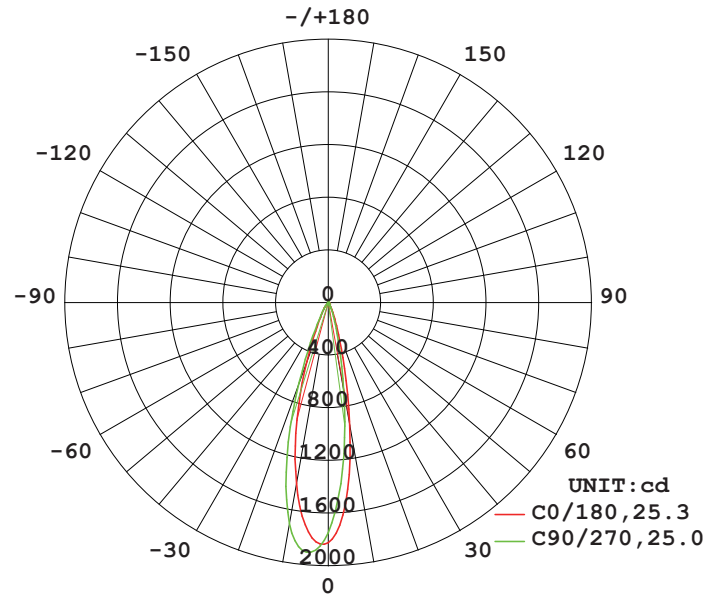

AVERAGE BEAM ANGLE (50%) : 25.1 DEG

Illuminance at a Distance

Flux out: 204.0 lm

| Height | Eavg, Emax | Angle: 24.99deg | Diameter |
|--------|------------------|-----------------|-----------|
| 5m | 48.72, 76.48lx | | 221.56cm |
| 10m | 12.18, 19.12lx | | 443.13cm |
| 15m | 5.414, 8.498lx | | 664.69cm |
| 20m | 3.045, 4.780lx | | 886.25cm |
| 25m | 1.949, 3.059lx | | 1107.81cm |
| 30m | 1.353, 2.124lx | | 1329.38cm |
| 35m | 0.9943, 1.561lx | | 1550.94cm |
| 40m | 0.7613, 1.195lx | | 1772.50cm |
| 45m | 0.6015, 0.9442lx | | 1994.06cm |
| 50m | 0.4872, 0.7648lx | | 2215.63cm |

Note: The Curves indicate the illuminated area and the average illumination when the luminaire is at different distance.

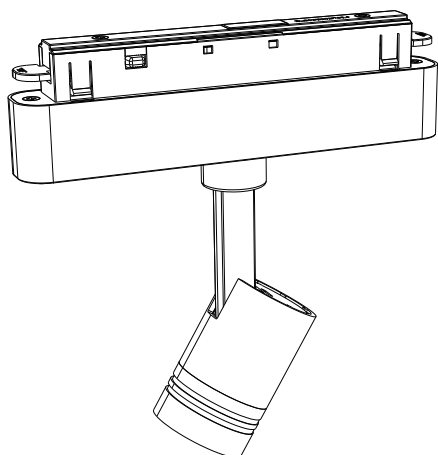

1

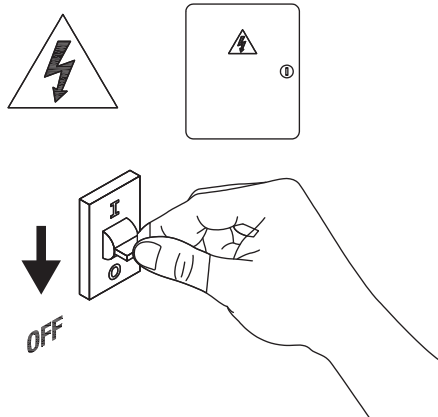

2

Turn off the power

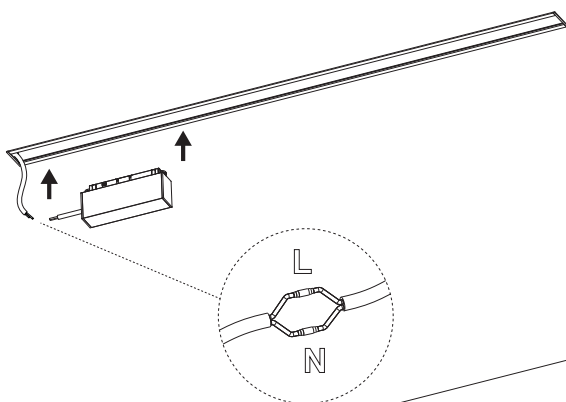

3

connect the cable

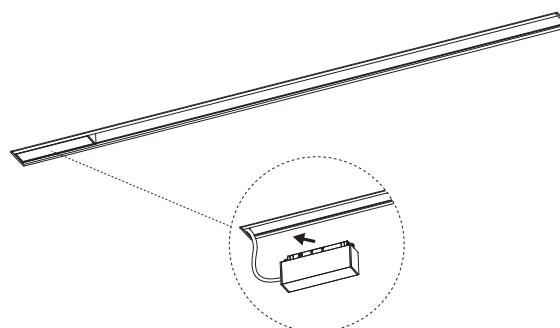

4

Install DC48V power supply

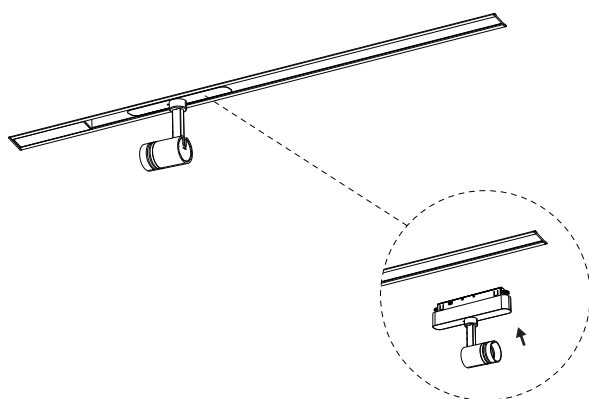

5

Install lamp the Installation is complete

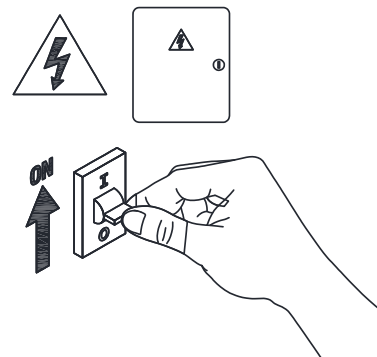

6

Turn on power

