

LED Magnetic Track System

NR-TL3660-6

IP20



Indoor 	DC 48V	CCT 3000K	Ra ≥90	Average 30,000 Hours	ON OFF ≥15,000	IP20	Beam Angle 24°	Chips COB	
------------	-----------	--------------	-----------	----------------------------	-------------------	------	----------------------	--------------	--

Item Code	P(W)	Using Track	Total Lumen	Beam Angle	Dimensions in mm			
A	B	C						
NR-TL3660-6	6	NR-S20/NR-S35	426	24°	150	Φ35	152	0.12

Dimensions in mm

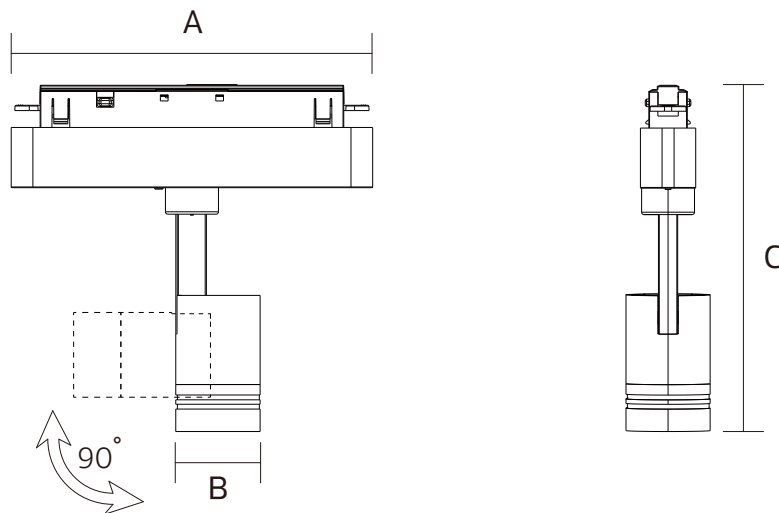

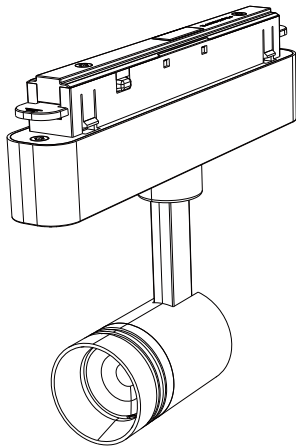

Description:
LED Magnetic Track System

Main material:
Aluminum shell, Silica gel

Specification:
Energy saving, up to 85% energy saving comparing to standard halogen and incandescent lamps
High quality light, high color rendering, less heat, no UV or IR radiation
Build-in LED Driver

Applications
.Office
.Meeting room
.Sitting room

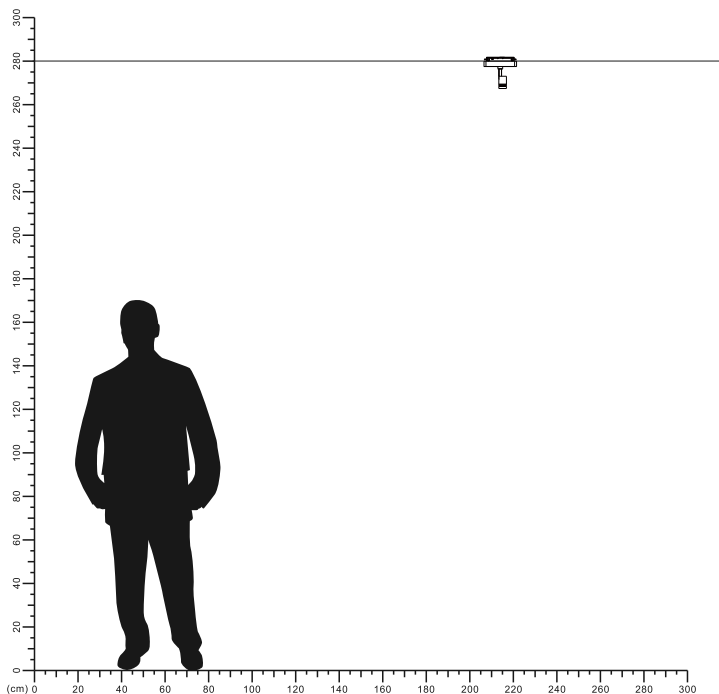

LUMINOUS INTENSITY DISTRIBUTION DIAGRAM

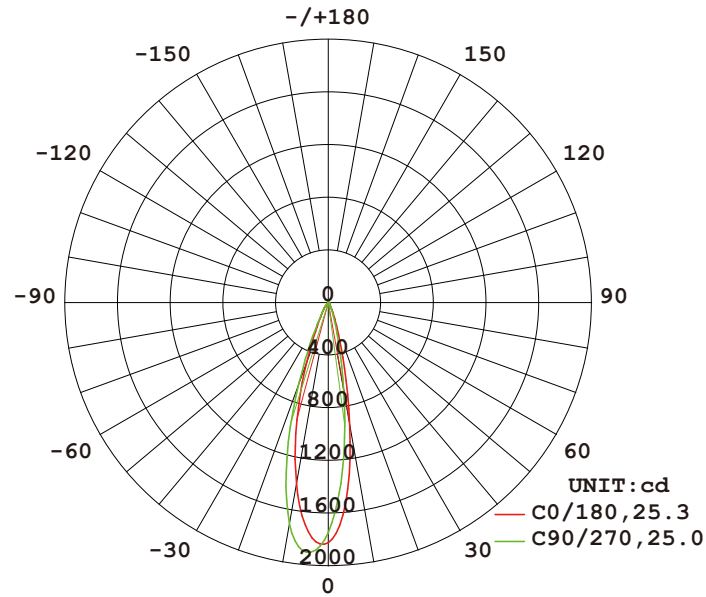

AVERAGE BEAM ANGLE (50%) : 25.1 DEG

Illuminance at a Distance

Flux out: 204.0 lm

Height	Eavg, Emax	Angle: 24.99deg	Diameter
5m	48.72, 76.48lx		221.56cm
10m	12.18, 19.12lx		443.13cm
15m	5.414, 8.498lx		664.69cm
20m	3.045, 4.780lx		886.25cm
25m	1.949, 3.059lx		1107.81cm
30m	1.353, 2.124lx		1329.38cm
35m	0.9943, 1.561lx		1550.94cm
40m	0.7613, 1.195lx		1772.50cm
45m	0.6015, 0.9442lx		1994.06cm
50m	0.4872, 0.7648lx		2215.63cm

Note: The Curves indicate the illuminated area and the average illumination when the luminaire is at different distance.

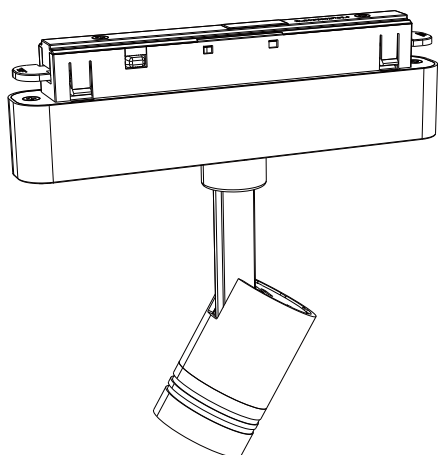

1

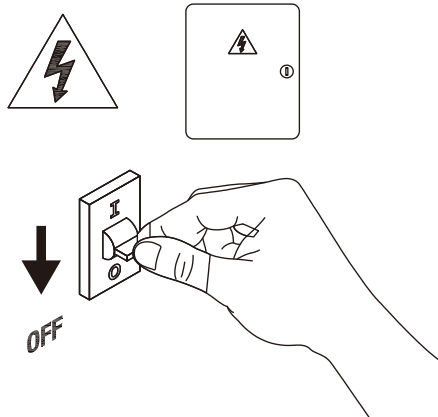

2

Turn off the power

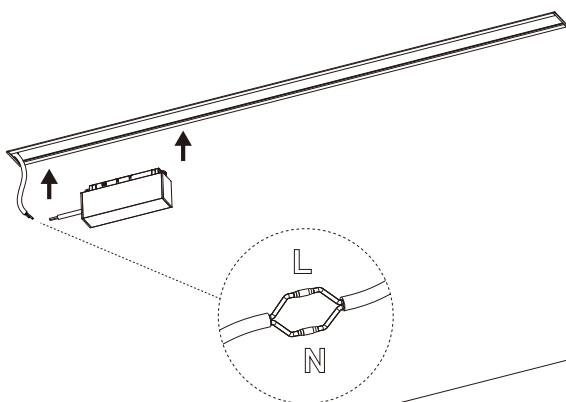

3

connect the cable

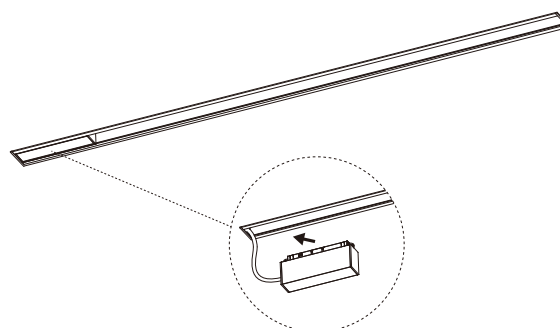

4

Install DC48V power supply

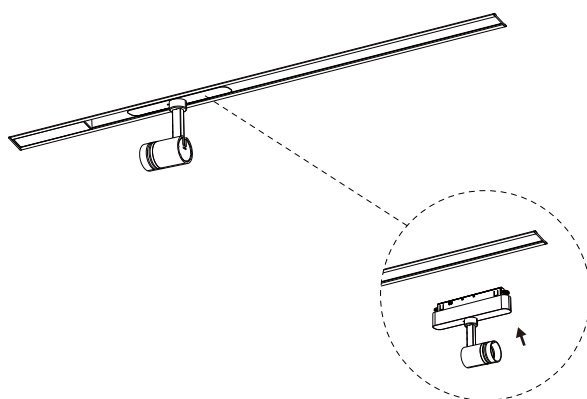

5

Install lamp the Installation is complete

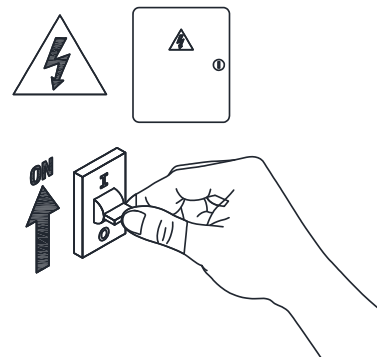

6

Turn on power

