

LED OUTDOOR BURIED LAMP

NR-UL102-18W-24V-IP68
IP67

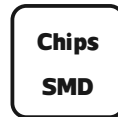
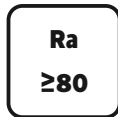
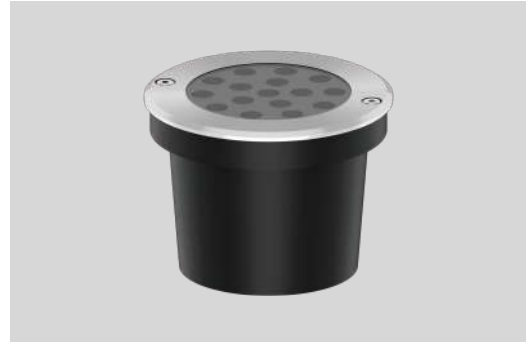

Item Code	P (W)	CCT(K)	Beam angle	Output (lm)	lm/w	Hole Size (mm)	Dimensions in mm		kg
							A	B	
NR-UL102-18W-24V-IP68	15	3000	12°	1075	71.7	Φ195	Φ200	87	1.57

Dimensions in mm

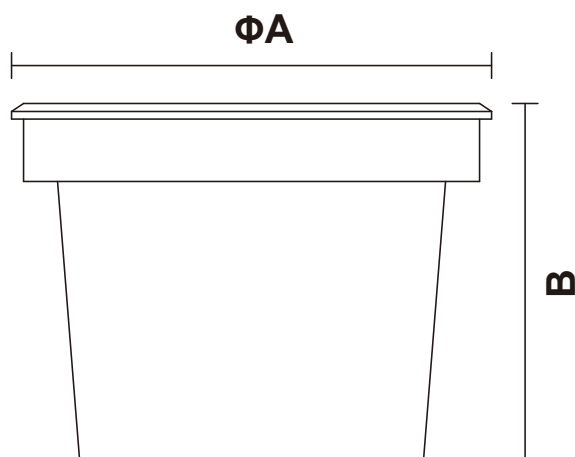

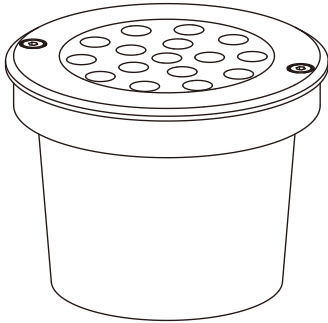

Description:
LED OUTDOOR BURIED LAMP

Main material:
Aluminum+Engineering plastics

Specification
Energy saving, up to 85% energy saving comparing to standard halogen and incandescent lamps
High quality light, high color rendering, less heat, no UV or IR radiation
Build-in LED Driver
IP67

Applications

- . Park
- . Square
- . Tourist attraction
- . Corridor

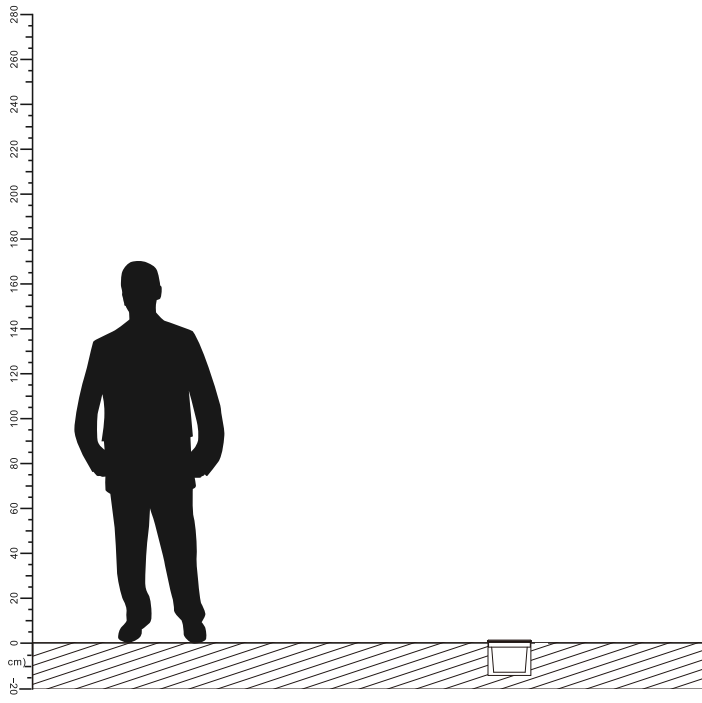

LUMINOUS INTENSITY DISTRIBUTION DIAGRAM

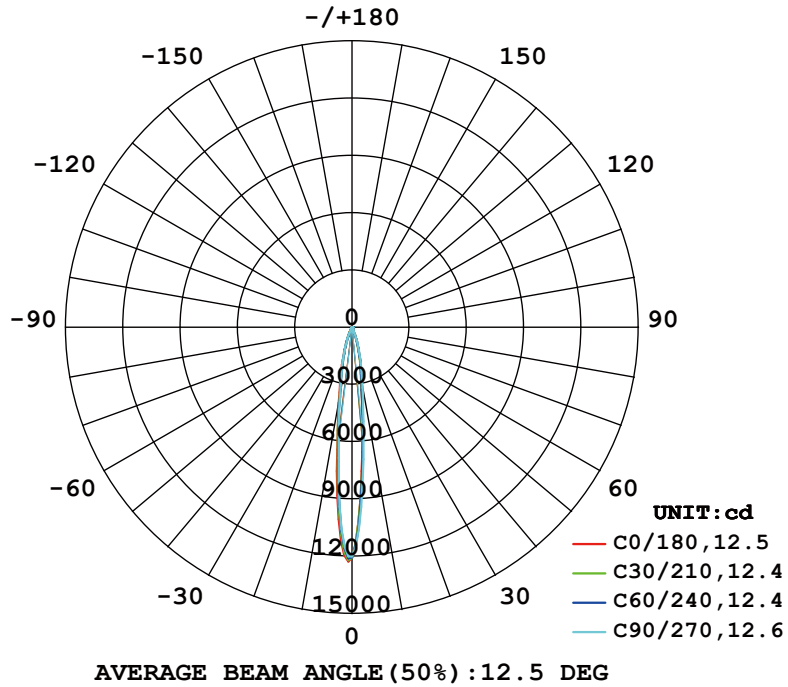

Illuminance at a Distance

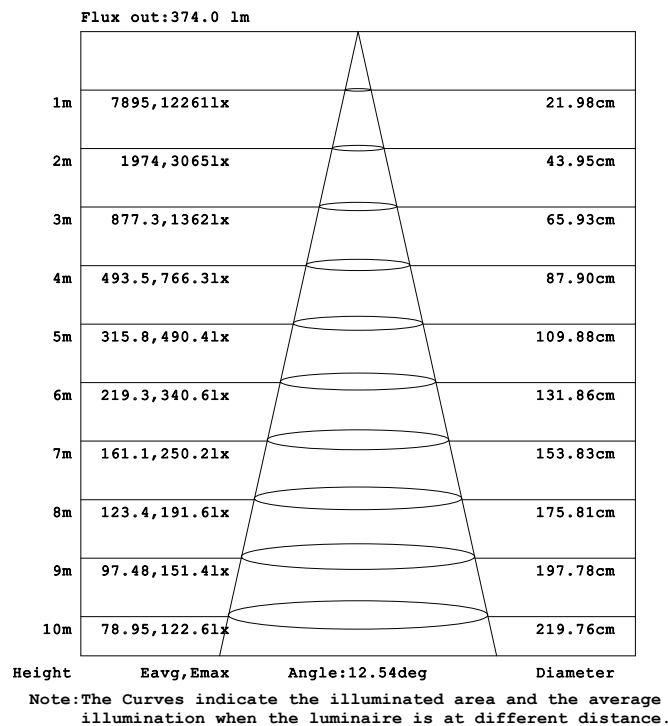

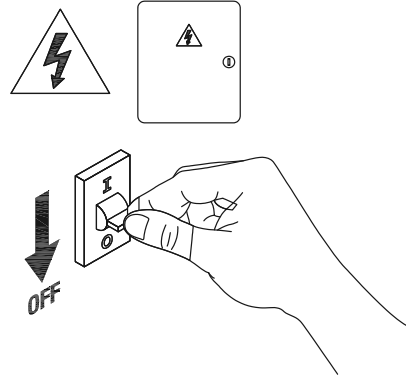
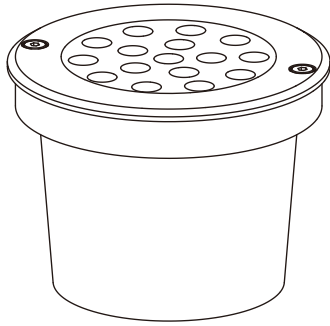

1

Turn off The Power

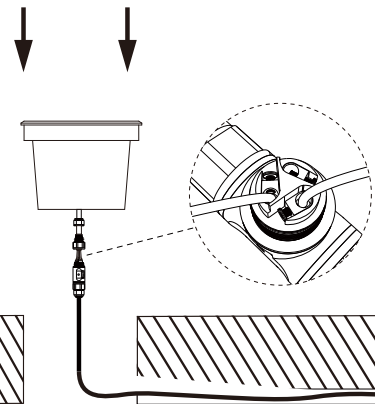
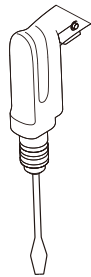

2

Opening holes on the ground

3

Connect the cable

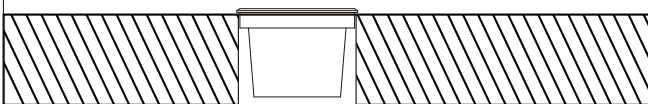

4

Installation completed

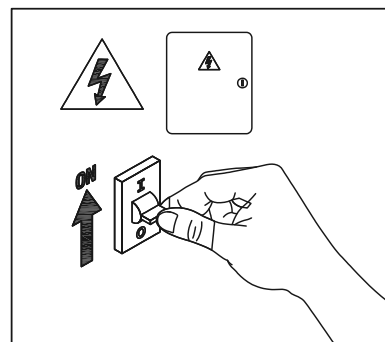

5

Turn on the power

