

LED Outdoor Buried Lamp

NR-WG102 Series
IP65

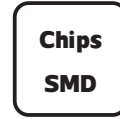
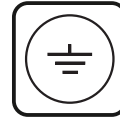
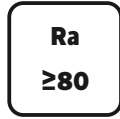
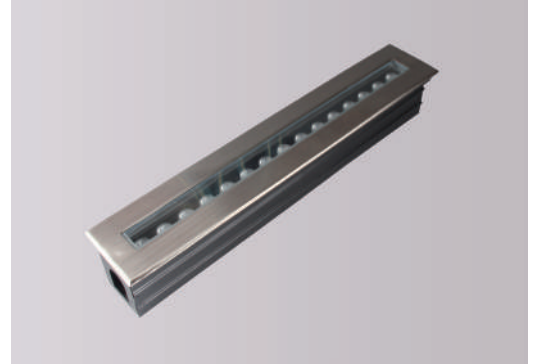

| Item Code | P(W) | CCT(K) | Total Lumen | Beam Angle | ✍️ | Dimensions in mm | | | kg |
|-------------|------|----------------|-------------|------------|-------------|------------------|------|----|-----|
| | | | | | | A | B | C | |
| NR-WG102-9 | 9 | 6500/4000/3000 | 585 | 30° | 293x78x90mm | 78 | 300 | 90 | 1.7 |
| NR-WG102-15 | 15 | 6500/4000/3000 | 1075 | 30° | 493x78x90mm | 78 | 500 | 90 | 2.6 |
| NR-WG102-24 | 24 | 6500/4000/3000 | 1776 | 30° | 993x78x90mm | 78 | 1000 | 90 | 4.5 |

Dimensions in mm

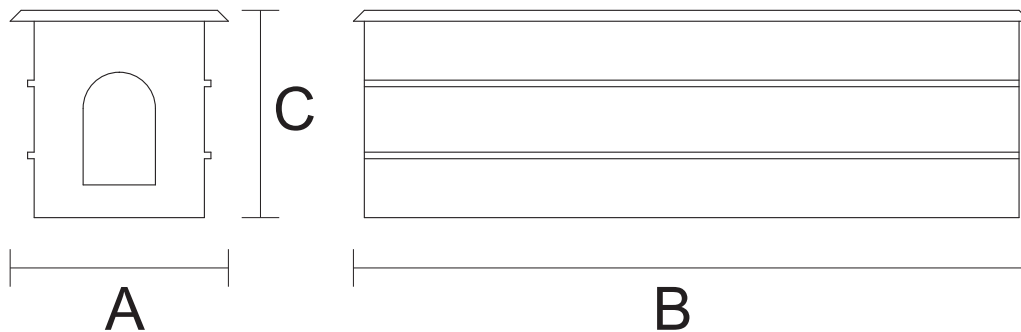

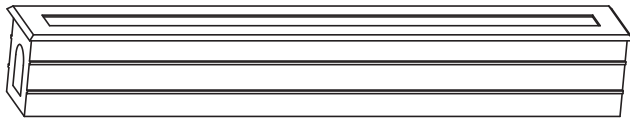

Description:
LED Outdoor Buried Lamp

Main material:
304 stainless steel

Specification
Energy saving, up to 85% energy saving comparing to standard halogen and incandescent lamps High quality light, high color rendering, less heat, no UV or IR radiation
LED driver is included
IP 65

Applications
. Park
. Square
. Corridor

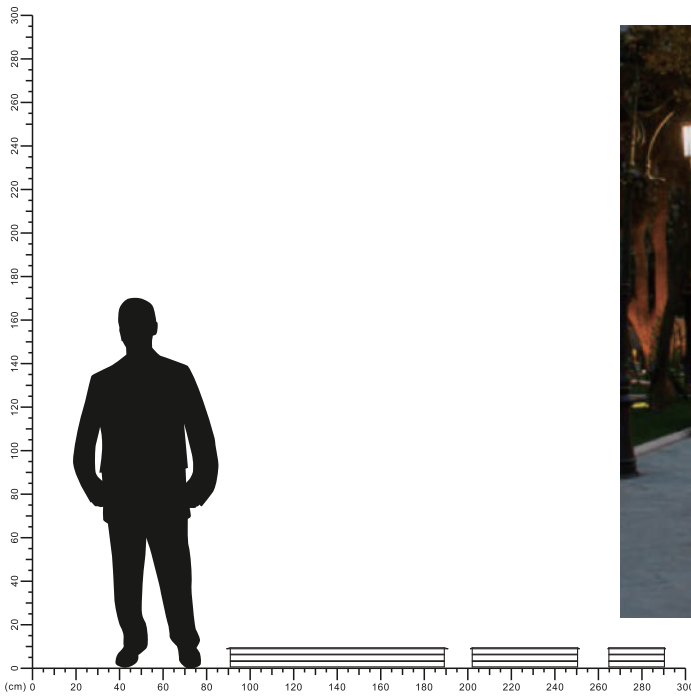

LUMINOUS INTENSITY DISTRIBUTION DIAGRAM

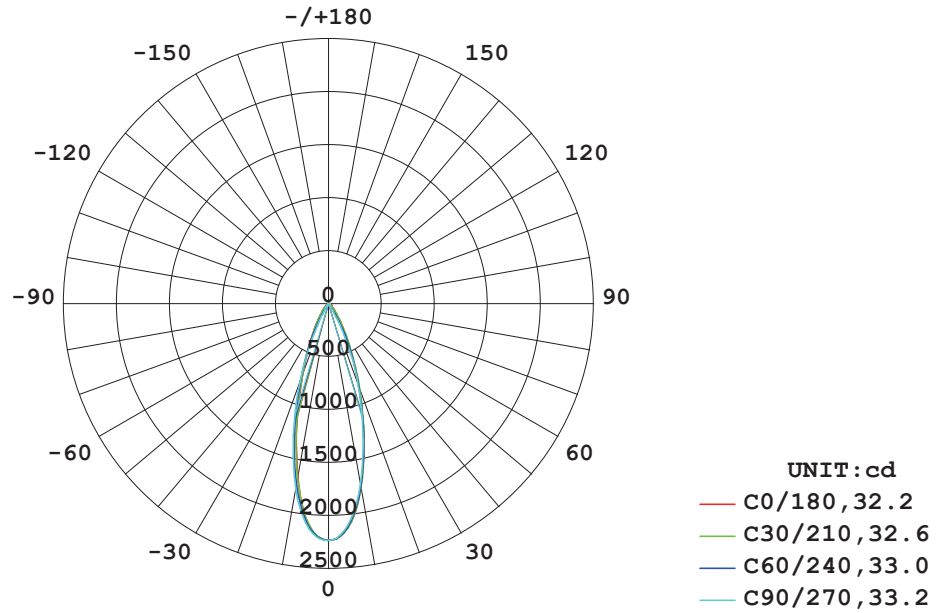

AVERAGE BEAM ANGLE (50%) : 32.8 DEG

Illuminance at a Distance

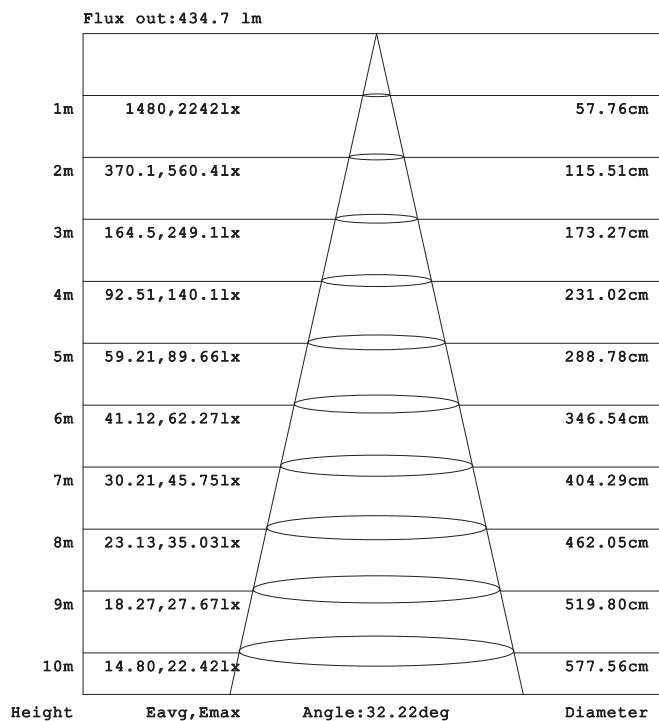

Model: NR-WG102-9

LUMINOUS INTENSITY DISTRIBUTION DIAGRAM

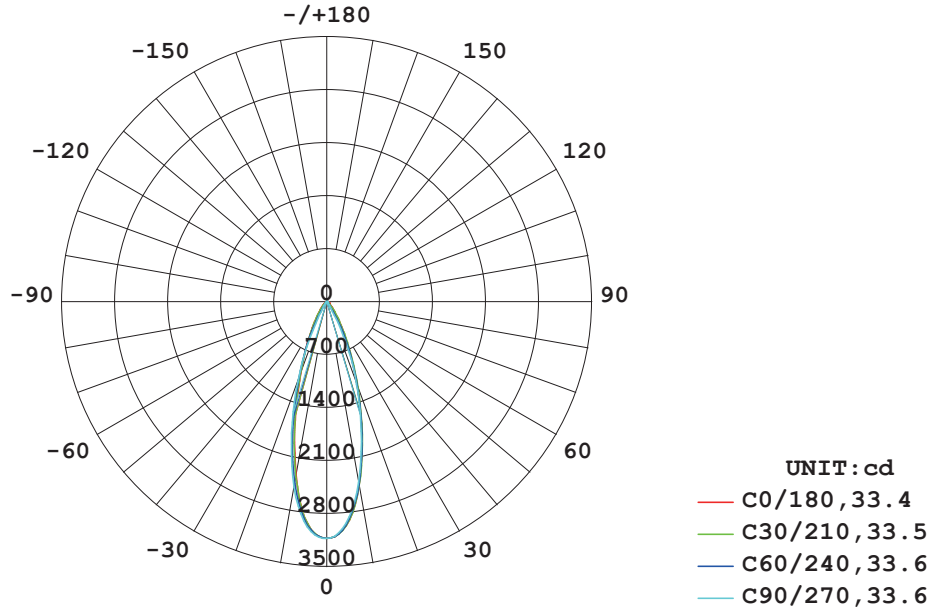

AVERAGE BEAM ANGLE (50%) : 33.5 DEG

Illuminance at a Distance

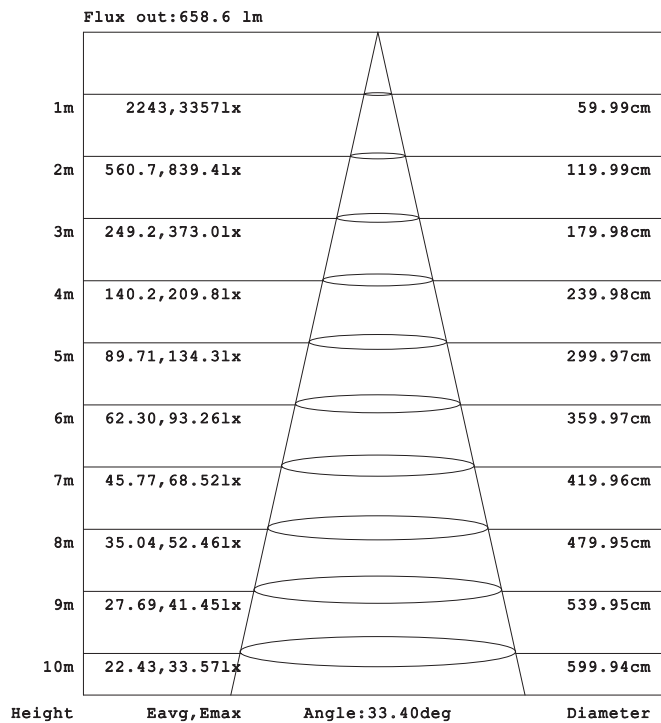

Model: NR-WG102-15

LUMINOUS INTENSITY DISTRIBUTION DIAGRAM

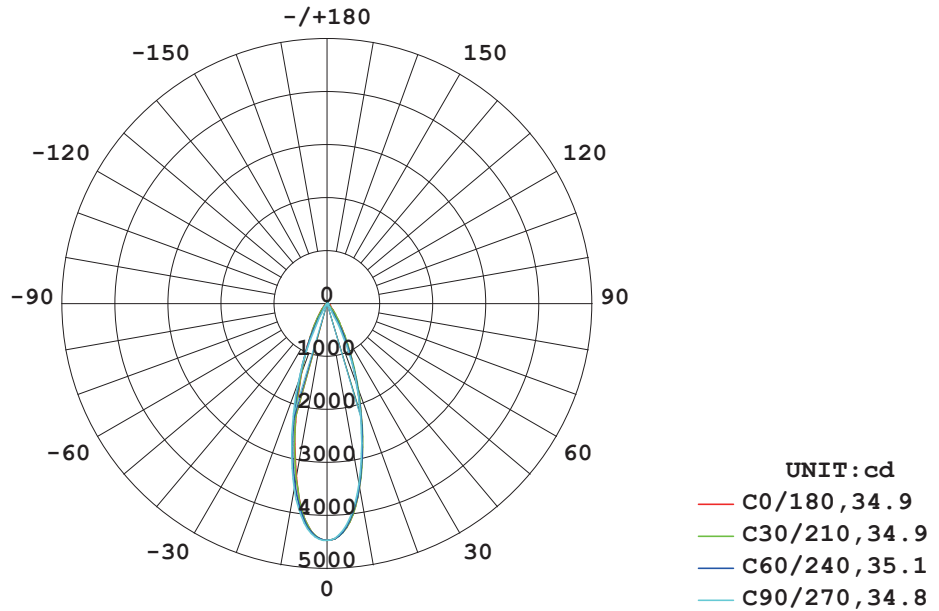

AVERAGE BEAM ANGLE (50%) : 34.9 DEG

Illuminance at a Distance

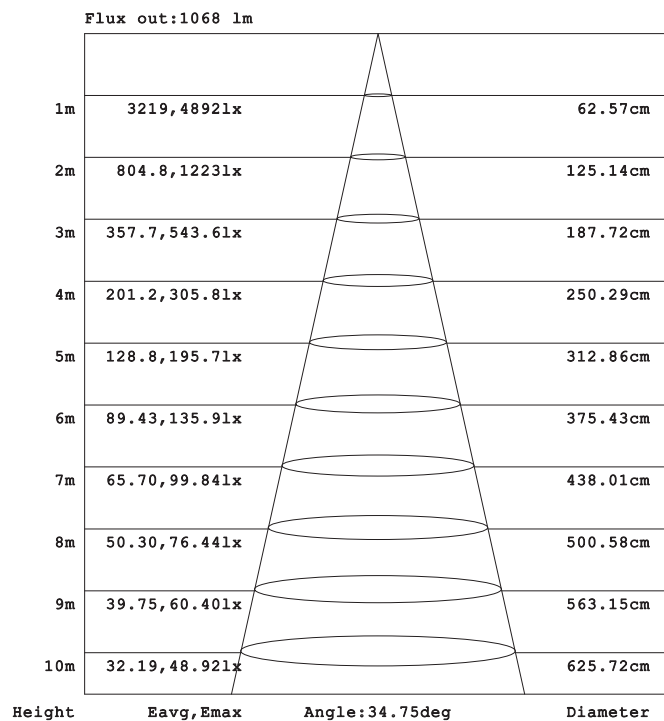

Model: NR-WG102-24



1

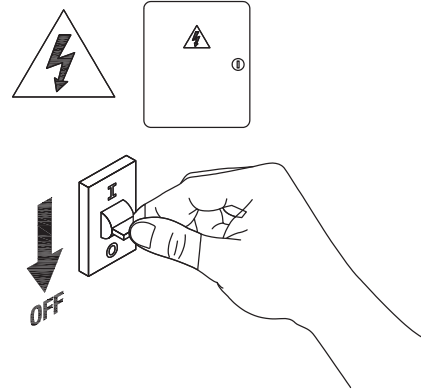

2

Turn off the power

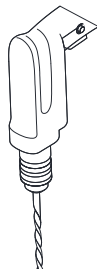

3

dug a hole

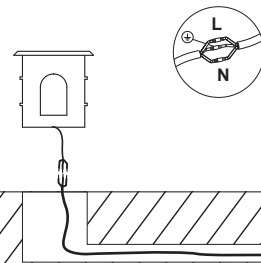

4

Connect the cable.



5

Installation completed.

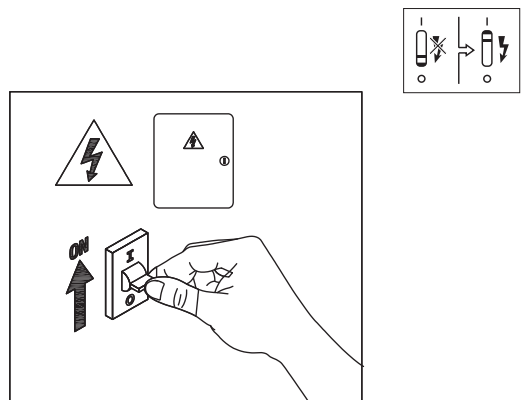

6

Turn on the power

