

LED Outdoor Wall Lamp

NR-WL455-6W

IP65



Outdoor	AC 220-240V	50/60 Hz	PF ≥0.7	CCT 6500K 4000K 3000K	Ra ≥80	IP65	Beam Angel 90°	Chips SMD	
---------	----------------	-------------	------------	--------------------------------	-----------	------	----------------------	--------------	--

Item Code	P (W)	CCT(K)	Beam angle	Output (lm)	lm/w	Dimensions in mm			kg
A	B	C							
NR-WL455-6W	6	3000/4000/6500	90°	390	65	202	120	80	0.69

Dimensions in mm

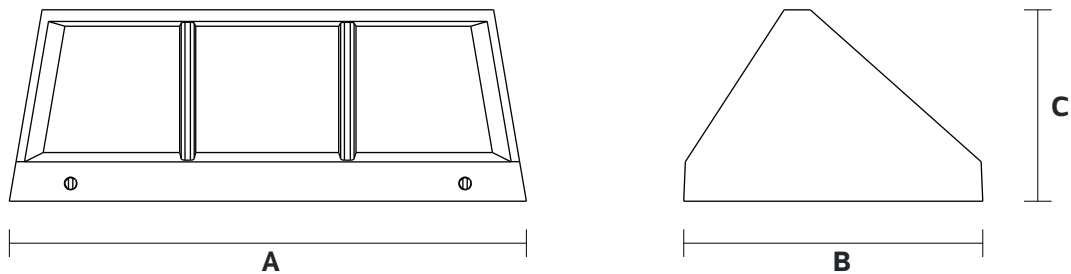

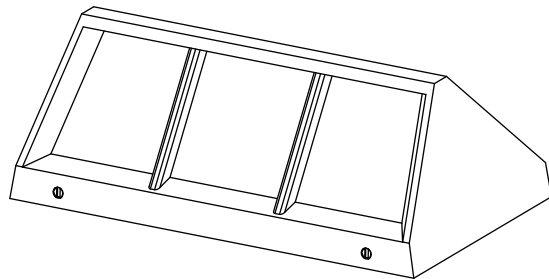

Description:
LED Outdoor Wall Lamp

Main material:
Aluminum+Engineering plastics

Specification
Energy saving, up to 85% energy saving
comparing to standard halogen and incandescent
lamps
High quality light, high color rendering, less heat,
no UV or IR radiation
Build-in LED Driver
IP65

Applications
• Park
• Square
• Tourist attraction
• Corridor

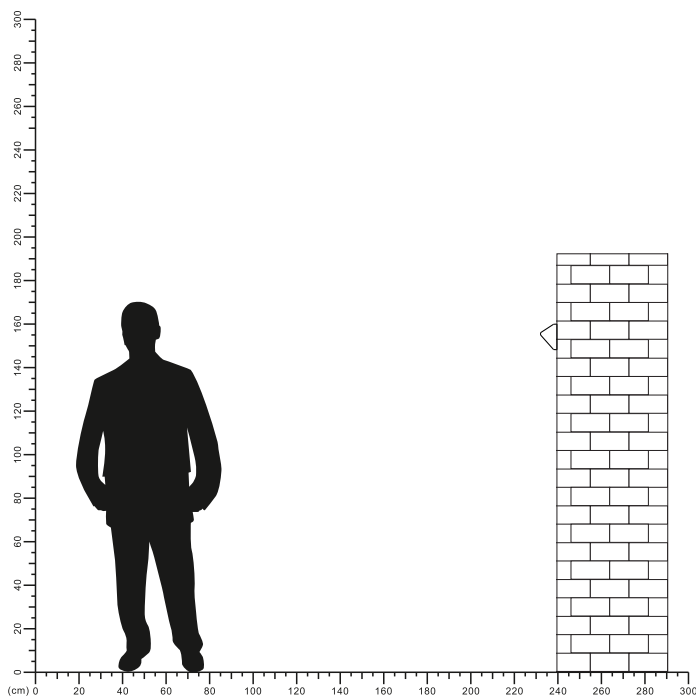

LUMINOUS INTENSITY DISTRIBUTION DIAGRAM

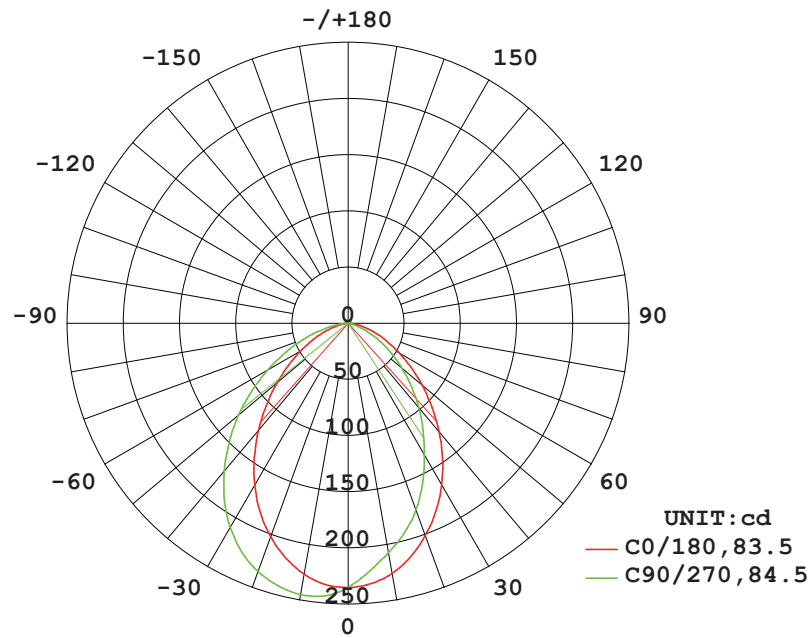

AVERAGE BEAM ANGLE (50%) : 84.0 DEG

Illuminance at a Distance

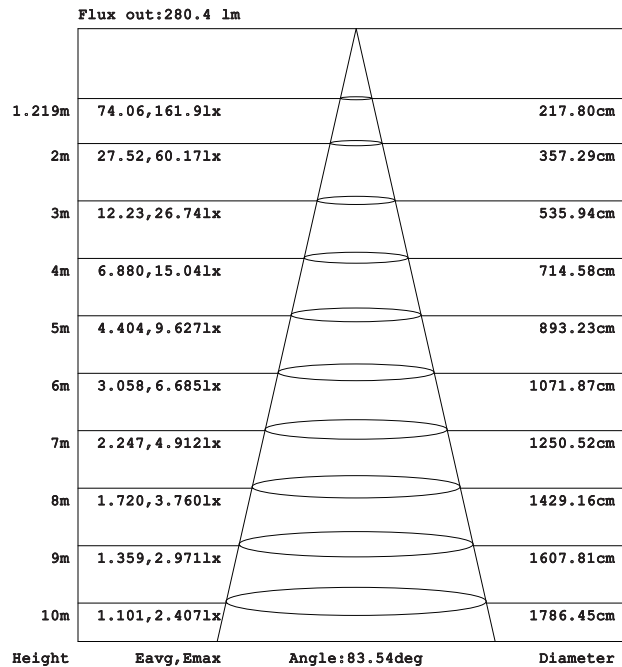

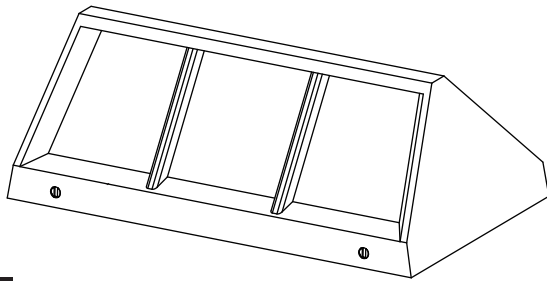

1

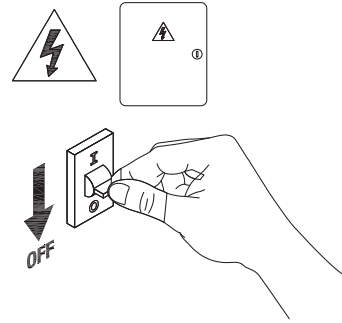

2

Turn off the power

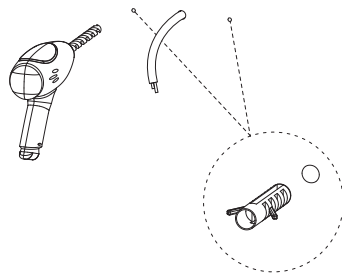

3

Drill two screw holes on the wall

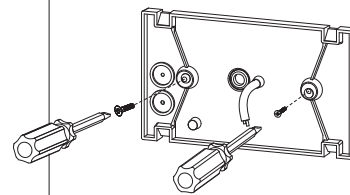

4

Install the base plate

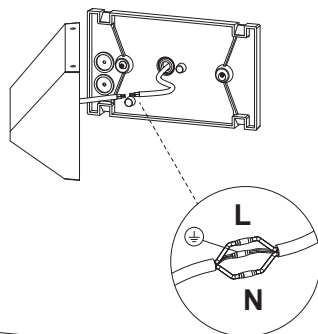

Connect Cable

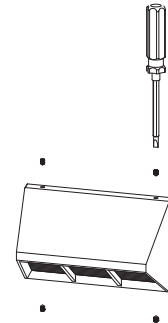

Mounting bottom box

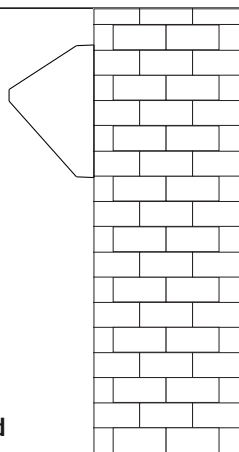

5

Installation completed

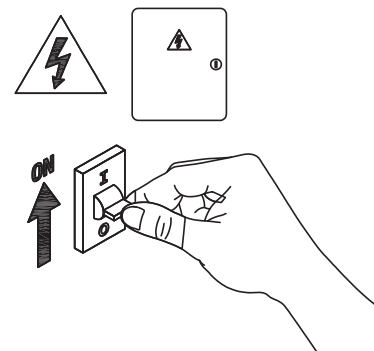

6

Turn on power

