

LED Downlight

NRP-SLM102 MR11 Series
IP20

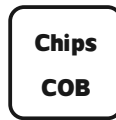
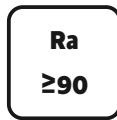

Item Code	P (W)	CCT (K)	Beam angle	Output (lm)	lm/w	Dimensions in mm			kg
						A	B	C	
NRP-SLM102-5	5	3000/4000	36°	355	71	Φ35	Φ38	73	0.18
NRP-SLM102-10 3000K	10	3000	36°	850	85	Φ35	Φ47	75	0.23
NRP-SLM102-10 4000K	10	4000	36°	750	75	Φ35	Φ47	75	0.23

Dimensions in mm

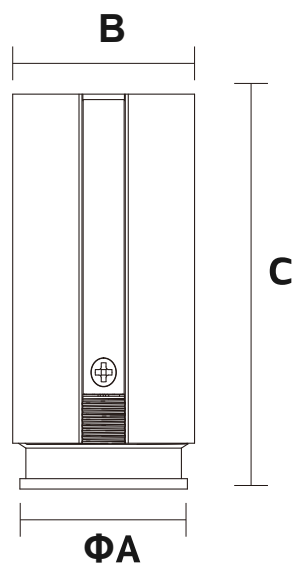

NR-SLM102-5



NR-SLM102-10

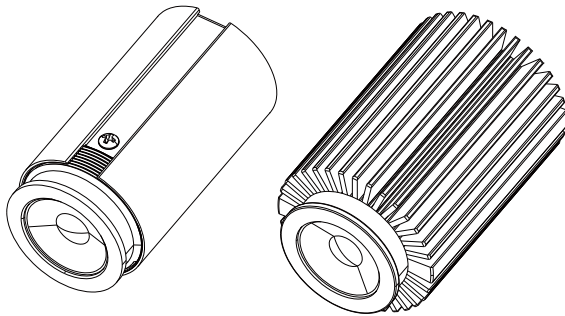

Description:

LED Downlight

Main material:

Die-cast aluminum+Engineering plastics

Specification

Energy saving, up to 85% energy saving comparing to standard halogen and incandescent lamps High quality light, high color rendering, less heat, no UV or IR radiation LED driver is included IP20

Applications

- . Shopping mall
- . Office buildings
- . Exhibition hall

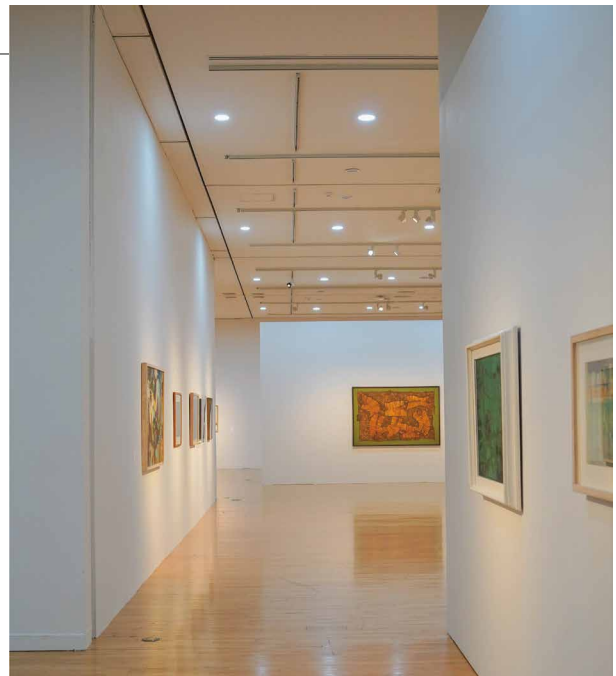
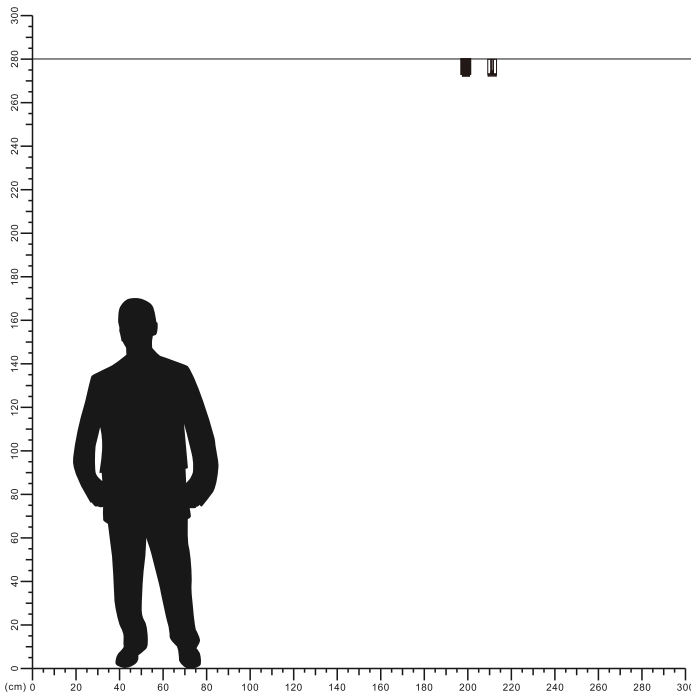

LUMINOUS INTENSITY DISTRIBUTION DIAGRAM

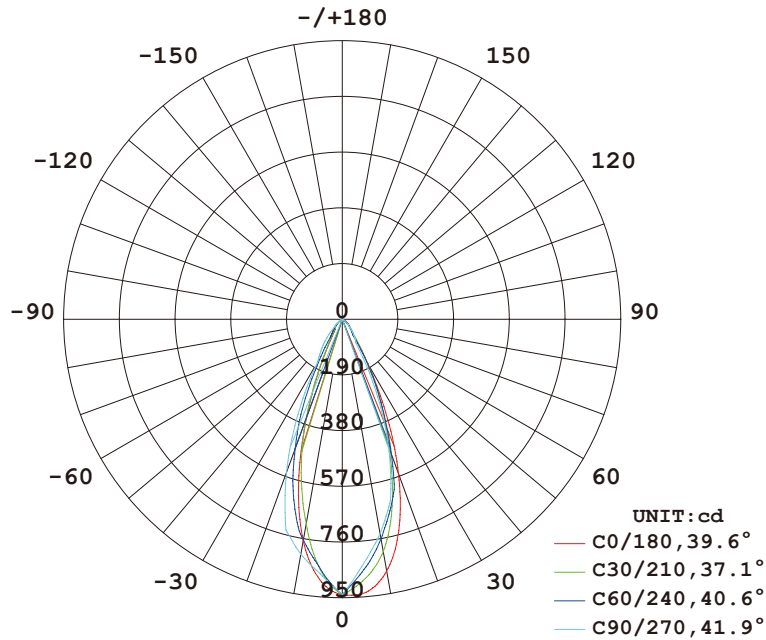

AVERAGE BEAM ANGLE (50%) : 39.8 DEG

Illuminance at a Distance

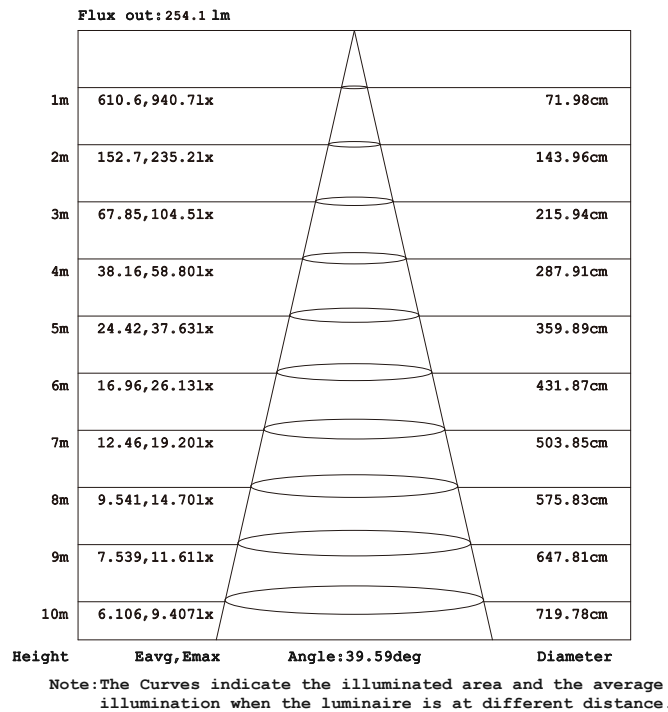

Item Code: NRP-SLM102-5

LUMINOUS INTENSITY DISTRIBUTION DIAGRAM

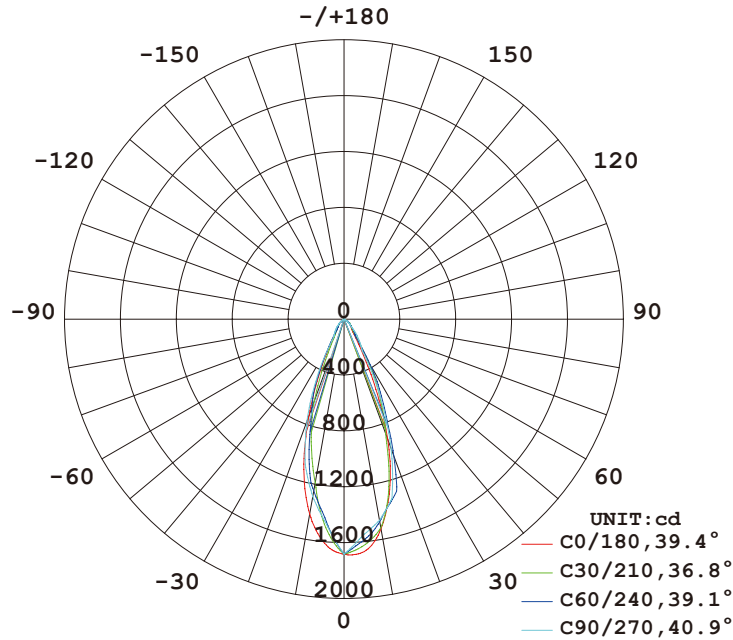

AVERAGE BEAM ANGLE (50%) : 39.1 DEG

Illuminance at a Distance

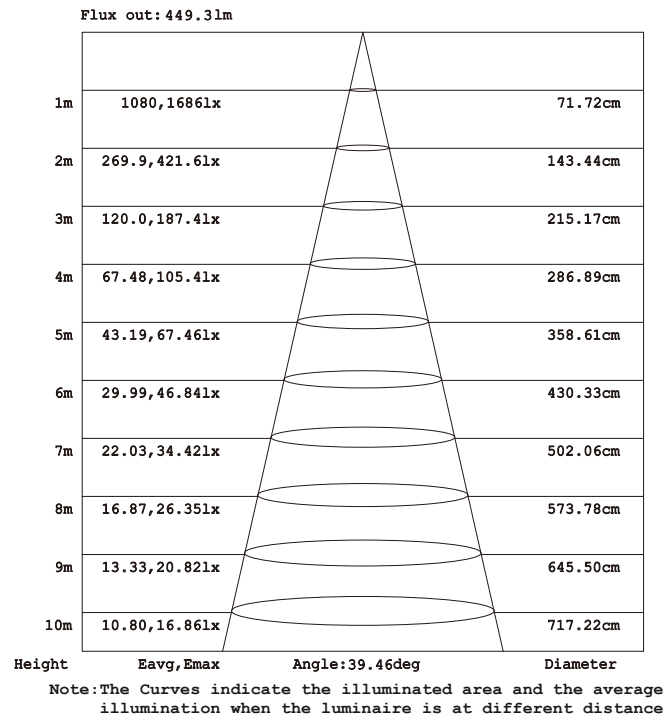

Item Code: NRP-SLM102-10

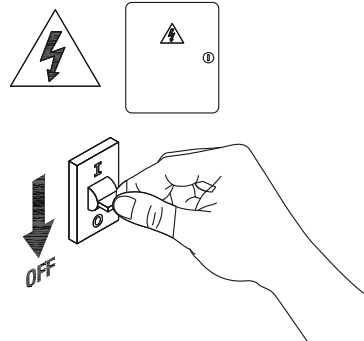
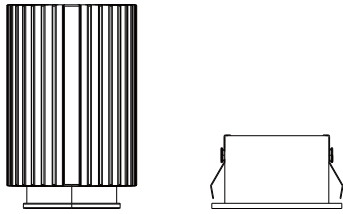

1

Turn off The Power

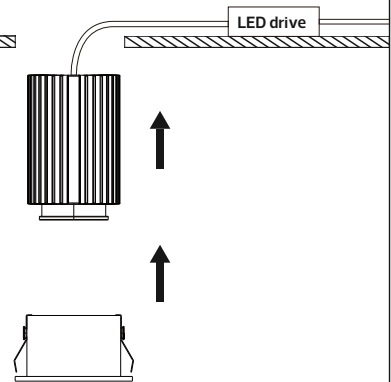
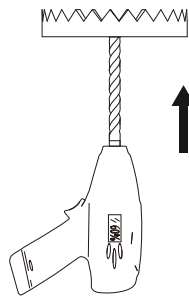

2

Cut a hole in the ceiling

3

Install lamps and wiring

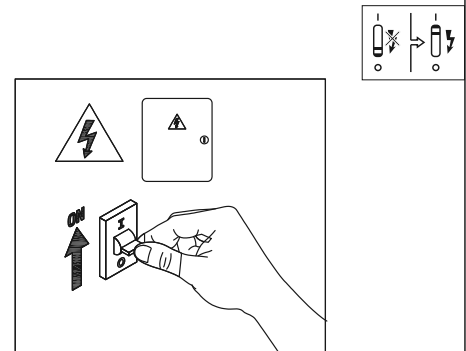
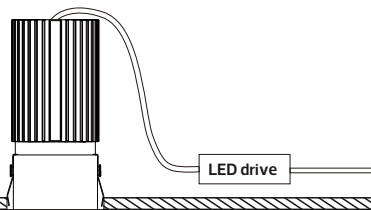

4

installaion is complete

5

Turn on the power

