

T5 LED Line Light

NRP-T5 Series

IP20

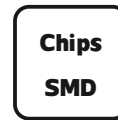
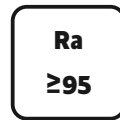

Item Code	P(W)	Displacement Factor	CCT(K)	Output (lm)	lm/w	Dimensions in mm			kg
						A	B	C	
NRP-T5-30-4-2700K	4	≥0.4	2700	296	74	300	21	35	0.05
NRP-T5-30-4-3000K	4	≥0.4	3000	312	78	300	21	35	0.05
NRP-T5-60-7	7	≥0.7	2700/3000	616	88	600	21	35	0.1
NRP-T5-90-12-2700K	12	≥0.7	2700	1200	100	900	21	35	0.15
NRP-T5-90-12-3000K	12	≥0.7	3000	1280	106.7	900	21	35	0.15
NRP-T5-120-16	16	≥0.7	2700/3000	1616	101	1200	21	35	0.2

Dimensions in mm

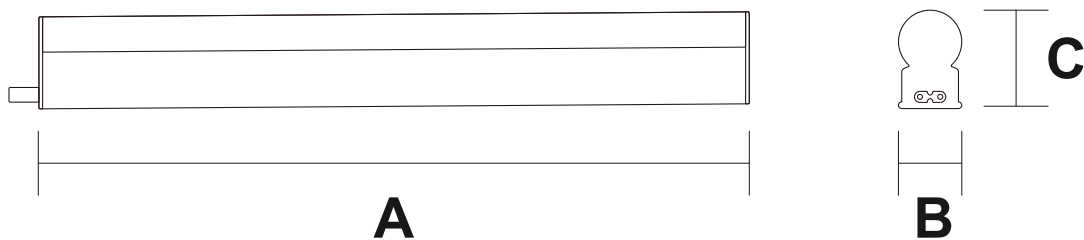

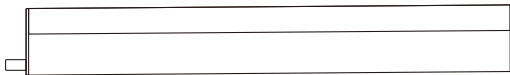

Description:
T5 LED Line Light

Main material:
PC

Specification:
Energy saving, upto 85% energy saving comparing to standard halogen and incandescent lamps Long life, upto 50,000 hours High quality light, high color rendering, less heat, no UV or IR radiation

Applications
Shopping mall
Office buildings
Exhibition hall

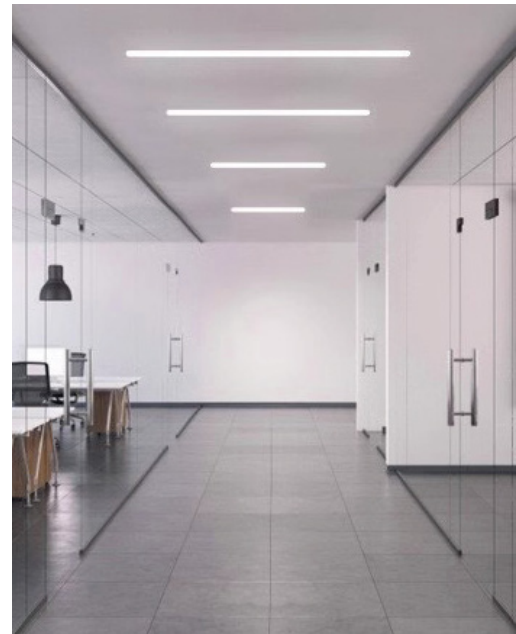
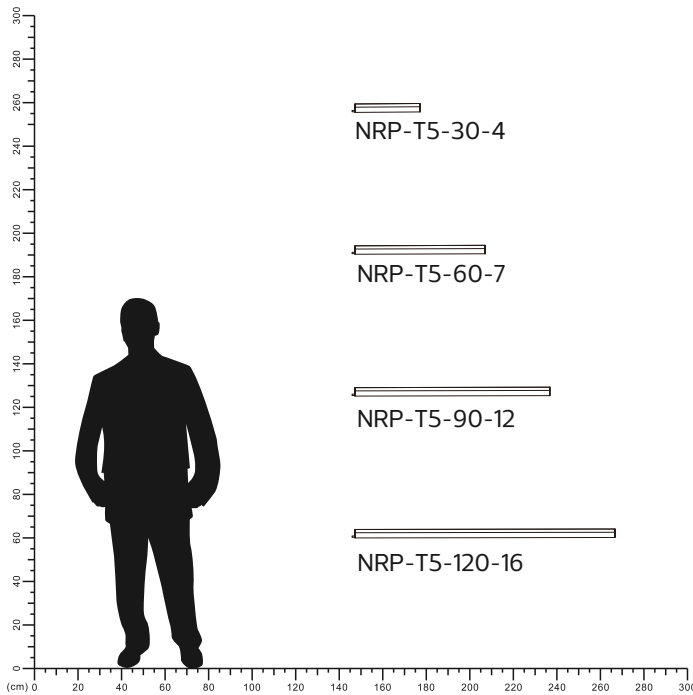

LUMINOUS INTENSITY DISTRIBUTION DIAGRAM

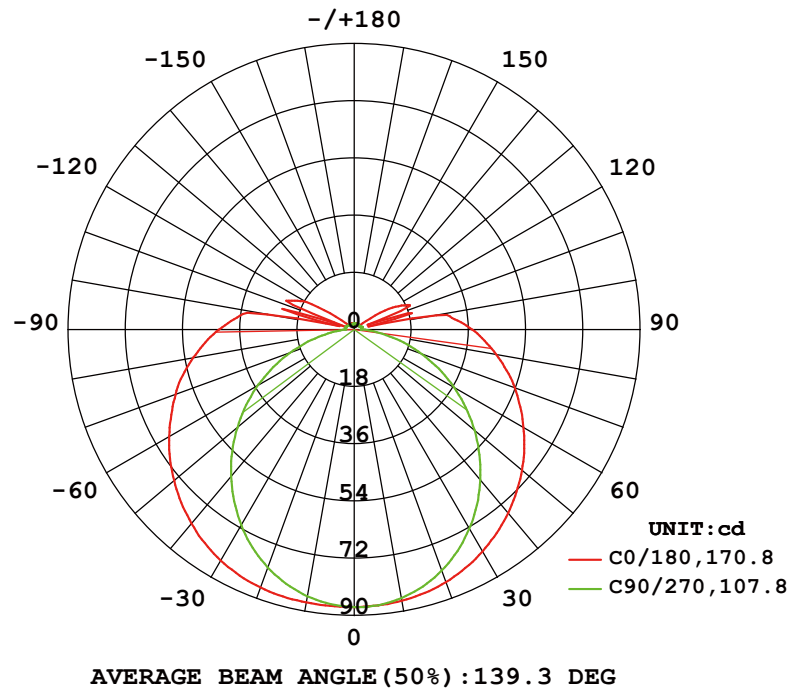

Illuminance at a Distance

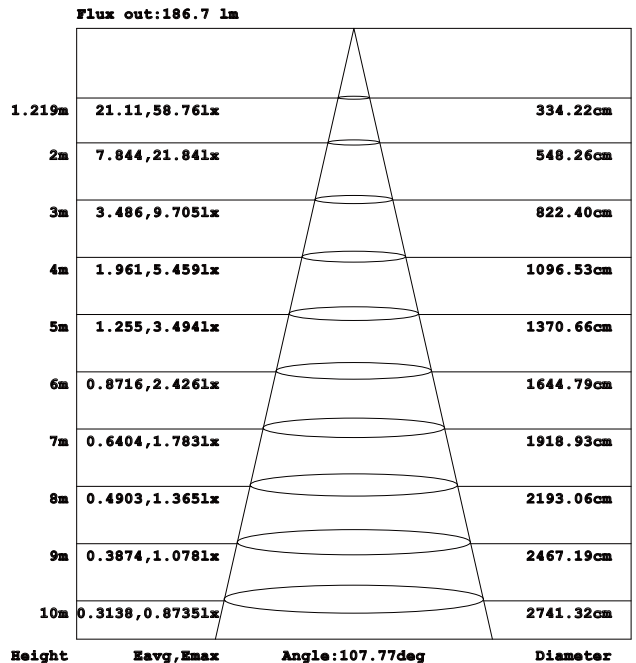

Item Code: NRP-T5-30-4

LUMINOUS INTENSITY DISTRIBUTION DIAGRAM

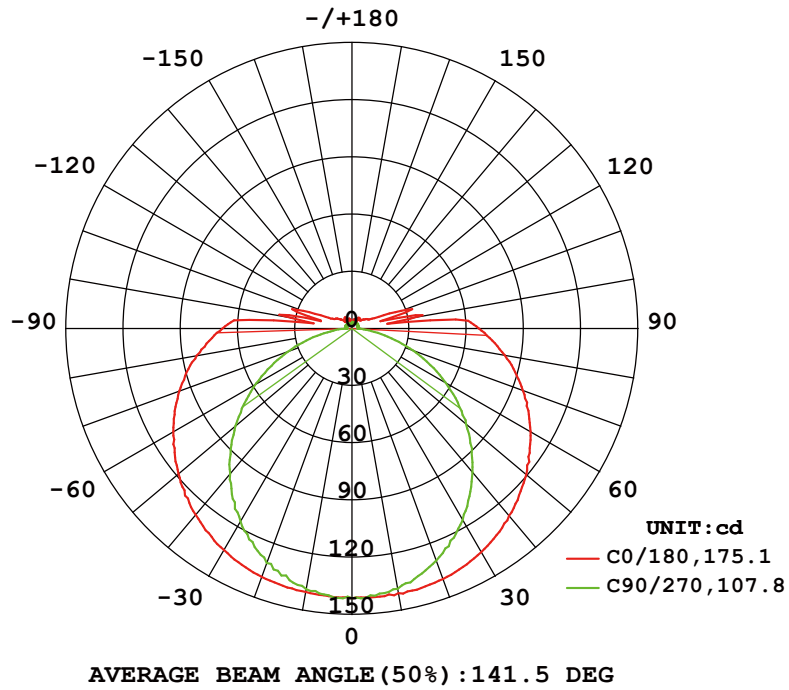

Illuminance at a Distance

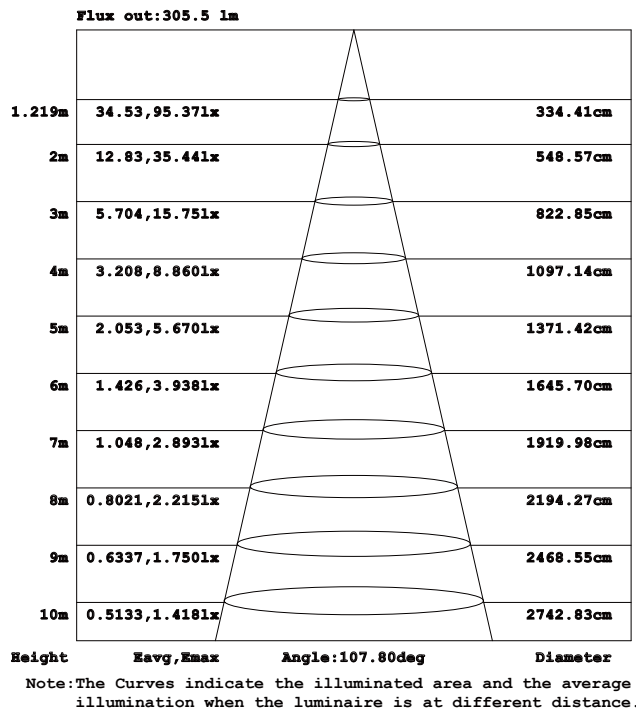

Item Code: NRP-T5-60-7

LUMINOUS INTENSITY DISTRIBUTION DIAGRAM

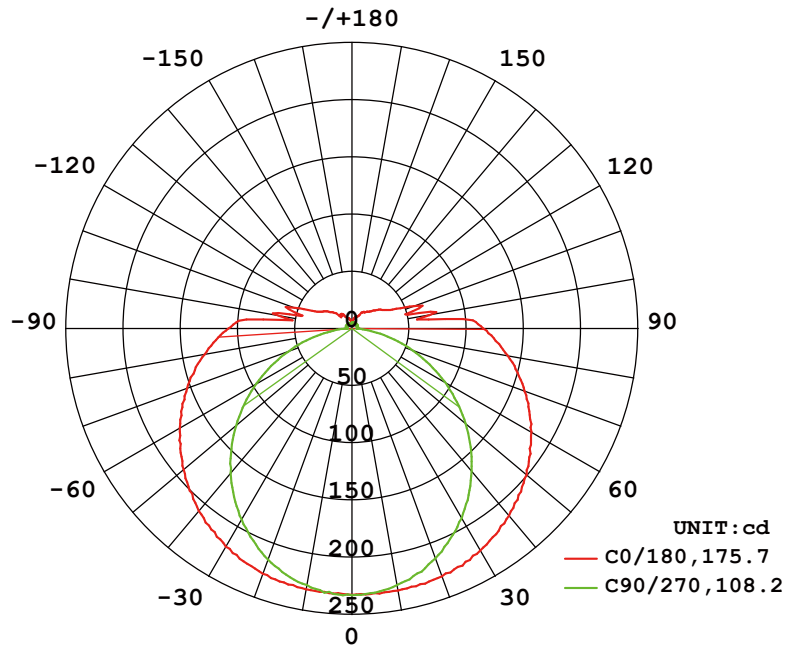

AVERAGE BEAM ANGLE (50%) : 141.9 DEG

Illuminance at a Distance

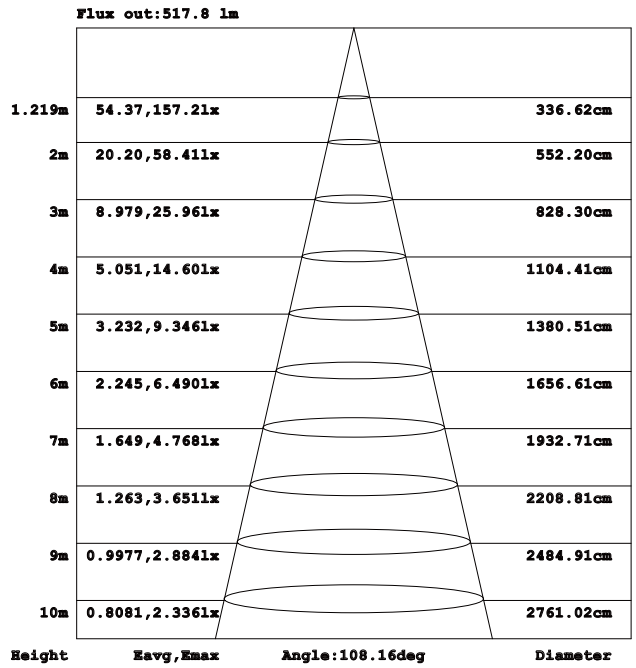

Note: The Curves indicate the illuminated area and the average illumination when the luminaire is at different distance.

Item Code: NRP-T5-90-12

LUMINOUS INTENSITY DISTRIBUTION DIAGRAM

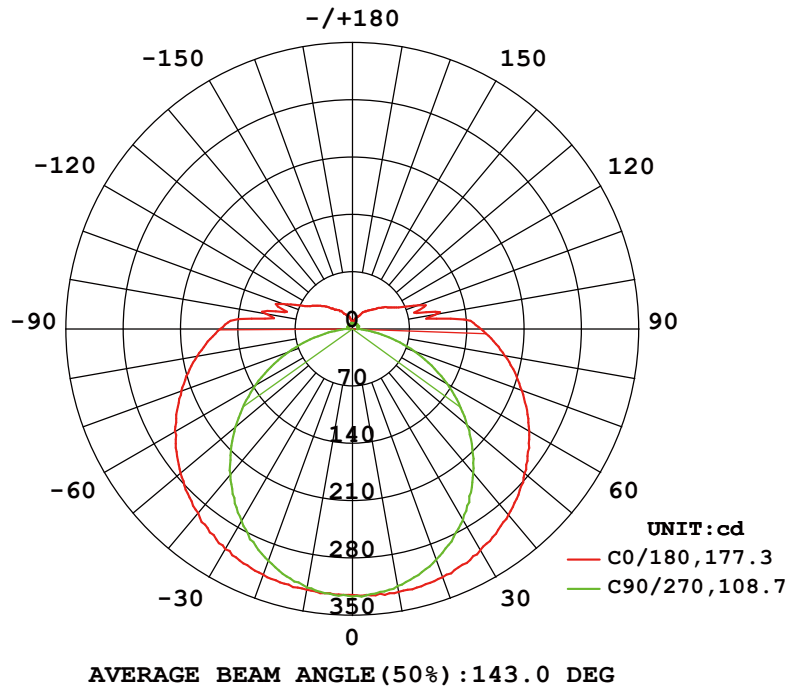

Illuminance at a Distance

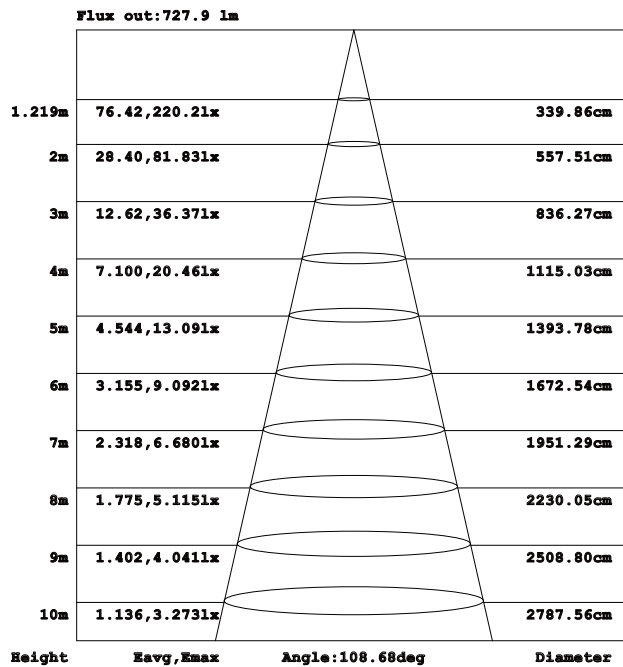

Note: The Curves indicate the illuminated area and the average illumination when the luminaire is at different distance.

Item Code: NRP-T5-120-16

Warm Tips:
Not more than five series

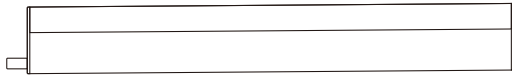

1

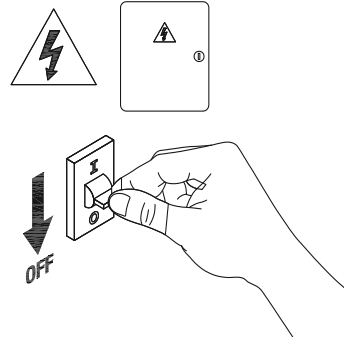

2

Turn off The Power

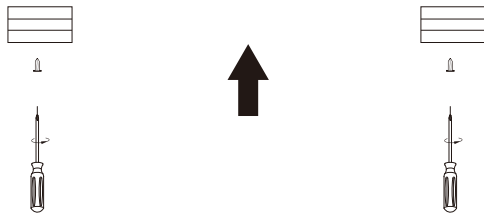

3

Install two clasps on the surface

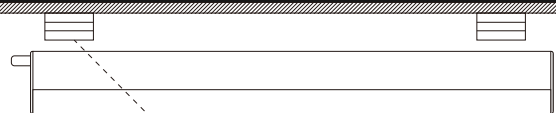

4

Clamp the T5 LED line light to the two clasps

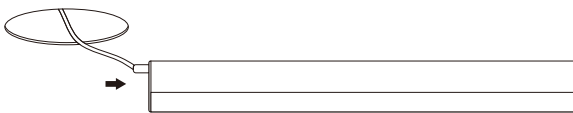
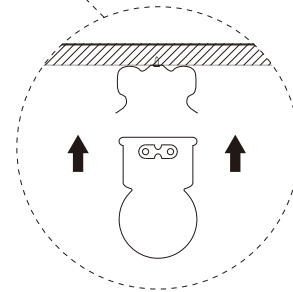

5

Connect the cable

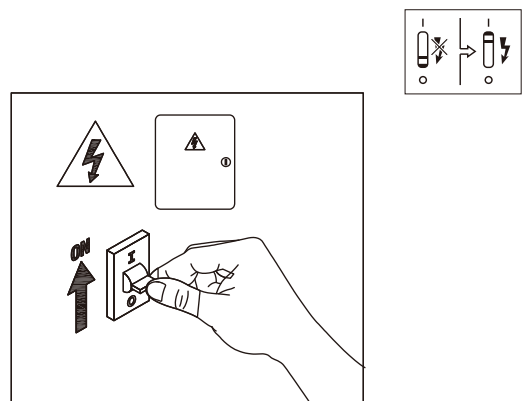

6

Turn on the power

