

## LED OUTDOOR BURIED LAMP

NRP-UL103 Series  
IP67

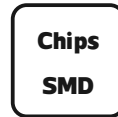
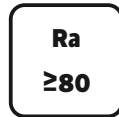

Item Code	P (W)	CCT(K)	Beam angle	PF	Output (lm)	lm/w	Hole Size (mm)	Dimensions in mm			kg	
								A	B	C		
NRP-UL103-9-12	9	3000	12°	≥0.7	585	65	Φ170	Φ180	123	Φ170	1.7	
NRP-UL103-9-60	9	3000	60°	≥0.7	585	65	Φ170	Φ180	123	Φ170	1.7	
NRP-UL103-18-12	18	3000	12°	≥0.9	1332	74	Φ195	Φ200	155	Φ195	2	
NRP-UL103-18-60	18	3000	60°	≥0.9	1332	74	Φ195	Φ200	155	Φ195	2	
NRP-UL103-36-12	36	3000	12°	≥0.9	2665	74.02	Φ240	Φ245	155	Φ240	3.3	
NRP-UL103-36-60	36	3000	60°	≥0.9	2665	74.02	Φ240	Φ245	155	Φ240	3.3	

### Dimensions in mm

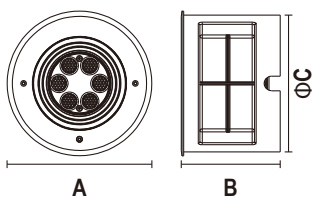

Item Code: NRP-UL103-9

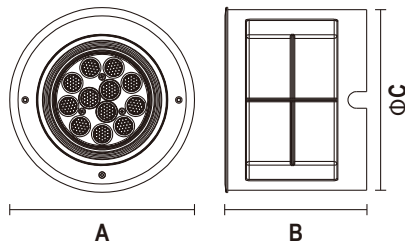

Item Code: NRP-UL103-18

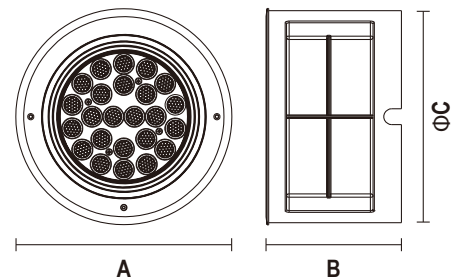

Item Code: NRP-UL103-36

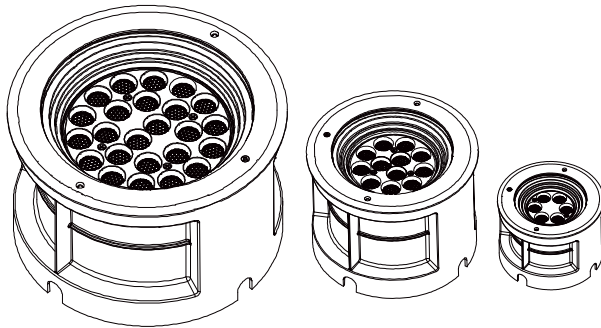
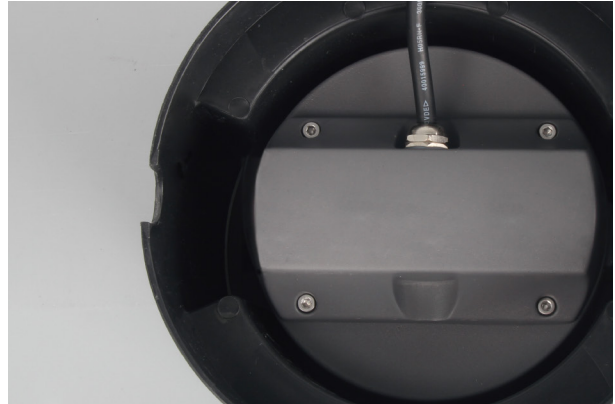

**Description:**  
LED OUTDOOR BURIED LAMP

**Main material:**  
Aluminium+Engineering plastics

**Specification**  
Efficient waterproof design, withstands harsh weather conditions. Energy-saving and eco-friendly, long-lasting durability. Sleek and stylish, seamlessly blends into any setting. Easy installation and user-friendly operation.  
IP67

**Applications**  
. Park  
. Balcony  
. Office buildings

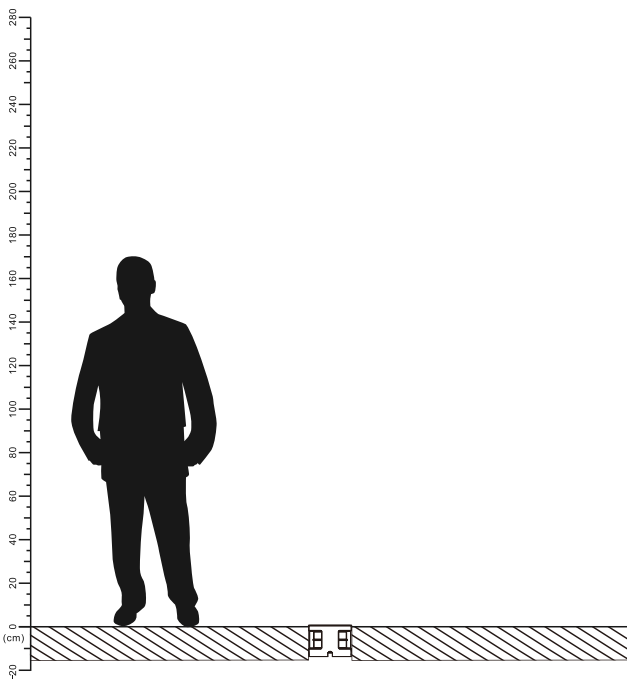

# LUMINOUS INTENSITY DISTRIBUTION DIAGRAM

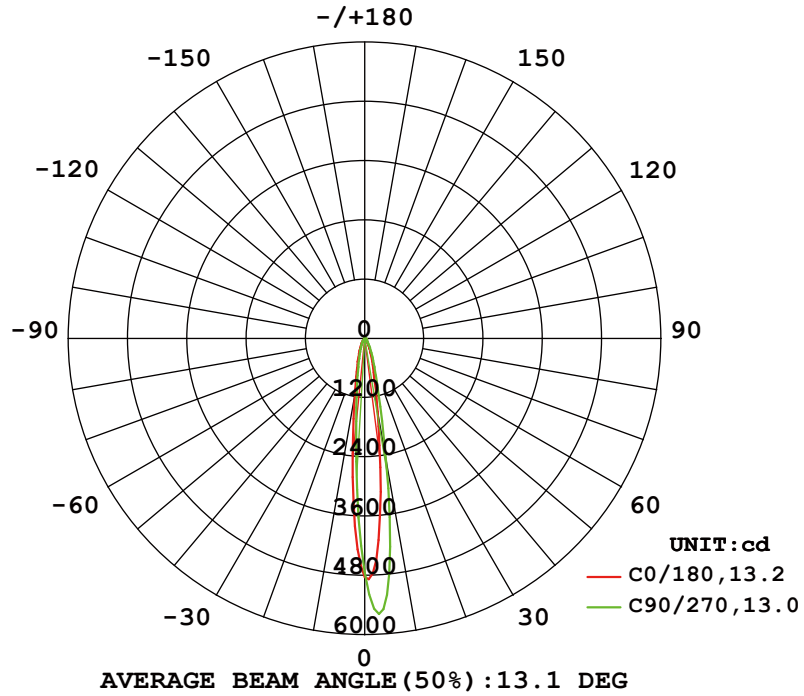

## Illuminance at a Distance

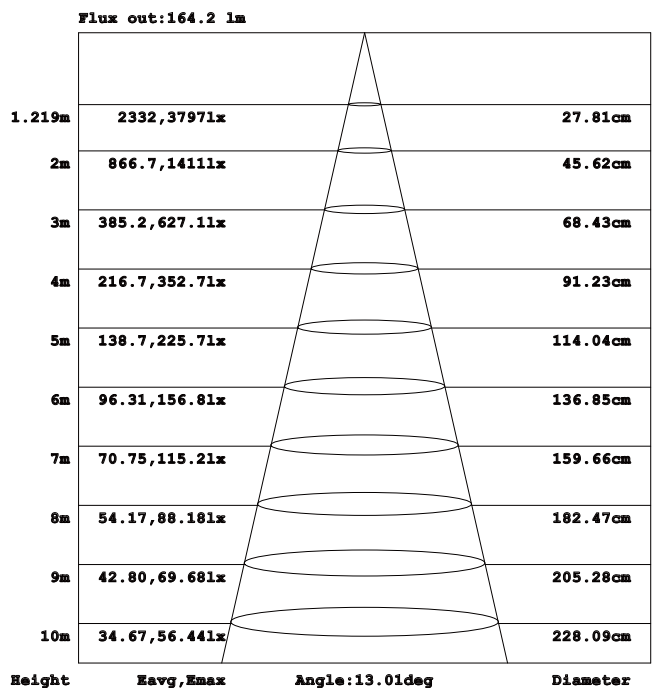

Note: The Curves indicate the illuminated area and the average illumination when the luminaire is at different distance.

# LUMINOUS INTENSITY DISTRIBUTION DIAGRAM

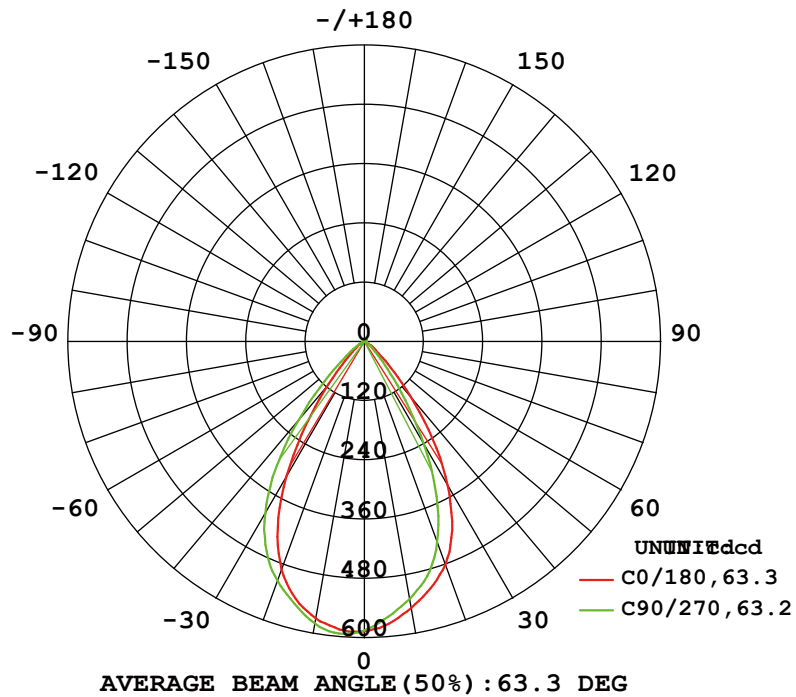

## Illuminance at a Distance

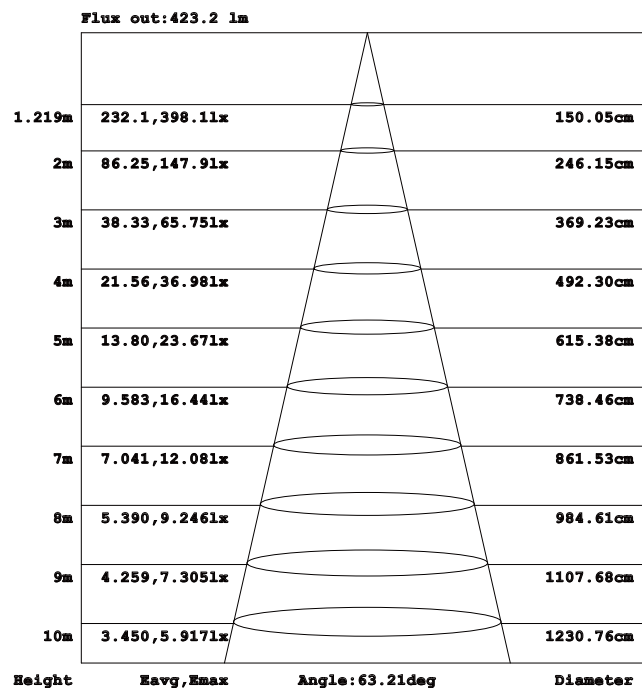

Note: The Curves indicate the illuminated area and the average illumination when the luminaire is at different distance.

# LUMINOUS INTENSITY DISTRIBUTION DIAGRAM

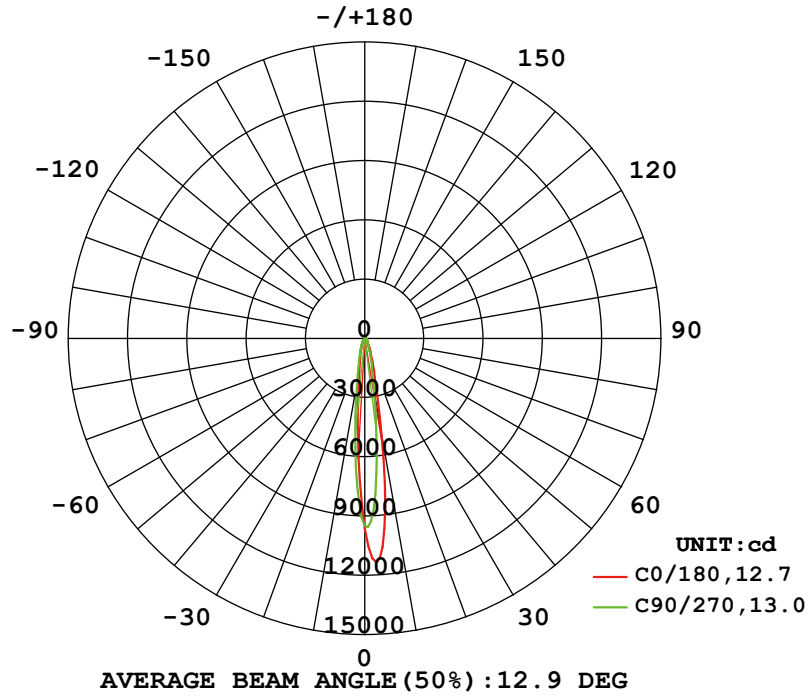

## Illuminance at a Distance

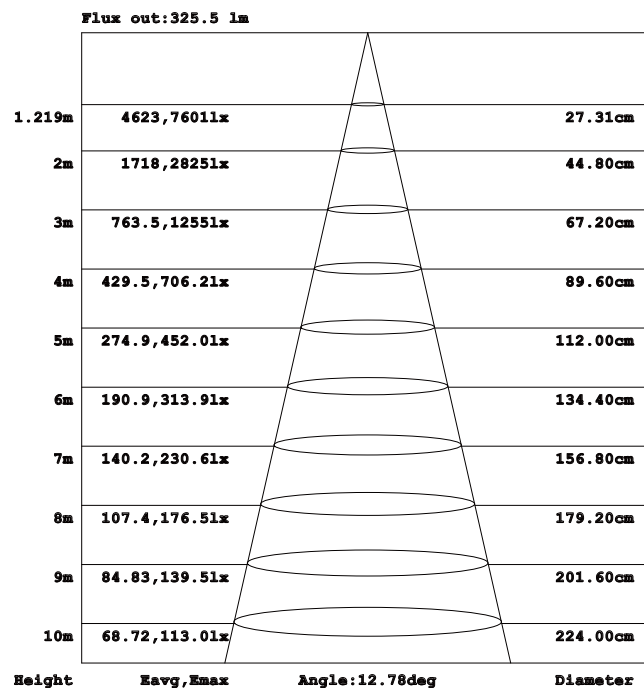

Note: The Curves indicate the illuminated area and the average illumination when the luminaire is at different distance.

# LUMINOUS INTENSITY DISTRIBUTION DIAGRAM

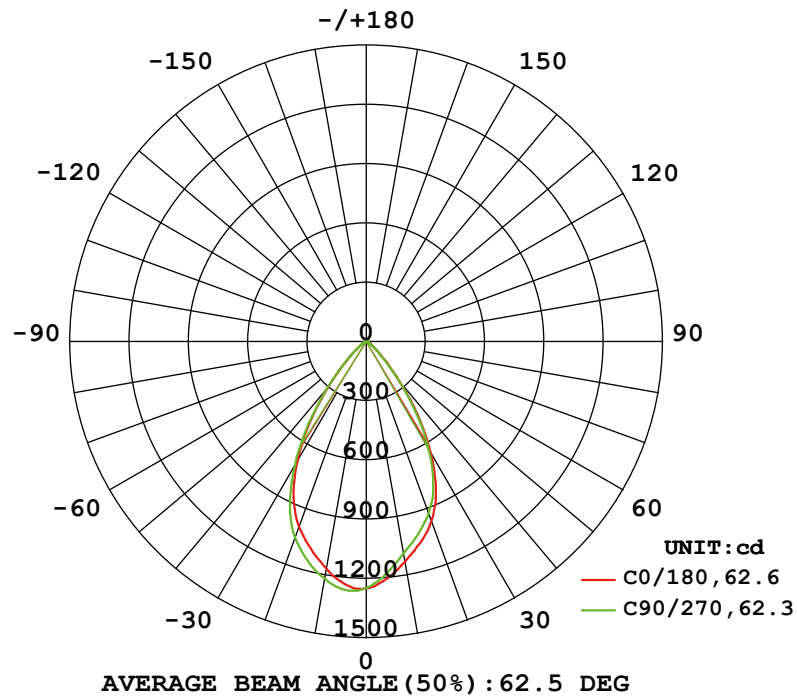

## Illuminance at a Distance

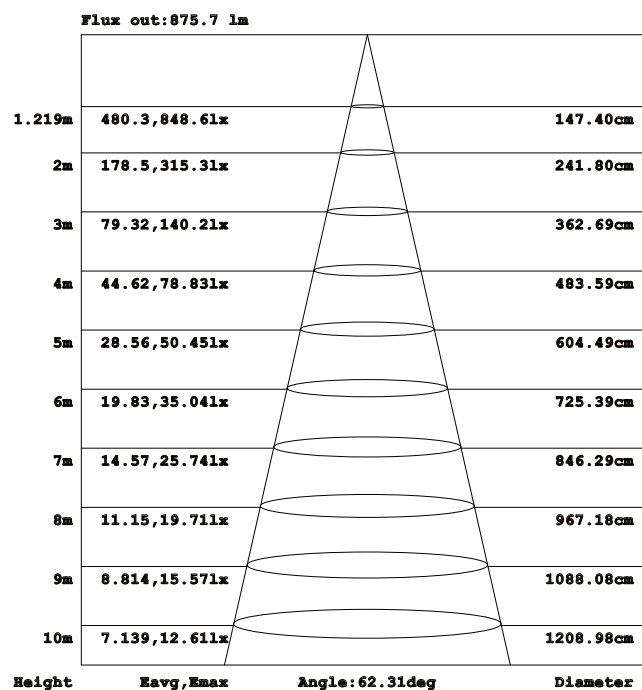

Note: The Curves indicate the illuminated area and the average illumination when the luminaire is at different distance.

# LUMINOUS INTENSITY DISTRIBUTION DIAGRAM

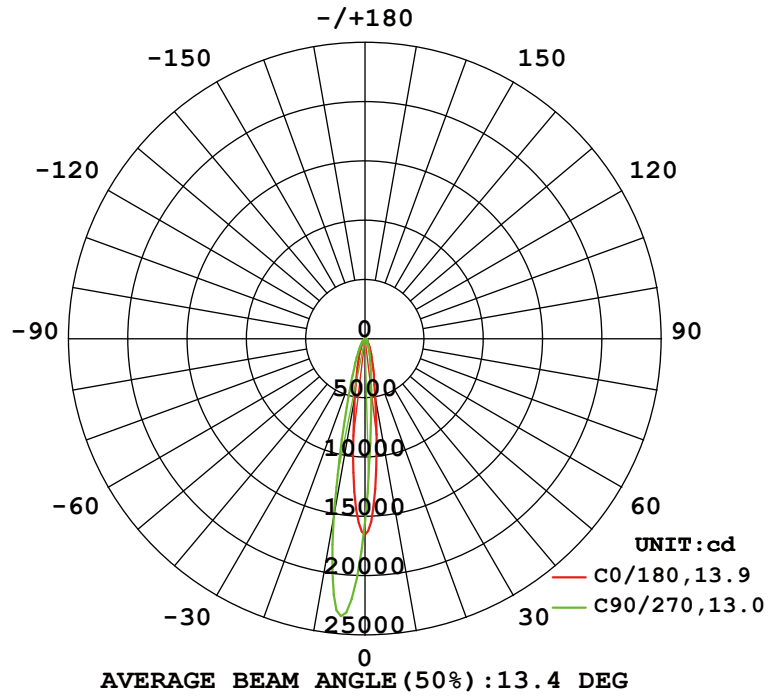

## Illuminance at a Distance

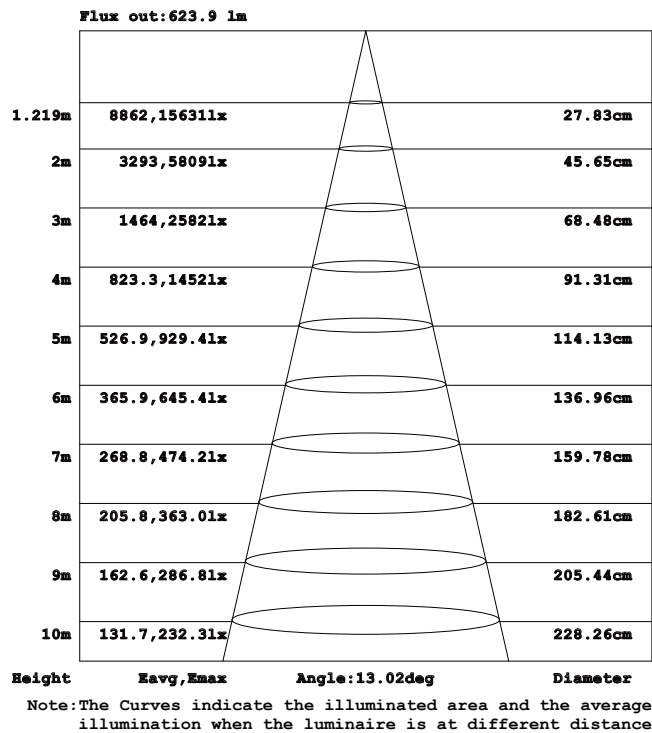

# LUMINOUS INTENSITY DISTRIBUTION DIAGRAM

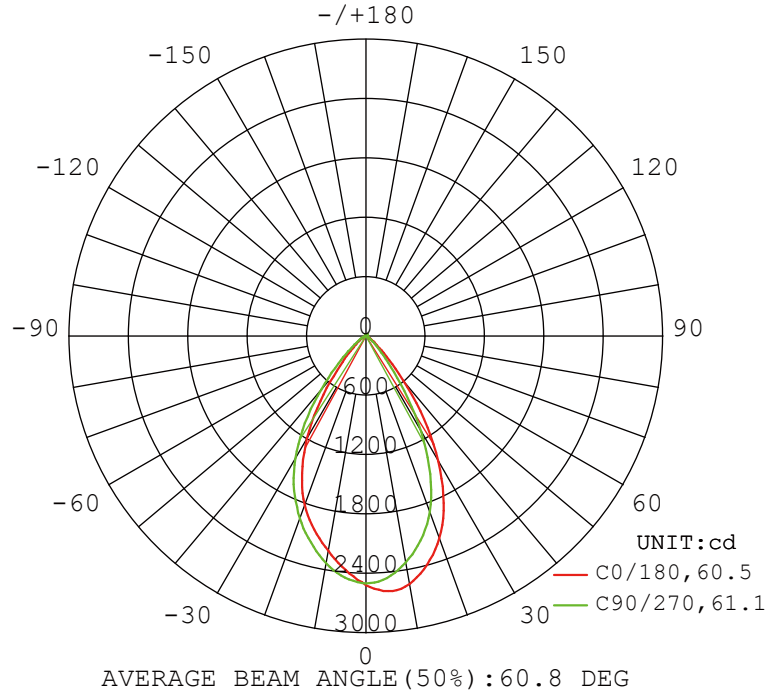

## Illuminance at a Distance

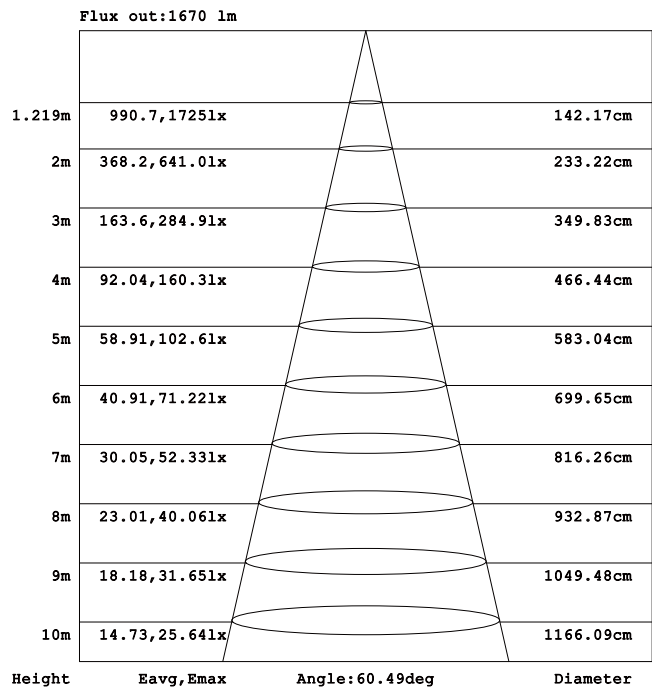

Note: The Curves indicate the illuminated area and the average illumination when the luminaire is at different distance.



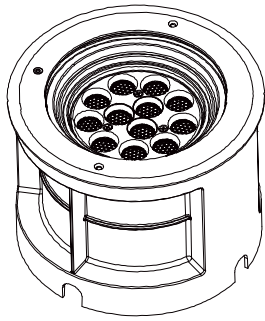

**1**

Turn off The Power

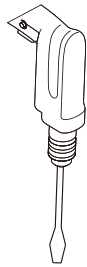
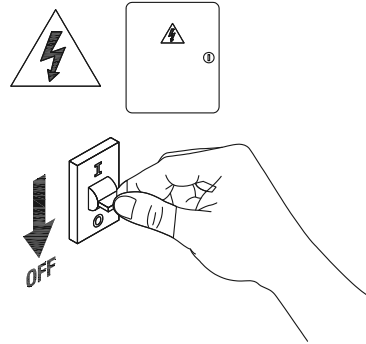

**2**

Opening holes in the wall

**3**

Connect the cable

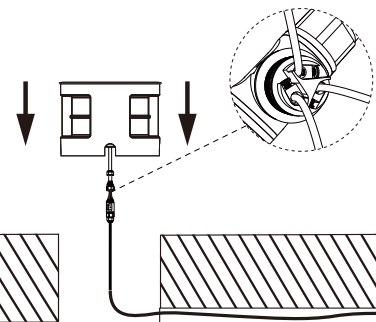

**4**

Installation completed

**5**

Turn on the power

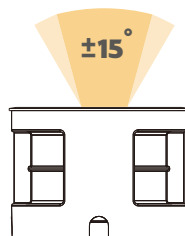
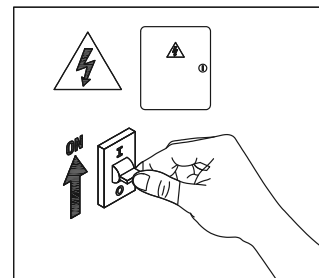

**6**

Direction  $\pm 15^\circ$  adjustable

