

LED SURFACE PANEL LIGHT

WJ-360 Series
IP20

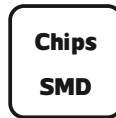
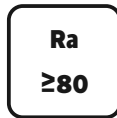
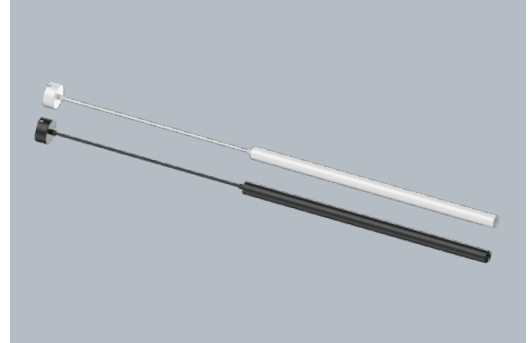

Item Code	P (W)	CCT (K)	Beam angle	Output (lm)	lm/w	Color	Dimensions in mm			kg
							A	B	C	
WJ-360-1	5	3000	60°	355	71	White/Black	Φ30	Φ60	1600	0.512
WJ-360-3	5	3000	60°	355	71	White/Black	Φ30	Φ60	3600	0.512

Dimensions in mm

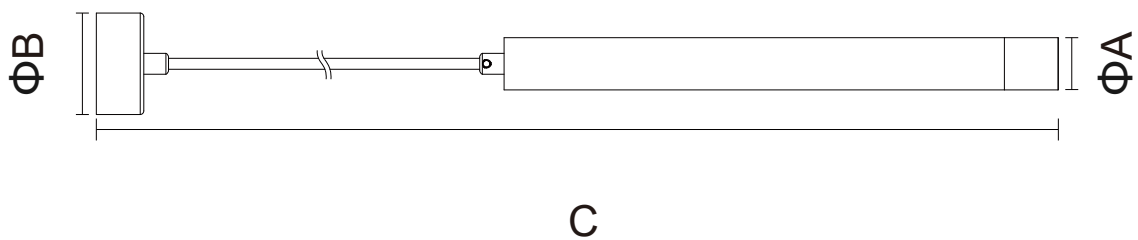

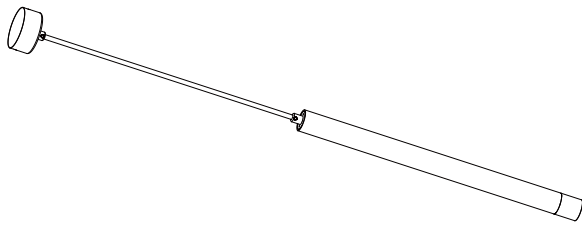

Description:
LED SURFACE PANEL LIGHT

Main material:
Aluminium+Engineering plastics

Specification
Energy saving, up to 85% energy saving comparing to standard halogen and incandescent lamps
High quality light, high color rendering, less heat, no UV or IR radiation
LED driver is included
IP20

Applications
. Shopping mall
. Office buildings
. Exhibition hall

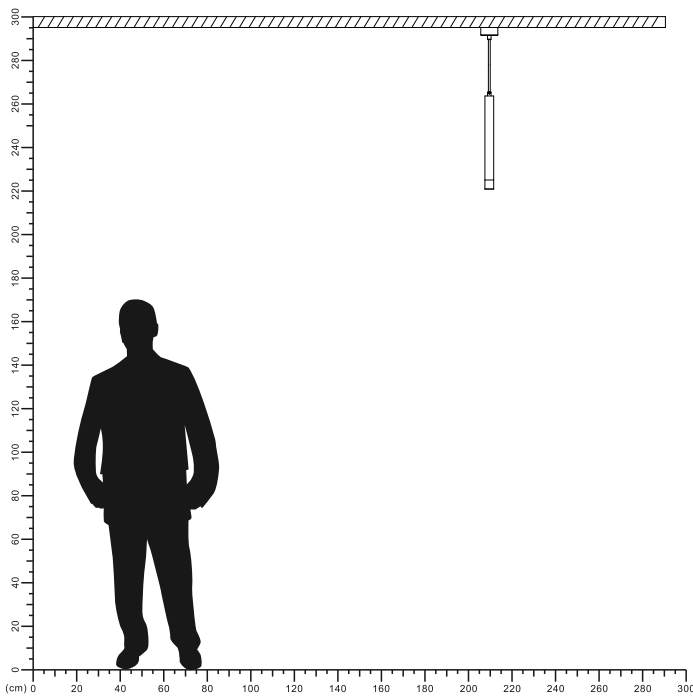

LUMINOUS INTENSITY DISTRIBUTION DIAGRAM

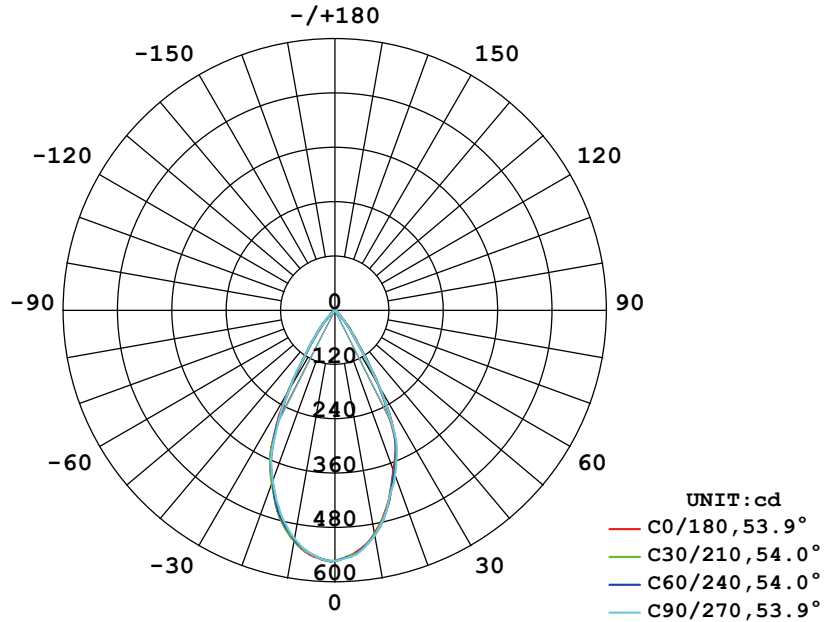

AVERAGE BEAM ANGLE (50%) : 53.9 DEG

Illuminance at a Distance

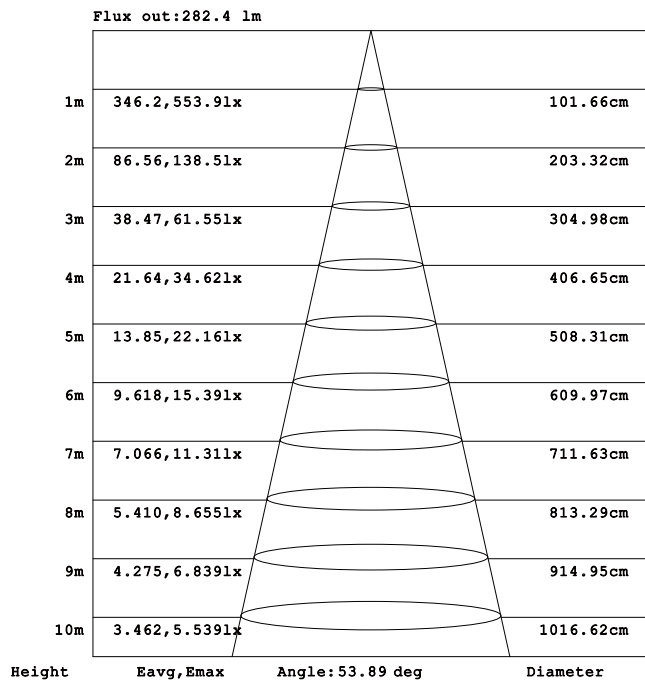

Note: The Curves indicate the illuminated area and the average illumination when the luminaire is at different distance.

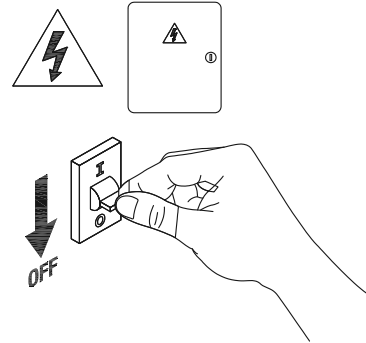
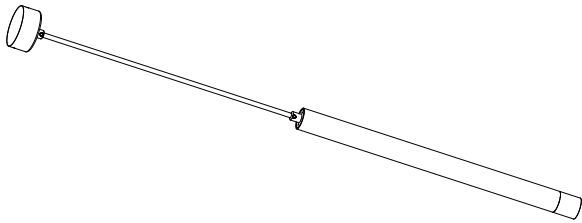

1

Turn off The Power

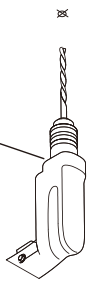

2

Drill 2 holes on your ceiling



3

Connect the cable

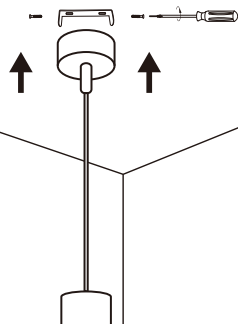

4

Fix the screw



5

Install the GU10 lamp cup



6

Installation completed

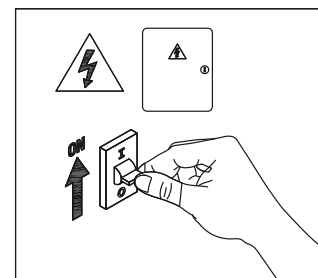

7

Turn on the power

