

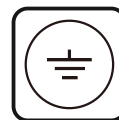

LED Wall Lamp

WL-9077

IP20



Item Code	Cap Type	Dimensions in mm			
		A	B	C	
WL-9077	E27*2	180	130	900	2.5

Dimensions in mm

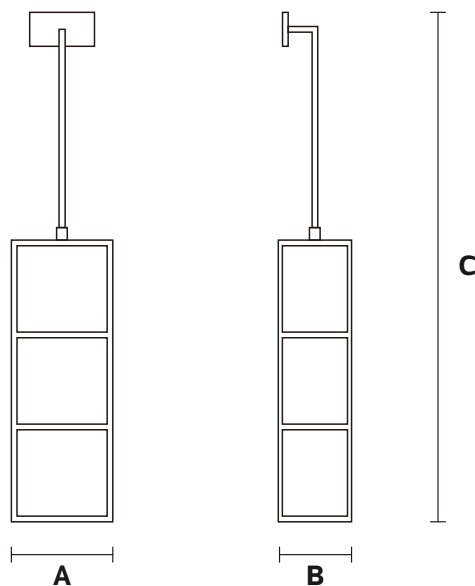

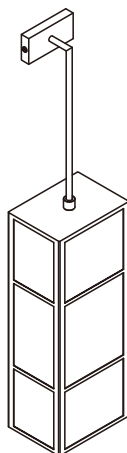
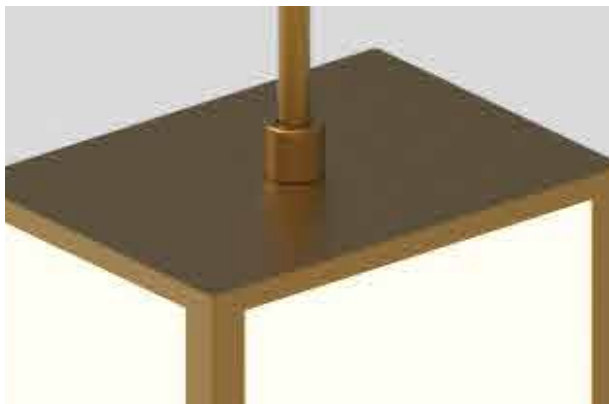

Description:
LED Wall Lamp

Main material:
Iron + acrylic

Specification
Special tree branch shape appearance, simple but full of personality and creative, randomly match the scene.
IP20

Applications
. Hotel
. Drawing room
. Corridor

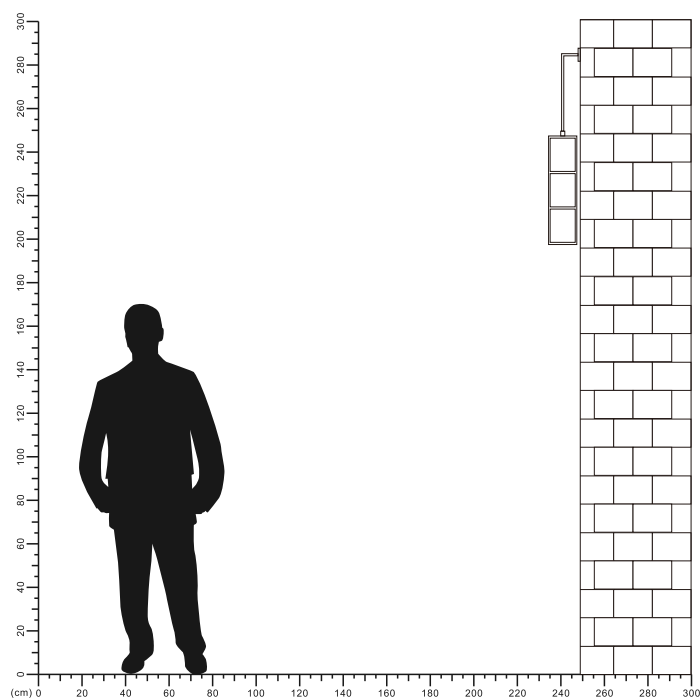

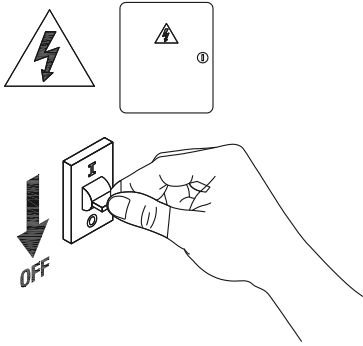

1

Turn off The Power

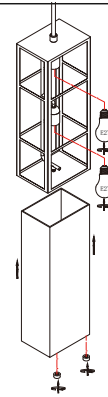

2

Install the E27 bulb and install the lamp casing

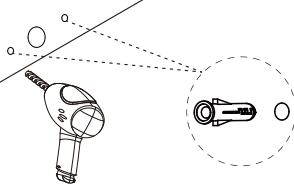

3

Fill holes in the wall insert expansion screws

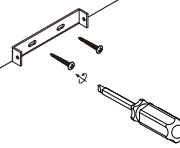

4

Install base plate

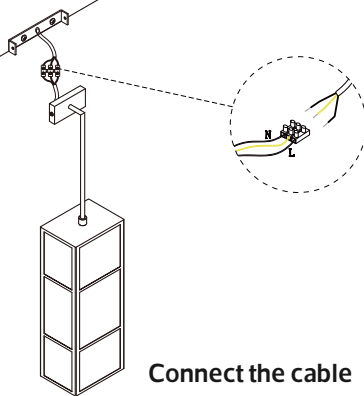

5

Connect the cable

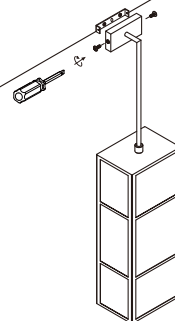

6

Tighten the bulb and insert the lampshade

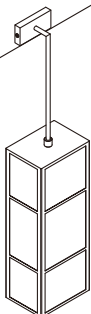

7

Installation completed

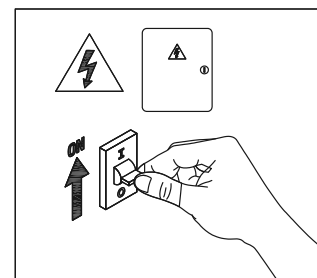

8

Turn on the power

