

## Lamp Accessories

WL027-G9 Series  
IP65

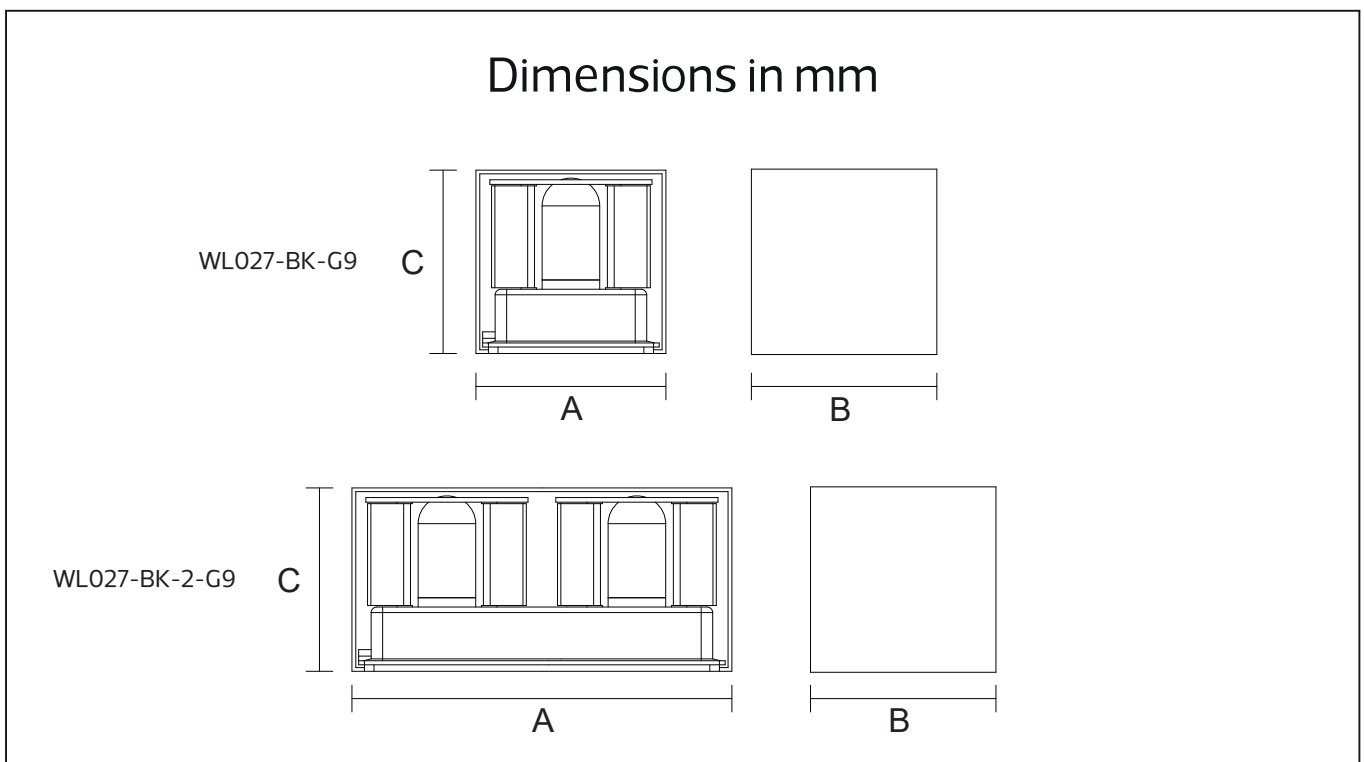

Item Code	Socket	Dimensions in mm			kg
		A	B	C	
WL027-BK-G9	G9*1	100	100	100	0.38
WL027-BK-2-G9	G9*2	200	100	100	0.77



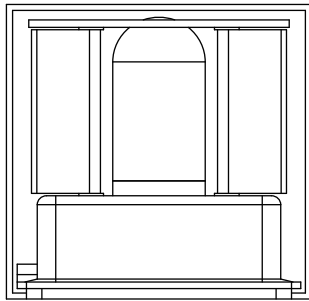
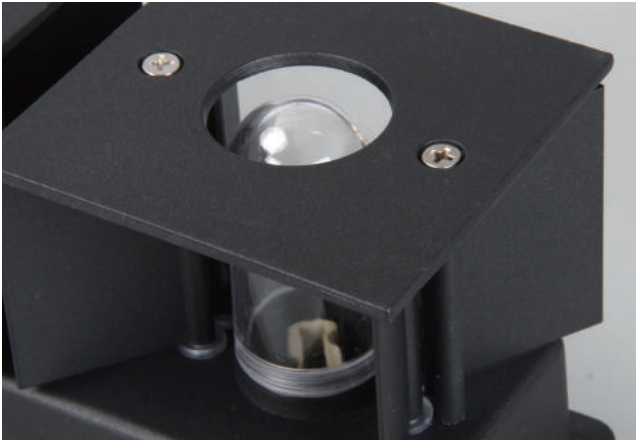

**Description:**  
Lamp Accessories

**Main material:**  
Aluminum

**Specification**  
Energy saving, up to 85% energy saving comparing to standard halogen and incandescent lamps  
High quality light, high color rendering, less heat, no UV or IR radiation  
IP65

**Applications**  

- . Park
- . Square
- . Tourist attraction
- . Corridor

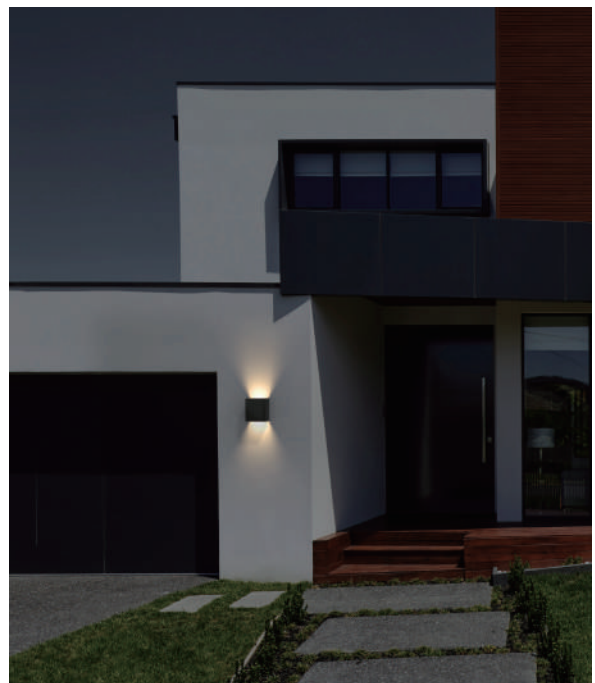
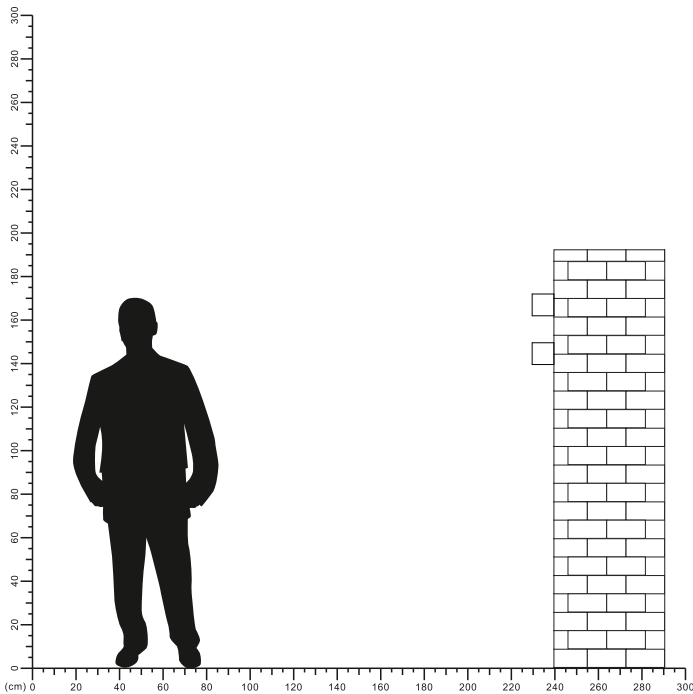

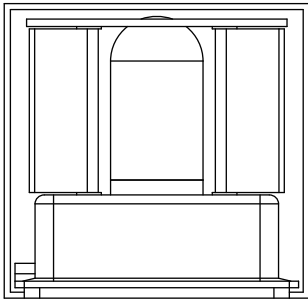

**1**

Turn off The Power

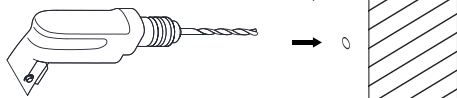
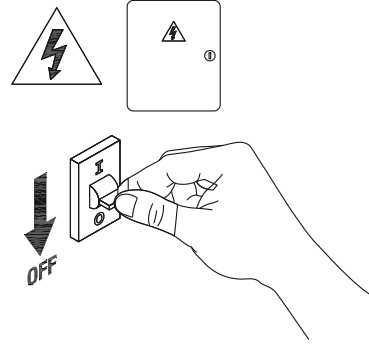

**2**

Drill two screw holes on the wall

**3**

Install the base and connect cables

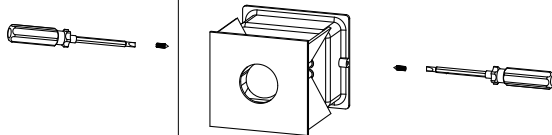
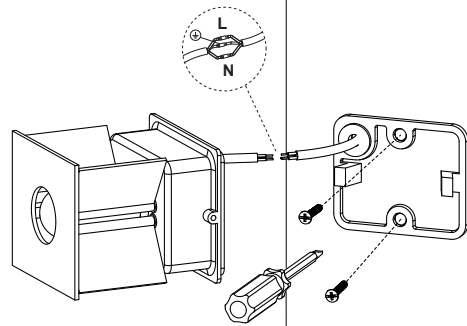

**4**

Fixing the body to the base.

**5**

Install G9 LED lamp

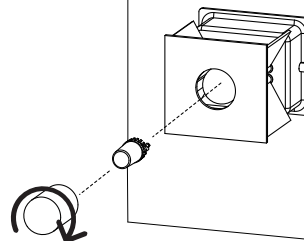

**6**

Install the shell and completed the installation

**7**

Turn on the power

